

plotted

Waverly

FORM 9-1642 (1-68)

Well No. J113 **PUNCHED**

WELL SCHEDULE

U. S. DEPT. OF THE INTERIOR

GEOLOGICAL SURVEY

WATER RESOURCES DIVISION

MASTER CARD

Record # 07 Source of data MBWC Date 11-13-73 Map WAVERLY 135-D

State 23 County Clay 54 Sequential number 13

Latitude: 33 36 48 N Longitude: 0 8 8 3 3 0 3 Sequential number: 1

Lat-long accuracy: 3 17 7 15 NW NE NE

Local well number: J113BA1517307E Other number: _____

Local use: 071 Owner or name: BRYAN FARMS Address: Box 203, West Point

Ownership: County, Fed Gov't, City, Corp or Co, Private, State Agency, Water Dist P

Use of water: (A) Air cond, Bottling, Comm, Dewater, Power, Fire, Dom, Irr, Med, Ind, P S, Rec, (S) Stock, Instit, Unused, Repressure, Recharge, Desal-P S, Desal-other, Other S

Use of well: (A) Anode, Drain, Seismic, Heat Res, Obs, Oil-gas, Recharge, Test, Unused, Withdraw, Waste, Destroyed. W

DATA AVAILABLE: Well data Freq. W/L meas.: Field aquifer char.

Hyd. lab. data:

Qual. water data; type:

Freq. sampling: Pumpage inventory: period:

Log data:

WELL-DESCRIPTION CARD

SAME AS ON MASTER CARD Depth well: 340 ft Meas. 3

Depth cased: 25 1/2 ft Casing type: Steel Diam. 4 in

Finish: (C) porous concrete, (F) gravel w. (G) gravel w. (H) horiz. open perf., (P) screen, (S) sd. pt., (T) shored, (W) open hole, (X) other X

Method Drilled: (A) air bored, (B) cable, (C) dug, (D) hvd jetted, (H) air percussion, (J) rot., (P) reverse trenching, (R) driven, (T) wash, (V) drive, (W) wash, (Z) other H

Date Drilled: 5-1-73 973 Pump intake setting: _____ ft

Driller: W. J. Reeves - Son

Lift (type): (A) air, (B) bucket, (C) cent, (J) multiple, (L) multiple, (M) none, (N) piston, (P) rot, (R) submerg, (S) turb, (T) other, (Z) Deep Shallow

Power (type): (nat) diesel, elec, gas, gasoline, hand, gas, wind, H.P. Trans. or meter no. _____

Descrip. MP _____ ft above LSD, Alt. MP _____

Alt. LSD: 253 Accuracy: (source) _____

Water Level: _____ ft above below MP; _____ ft above below LSD Accuracy: _____

Date meas: 573 Yield: _____ gpm Method determined _____

Drawdown: _____ ft Accuracy: _____ Pumping period _____ hrs

QUALITY OF WATER DATA: Iron _____ ppm Sulfate _____ ppm Chloride _____ ppm Hard. _____ ppm

Sp. Conduct _____ K x 10⁶ Temp. _____ °F Date sampled _____

Taste, color, etc. _____

Well No. J113

Latitude-longitude _____ N
 _____ S
 _____ d _____ m _____ s

HYDROGEOLOGIC CARD

SAME AS ON MASTER CARD Physiographic Province: 03 Section: _____

Drainage Basin: D 13E Subbasin: _____

Topo of well site: (D) depression, stream channel, dunes, flat, hilltop, sink, swamp, (C) (E) (F) (H) (K) (L) (O) (P) (S) (T) (U) (V) offshore, pediment, hillside, terrace, undulating, valley flat _____

MAJOR AQUIFER: system _____ series K3 aquifer, formation, group EU

Lithology: _____ Origin: 6 Aquifer Thickness: _____ ft

Length of well open to: _____ ft 60 Depth to top of: _____ ft 280

MINOR AQUIFER: system _____ series _____ aquifer, formation, group _____

Lithology: _____ Origin: _____ Aquifer Thickness: _____ ft

Length of well open to: _____ ft _____ Depth to top of: _____ ft _____

Intervals Screened:

Depth to consolidated rock: _____ ft _____ Source of data: _____

Depth to basement: _____ ft _____ Source of data: _____

Surficial material: _____ Infiltration characteristics: _____

Coefficient Trans: _____ gpd/ft _____ Coefficient Storage: _____

Coefficient Perm: _____ gpd/ft²; Spec cap: _____ gpm/ft; Number of geologic cards: _____

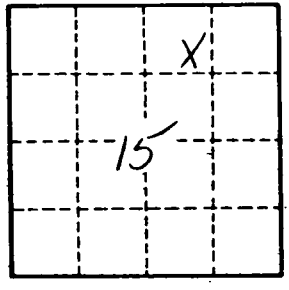
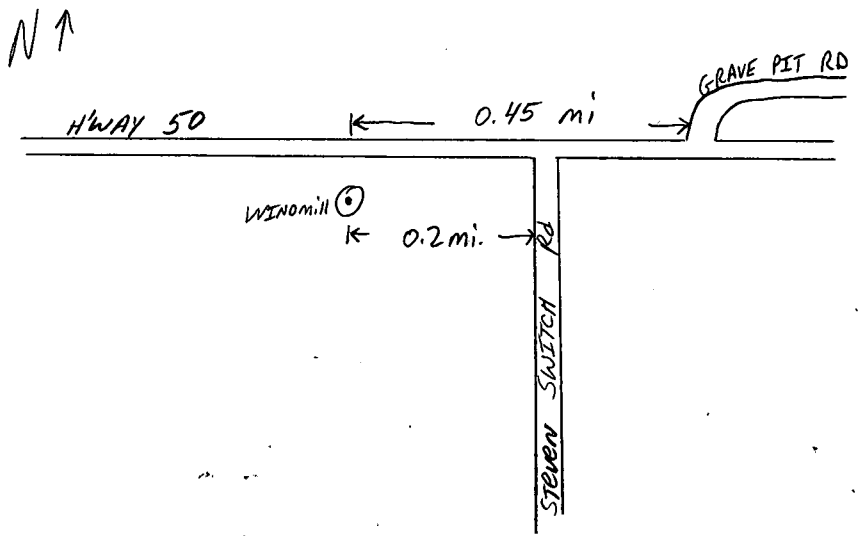

Well No. _____

12-6-90
 130.00
 27.82 cut
 102.18
 1.0 M.P.
 101.18

CLAY
J 113
5-1-73

MISSISSIPPI
BOARD OF WATER COMMISSIONERS
416 North State Street
Jackson, Mississippi 39201

CODED

WATER WELL DRILLERS LOG

5-1 1973 W.J. REEVES & SON CLAY
date well completed firm name county well located

LANDOWNER:	description of formations encountered	from	to
BRYAN FARMS			
Box 203			
WEST POINT (mailing address)	CLAY BLUE CLAY " SAND	0 18 280	18 280 340
WELL LOCATION:			
sec. 16 T. 12 S. R. 7 E			
5 miles E of WEST PT. (distance) (direction) (nearest town)			
WELL PURPOSE: STOCK (home, irrigation, municipal, industrial)			
WELL COMPLETION DATA:			
(1) diameter (inches) 4			
(2) total depth (feet) 340			
(3) static water level (feet) 95 below top of ground.			
(4) casing STU 25 1/2 (material) (depth)			
4 (size) if telescope see back.			
(5) screen (length) (depth to top)			
(size) (material)			
(6) pump 3 (HP) (yield gpm)			
WIND (type power)			
(7) electric log NO (yes or no)			
(organization running log)			
(8) how well bottom plugged OPEN			
DRILLERS REMARKS:			

CODED

OCT 30 1973

MISS. Bd. OF WATER COMM.

