

9-185
(October 1950)

UNITED STATES
DEPARTMENT OF THE INTERIOR
GEOLOGICAL SURVEY
WATER RESOURCES DIVISION

WELL SCHEDULE

Date 4-22, 1964 Field No. _____
Record by P.E. Grantham + Billie Wasson Office No. J38
Source of data Observation + owner

1. Location: State Miss County Clay

Map _____
SW $\frac{1}{4}$ SE $\frac{1}{4}$ sec. 7 T. 17 N. R. 7 

2. Owner: Davis Poultry Co. Address West Point

Tenant Freddie Davis Address _____

Driller Tommy Park Simmons Address Houlka

3. Topography Top of Ridge

4. Elevation 220 ft. above _____
below _____

5. Type: Dug drilled, driven, bored, jetted _____ 19.64 ⁵⁹

6. Depth: Rept. 200' ft. Meas. _____ ft.

7. Casing: Diam. 4" in., to _____ in., Type _____

Depth 40 ft., Finish perf pipe

8. Chief Aquifer Eutaw From _____ ft. to _____ ft.

Others _____

9. Water level 71.65 ft. rept. 4-22 19.64 above well
head meas. which is 0 ft. above
below surface

10. Pump: Type Sub Capacity _____ G. M.

Power: Kind electric Horsepower _____

11. Yield: Flow _____ G. M., Pump 15 G. M., Meas. Rept. Est. _____

Drawdown _____ ft. after _____ hours pumping _____ G. M.

12. Use: Dom., Stock PS., RR., Ind., Irr., Obs. _____

Adequacy, permanence _____

13. Quality _____ Temp 65 °F.

Taste, odor, color _____ Sample 4-22-64
No _____

Unfit for _____

14. Remarks: (Log, Analyses, etc.) _____

75.00 - 335 = 71.65

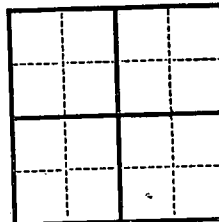

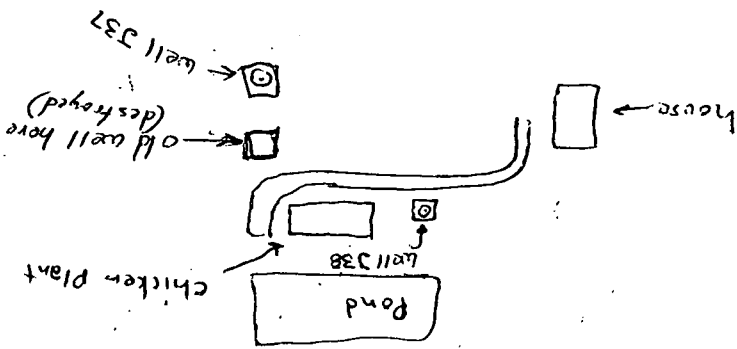

Handwritten notes and text, mostly illegible due to blurriness and low contrast. Some words like "Pond" and "chicken plant" are visible but faint.

DEPARTMENT OF THE INTERIOR
GEOLOGICAL SURVEY

