

Strong

WRD Ex. (GW)  
April 1966

Well No. J18

WELL SCHEDULE  
GEOLOGICAL SURVEY

**PUNCHED PUNCHED**  
RESOURCES DIVISION  
JAN 24 1973

U. S. DEPT. OF THE INTERIOR

DEC 7 1972

MASTER CARD

Record by Shrew/Hit Source of data owner's wife Date 5/16/56 Map \_\_\_\_\_

State Miss. 28 County (or town) C194 13

Latitude: 33<sup>deg</sup> 40<sup>7 min</sup> 43<sup>11 sec</sup> N Longitude: 088<sup>12 degrees</sup> 31<sup>13 min</sup> 5<sup>18 sec</sup> Sequential number: 1

Lat-long accuracy: 3 T. 16 N. R. 7 W. Sec 24, NW 1/4, NW 1/4, NW 1/4

Local well number: J012332416507E Other number: \_\_\_\_\_ B & H

Local use: 115 Owner or name: BUFFORD ROBERTS Address: Rt. 2 W. Point

Ownership: County, Fed Gov't, City, Corp or Co, Private, State Agency, Water Dist P

Use of water: (A) Air cond, (B) Bottling, (C) Comm, (D) Dewater, (E) Power, (F) Fire, (G) Dom, (H) Irr, (I) Med, (J) P S, (K) Rec, (L) Stock, (M) Instat, (N) Unused, (O) Repressure, (P) Recharge, (Q) Desal-P S, (R) Desal-other, Other H

Use of well: (A) Anode, (B) Drain, (C) Seismic, (D) Heat Res, (E) Obs, (F) Oil-gas, (G) Recharge, (H) Test, (I) Unused, (J) Withdraw, (K) Waste, (L) Destroyed W

DATA AVAILABLE: Well data  Freq. W/L meas.:  Field aquifer char.

Hyd. lab. data:

Qual. water data; type:

Freq. sampling:  Pumpage inventory:  no, period: \_\_\_\_\_ yes

Aperture cards:  yes

Log data:

WELL-DESCRIPTION CARD

SAME AS ON MASTER CARD Depth well: 600-800 ft 700 Meas. rept accuracy 6

Depth cased: (first perf.) \_\_\_\_\_ ft \_\_\_\_\_ Casing type: \_\_\_\_\_; Diam. in 2

Finish: (C) porous concrete, (F) gravel w. (perf.), (G) gravel w. (screen), (H) horiz. gallery, (I) open end, (J) open perf., (K) screen, (L) sd. pt., (M) shored, (N) open hole, (O) other H

Method Drilled: (A) air rot, (B) bored, (C) cable, (D) dug, (E) hyd rot, (F) jetted, (G) air percussion, (H) reverse, (I) rotary, (J) trenching, (K) driven, (L) drive wash, (M) other H

Date Drilled: 9-3-6 Pump intake setting: \_\_\_\_\_ ft \_\_\_\_\_

Driller: Simmons

Lift (type): (A) air, (B) bucket, (C) cent, (D) jet, (E) multiple (cent.), (F) multiple (turb.), (G) none, (H) piston, (I) rot, (J) submerg, (K) turb, (L) other H Deep  Shallow

Power (type): (A) diesel, (B) elec, (C) gas, (D) gasoline, (E) hand, (F) gas, (G) wind, (H) H.P., (I) other H Trans. or meter no. \_\_\_\_\_

Descrip. MP 265 (11/89) ft above LSD. Alt. MP \_\_\_\_\_

Alt. LSD: 270 Accuracy: (source) 5

Water Level 30-40 ft above MP; Ft below LSD 35 Accuracy: upt

Date meas: 56 Yield: 56 gpm Method determined \_\_\_\_\_

Drawdown: \_\_\_\_\_ ft Accuracy: \_\_\_\_\_ Pumping period \_\_\_\_\_ hr

QUALITY OF WATER DATA: Iron \_\_\_\_\_ ppm Sulfate \_\_\_\_\_ ppm Chloride \_\_\_\_\_ ppm Hard. \_\_\_\_\_ ppm

Sp. Conduct \_\_\_\_\_ K x 10<sup>6</sup> Temp. \_\_\_\_\_ °F Date sampled 8-5-6

Taste, color, etc. Stains clothes

Well No.

Well No. \_\_\_\_\_

Latitude-longitude \_\_\_\_\_  
N  
S  
d m s d m s

**HYDROGEOLOGIC CARD**

SAME AS ON MASTER CARD  Physiographic Province: \_\_\_\_\_ Section: 03

Drainage Basin: D Subbasin: 13L

Top of well site: (D) depression, stream channel, dunes, flat, hilltop, sink, swamp, (E) (F) (H) (K) (L) (O) (P) (S) (T) (U) (V) offshore, pediment, hillside, terrace, undulating, valley flat

MAJOR AQUIFER: system \_\_\_\_\_ series K3 aquifer, formation, group Gφ

Lithology: \_\_\_\_\_ Origin: 2 Aquifer Thickness: \_\_\_\_\_ ft

Length of well open to: \_\_\_\_\_ ft Depth to top of: \_\_\_\_\_ ft

MINOR AQUIFER: system \_\_\_\_\_ series \_\_\_\_\_ aquifer, formation, group \_\_\_\_\_

Lithology: \_\_\_\_\_ Origin: \_\_\_\_\_ Aquifer Thickness: \_\_\_\_\_ ft

Length of well open to: \_\_\_\_\_ ft Depth to top of: \_\_\_\_\_ ft

Intervals Screened: \_\_\_\_\_

Depth to consolidated rock: \_\_\_\_\_ ft Source of data: \_\_\_\_\_

Depth to basement: \_\_\_\_\_ ft Source of data: \_\_\_\_\_

Surficial material: \_\_\_\_\_ Infiltration characteristics: \_\_\_\_\_

Coefficient Trans: \_\_\_\_\_ gpd/ft Coefficient Storage: \_\_\_\_\_

Coefficient Perm: \_\_\_\_\_ gpd/ft<sup>2</sup>; Spec cap: \_\_\_\_\_ gpm/ft; Number of geologic cards: \_\_\_\_\_

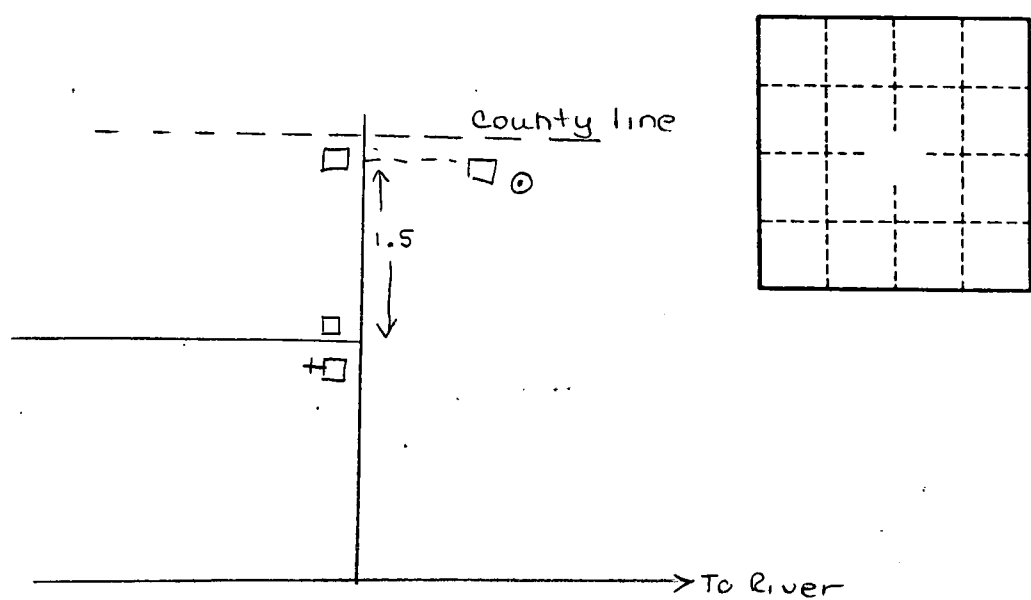

Well No. \_\_\_\_\_