

WELL SCHEDULE

U. S. DEPT. OF THE INTERIOR

GEOLOGICAL SURVEY

WATER RESOURCES DIVISION

PUNCHED FILE COPY
JAN 24 1973

MASTER CARD

Record by Shawes Source of data Owner Date 8-16-56 Map

State 28 County (or town) 13

Latitude: 33 34 29 N Longitude: 08 83 55 W Sequential number: 1

Lat-long accuracy: 2 17 7 29 NE NE NE

Local well number: W 014 A A 29 17 S O 7 E Other number: Marie Gibbs

Local use: _____ Owner or name: _____

Owner or name: V. B. GIBBS Address: West Point (Gibbs Qtrs)

Ownership: County, Fed Gov't, City, Corp or Co, Private, State Agency, Water Dist P

Use of water: (A) Air cond, Bottling, Comm, Dewater, Power, Fire, Dom, Irr, Med, Ind, P S, Rec, (S) Stock, Instit, Unused, Repressure, Recharge, Desal-P S, Desal-other, Other H

Use of well: (A) Anode, Drain, Seismic, Heat Res, Obs, Oil-gas, Recharge, Test, Unused, Withdraw, Waste, Destroyed, (W) W

DATA AVAILABLE: Well data Freq. W/L meas: Field aquifer char.

Hyd. lab. data: _____

Qual. water data; type: _____

Freq. sampling: _____ Pumpage inventory: yes no; period: _____

Aperture cards: _____ yes

Log data: _____

WELL-DESCRIPTION CARD

SAME AS ON MASTER CARD Depth well: _____ ft 250 Meas. rept accuracy 6

Depth cased; (first perf.) _____ ft _____ Casing type: _____; Diam. in _____

Finish: (C) porous concrete, (F) gravel w. (perf.), (G) gravel w. (screen), (H) horiz. gallery, (O) open end, (P) perf., (S) screen, (T) sd. pt., (W) shored, (X) open hole, (Z) other X

Method Drilled: (A) air bored, (B) cable, (C) dug, (D) rot., (H) rot., (J) hyd jetted, (P) air percussion, (R) reverse, (T) trenching, (V) driven, (W) drive wash, (Z) other H

Date Drilled: 9.5.3 Pump intake setting: _____ ft _____

Driller: _____

Lift (type): (A) air, (B) bucket, (C) cent., (J) jet, (L) multiple, (M) multiple, (N) none, (P) piston, (R) rot., (S) submerg, (T) turb, (Z) other P Deep Shallow

Power (type): (nat) diesel, elec, gas, gasoline, hand, gas, wind; (LP) S Trans. or meter no. _____

Descrip. MP _____ above _____ ft below LSD, Alt. MP _____

Alt. LSD: _____ Accuracy: (source) 8

Water Level _____ ft above _____ ft below MP; _____ ft below LSD Accuracy: 9

Date meas: 53 Yield: _____ gpm Method determined 61

Drawdown: _____ ft Accuracy: _____ Pumping period _____ hrs _____

QUALITY OF WATER DATA: Iron _____ Sulfate _____ Chloride _____ Hard. _____

Sp. Conduct _____ K x 10⁶ Temp. _____ °F Date sampled _____

Taste, color, etc. _____

000 Wmory Rd
info on setting house on hill on truck 3/4
8/21/1987 well is sealed up. located in tin house. A day.

unable to get tape in well.

Well No.

Latitude-longitude N
S
d m s d m s

HYDROGEOLOGIC CARD

SAME AS ON MASTER CARD
Physiographic Province: 03 Section: _____
Drainage Basin: 13E Subbasin: _____

Top of well site: (D) depression, (C) stream channel, (E) dunes, (F) flat, (H) hilltop, (K) sink, (L) swamp, (M) offshore, (P) pediment, (S) hillside, (T) terrace, (U) undulating, (V) valley flat
14

MAJOR AQUIFER: system _____ series K3 aquifer, formation, group E2

Lithology: _____ Origin: 6 Aquifer Thickness: _____ ft
Length of well open to: _____ ft Depth to top of: _____ ft

MINOR AQUIFER: system _____ series _____ aquifer, formation, group _____

Lithology: _____ Origin: _____ Aquifer Thickness: _____ ft
Length of well open to: _____ ft Depth to top of: _____ ft

Intervals Screened:
Depth to consolidated rock: _____ ft Source of data: _____
Depth to basement: _____ ft Source of data: _____
Surficial material: _____ Infiltration characteristics: _____
Coefficient Trans: _____ gpd/ft² Coefficient Storage: _____
Coefficient Perm: _____ gpd/ft²; Spec cap: _____ gpm/ft; Number of geologic cards: _____

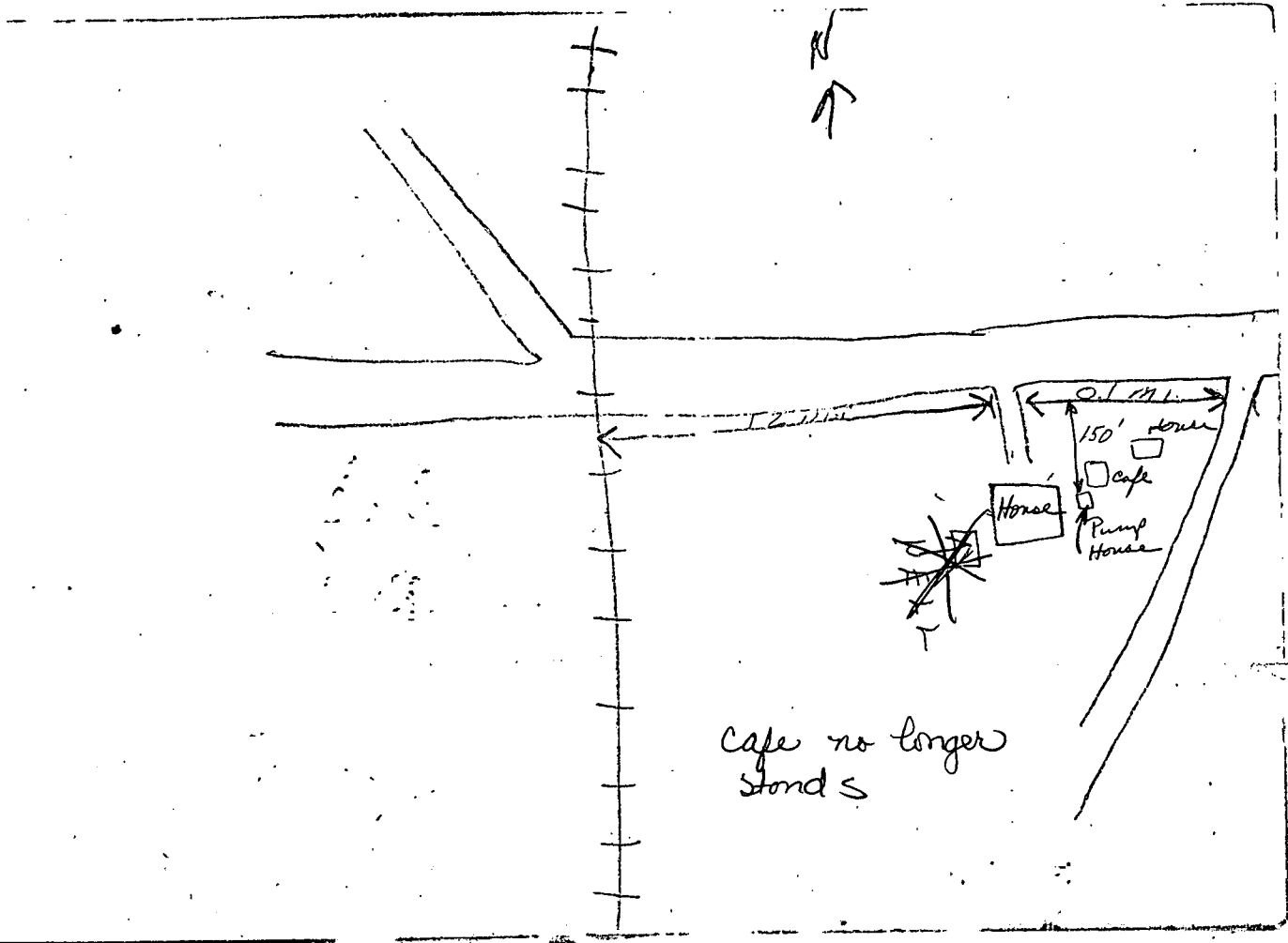

U.S. DEPT. OF INTERIOR
 GEOLOGICAL SURVEY
 WATER RESOURCES DIVISION
 GROUND WATER SITE INVENTORY
 WATER-LEVEL DATA

WELL NO. J14
 MP HEIGHT _____

Clay County

Site Ident. No. 333429088255101

R - 234 * T - A *

VB Gibbs
 211 Eutaw

DATE	WATER LEVEL (BELOW LSD)	STATUS	METHOD	HOLD	CUT	DEPTH BELOW MP	REMARKS	DATE PUNCHED	DATE ENTERED
235 # 08/21/1987 *	237 - *	238 - * *	239 - * *				Can not measure well is in use Bday		
235 # / / *	237 - *	238 - * *	239 - * *						
235 # / / *	237 - *	238 - * *	239 - * *						
235 # / / *	237 - *	238 - * *	239 - * *						
235 # / / *	237 - *	238 - * *	239 - * *						
235 # / / *	237 - *	238 - * *	239 - * *						
235 # / / *	237 - *	238 - * *	239 - * *						
235 # / / *	237 - *	238 - * *	239 - * *						
235 # / / *	237 - *	238 - * *	239 - * *						
235 # / / *	237 - *	238 - * *	239 - * *						
235 # / / *	237 - *	238 - * *	239 - * *						
235 # / / *	237 - *	238 - * *	239 - * *						
235 # / / *	237 - *	238 - * *	239 - * *						
235 # / / *	237 - *	238 - * *	239 - * *						
235 # / / *	237 - *	238 - * *	239 - * *						
235 # / / *	237 - *	238 - * *	239 - * *						
235 # / / *	237 - *	238 - * *	239 - * *						
235 # / / *	237 - *	238 - * *	239 - * *						
235 # / / *	237 - *	238 - * *	239 - * *						

Method of Measurement 239 = A C E G H L M R S T V Z
 airline, calibrated, estimated, pressure, calibrated, geophysical, manometer, reported, steel, electric, calibrated other
 airline pressure gage pressure gage logs tape tape electric tape

Site Status 238 = D E F G H Ø P R S T V X Z
 dry, flowed recently, flowing, nearby, nearby, obstruction, pumping, recently, nearby, nearby, foreign, surface-water, other
 recently flowing flowing recently flowing pumped pumping pumped pumped substances pumped effect