

Recorded by Bew  
Date 9/1/76

U.S. GEOLOGICAL SURVEY  
WATER RESOURCES DIVISION  
MISSISSIPPI DISTRICT  
WELL RECORD

1/77

Well No. H152  
E-Log No. \_\_\_\_\_  
County CLAY

GEN. SITE DATA

Site ID 333450088383301 R=0\* T=AM\* 2=W\*

Data reliab. 3-CU\* Report. agency 4-USGS\* Dist. 6=28\* 7=28\* Co. 8=025\*

Lat. \_\_\_\_\_ Long. 9=333450\* 10=0883833\* Well No. 12=H152\*

Location 13=SESE s 23 T 17 S R 06 E\* Alt. 16=205.\*

Hyd. Unit (OWDC) 20= Date 21=0010011950\*

Well use 23=W\* Water Use 24=H\* Hole depth 27= Well depth 28=360.\*

WL 30=138.\* Date 31=0910111976\* Source 33=S\*

Status 273=

OWNER

R=158\* T=AM\* Date 159#0010011950\* Owner No. \_\_\_\_\_

Owner 161=M G NOLAN\*

FIELD CW

R=192\* T=AM\* Date 193# Temp. 196#00010\* 197=

R=192\* T=AM\* Date 193# Cond. 196#00095\* 197=

R=192\* T=AM\* Date 193# pH 196#00400\* 197=

CONSTR.

R=58\* T=AM\* 59#1\* Date 60=0010011950\* Remarks \_\_\_\_\_

Drlg. 63= Name \_\_\_\_\_ Method 65=H\* Finish 66=X\*

CASING

R=76\* T=AM\* 59#1\*

Top csgn. 77#-1.\* Bot. csgn. 78=20.\* Diam. 79#4.\*

R=76\* T=AM\* 59#1\*

Top csgn. 77# Bot. csgn. 78= Diam. 79#

OPENINGS

R=82\* T=AM\* 59#1\* Top 83#20.\* Bottom 84=360.\*

Type 85=X\* Diam. 87= Size 88=

R=82\* T=AM\* 59#1\* Top 83# Bottom 84=

Type 85= Diam. 87= Size 88=

YIELD

R= 134 146\* T=AM\* 147#1\* Q 150= Q/S 272=

LIFT

R=42\* T= A M \* Lift type 43# \* Intake 44= \* Power type 45= \*

Date 38= / / H.P. 46= \*

LOGS

R=198\* T= A M \* Log 199# \* Top 200= \* Bot 201= \*

R=198\* T= A M \* Log 199# \* Top 200= \* Bot 201= \*

R=189\* T= A M \* E Log No. 190# \* 191= M I S S D I S T \*

ANAL.

R=114\* T= A M \* Year 115# \* Type 120= \*

AQUIFERS

R=90\* T= A M \* 256# 1 \* Top 91= \* Bot 92= \*

Unit ID 93-211EUTW \* Name of Unit \_\_\_\_\_

R=90\* T= A M \* 256# 1 \* Top 91= \* Bot 92= \*

Unit ID 93= \* Name of Unit \_\_\_\_\_

HYDRAULICS

R=98\* T= A M \* 99# 1 \* Unit tested 100= \*

R=105\* T= A M \* 99# 1 \* Test No. 106# \*

107= \* Transmissivity (gal/d)/ft \_\_\_\_\_

108= \* Hydraul. cond. (gal/d)/ft<sup>2</sup> \_\_\_\_\_

110= \* Storage coeff. Boundaries \_\_\_\_\_

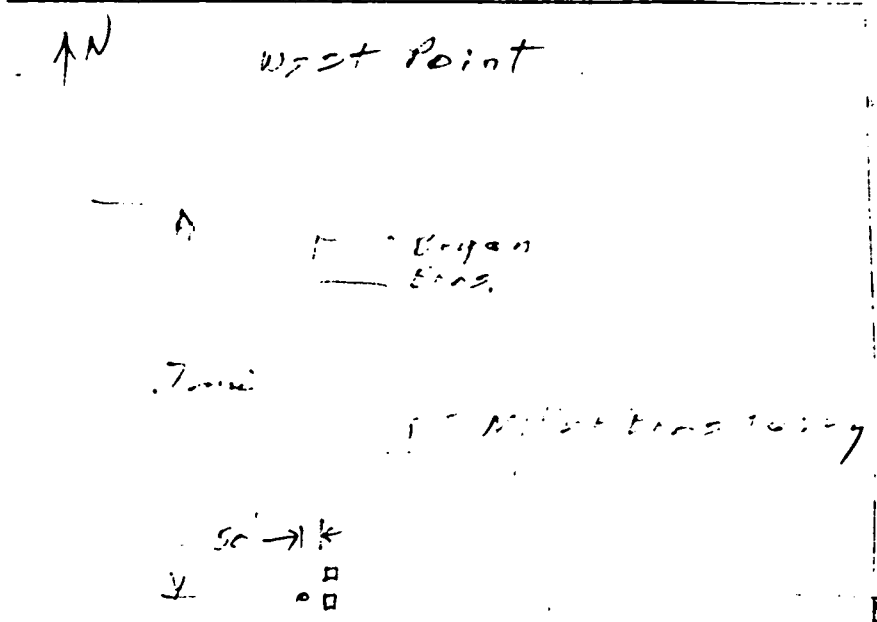

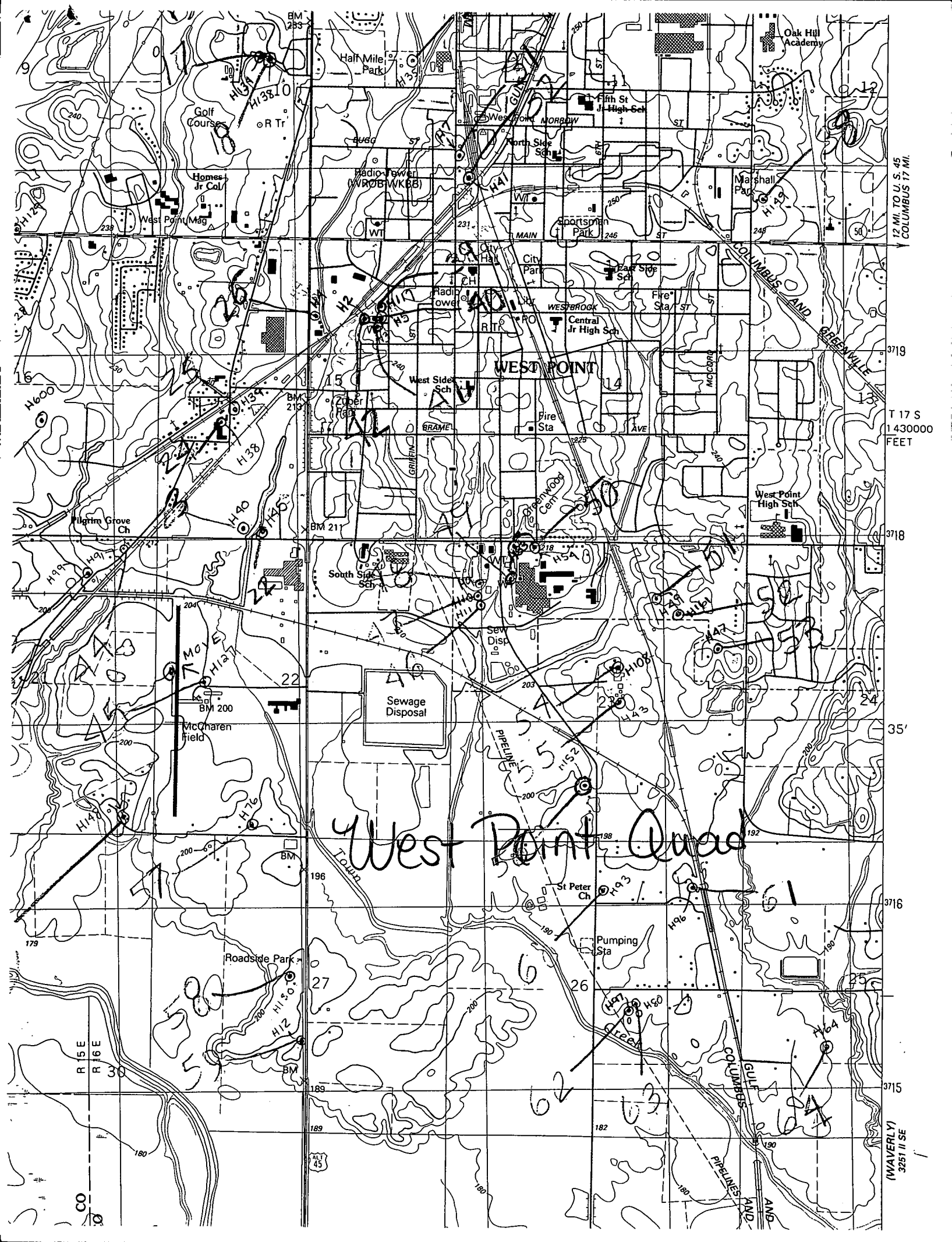

12 MI. TO U. S. 45  
COLUMBUS 17 MI.

T 17 S  
1430000  
FEET

3718

35'

3716

3715

(WAVERLY)  
3251 II SE

West Point Quad