

10/78

TRANSMITTED FOR ADP
1/77

Recorded by BEW
Date CLAY

U.S. GEOLOGICAL SURVEY
WATER RESOURCES DIVISION
MISSISSIPPI DISTRICT
WELL RECORD

Well No. H150
E-Log No. _____
County CLAY

8/19/87 *gdy*

Private well

FILE COPY

14.6
5.34
135.06

GEN. SITE DATA

Site ID 333415088393501 R=0* T=AM* 2=W*

Data reliab. 3-CU* Report. agency 4-USGS* Dist. 6=28* 7=28* Co. 8=025*

Lat. _____ Long. / 9=333415* 10=0883935* Well No. 12=H150

Location 13=SENE S 27 T 17 S R 06 E* Alt. 16=203.*

Hyd. Unit (OWDC) 20= Date 21=00/00/1950*

Well use 23=W* Water Use 24=H* Hole depth 27= Well depth 28=400.*

WL 30=126.* Date 31=08/31/1976* Source 33=S*

Status 273= * W/L=132. 10/5/78

OWNER

R=158* T=AM* Date 159#00/00/1950* Owner No. _____

Owner 161=D. K. ECKROADE*

FIELD OF

R=192* T=AM* Date 193# / / / * Temp. 196#00010* 197= *

R=192* T=AM* Date 193# / / / * Cond. 196#00095* 197= *

R=192* T=AM* Date 193# / / / * pH 196#00400* 197= *

CONSTR.

R=58* T=AM* 59#1* Date 60=00/00/1950* Remarks _____

Drlg. 63= * Name _____ Method 65=H* Finish 66=X*

CASING

R=76* T=AM* 59#1*

Top csgn. 77# - 1.* Bot. csgn. 78= 20.* Diam. 79# 4.*

R=76* T=AM* 59#1*

Top csgn. 77# Bot. csgn. 78= Diam. 79#

OPENINGS

R=82* T=AM* 59#1* Top 83# 20.* Bottom 84= 400.*

Type 85=X* Diam. 87= Size 88=

R=82* T=AM* 59#1* Top 83# Bottom 84=

Type 85= Diam. 87= Size 88=

YIELD

R= 134 146 * T=AM* 147#1* Q 150= Q/S 272=

134
16.3
117.7
11/30/82

*This may not be a good reading
lot of mud.*

LIFT

R=42* T= A M * Lift type 43# * Intake 44= * Power type 45= *

Date 38= / / * H.P. 46= * *

LOGS

R=198* T= A M * Log 199# * Top 200= * Bot 201= *

R=198* T= A M * Log 199# * Top 200= * Bot 201= *

R=189* T= A M * E Log No. 190# * 191= M I S S D I S T *

ANAL.

R=114* T= A M * Year 115# * Type 120= *

AQUIFERS

R=90* T= A M * 256# 1 * Top 91= * Bot 92= *

Unit ID 93= 211 EU TW * Name of Unit

R=90* T= A M * 256# 1 * Top 91= * Bot 92= *

Unit ID 93= * Name of Unit

HYDRAULICS

R=98* T= A M * 99# 1 * Unit tested 100= *

R=105* T= A M * 99# 1 * Test No. 106# *

107= * Transmissivity (gal/d)/ft

108= * Hydraul. cond. (gal/d)/ft²

110= * Storage coeff. Boundaries

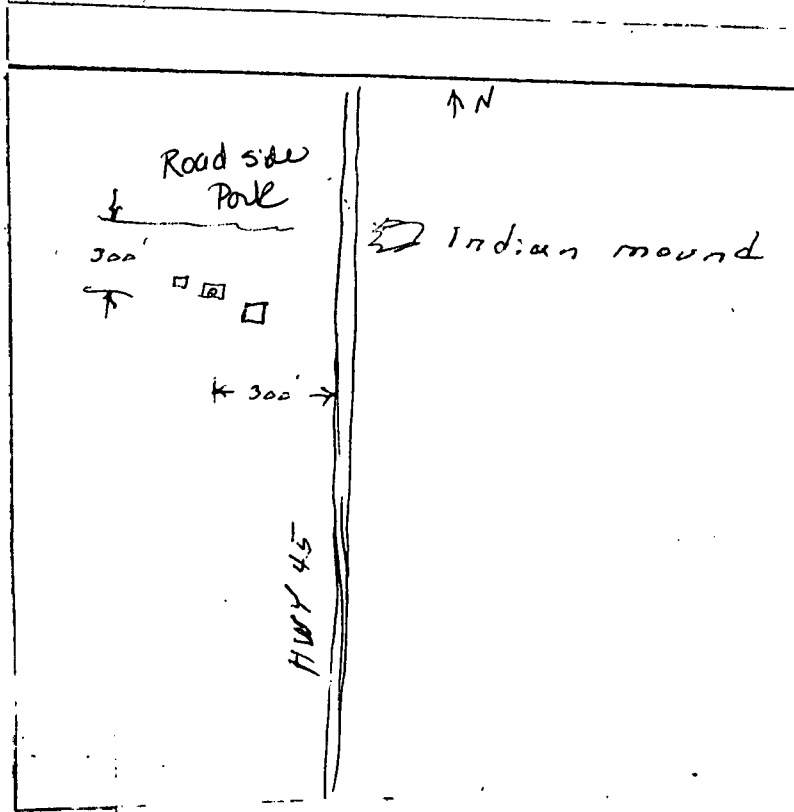

Clay County

U.S. DEPT. OF INTERIOR
 GEOLOGICAL SURVEY
 WATER RESOURCES DIVISION
 GROUND WATER SITE INVENTORY
 WATER-LEVEL DATA

WELL NO. H150

MP HEIGHT _____

*D.K. Eckroade
 211 Cutaw*

Site Ident. No. 3334.15.0883935.01

R - 234 *

T - A *

DATE	WATER LEVEL (BELOW LSD)	STATUS	METHOD	HOLD	CUT	DEPTH BELOW MP	REMARKS	DATE PUNCHED	DATE ENTERED
235 # 1,010 5/1, 978 *	237 - 1,320.00 *	238 - *	239 - *				<i>See Well Schedule attached</i>		
235 # / / *	237 - . . . *	238 - *	239 - *						
235 # 1,113,011, 982 *	237 - 1,117.7 *	238 - *	239 - *				<i>" " may not be a good head</i>		
235 # / / *	237 - . . . *	238 - *	239 - *						
235 # 6,871 9/1, 987 *	237 - 1,350.09 *	238 - *	239 - *						
235 # / / *	237 - . . . *	238 - *	239 - *						
235 # / / *	237 - . . . *	238 - *	239 - *						
235 # / / *	237 - . . . *	238 - *	239 - *						
235 # / / *	237 - . . . *	238 - *	239 - *						
235 # / / *	237 - . . . *	238 - *	239 - *						
235 # / / *	237 - . . . *	238 - *	239 - *						
235 # / / *	237 - . . . *	238 - *	239 - *						
235 # / / *	237 - . . . *	238 - *	239 - *						
235 # / / *	237 - . . . *	238 - *	239 - *						
235 # / / *	237 - . . . *	238 - *	239 - *						
235 # / / *	237 - . . . *	238 - *	239 - *						
235 # / / *	237 - . . . *	238 - *	239 - *						
235 # / / *	237 - . . . *	238 - *	239 - *						
235 # / / *	237 - . . . *	238 - *	239 - *						
235 # / / *	237 - . . . *	238 - *	239 - *						
235 # / / *	237 - . . . *	238 - *	239 - *						
235 # / / *	237 - . . . *	238 - *	239 - *						
235 # / / *	237 - . . . *	238 - *	239 - *						

Method of Measurement 239 = A C E G H L M R S T V Z
 airline, calibrated, estimated, pressure, calibrated, geophysical, manometer, reported, steel, electric, calibrated other
 airline gage pressure gage logs tape tape electric tape

Site Status 238 = D E F G H Ø P R S T V X Z
 dry, flowed flowing, nearby, nearby, obstruction, pumping, recently, nearby, nearby, foreign, surface-water, other
 recently flowing, recently flowing, pumped pumping pumped recently pumped recently substances effect
 flowing

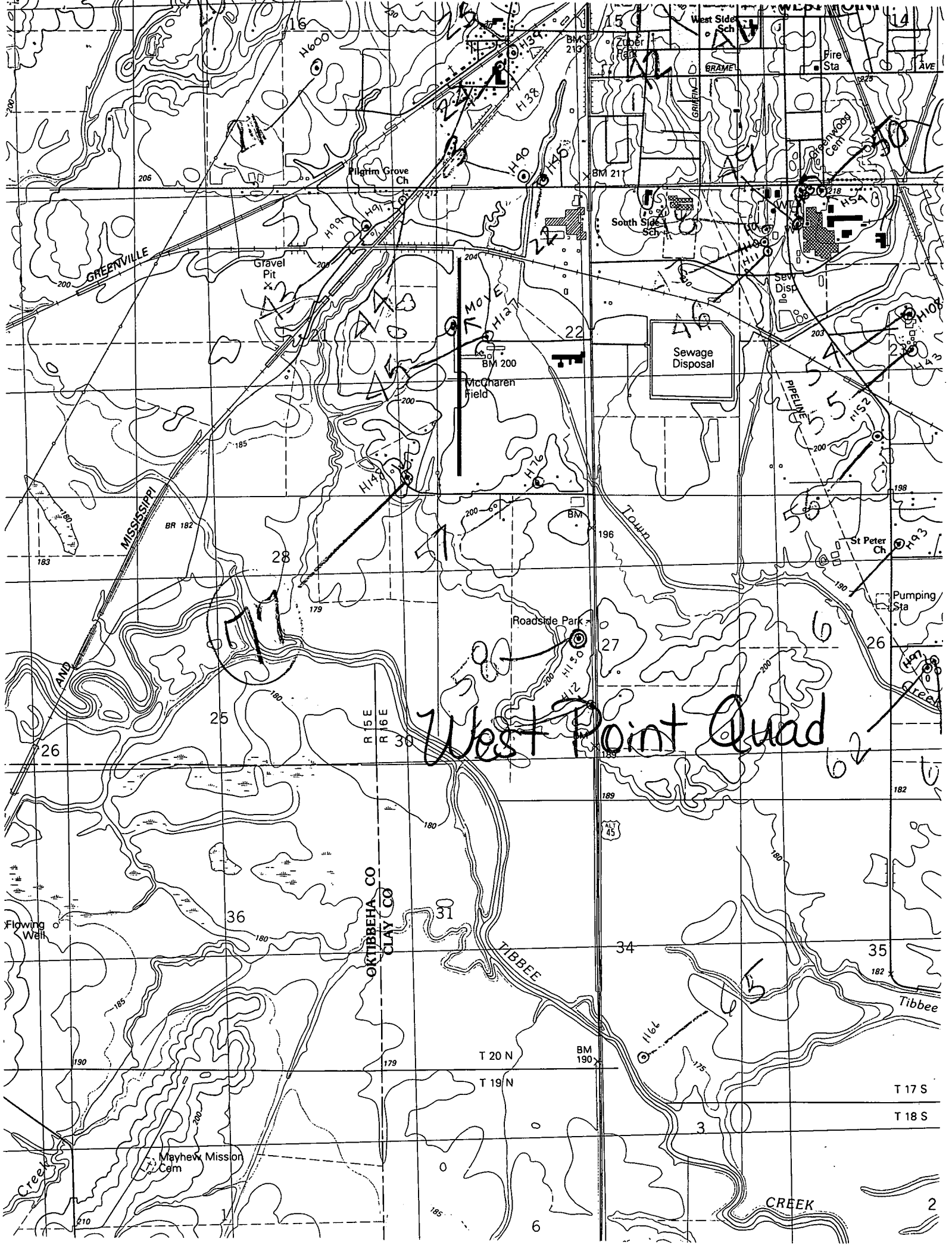

West Point Quad

62

M

