

**WELL-DESCRIPTION CARD**

NAME: **Singer Lays**

ADDRESS: **Clendon Ms**

DATE: **4-1-79**

DEPTH: **40.0** FEET

DIAMETER: **20x12** IN

CONSTRUCTION: **Concrete**

FINISH: **Open**

METHOD: **Hand**

QUALITY OF WATER DATA: **Iron**

SP. CONDUCT: **6**

TEMP: **72**

DATE SAMPLED: **4/1/79**

WATER DATA: **Iron**

QUALITY OF: **Iron**

DEVELOPMENT: **Yield: 4.74**

DATE: **4/1/79**

LEVEL: **Below HP: 177**

WATER: **Below HP: 177**

ALT. LSN: **177**

DESCRIP. HP: **2.2 278 (12/89)**

POWER: **LP**

ITEMS OF INTEREST: **V**

DEPTH: **40.0**

CONSTRUCTION: **Concrete**

FINISH: **Open**

METHOD: **Hand**

QUALITY OF WATER DATA: **Iron**

SP. CONDUCT: **6**

TEMP: **72**

DATE SAMPLED: **4/1/79**

WATER DATA: **Iron**

QUALITY OF: **Iron**

DEVELOPMENT: **Yield: 4.74**

DATE: **4/1/79**

LEVEL: **Below HP: 177**

WATER: **Below HP: 177**

ALT. LSN: **177**

24173 = 9/25/76

Well No.

**MASTER CARD**

RECORD BY: **Source Bowc**

DATE: **5/79**

STATE: **28**

COUNTY: **CLAY**

LOCALITY: **West Point**

WELL NUMBER: **138**

LOCAL USE: **Well #1**

OWNER OR NAME: **WEST POINT**

ADDRESS: **Well # 7**

MEMBERSHIP: **M**

USE OF: **M**

WELL: **M**

DATA AVAILABLE: **Field aquifer char.**

HYD. LAB. DATA: **Φ**

QUAL. WATER DATA: **Φ**

FREQ. SAMPLING: **Φ**

WATER-CARDS: **Φ**

LOG DATA: **Ref Elev 48.99 nearby**

MASTER CARD

DOI # 130008-03

GPSD 4/14/79 AH/MO  
GW1328  
WELL SCHEDULE

West Point  
6W1328  
H138

permitted  
West Point

Well No. \_\_\_\_\_

Latitude-longitude \_\_\_\_\_  
N  
S

**HYDROGEOLOGIC CARD**

**SAME AS ON MASTER CARD** Physiographic Province: 03 Section: \_\_\_\_\_  
Drainage Basin: D Subbasin: 13E

Topo of well site: (D) depression, stream channel, dunes, flat, hilltop, sink, swamp, \_\_\_\_\_  
(E) offshore, pediment, hillside, terrace, undulating, valley flat \_\_\_\_\_

MAJOR AQUIFER: system \_\_\_\_\_ series K3 aquifer, formation, group E2

Lithology: \_\_\_\_\_ Origin: 6 Aquifer Thickness: 101 ft

Length of well open to: \_\_\_\_\_ ft 101 Depth to top of: \_\_\_\_\_ ft 299

MINOR AQUIFER: system \_\_\_\_\_ series \_\_\_\_\_ aquifer, formation, group \_\_\_\_\_

Lithology: \_\_\_\_\_ Origin: \_\_\_\_\_ Aquifer Thickness: \_\_\_\_\_ ft

Length of well open to: \_\_\_\_\_ ft \_\_\_\_\_ Depth to top of: \_\_\_\_\_ ft \_\_\_\_\_

Intervals Screened: \_\_\_\_\_

Depth to consolidated rock: \_\_\_\_\_ ft \_\_\_\_\_ Source of data: \_\_\_\_\_

Depth to basement: \_\_\_\_\_ ft \_\_\_\_\_ Source of data: \_\_\_\_\_

Surficial material: \_\_\_\_\_ Infiltration characteristics: \_\_\_\_\_

Coefficient Trans: \_\_\_\_\_ gpd/ft \_\_\_\_\_ Coefficient Storage: \_\_\_\_\_

Coefficient Perm: \_\_\_\_\_ gpd/ft<sup>2</sup>; Spec cap: \_\_\_\_\_ gpm/ft; Number of geologic cards: \_\_\_\_\_

driller log

HD# 130008-03  
9-6-91  
Hold 240  
cut 23.44  
MP 2.3  
WL 214.26

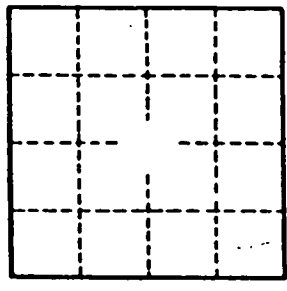
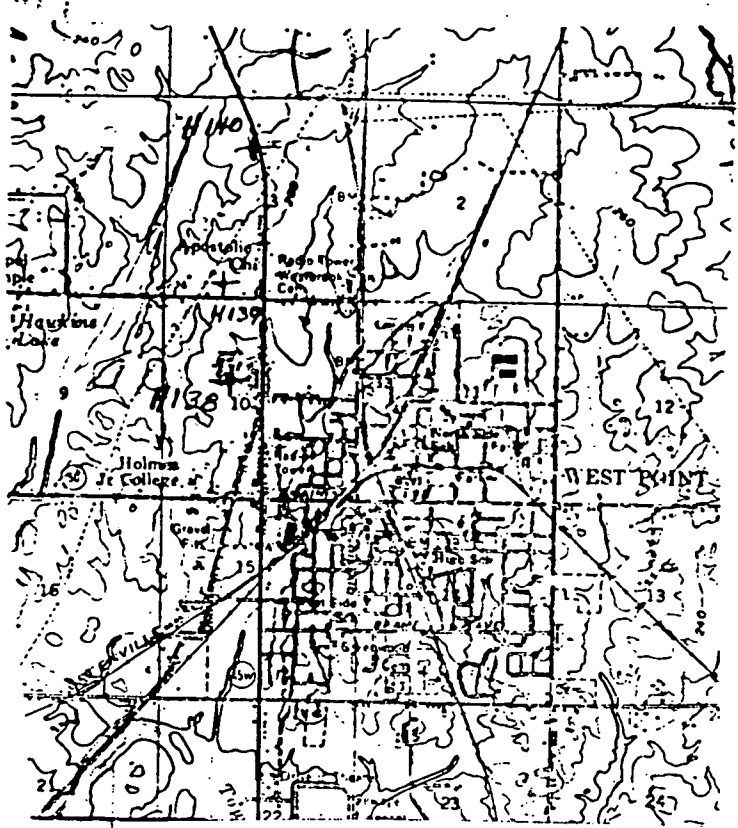

Well No. \_\_\_\_\_

CLAY  
H 138  
4-1-74  
Ref E logs 98,99

GW  
01308

C17226  
Well #1

MISSISSIPPI  
BOARD OF WATER COMMISSIONERS  
416 North State Street  
Jackson, Mississippi 39201

CODED

WATER WELL DRILLERS LOG

April 1, 1974 Singer-Layne Central Div. Clay  
date well completed firm name county well located

LANDOWNER:	description of fomations encountered	from	to
City of West Point			
West Point, Mississippi	Sandy Clay	0	15
(mailing address)	Sand	15	19
	Clay	19	201
WELL LOCATION:	Fine Sand & Sandy Shale	201	236
sec. 10 T 17 N R 6 E S	Rock	236	237
(distance) miles (direction) of West Point (nearest town)	Fine Sand & Sandy Shale	237	279
WELL PURPOSE: Municipal	Hard Rock	279	281
(home, irrigation, municipal, industrial)	Fine Sand	281	298
WELL COMPLETION DATA:	Rock	298	299
(1) diameter (inches) 20"	Fine Sand	299	400
(2) total depth (feet) 407'	Sandy Shale	400	420
(3) static water level (feet) 177' below top of ground	Clay	420	442
Surface Casing: 26" - Size; 18' - Length			
(4) casing Steel 296.9'			
(material) (depth)			
20" If telescope see back.			
Inner Casing: 12" - Size; 115' 4" - Length			
2'-Blank(5) screen 101' 3" 400'			
(length) (depth to top)			
12" Stainless Steel			
(size) (material)			
(6) pump 50 350			
(HP) (yield gpm)			
Electric			
(type power)			
(7) electric log Yes			
(yes or no)			
U. S. Geological Survey			
(organization running log)			
(8) how well bottom plugged 7' Back-			
pressure valve (6")			
DRILLERS REMARKS:			

CODED

MAY 26 1974

MISS. BD. OF WATER COMM.

DEPARTMENT OF ENVIRONMENTAL QUALITY - OLWR  
PUBLIC SUPPLY WELLS PROJECT

GPS LOG

USER NAME(S): AH/mo DATE: 4-14-99

UNIT DEQ #: 82859 FILE #: B041413A

HEALTH DEPT. #: 130008-03 ELEV.: ~250

USGS #: H138 OLWR #: CW-01328

OWNER: City of West Point QUAD: West Point

LOCATION: SE NW S10 T17S R6E COUNTY: Clay

LOCATION DESCRIPTION: AT Fork of road on Lakeside subdivision  
Beside Lake

CASING DIAM: 8" PUMP TYPE AND SIZE: Turbine 60 HP

GPS FIELD LOCATION: LAT: 33 36 58.3 N LONG: 88 39 39.2 W

GPS CORRECTED: LAT: 33.615696 LONG: 88.661522

REMARKS: Rd to tank to well is Across from  
Pizza Inn which is Lake Side Sub. Rd.

p159



H138. West Point. 130008-03. Clay Co. 4/14/99

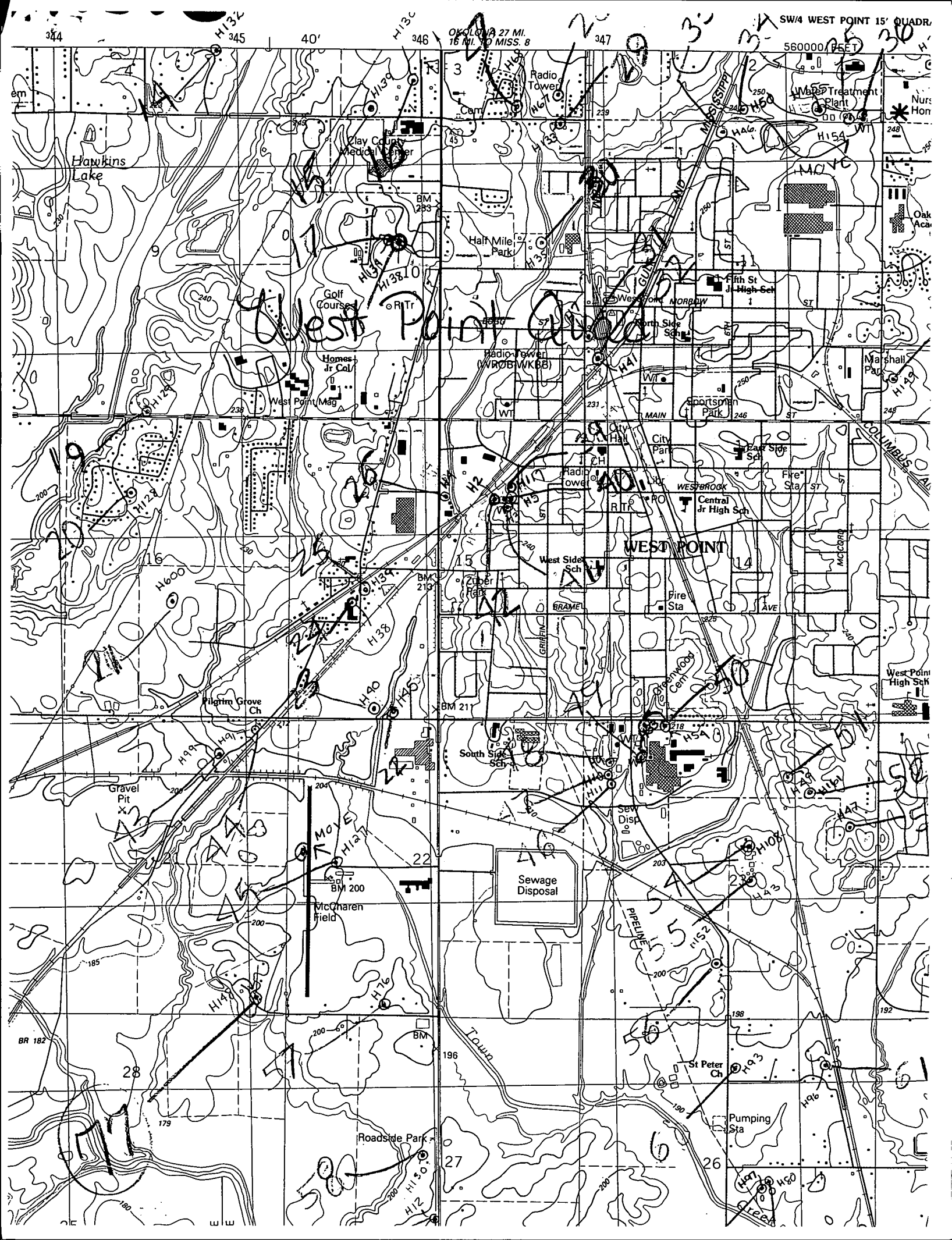

SW/4 WEST POINT 15' QUADR.

OKLAHOMA 27 MI.  
16 MI. TO MISS. B

560000 FEET

Hawkins Lake

Clay County Medical Center

Radio Tower

Water Treatment Plant

Nurs Home

West Point

Golf Courses

Half Mile Park

High St. High Sch

Homes Jr Col

Radio Tower (WROB/WKBB)

North Side Sch

West Point Mag

City Hall

Marshall Park

WEST POINT

West Side Sch

East Side Sch

Pilgrim Grove Ch

South Side Sch

Central Jr High Sch

Gravel Pit

Sewage Disposal

McCharen Field

Sew Disp

St Peter Ch

Roadside Park

Pumping Sta