

FORM 9-1642 (1-68)

Well No. H 132
Elog # 47

WELL SCHEDULE
GEOLOGICAL SURVEY

U. S. DEPT. OF THE INTERIOR

WATER RESOURCES DIVISION

MASTER CARD

Record by WTO Source of data Obs driller Date 10-25-73 Map West Point + Quad

State MISS 28 County (or town) CLAY 13

Latitude: 33° 37' 23" N Longitude: 088° 40' 24" W Sequential number: 1

Lat-long accuracy: 2 T 17 R 6 W, Sec 4 NE NE SW SE

Local well number: H 132 CD 04 17 50 6 E Other number: T.H. # 6

Local use: 064047 Owner or name: WEST POINT Address: _____

Ownership: County, Fed Gov't, City, Corp or Co, Private, State Agency, Water Dist M

Use of water: (A) Air cond, Bottling, Comm, Dewater, Power, Fire, Dow, Irr, Med, Ind, P S, Rec. (S) (T) (U) (V) (W) (X) (Y) (Z) U

Use of well: (A) Anode, Drain, Seismic, Heat Res, Obs, Oil-gas, Recharge, Test, Unused, Withdraw, Waste, Destroyed. (P) (R) (T) (U) (W) (X) (Z) T

DATA AVAILABLE: Well data Freq. W/L meas.: Field aquifer char.

Hyd. lab. data:

Qual. water data; type:

Freq. sampling: Pumpage inventory: yes no period:

Aperture cards: yes

Log data: Elog 10' - 499' Soot D E

WELL-DESCRIPTION CARD

SAME AS ON MASTER CARD Depth well: _____ ft Meas. rept accuracy _____

Depth cased; (first perf.) _____ ft Casing type: _____; Diam. _____ in

Finish: (C) porous concrete, (F) gravel w. (perf.), (G) gravel w. (screen), (H) horiz. gallery, (N) open hole, (P) perf., (S) screen, (T) sd. pt., (W) shored, (X) open hole, (Z) other

Method Drilled: (A) air rot, (B) bored, (C) cable, (D) dug, (H) hyd jetted, (J) air rot., (P) reverse percussion, (R) air percuss, (T) rotary, (V) driven, (W) drive wash, (Z) other

Date Drilled: 10-25-73 9:7:3 Pump intake setting: _____ ft

Driller: SINGER LAYNE (SHULTZ) CLEVELAND

Lift (type): (A) air, (B) bucket, (C) cent., (J) jet, (L) multiple, (M) multiple, (N) noise, (P) piston, (R) rot., (S) submerg., (T) turb., (Z) other Deep Shallow

Power (type): (nat) diesel, elec, gas, gasoline, hand, gas, wind; (LP) gas, wind; H.P. Trans. or meter no. _____

Descrip. MP OK (12/89) above ft below LSD, Alt. MP _____

Alt. LSD: 230 Accuracy: topo 4

Water Level: _____ ft above below MP; _____ ft above below LSD Accuracy: _____

Date meas: _____ Yield: _____ gpm Method determined

Drawdown: _____ ft Accuracy: _____ Pumping period _____ hrs

QUALITY OF WATER DATA: Iron _____ ppm Sulfate _____ ppm Chloride _____ ppm Hard. _____ ppm

Sp. Conduct _____ K x 10⁶ Temp. _____ °F Date sampled _____

Taste, color, etc. _____

Well No.

Well No. _____

Latitude-longitude _____
d m s d m s

HYDROGEOLOGIC CARD

SAME AS ON MASTER CARD Physiographic Province: 03 Section: _____

Drainage Basin: D Subbasin: 13E

Topo of well site: (D) depression, stream channel, dunes, flat, hilltop, sink, swamp, (E) offshore, pediment, hillside, terrace, undulating, valley flat

MAJOR AQUIFER: system _____ series _____ aquifer, formation, group _____

Lithology: _____ Origin: _____ Aquifer Thickness: _____ ft

Length of well open to: _____ ft Depth to top of: _____ ft

MINOR AQUIFER: system _____ series _____ aquifer, formation, group _____

Lithology: _____ Origin: _____ Aquifer Thickness: _____ ft

Length of well open to: _____ ft Depth to top of: _____ ft

Intervals Screened:

Depth to consolidated rock: _____ ft Source of data: _____

Depth to basement: _____ ft Source of data: _____

Surficial material: _____ Infiltration characteristics: _____

Coefficient Trans: _____ gpd/ft Coefficient Storage: _____

Coefficient Perm: _____ gpd/ft²; Spec cap: _____ gpm/ft; Number of geologic cards: _____

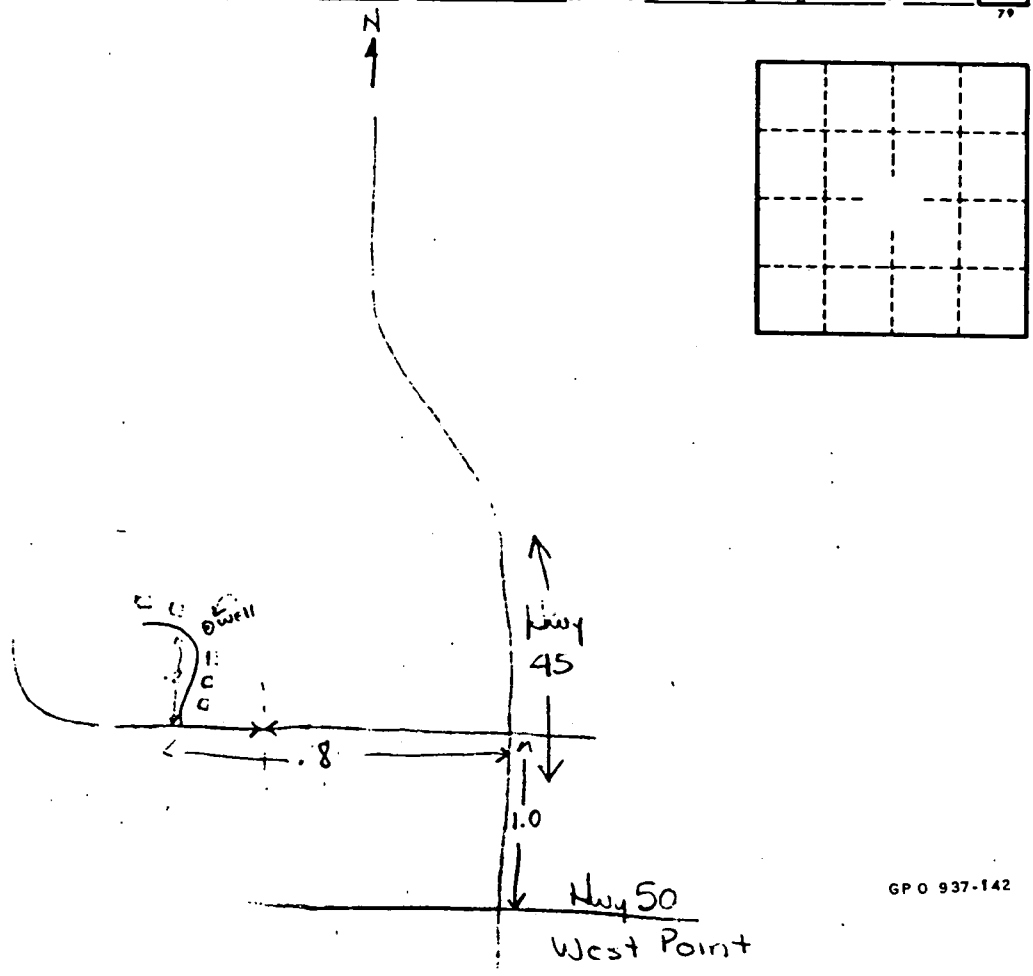

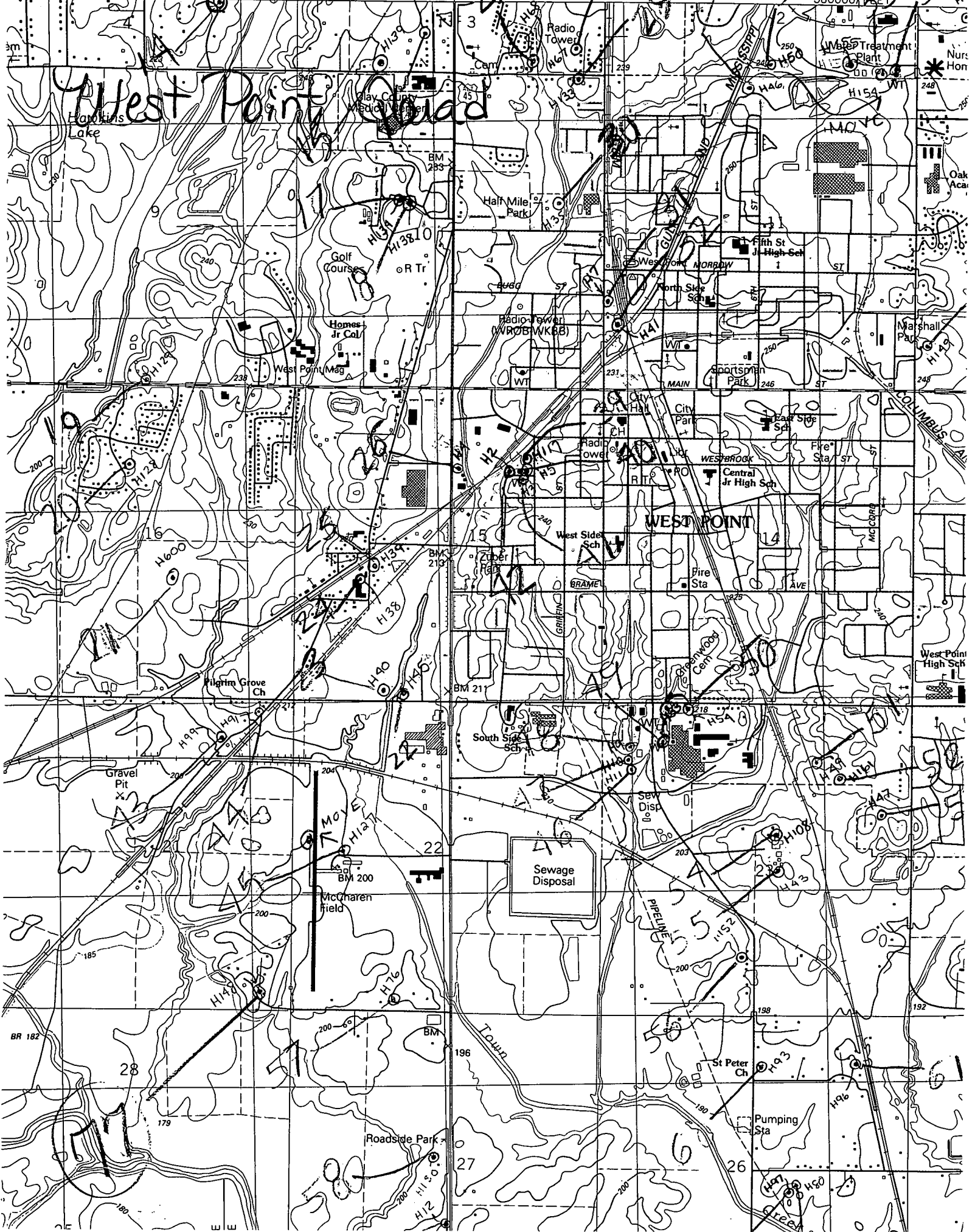

West Point

WEST POINT

Sewage Disposal

Roadside Park

St Peter Ch

Pumping Sta