

FORM 9-1642 (1-68)

Well No. H129

WELL SCHEDULE
GEOLOGICAL SURVEY

E log # 44
WATER RESOURCES DIVISION

U. S. DEPT. OF THE INTERIOR

MASTER CARD

Record by WTO Source of data Obs driller Date 10-23-73 Map West Point Quad

State Miss County CLAY (or town) 28 13

Latitude: 33° 37' 11" N Longitude: 088° 40' 49" W Sequential number: 1

Lat-long accuracy: 20 T. 17 S. R. 6 Sec. 9SW, SW 1/4, SW 1/4, SE 1/4

Local well number: H129CD09173065 Other number: T.H. #3

Local use: 064044 Owner or name: WEST POINT Address: _____

Ownership: County, Fed Gov't, City, Corp or Co, Private, State Agency, Water Dist M

Use of water: Air cond, Bottling, Comm, Dewater, Power, Fire, Dom, Irr, Med, Ind, P S, Rec, Stock, Instit, Unused, Repressure, Recharge, Desal-P S, Desal-other, Other U

Use of well: Anode, Drain, Seismic, Heat Res, Obs, Oil-gas, Recharge, Test, Unused, Withdraw, Waste, Destroyed. T

DATA AVAILABLE: Well data Freq. W/L meas.: Field aquifer char.

Hyd. lab. data:

Qual. water data; type: _____

Freq. sampling: Pumpage inventory: no; period: _____

Aperture cards: yes

Log data: E log 10' - 500' E

WELL-DESCRIPTION CARD

SAME AS ON MASTER CARD Depth well: _____ ft Meas. accuracy _____

Depth cased; (first perf.) _____ ft Casing type: _____; Diam. _____ in

Finish: porous concrete, gravel w. (perf.), gravel w. (screen), horz. gallery, open end, other _____

Method Drilled: air rot., cable, dug, hyd jetted, air rot., percussion, rotary, reverse trenching, driven, drive wash, other _____

Date Drilled: _____ Pump intake setting: _____ ft

Driller: SINGER LAYNE (SHULTZ) CLEVELAND

Lift (type): air, bucket, cent, jet, multiple, multiple, none, piston, rot, submerg, turb, other _____ Deep _____ Shallow _____

Power (type): diesel, elec, gas, gasoline, hand, gas, wind; H.P. _____ Trans. or meter no. _____

Descrip. MP OK C12/P9 ft above _____ below LSD, Alt. MP _____

Alt. LSD: 230 Accuracy: topo 4

Water Level _____ ft above _____ below MP; Ft below LSD _____ Accuracy: _____

Date meas: _____ Yield: _____ gpm Method determined _____

Drawdown: _____ ft Accuracy: _____ Pumping period _____ hrs

QUALITY OF WATER DATA: Iron _____ Sulfate _____ Chloride _____ Hard. _____

Sp. Conduct _____ K x 10⁶ Temp. _____ °F Date sampled _____

Taste, color, etc. _____

Well No.

Well No. _____

Latitude-longitude _____
d m s N S

HYDROGEOLOGIC CARD

SAME AS ON MASTER CARD Physiographic Province: _____

013 Section: _____

D Drainage Basin: _____ **113E** Subbasin: _____

(D) depression, stream channel, dunes, flat, hilltop, sink, swamp, offshore, pediment, hillside, terrace, undulating, valley flat

MAJOR AQUIFER: _____ system _____ series _____ aquifer, formation, group _____

Lithology: _____ **Origin:** _____ **AQUIFER Thickness:** _____ ft
Length of well open to: _____ ft **Depth to top of:** _____ ft

MINOR AQUIFER: _____ system _____ series _____ aquifer, formation, group _____

Lithology: _____ **Origin:** _____ **AQUIFER Thickness:** _____ ft
Length of well open to: _____ ft **Depth to top of:** _____ ft

Intervals Screened:

Depth to consolidated rock: _____ ft **Source of data:** _____

Depth to basement: _____ ft **Source of data:** _____

Surficial material: _____ **Infiltration characteristics:** _____

Coefficient Trans: _____ gpd/ft **Coefficient Storage:** _____

Coefficient Perm: _____ gpd/ft²; **Spec cap:** _____ gpm/ft; **Number of geologic cards:** _____

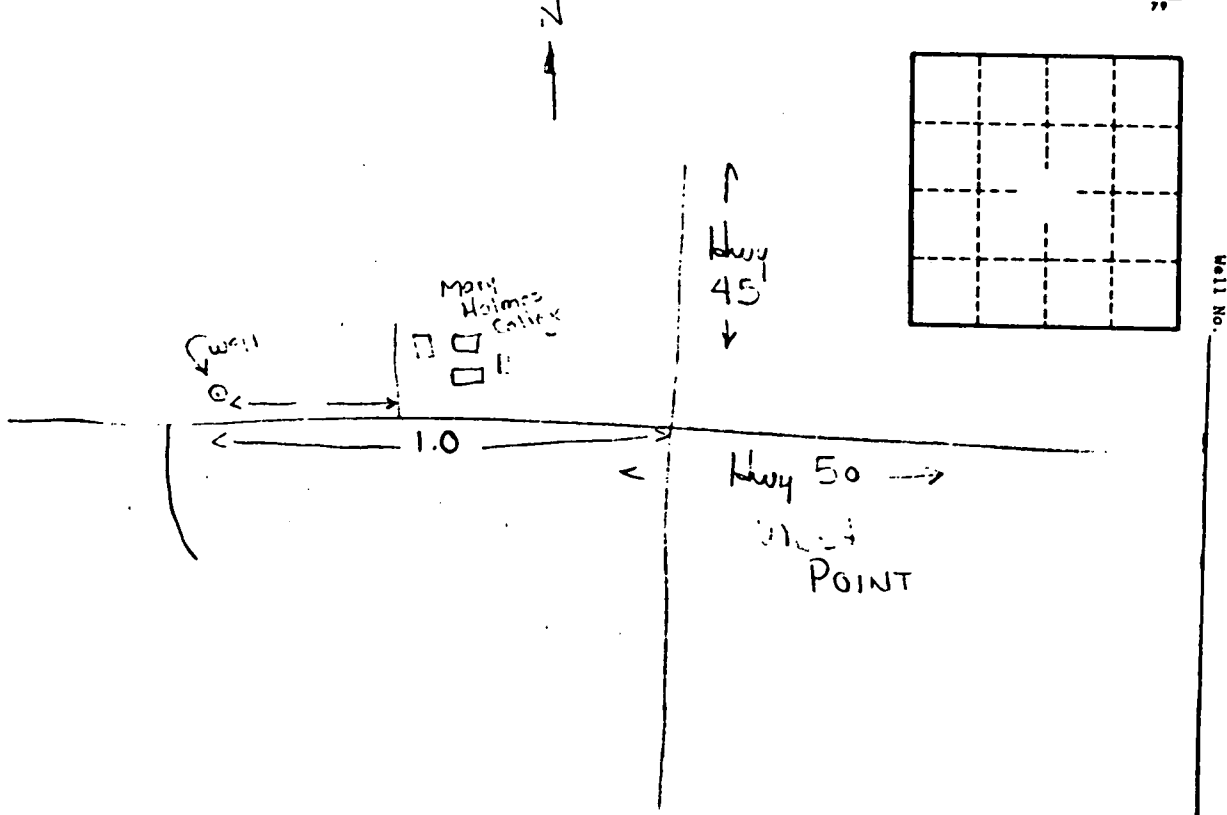

West Point Quads

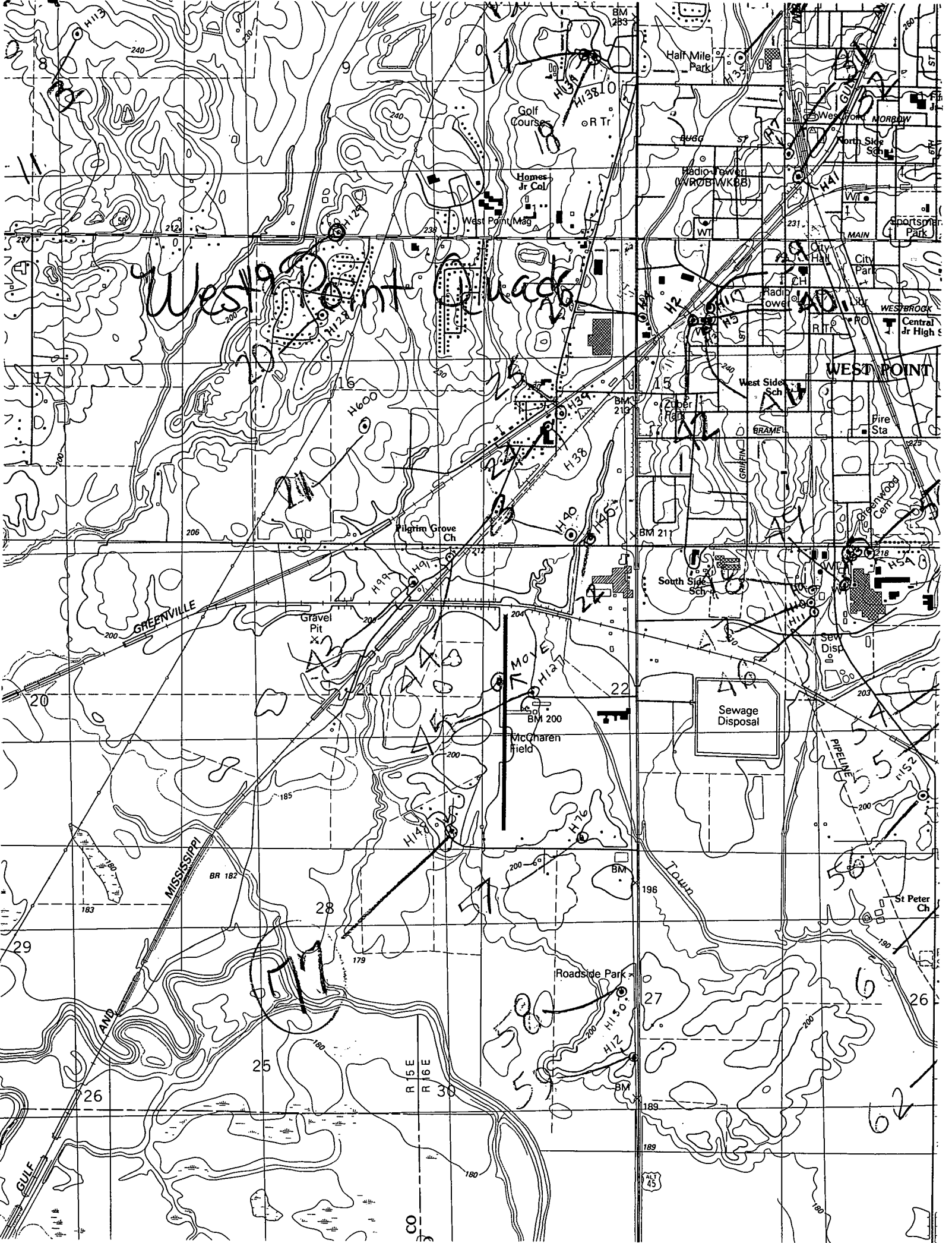

62