

WELL SCHEDULE

Elog #42

U. S. DEPT. OF THE INTERIOR

GEOLOGICAL SURVEY

WATER RESOURCES DIVISION

MASTER CARD

Record by J.A. [unclear] Source of data Wells Date 12-1-89 Map _____

State IL County (or town) Chgo Sequential number: 19

Latitude: 41° 17' 5" N Longitude: 87° 51' 51" W

Lat-long accuracy: 2 sec

Local well number: H127CB2217S06E Other number: _____

Local use: _____ Owner or name: WASTE P. [unclear] Address: _____

Ownership: County, Fed Gov't, City, Corp or Co, Private, State Agency, Water Dist _____

Use of water: (A) Air cond, Bottling, Comm, Dewater, Power, Fire, Dom, Irr, Med, Ind, P S, Rec, (S) Stock, (T) Instit, (U) Unused, (V) Repressure, (W) Recharge, (X) Desal-P S, (Y) Desal-other, (Z) Other _____

Use of well: (A) Anode, (D) Drain, (G) Seismic, (H) Heat Res, (O) Obs, (P) Oil-gas, (R) Recharge, (T) Test, (U) Unused, (W) Withdraw, (X) Waste, (Z) Destroyed _____

DATA AVAILABLE: Well data Freq. W/L meas.: _____ Field aquifer char. _____

Hyd. lab. data: _____

Qual. water data; type: _____

Freq. sampling: _____ Pumpage inventory: _____

Log data: E 10" - 7" - 5" - 10"

WELL-DESCRIPTION CARD

SAME AS ON MASTER CARD

Depth well: _____ ft Meas. accuracy: _____

Depth cased: _____ ft Casing type: _____; Diam. _____ in

Finish: (C) porous concrete, (F) gravel w. concrete, (G) gravel w. (perf.), (H) gravel w. (screen), (O) horiz. gallery, (P) open end, (S) perf., (T) screen, (W) sd. pt., (X) shored, (Z) open hole, other _____

Method: (A) air bored, (B) cable, (C) dug, (D) hyd jetted, (H) rot., (J) air percussion, (P) reverse, (R) air reverse, (T) trenching, (U) driven, (V) wash, (W) drive wash, (Z) other _____

Date Drilled: 9-7-83 Pump intake setting: _____ ft

Driller: _____ name _____ address _____

Lift (type): (A) air, (B) bucket, (C) cent., (J) jet, (L) multiple, (M) multiple, (N) none, (P) piston, (R) rot., (S) submerg, (T) turb., other _____ Deep _____ Shallow _____

Power (type): diesel, elec, gas, gasoline, hand, LP, gas, wind, H.P. _____ Trans. or meter no. _____

Descrip. MP OK (12/89) ft above _____ below LSD, Alt. MP _____

Alt. LSD: 200 Accuracy: _____

Water Level: _____ ft above _____ below MP; _____ ft below LSD Accuracy: _____

Date meas: _____ Yield: _____ gpm Method determined _____

Drawdown: _____ ft Accuracy: _____ Pumping period _____ hrs

QUALITY OF WATER DATA: Iron _____ ppm Sulfate _____ ppm Chloride _____ ppm Hard. _____ ppm

Sp. Conduct _____ K x 10⁶ Temp. _____ °F Date sampled _____

Tas:e, color, etc. _____

Well No. _____

Latitude-longitude _____
d m s N
d m s S

HYDROGEOLOGIC CARD

SAME AS ON MASTER CARD Physiographic Province: 03 Section: _____

D Drainage Basin: 131E Subbasin: _____

(D) (C) (E) (F) (R) (K) (L)
Topo of well site: depression, stream channel, dunes, flat, hilltop, sink, swamp,
(Ø) (P) (S) (T) (U) (V)
offshore, pediment, hillside, terrace, undulating, valley flat _____

MAJOR AQUIFER: _____ system _____ series _____ aquifer, formation, group _____

Lithology: _____ Origin: _____ Aquifer Thickness: _____ ft

Length of well open to: _____ ft Depth to top of: _____ ft

MINOR AQUIFER: _____ system _____ series _____ aquifer, formation, group _____

Lithology: _____ Origin: _____ Aquifer Thickness: _____ ft

Length of well open to: _____ ft Depth to top of: _____ ft

Intervals Screened:

Depth to consolidated rock: _____ ft _____ Source of data: _____

Depth to basement: _____ ft _____ Source of data: _____

Surficial material: _____ Infiltration characteristics: _____

Coefficient Trans: _____ gpd/ft _____ Coefficient Storage: _____

Coefficient Perm: _____ gpd/ft²; Spec cap: _____ gpm/ft; Number of geologic cards: _____

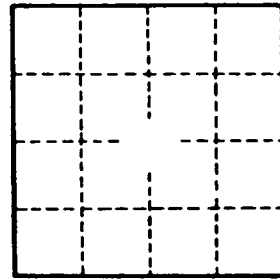
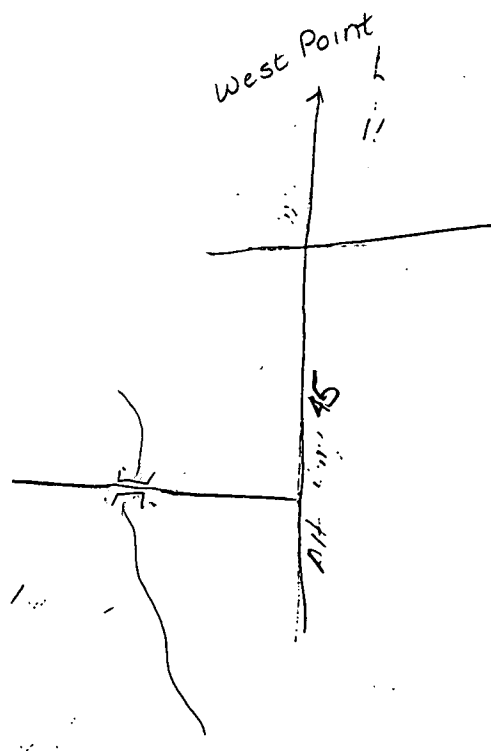

Well No. _____

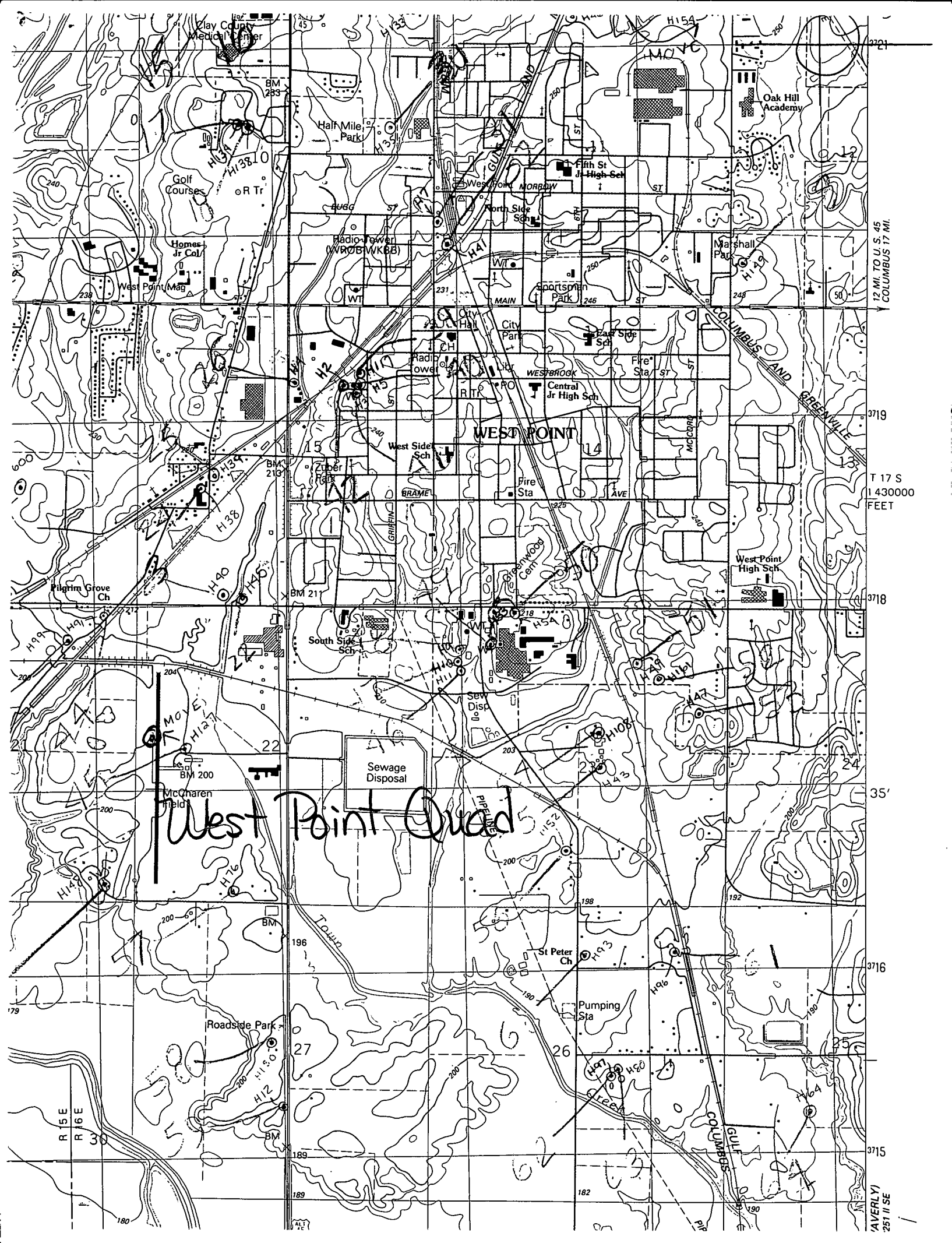

West Point Quad

12 MI TO U.S. 45
COLUMBUS 17 MI.

T 17 S
1430000
FEET

35'

1/4
AVERLY
251 11 SE