

Clay

45A

Churchhill Rd - Tiber Rd → Miller Pw. H 108

FORM 9-1642 (1-68)

Well No.

WELL SCHEDULE
GEOLOGICAL SURVEY

Elog # 49 UNCHED

WATER RESOURCES DIVISION

FILE COPY

MASTER CARD

Record by WTO Source of data MSGs Date 2/73 Map _____

State Miss 28 County (or town) CLAY 13

Latitude: 33³ 51¹¹ N Longitude: 08⁸ 38²² Sequential number: 1

Lat-long accuracy: 2⁰ 17⁰ S 6⁰ W Sec 23 SW SW NE B & M

Local well number: H108CA2317S06E Other number: _____

Local use: 106041 Owner or name: MILLER BROS Miller Bros Dairy Co. 1975 sold out

Address: West Point

Ownership: County, Fed Gov't, City, Corp or Co, Private, State Agency, Water Dist N

Use of water: (A) Air cond, Bottling, Comm, Dewater, Power, Fire, Dom, Irr, Med, Ind, P S, Rec, (S) Stock, (T) Instat, (U) Unused, (V) Repressure, (W) Recharge, (X) Desal-P S, (Y) Desal-other, (Z) Other N

Use of well: (A) Anode, (D) Drain, (G) Seismic, (H) Heat Res, (I) Obs, (J) Oil-gas, (K) Recharge, (L) Test, (M) Unused, (N) Withdraw, (O) Waste, (P) Destroyed. W

DATA AVAILABLE: Well data Freq. W/L meas.: Field aquifer char.

Hyd. lab. data: _____

Qual. water data; type: _____

Freq. sampling: Pumpage inventory: yes no; period: _____

Aperture cards: _____ yes

Log data: Elog 10' 402' DE

WELL-DESCRIPTION CARD

SAME AS ON MASTER CARD Depth well: _____ ft 402 Meas. 3

Depth cased: (first perf.) _____ ft 255 Casing type: _____; Diam. 6x4 in 6

Finish: porous concrete, gravel w. (perf.), gravel w. (screen), horiz. gallery, open end, perf., screen, sd. pt., shored, open hole, other P

Method Drilled: (A) air bored, (B) cable, (C) dug, (D) hyd jetted, (E) air reverse, (F) trenching, (G) driven, (H) drive wash, (I) other H

Date Drilled: 1-31-73 973 Pump intake setting: _____ ft _____

Driller: H. ECHOLS address _____

Lift (type): (A) air, (B) bucket, (C) cent, (D) jet, (E) multiple, (F) multiple, (G) none, (H) piston, (I) rot, (J) submerg, (K) turb, (L) other T Deep Shallow

Power (type): diesel, elec, gas, gasoline, hand, gas, wind; H.P. 2 T Trans. or meter no. _____

Descrip. MP _____ ft above below LSD, Alt. MP _____

Alt. LSD: _____ 222 Accuracy: (source) topo 3

Water Level 172.0 ft above below MP; Ft below LSD 130 Accuracy: _____ D

Date meas: 173-10/16/78 273 Yield: _____ gpm 23 Method determined _____

Drawdown: _____ ft Accuracy: _____ hrs _____

QUALITY OF WATER DATA: Iron _____ ppm Sulfate _____ ppm Chloride _____ ppm Hard. _____ ppm

Sp. Conduct _____ K x 10⁶ Temp. _____ °F Date sampled _____

Taste, color, etc. _____

Contact Jack Miller 494-2786 8/21/87 @ 104

14/78 WL=173

185 13.1 171.9 1.5 170.4 11/30/82 178 12/1/82

1108 open hole No pump. Pump remove 5 yrs ago.

Well No. _____

Latitude-longitude _____
d m s N S

HYDROGEOLOGIC CARD

SAME AS ON MASTER CARD

Physiographic Province: _____

03 Section: _____

D Drainage Basin: _____

13E Subbasin: _____

(D) (C) (E) (F) (H) (K) (L)
Topo of depression, stream channel, dunes, flat, hilltop, sink, swamp,
well site: (Ø) (P) (S) (T) (U) (V)
offshore, pediment, hillside, terrace, undulating, valley flat _____

MAJOR AQUIFER: _____

K3 system _____ series _____

EZ aquifer, formation, group _____

Lithology: _____

5 Origin: _____

6 Aquifer Thickness: _____ ft

Length of well open to: _____ ft

Depth to top of: _____ ft

MINOR AQUIFER: _____

_____ system _____ series _____

_____ aquifer, formation, group _____

Lithology: _____

_____ Origin: _____

_____ Aquifer Thickness: _____ ft

Length of well open to: _____ ft

Depth to top of: _____ ft

Intervals Screened: _____

Depth to consolidated rock: _____ ft

_____ Source of data: _____

Depth to basement: _____ ft

_____ Source of data: _____

Surficial material: _____

_____ Infiltration characteristics: _____

Coefficient Trans: _____ gpd/ft

_____ Coefficient Storage: _____

Coefficient Perm: _____ gpd/ft²; Spec cap: _____

_____ gpm/ft; Number of geologic cards: _____

47' 6"

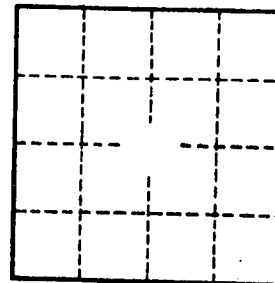

Well No. _____

U.S. DEPT. OF INTERIOR
GEOLOGICAL SURVEY
WATER RESOURCES DIVISION
GROUND WATER SITE INVENTORY
WATER-LEVEL DATA

Barber
Miller
C.
(Bella Maria Food Co.)

WELL NO. H108
MP HEIGHT _____

Miller Brothers

Clay County

Site Ident. No. 5 _____ 19

R - 234 * T - A *

DATE	WATER LEVEL (BELOW LSD)	STATUS	METHOD	HOLD	CUT	DEPTH BELOW MP	REMARKS	DATE PUNCHED	DATE ENTERED
235 # 12/01/1982	237 - 86.14	238 - *	239 - *						
235 # / / *	237 -	238 - *	239 - *				<i>per GWSI file</i>		
235 # 0.4/0.1/19.76 *	237 - 170.00	238 - *	239 - *						
235 # / / *	237 -	238 - *	239 - *						
235 # 1.0/1.6/19.78 *	237 - 173.00	238 - *	239 - *						
235 # / / *	237 -	238 - *	239 - *						
235 # 1.1/3.0/19.82 *	237 - 170.40	238 - *	239 - *						
235 # 1.2/0.1/19.82 *	237 - 178.00	238 - *	239 - *						
235 # / / *	237 -	238 - *	239 - *						
235 # 0.8/1.9/19.87 *	237 - NO MEASUREMENT	238 - *	239 - *				<i>MR. JACK MILLER - OWNER, NOT @ home</i>		
235 # / / *	237 -	238 - *	239 - *				<i>to get key to unlock house.</i>		
235 # 1.0/2.9/19.87 *	237 - N.O.M.E.A.	238 - SPENT	239 - 30 MIN TRYING TO				<i>OPEN HOLE TAPE KEPT</i>		
235 # / / *	237 -	238 - *	239 - *				<i>HANG UP ON 44D - EVEN W/220Z WEIGHT ON</i>		
235 # / / *	237 -	238 - *	239 - *				<i>END OF TAPE</i>		
235 # / / *	237 -	238 - *	239 - *						
235 # / / *	237 -	238 - *	239 - *						
235 # / / *	237 -	238 - *	239 - *						
235 # / / *	237 -	238 - *	239 - *						
235 # / / *	237 -	238 - *	239 - *						
235 # / / *	237 -	238 - *	239 - *						
235 # / / *	237 -	238 - *	239 - *						
235 # / / *	237 -	238 - *	239 - *						
235 # / / *	237 -	238 - *	239 - *						
235 # / / *	237 -	238 - *	239 - *						
235 # / / *	237 -	238 - *	239 - *						
235 # / / *	237 -	238 - *	239 - *						
235 # / / *	237 -	238 - *	239 - *						
235 # / / *	237 -	238 - *	239 - *						
235 # / / *	237 -	238 - *	239 - *						
235 # / / *	237 -	238 - *	239 - *						

Method of Measurement

239 = A C E G H L M R S T V Z
 airline, calibrated, estimated, pressure, calibrated, geophysical, manometer, reported, steel, electric, calibrated other
 airline pressure gage pressure gage logs tape tape electric tape

Site Status

238 = D E F G H Ø P R S T V X Z
 dry, flowed recently, flowing, nearby, flowing, nearby, obstruction, pumping, recently, nearby, recently, nearby, foreign, surface-water, other
 recently, flowing, recently, pumped, pumped, pumped, recently, substances, effect

CLAY Co
 H108
 Log # 41

MISSISSIPPI
 BOARD OF WATER COMMISSIONERS
 416 North State Street
 Jackson, Mississippi 39201

CODED

WATER WELL DRILLERS LOG
 HERMAN ECHOLS



Pump & Well Service

316 ROME, Miss.

Clay

county well located

2/9/73
 date well completed

1973

Phone: 323-5111

LANDOWNER:

Miller Bros

description of formations encountered

Electrolog by State

from to

West Point Miss
 (mailing address)

Sandy clay
 fine siltstone
 sand

6" casing 147'

WELL LOCATION:

sec 23 T 17 N R 16 E

1 miles South of West Point
 (distance) (direction) (nearest town)

WELL PURPOSE:

(home, irrigation, municipal, industrial)

WELL COMPLETION DATA:

- (1) diameter (inches) 6"
- (2) total depth (feet) 402
- (3) static water level (feet) 130 below top of ground.

Note: 360' 4" casing (material) 6" (depth) bottom casing (size) If telescope see back.

- (5) screen (length) (depth to top)

- (6) pump 2 (HP) 23 (yield gpm)

Electric (type power)

- (7) electric log YES (yes or no)

State (organization running log)

- (8) how well bottom plugged

DRILLERS REMARKS:

NOTE: 147' slotted pipe in sand 6 slots per foot on 7" pipe

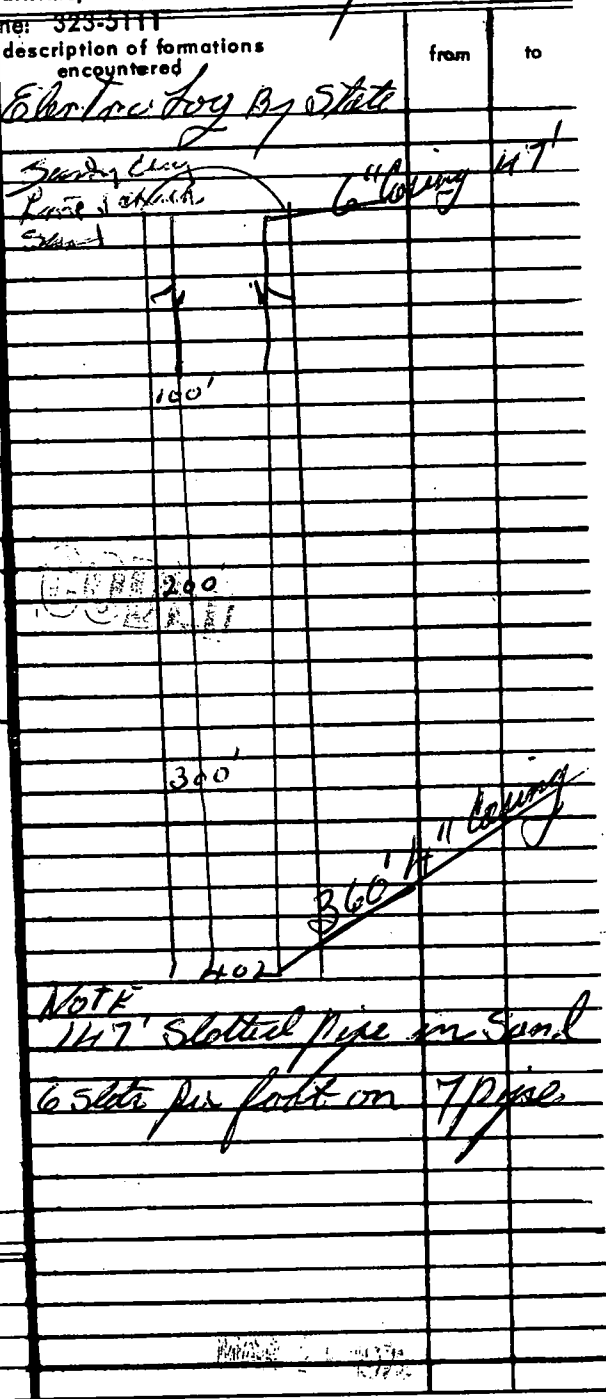

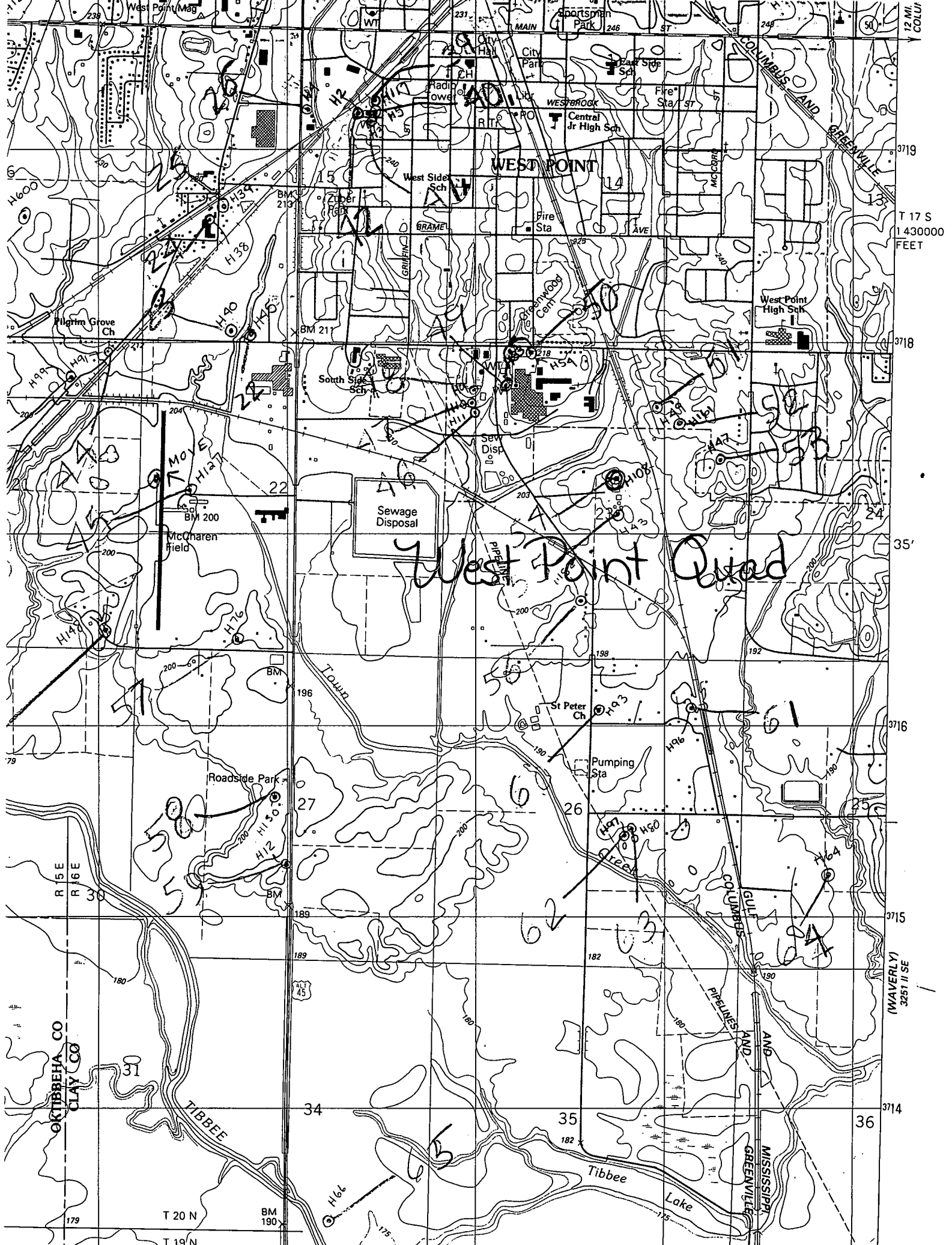

West Point Qued

61

62

63

64

12 MI. COLU
T 17 S
1430000
FEET

35'

3716

3715

3714

(WAVERLY)
3251 II SE

T 20 N
T 19 N
BM 190

OCTOBERHA CO
CLAY CO

West Point Mag
Sportsman Park
MAIN ST
COLUMBUS AND GREENWILLE

