

FORM 9-1642 (1-68)

Well No. H96

WELL SCHEDULE

U. S. DEPT. OF THE INTERIOR

GEOLOGICAL SURVEY

WATER RESOURCES DIVISION

PUNCHED

JAN 24 1973

MASTER CARD

Record by ACM Source of data BOWC Date 10-71 Map _____

State 28 County (or town) Clay 13

Latitude: 33^{deg} 34^{min} 28^{sec} N Longitude: 08^{degrees} 8^{min} 38^{sec} W Sequential number: 1

Lat-long Accuracy: 1 T. 17 R. 6 Sec 26 NE, SW, NE, NE

Local well number: H096AA2617506E Other number: _____

Local use: 106 Owner or name: PEARL JOHNSON Address: West Point

Ownership: County, Fed Gov't, City, Corp or Co, Private, State Agency, Water Dist P

Use of water: (A) Air cond, Bottling, Comm, Dewater, Power, Fire, Dom, Irr, Med, Ind, P S, Rec, (S) Stock, Instit, Unused, Repressure, Recharge, Desal-P S, Desal-other, Other H

Use of well: (A) Anode, Drain, Seismic, Heat Res, Obs, Oil-gas, Recharge, Test, Unused, Withdraw, Waste, Destroyed. W

DATA AVAILABLE: Well data Freq. W/L meas.: Field aquifer char.

Hyd. lab. data: _____

Qual. water data; type: _____

Freq. sampling: _____ Pumpage inventory: yes no; period: _____

Aperture cards: _____ yes

Log data: _____ D

WELL-DESCRIPTION CARD

SAME AS ON MASTER CARD Depth well: 275 ft Meas. rept accuracy 3

Depth cased: (first perf.) 21 ft Casing type: _____; Diam. 4 in

Finish: (C) porous concrete, (F) gravel w. (G) gravel w. (H) horiz. (Ø) open perf., (P) screen, (S) sd. pt., (T) shored, (W) open hole, (X) other X

Method: (A) air, (B) bored, (C) cable, (D) dug, (H) hyd, (J) jetted, (P) air percussion, (R) reverse, (T) trenching, (V) driven, (W) drive wash, (Ø) other H

Date Drilled: 971 Pump intake setting: _____ ft

Driller: Echols

Lift (type): (A) air, (B) bucket, (C) cent, (J) jet, (L) multiple, (M) multiple, (N) none, (P) piston, (R) rot, (S) submerg, (T) turb, other Deep Shallow 40

Power (type): diesel, ex gas, gasoline, hand, gas, wind; H.P. 1 Trans. or meter no. 5

Descrip. MP _____ ft above below LSD, Alt. MP _____

Alt. LSD: 200 Accuracy: (source) _____

Water Level: _____ ft above below MP; _____ ft above below LSD 80 Accuracy: _____

Date meas: 871 Yield: _____ gpm 4 Method determined _____

Drawdown: _____ ft Accuracy: _____ Pumping period _____ hrs _____

QUALITY OF WATER DATA: Iron _____ ppm Sulfate _____ ppm Chloride _____ ppm Hard. _____ ppm

Sp. Conduct _____ K x 10⁶ Temp. _____ °F Date sampled _____

Taste, color, etc. _____

Well No.

H96

Well No. _____

Latitude-longitude N
S
d m s d m s

HYDROGEOLOGIC CARD

PHONIX CARD 19 Physiographic Province: _____ Section: _____
20 21

ETER A S NAL Drainage Basin: **13E** Subbasin: _____
23 25 26

Topo of well site: (C) (E) (F) (H) (K) (L) depression, stream channel, dunes, flat, hilltop, sink, swamp,
(O) (P) (S) (T) (U) (V) offshore, pediment, hillside, terrace, undulating, valley flat _____ 27

MAJOR AQUIFER: _____ system _____ series **K3** _____ aquifer, formation, group **E2**
28 29 30 31

Lithology: _____ Origin: **6** Aquifer Thickness: **126** ft
32 33 34

Length of well open to: _____ ft **126** Depth to top of: _____ ft **149**
35 37 38 39

MINOR AQUIFER: _____ system _____ series _____ aquifer, formation, group _____
44 45 46 47

Lithology: _____ Origin: _____ Aquifer Thickness: _____ ft
48 49 50

Length of well open to: _____ ft _____ Depth to top of: _____ ft _____
51 53 54 55 57 59

Intervals Screened: none

Depth to consolidated rock: _____ ft _____ Source of data: _____
60 61 62 64

Depth to basement: _____ ft _____ Source of data: _____
65 66 67 69

Surficial material: _____ Infiltration characteristics: _____
70 71 72

Coefficient Trans: _____ gpd/ft _____ Coefficient Storage: _____
73 74 75 76 78

Coefficient Perm: _____ gpd/ft²; Spec cap: _____ gpm/ft; Number of geologic cards: _____
77 79

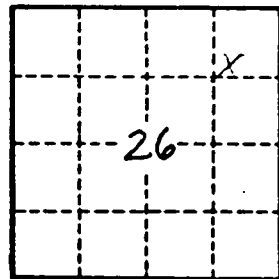

Well No.

H 96

Clay
H 98
8-71

MISSISSIPPI
BOARD OF WATER COMMISSIONERS
416 North State Street
Jackson, Mississippi 39201

WATER WELL DRILLERS LOG

CODED

date well completed 19 71



HERMAN ECHOLS
Pump & Well Service

county well located

LANDOWNER: 730 E. 11th St
PEARL JOHNSON
West Point
(mailing address)

Starkville, Miss. Phone: 323-5111	form	to
encountered		
<u>Sandy & clay</u>	<u>0</u>	<u>18</u>
<u>Chalk</u>	<u>18</u>	<u>149</u>
<u>Sand</u>	<u>149</u>	<u>273</u>

WELL LOCATION:
sec. 26 T. 17 N. R. 16 E.
(S) (W)
miles of
(distance) (direction) (nearest town)

WELL PURPOSE: IRRIGATOR
(home, irrigation, municipal, industrial)

- WELL COMPLETION DATA:
- (1) diameter (inches) 4"
 - (2) total depth (feet) 276
 - (3) static water level (feet) 86 below above top of ground.
 - (4) casing 2 1/2" 4"
(material) (depth)
 - if telescope see back.
(size)
 - (5) screen
(length) (depth to top)
 - (size) (material)
 - (6) pump 1 4
(HP) (yield gpm)
 - Electric
(type power)
 - (7) electric log
(yes or no)
 - (organization running log)
 - (8) how well bottom plugged

CODED

OCT 14 1971

DRILLERS REMARKS:

MISS. Bd. of
Water Comm.

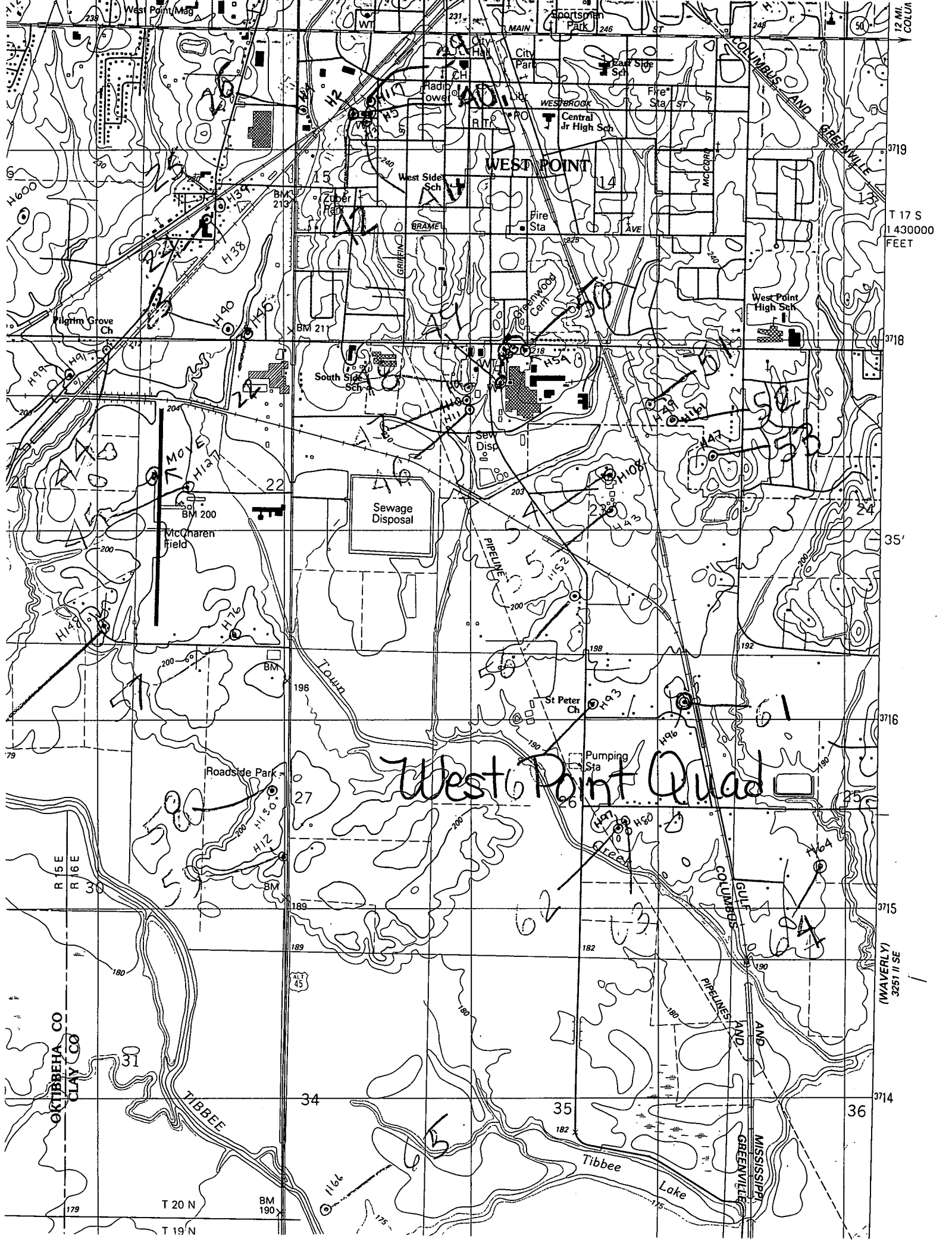

T 17 S
1430000
FEET

35'

3716

3715

3714

(WAVERLY)
3257 1/2 SE

West Point Quad

62

