

Wkd Exp. (GW)
April 1966

Well No. H 50

WELL SCHEDULE
GEOLOGICAL SURVEY

E 109 # 24

PUNCHED

U. S. DEPT. OF THE INTERIOR

WATER RESOURCES DIVISION

JAN 24 1973

MASTER CARD BEW... 10-17-67

Record: TYPE 2 location of data Source of Data ... Date 7-8-67 Map

State Miss. County (or town) Clay 13

Latitude: 33° 37' 23" N Longitude: 90° 38' 28" W Sequential number: 19

Lat-long accuracy: 1 T. 17 S. R. 6 W. Sec. 2 SW 1/4, SW 1/4, SE 1/4

Local well number: H 0 5 C C D D 0 2 1 7 5 0 0 0 Other number: B & M

Local use: 009.024 Owner or name: City of West Point

Owner or name: WEST POINT Address: Industrial Park

Ownership: County, Fed Gov't, City, Corp or Co, Private, State Agency, Water Dist 7

Use of Air cond, bottling, Comm, Dewater, Power, Fire, Dum, Irr, Med, Ind, P S, Rec, water: (S) (T) (U) (V) (W) (X) (Y) (Z) U

Use of well: (A) (D) (G) (H) (I) (P) (R) (T) (U) (W) (X) (Z) 4

DATA AVAILABLE: Well data Freq. W/L meas.: 4 Field aquifer char.

Hyd. lab. data:

Qual. water data; type:

Freq. sampling: Pumpage inventory: no. period:

Aperture cards: yes

Log data: F 24 1 F

WELL-DESCRIPTION CARD

SAME AS ON MASTER CARD Depth well: 515 Meas. 5 ft 24

Depth cased: (first perf.) 75.2 Casing type: steel Diam. 3 in 30

Finish: porous gravel w. concrete, (F) gravel w. (C) horz. (H) open (O) perf., (P) screen, (S) sd. pt., (T) shored, (X) open hole, (Z) other 31

Method (A) (B) (C) (D) (H) (J) (P) (R) (T) (V) (W) (Z) 37

Drilled: air bored, cable, dug, hyd, jetted, air reverse trenching, driven, drive wash, percussion, rotary, other 37

Date Drilled: July 1963 9.6 Pump intake setting: 235 ft 30

Driller: ...

Lift (type): (A) air, (B) bucket, (C) cent, (J) jet, (L) multiple, (M) multiple, (N) none, (P) piston, (R) rot, (S) submerg, (T) turb, (Z) other N Deep Shallow

Power (type): diesel, elec, gas, gasoline, hand, gas, wind, H.P. Trans. or meter no.

Descrip. ... ft above 1 below LSD. Alt. MP 245 (10/92) Accuracy: 240 47

Water Level 27.33 ft above 1 below MP; Ft below LSD 48 Accuracy: 52

Date meas: 10-30-63 0.63 Yield: ... gpm 60 Method determined 61

Drawdown: ... ft 62 Accuracy: 63 Pumping period 64 hr 65

QUALITY OF WATER DATA: Iron ... ppm 69 Sulfate ... ppm 70 Chloride ... ppm 71 Hard. ... ppm 72

Sp. Conduct ... K x 10⁶ 73 Temp. ... °F 74 Date sampled ... 75

Taste, color, etc. 76

TRANSMITTED FOR ADP.

Well No.

PUNCHED

Well No. 400

Latitude-longitude 33 37 22 ^N 088 32 28
d m s d m s

HYDROGEOLOGIC CARD

19 SAME AS ON MASTER CARD 20 Physiographic Province: 03 Section: _____

22 Drainage Basin: 131E 25 Subbasin: _____ 26

Topo of well site: (D) depression, stream channel, dunes, (E) flat, hilltop, sink, swamp, (F) flat, (H) hilltop, (K) sink, (L) swamp, (P) offshore, pediment, hillside, terrace, undulating, valley flat, (S) offshore, pediment, hillside, terrace, undulating, valley flat, (T) offshore, pediment, hillside, terrace, undulating, valley flat, (U) offshore, pediment, hillside, terrace, undulating, valley flat, (V) offshore, pediment, hillside, terrace, undulating, valley flat. 27

MAJOR AQUIFER: _____ system _____ series K3 _____ aquifer, formation, group 54

Lithology: UR Origin: 2 Aquifer Thickness: _____ ft

Length of well open to: _____ ft _____ Depth to top of: _____ ft _____

MINOR AQUIFER: _____ system _____ series _____ aquifer, formation, group _____

Lithology: _____ Origin: _____ Aquifer Thickness: _____ ft

Length of well open to: _____ ft _____ Depth to top of: _____ ft _____

Intervals Screened: 783-802 201-220 220-235

Depth to consolidated rock: _____ ft _____ Source of data: _____ 64

Depth to basement: _____ ft _____ Source of data: _____ 69

Surficial material: _____ Infiltration characteristics: _____ 72

Coefficient Trans: _____ gpd/ft 135 Coefficient Storage: _____ 76

Coefficient Perm: _____ gpd/ft²; Spec cap: _____ gpm/ft; Number of geologic cards: _____ 79

1.0 x 10⁻⁴
See sketch on H46

Sketch on H46

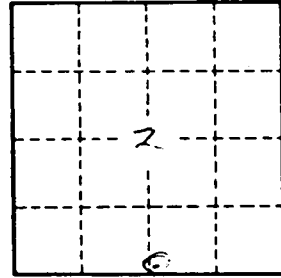

Well No. _____

WEST POINT QUADRANGLE
MISSISSIPPI

7.5 MINUTE SERIES (TOPOGRAPHIC)

SW/4 WEST POINT 15' QUADRANGLE

3251 II NE
(STRONG)

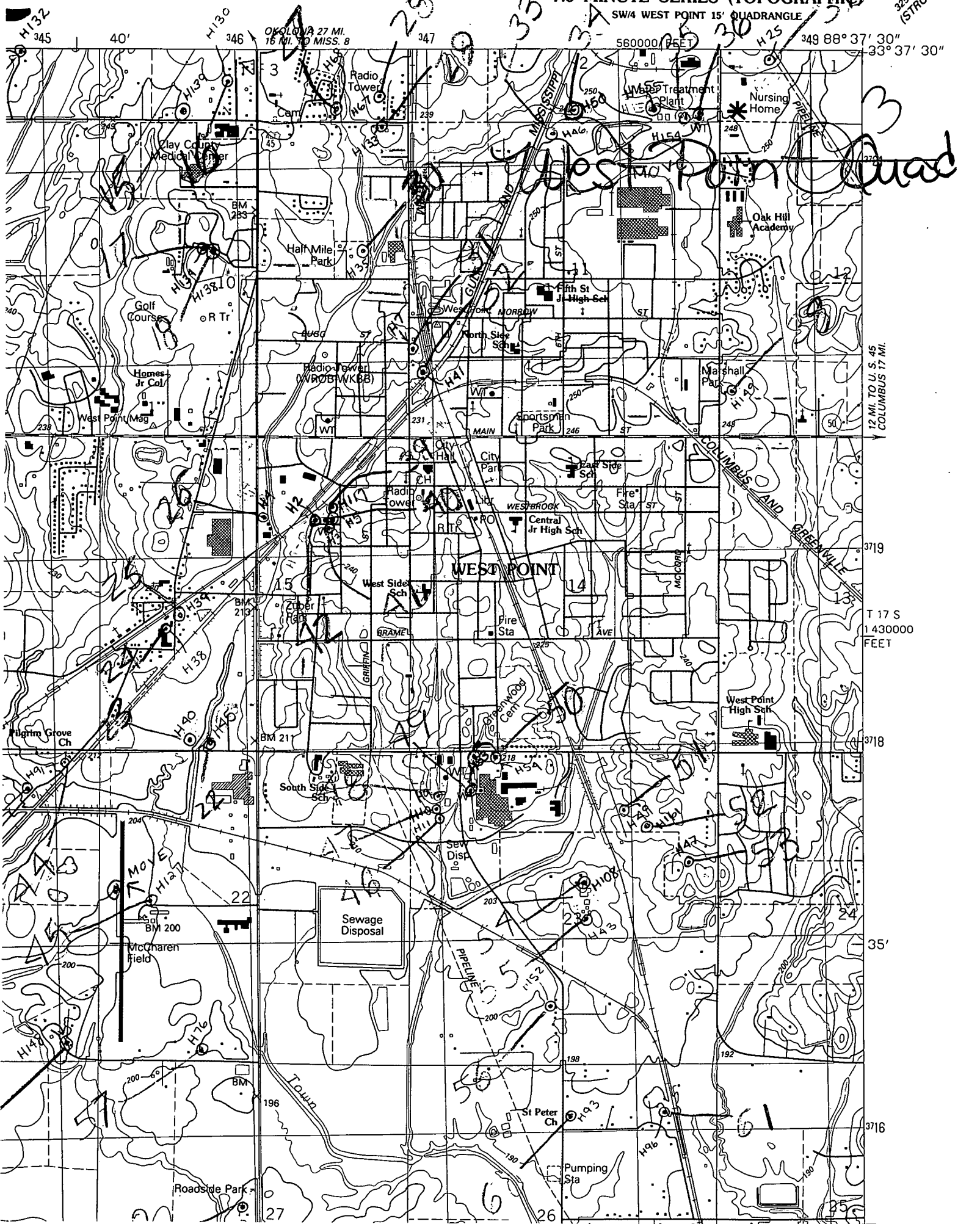

H132
345

40'

H130
346

OKOLOJA 27 MI.
16 MI. TO MISS. 8

347

560000 FEET

H125

349 88° 37' 30"

33° 37' 30"

12 MI. TO U. S. 45
COLUMBUS 17 MI.

3719

T 17 S
1430000
FEET

3718

35'

3716

H140
H138

H137
H136

H142
H141

Roadside Park

Sewage Disposal

PIPELINE

St Peter Ch

Pumping Sta

Clay County Medical Center

Golf Courses

Homes Jr Col

Hilghm Grove Ch

McCharen Field

Highm Grove Ch

Radio Tower

Radio Tower

South Side Sch

Sew Disposal

Roadside Park

Radio Tower

Radio Tower

South Side Sch

Sew Disposal

Roadside Park

Waste Treatment Plant

Radio Tower

South Side Sch

Sew Disposal

Roadside Park

Waste Treatment Plant

Radio Tower

South Side Sch

Sew Disposal

Roadside Park

Nursing Home

Radio Tower

South Side Sch

Sew Disposal

Roadside Park

Nursing Home

Radio Tower

South Side Sch

Sew Disposal

Roadside Park

Clay County Medical Center

Golf Courses

Homes Jr Col

Hilghm Grove Ch

McCharen Field

Highm Grove Ch

Radio Tower

Radio Tower

South Side Sch

Sew Disposal

Roadside Park

Radio Tower

Radio Tower

South Side Sch

Sew Disposal

Roadside Park

Waste Treatment Plant

Radio Tower

South Side Sch

Sew Disposal

Roadside Park

Waste Treatment Plant

Radio Tower

South Side Sch

Sew Disposal

Roadside Park

Nursing Home

Radio Tower

South Side Sch

Sew Disposal

Roadside Park

Nursing Home

Radio Tower

South Side Sch

Sew Disposal

Roadside Park

Clay County Medical Center

Golf Courses

Homes Jr Col

Hilghm Grove Ch

McCharen Field

Highm Grove Ch

Radio Tower

Radio Tower

South Side Sch

Sew Disposal

Roadside Park

Radio Tower

Radio Tower

South Side Sch

Sew Disposal

Roadside Park

Waste Treatment Plant

Radio Tower

South Side Sch

Sew Disposal

Roadside Park

Waste Treatment Plant

Radio Tower

South Side Sch

Sew Disposal

Roadside Park

Nursing Home

Radio Tower

South Side Sch

Sew Disposal

Roadside Park

Nursing Home

Radio Tower

South Side Sch

Sew Disposal

Roadside Park