

City of West Point Well #11

494-1432 or 1445

FORM 9-1642 (1-68)

Well No. H46 b

U. S. DEPT. OF THE INTERIOR

WELL SCHEDULE
GEOLOGICAL SURVEY

Σ log #25 **PUNCHED**
WATER RESOURCES DIVISION

PUNCHED
DEC 7 1972
JAN 24 1973

MASTER CARD

Record by Ganthers Source of data D.H. 2 obs. Date 5/25/62 Map _____

State 28 County (or town) 13

Latitude: 33° 37' 12" N Longitude: 088° 38' 46" W Sequential number: 1

Local well number: H046AB117506E Other number: _____

Local use: 09025 Owner or name: WEST POINT Address: _____

Ownership: County, Fed Gov, City, Corp or Co, Private, State Agency, Water Dist M

Use of water: Air cond., Bottling, Comm. Dewater, Power, Fire, Dom., Irr., Ind., P S, Rec. X

Use of well: Anode, Drain, Seismic, Heat Res, Obs, Oil-gas, Recharge, Test, Unused, Withdraw Waste, Destroyed. X

DATA AVAILABLE: Well data Freq. W/L meas.: Field aquifer char.

Hyd. lab. data: _____

Qual. water date; type: USGS 6/27/62

Freq. sampling: _____ Pumps inventory: no. period: _____

Aperture cards: _____

Log data: DE

WELL-DESCRIPTION CARD

SAME AS ON MASTER CARD Depth well: TD: 1350 ft. 810 Meas. 6

Depth cased; (first perf.) 750 ft. Casing type: _____; Diam. 8x6 in. 8

Finish: porous concrete, gravel w. concrete, gravel w. (screen), horis. gallery, open perf., screen, ad. pt., shored, open hole, other 5

Method: air bored, cable, dug, hyd. jetted, air percussion, rotary, reverse trenching, driven, drive wash, other H

Date Drilled: 6/6/62 962 Pump intake setting: _____ ft. 30

Driller: Carlson Memphis

Lift (type): air, bucket, cent, jet, multiple, multiple, none, piston, rot, submerg, turb, other T Deep Shallow

Power (type): diesel, elec, gas, gasoline, hand, gas, wind; H.P. V Trans. or meter no. _____

Descr. MP _____ ft. below LSD, Alt. MP _____

Alt. LSD: 237 Accuracy: (source) 5

Water Level: 2895 ft. above MP; Ft. below LSD 38 Accuracy: _____

Date meas: 7/16/63 Yield: 430 gpm 430 Method determined 4

Drawdown: _____ ft. Accuracy: _____ Pumping period: _____ hrs. 17

QUALITY OF WATER DATA: Iron _____ Sulfate _____ Chloride 8 Hard. _____

Sp. Conduct 105 x 10⁶ Temp. 71 Date sampled 6.6.2

Taste, color, etc. _____

Water Level Data
1/8/82
271.48

Pumpology
4-156
A

HECD 125.0
Cut 17.3
MP 107.7
EIO
105.7
DR/B
BNM
8/11/88
ECU
240

Well No.

52
+188

Observation Well

FILE COPY

County Collins

Well No. H46

33 37 1005 36 46.01

Owner's Name West Point

Location West Point
(town)

1 NE
(miles and direction from center of town)

Other description _____

Depth 810 Diameter 8 Date drilled _____

Formation Shale

Elev. of lsd 240 Recorder Small shaft Stephens "F" S.F. No. 5481-43 10/1/20
Type G-E Clock No. _____

M.P. Top of recorder house floor at 2.10 ft ^{above} below lsd. Date 1963

M.P. _____ at _____ ft ^{above} below lsd. Date _____

M.P. _____ at _____ ft ^{above} below lsd. Date _____

240
58
+182

Special _____

WL ~60 10/5/78

52 (1976)

-48 (1973)

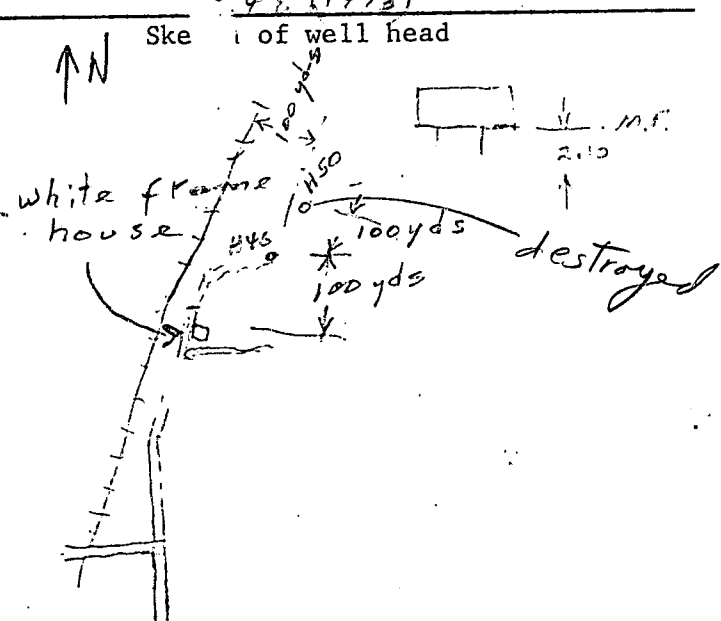
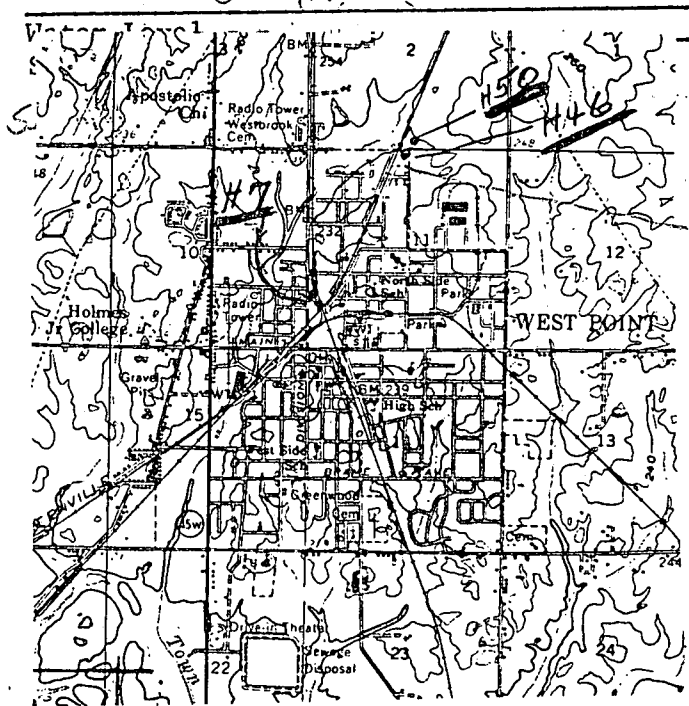

Observation Well

County Clay

Well No. 446

FILE COPY

Owner's Name West Point

Location West Point
(town)

1 mi NE
(miles and direction from center of town)

Other description _____

Depth 810 Diameter 5 Date drilled _____

Formation Shale

Elev. of lsd 200 Recorder Stapions "F" Type E-E class No. _____

M.P. _____ at _____ ft ^{above} below lsd. Date 1923

M.P. _____ at _____ ft ^{above} below lsd. Date _____

M.P. _____ at _____ ft ^{above} below lsd. Date _____

Special _____

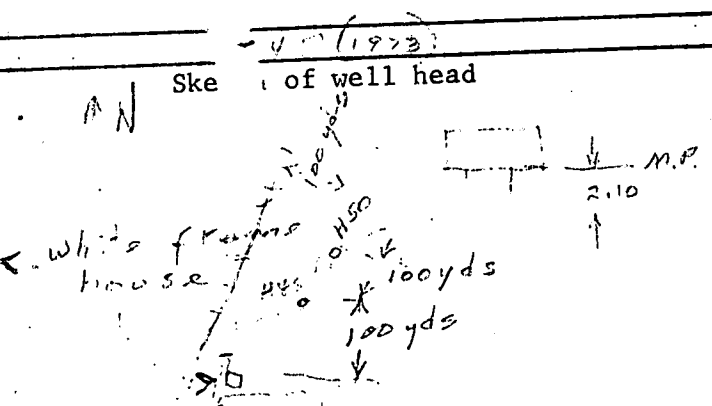
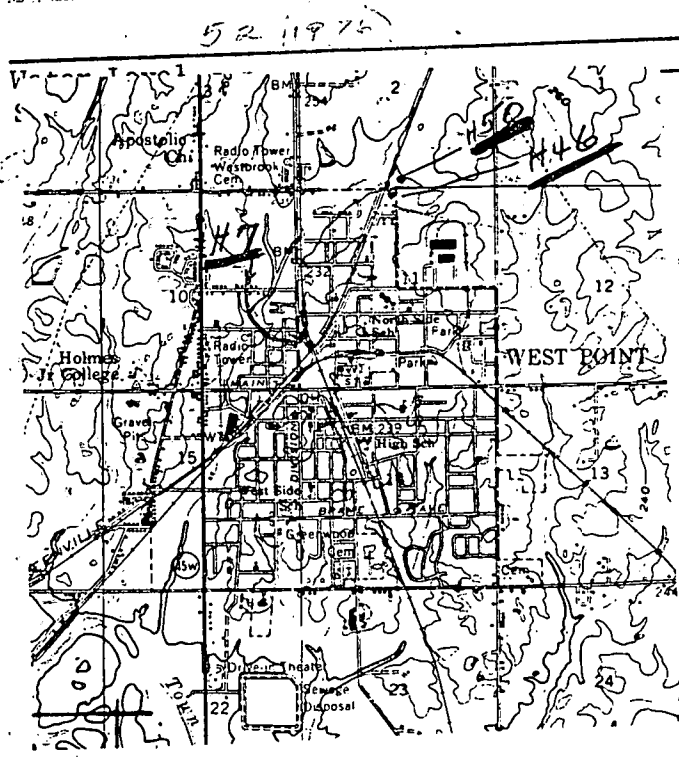

11/18/92
 95.
 - 21.42

 73.58
 - 2.10

 71.48

See back

Recorder on well

U.S. DEPT. OF INTERIOR
GEOLOGICAL SURVEY
WATER RESOURCES DIVISION
GROUND WATER SITE INVENTORY
WATER-LEVEL DATA

WELL NO. HA6
MP HEIGHT _____

Clay County

West Point

Site Ident. No.

--	--	--	--	--	--	--	--	--	--	--	--	--	--	--	--	--	--	--	--	--

 R = 234 * T = A *

DATE	WATER LEVEL (BELOW LSD)	STATUS	METHOD	HOLD	CUT	DEPTH BELOW MP	REMARKS	DATE PUNCHED	DATE ENTERED
11 DATE 1982 08/09/1984 *	237 - 77.48 79.59 *	238 - *	239 - *				entire piezometer ↓		
235 # / / *	237 - . . . *	238 - *	239 - *						
08/28/1985 *	237 - 78.81 *	238 - *	239 - *						
235 # / / *	237 - . . . *	238 - *	239 - *						
07/30/1986 *	237 - 80.25 *	238 - *	239 - *						
235 # / / *	237 - . . . *	238 - *	239 - *						
235 # / / *	237 - . . . *	238 - *	239 - *						
235 # / / *	237 - . . . *	238 - *	239 - *						
235 # / / *	237 - . . . *	238 - *	239 - *						
235 # / / *	237 - . . . *	238 - *	239 - *						
235 # / / *	237 - . . . *	238 - *	239 - *						
235 # / / *	237 - . . . *	238 - *	239 - *						
235 # / / *	237 - . . . *	238 - *	239 - *						
235 # / / *	237 - . . . *	238 - *	239 - *						
235 # / / *	237 - . . . *	238 - *	239 - *						
235 # / / *	237 - . . . *	238 - *	239 - *						
235 # / / *	237 - . . . *	238 - *	239 - *						
235 # / / *	237 - . . . *	238 - *	239 - *						
235 # / / *	237 - . . . *	238 - *	239 - *						
235 # / / *	237 - . . . *	238 - *	239 - *						
235 # / / *	237 - . . . *	238 - *	239 - *						
235 # / / *	237 - . . . *	238 - *	239 - *						

Method of Measurement 239 = A C E G H L M R S T V Z
 airline, calibrated, estimated, pressure, calibrated, geophysical, manometer, reported, steel, electric, calibrated other
 airline pressure gage pressure gage logs tape tape electric tape

Site Status 238 = D E F G H Ø P R S T V X Z
 dry, flowed recently, flowing, nearby, recently flowing, nearby, recently flowing, obstruction, pumping, recently pumped, nearby, recently pumped, foreign, surface-water, other effect

FILE COPY

UNITED STATES
DEPARTMENT OF THE INTERIOR
GEOLOGICAL SURVEY

WATER RESOURCES DIVISION

Report Page No. _____
GROUND WATER BRANCH

COUNTY CLAY

STATE MS

WATER LEVELS IN OBSERVATION WELLS

C-Recorder

333712011384601 H46 CITY OF WEST POINT

Gordo Fm

EW

FILE COPY

Highest water level _____ 19____; lowest _____ 19____
Records available _____ Water level _____

Date	Water level	Date	Water level	Date	Water level	Date	Water level
1979		DEC. 16	70.33	OCT. 19	73.32	OCT. 7	78.61 ✓
AUG. 15	59.41 ✓	1982		NOV. 19	71.32 ✓	DEC. 4	79.37 ✓
NOV. 29	60.41	JAN. 28	70.06 ✓	1984		1986	
1980		MAR. 11	69.91 ✓	JAN. 11	73.70 ✓	JAN. 7	78.59 ✓
JAN. 10	60.60	APR. 22	70.37 ✓	FEB. 23	73.77 ✓	FEB. 26	78.50 ✓
FEB. 14	60.55	JUN. 16	69.83 ✓	APR. 25	73.49 ✓	APR. 3	78.75 ✓
MAR. 25	62.80	AUG. 26	71.51 ✓	APR. 4	74.30 ✓	MAY 13	79.16 ✓
MAY 6	65.70 ✓	OCT. 13	72.07 ✓	JUN. 25	73.86 ✓	JUN 17	79.29 ✓
JUN. 19	66.72	NOV. 18	71.48 ✓	AUG. 9	79.59 ✓	JUL 30	80.25 ✓
JUL. 29	67.78	1983		SEPT. 20	75.15 ✓	SEPT. 3	84.69 ✓
OCT. 22	67.85	JAN. 4	70.66 ✓	DEC. 11	74.92 ✓	OCT. 7	85.87 ✓
DEC. 2	86.69 ✓	FEB. 9	71.10	DEC. 13	75.02 ✓	NOV. 19	85.70 ✓
1981		MAR. 22	71.56 ✓	1985		DEC. 18	83.27 ✓
JAN. 13	69.35	MAY 5	70.99 ✓	JAN. 29	75.88 ✓	1987	
FEB. 25	69.57 ✓	JUN. 16	70.97 ✓	MAR. 6	75.50 ✓	FEB. 19	85.99 ✓
MAY 21	68.80 ✓	JUL. 29	71.61 ✓	APR. 25	74.52 ✓		
JUL. 1	69.90 ✓	AUG. 2	71.15 ✓	MAY 31	75.25 ✓		
SEPT. 23	71.10	SEPT. 13	73.18 ✓	JUL. 9	77.39 ✓		
NOV. 5	70.60 ✓	OCT. 18	73.31 ✓	AUG. 28	78.81 ✓		

9-6-91

Hold
Cut

MP	1.5
WL	

chain link fence around water company

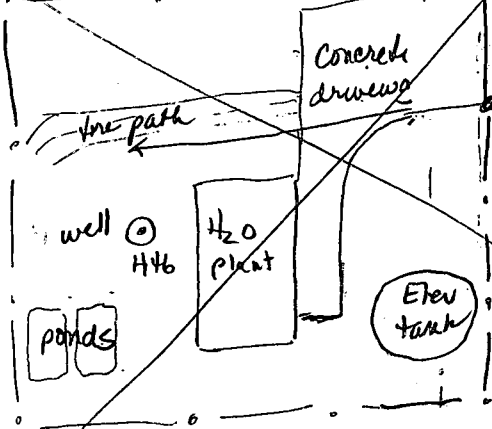

no

Eshman

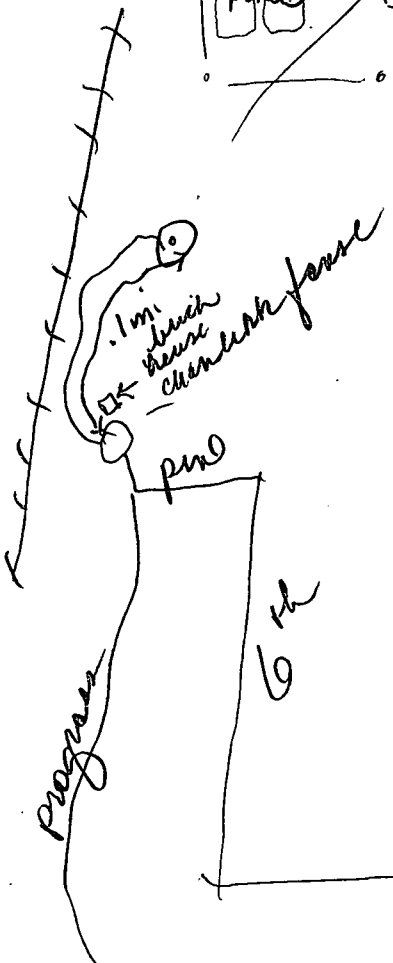

4" sub metal box on concrete base
 Cul-de-sac at N end of Progress St
 down dirt path .1 mi

Half mile