

DOH # 130008-02  
GW1326  
GPS d 4/14/99 AH/MD

West Point  
GW1326

FORM 9-1642  
(1-68)

Well No. H45

WELL SCHEDULE

U. S. DEPT. OF THE INTERIOR

GEOLOGICAL SURVEY

WATER RESOURCES DIVISION

MASTER CARD

Record by Smith Source of data M. Tilman Date 5/3/62 Map WEST POINT

State 28 County (or town) Clay 13

Latitude: 33° 35' 34" N Longitude: 088° 39' 41" W Sequential number: 5

Lat-long accuracy: 3 T. 17 R. 6 Sec. 15 SW. SE

Local well number: H045 DC 15 17 S 06 E Other number: C.F. #5

Local use: 064 063 38 Owner or name:

Owner or name: WEST POINT Address:

Ownership: County, Fed Gov't, City, Corp or Co, Private, State Agency, Water Dist. M

Use of water: (A) Air cond, Bottling, Comm, Dewater, Power, Fire, Dom, Irr, Mad, Ind, P S, Rac, Stock, Instit, Unused, Recharge, Desal-P S, Desal-other, Other P

Use of well: (A) Anode, Drain, Seismic, Heat Res, Obs, Oil-gas, Recharge, Test, Unused, Withdraw, Waste, Destroyed. W

DATA AVAILABLE: Well data  Freq. W/L meas.:  Field aquifer char. Z

Hyd. lab. data:

Qual. water data; type:

Freq. sampling:  Pumpage inventory:  no. period:

Aperture cards:

Log data: D

WELL-DESCRIPTION CARD

SAME AS ON MASTER CARD Depth well: 382 ft Meas. accuracy 3

Depth cased: 312 ft Casing type: 26x10 in 26

Finish: (C) porous concrete, (F) gravel v. concrete, (G) gravel v. (perf.), (H) horis. gallery, (I) open end, (J) percuss, (K) air, (L) screen, (M) ad. pt., (N) shored, (O) open, (P) other S

Method Drilled: (A) air rot., (B) bored, (C) cable, (D) dug, (E) hyd, (F) jetted, (G) air percuss, (H) rotary, (I) reverse, (J) trenching, (K) driven, (L) drive wash, (M) other H

Date Drilled: 9:6:1 Pump intake setting: ft

Driller: Layne Central

Lift (type): (A) air, (B) bucket, (C) cent., (D) jet, (E) multiple, (F) multiple, (G) none, (H) piston, (I) rot., (J) submerg., (K) turb., (L) other T Deep  Shallow

Power (type): diesel, elec, gas, gasoline, hand, gas, wind; H.P.  Trans. or meter no. 41

Descrip. MP 202 (12/89) ft above LSD, Alt. MP ft below

Alt. LSD: 205 Accuracy: 4

Water Level: 144 ft below MP; Ft below LSD Accuracy: 3

Date meas: N 7 1 Yield: 0 gpm 472 Method determined 3

Drawdown: ft Accuracy: hrs

QUALITY OF WATER DATA: Iron ppm Sulfate ppm Chloride ppm Hard. ppm

Sp. Conduct K x 10 Temp. F Date sampled 77

Taste, color, etc. pH 8.3

PUNCHED and VERIFIED  
ROLLA COMPUTATION BRANCH

Well No.

H45

Well No. H 45

Latitude-longitude N  
S  
d m s d m s

**HYDROGEOLOGIC CARD**

1 SAME AS ON MASTER CARD 19 Physiographic Province: 03 Section: \_\_\_\_\_  
 20 21  
 22 D Drainage Basin: 13E Subbasin: \_\_\_\_\_ 24  
 (D) (C) (E) (F) (R) (K) (L)  
 Topo of well site: depression, stream channel, dunes, flat, hilltop, sink, swamp,  
 (Q) (P) (S) (T) (U) (V) \_\_\_\_\_ 27  
 offshore, pediment, hillside, terrace, undulating, valley flat  
 MAJOR AQUIFER: \_\_\_\_\_ system \_\_\_\_\_ series K3 \_\_\_\_\_ aquifer, formation, group E2  
 28 29 30 31  
 Lithology: \_\_\_\_\_ Origin: U.S. \_\_\_\_\_ Aquifer Thickness: 807 ft  
 32 33 34  
 35 80 Length of well open to: \_\_\_\_\_ ft 70 Depth to top of: \_\_\_\_\_ ft \_\_\_\_\_  
 36 37 38 39 40 41 42  
 MINOR AQUIFER: \_\_\_\_\_ system \_\_\_\_\_ series \_\_\_\_\_ aquifer, formation, group \_\_\_\_\_  
 43 44 45 46 47  
 Lithology: \_\_\_\_\_ Origin: \_\_\_\_\_ Aquifer Thickness: \_\_\_\_\_ ft  
 48 49 50  
 \_\_\_\_\_ Length of well open to: \_\_\_\_\_ ft \_\_\_\_\_ Depth to top of: \_\_\_\_\_ ft \_\_\_\_\_  
 51 52 53 54 55 56 57 58 59  
 Intervals Screened: \_\_\_\_\_  
 Depth to consolidated rock: \_\_\_\_\_ ft \_\_\_\_\_ Source of data: \_\_\_\_\_ 64  
 60 61 62  
 Depth to basement: \_\_\_\_\_ ft \_\_\_\_\_ Source of data: \_\_\_\_\_ 69  
 63 64 65  
 Surficial material: \_\_\_\_\_ Infiltration characteristic: \_\_\_\_\_ 73  
 66 67 68  
 Coefficient Trans: 9000 gpd/ft 902 Coefficient Storage: \_\_\_\_\_ 76 77  
 78 79  
 Coefficient Perm: 110 gpd/ft<sup>2</sup>; Spec cap: 3.8 gpd/ft; Number of geologic cards: \_\_\_\_\_ 79

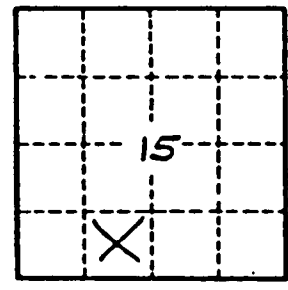
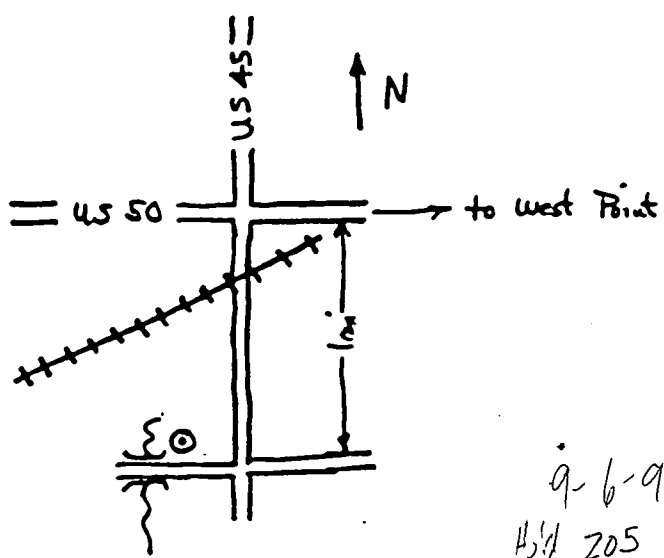

WL  
 82' vpt drl in 1961  
 97' man 1963

9-6-91  
 HSD 205  
 Cat 1.82  
 MI 2.16  
 WL 201.02

Well No. H 45

CLAY  
H45

12-5-61

MISSISSIPPI BOARD OF WATER COMMISSIONERS

WATER WELL DRILLERS LOG

**CODED**

Gw 1326

202

Date: 12-5-1961, Driller: Layne-Central Co. County: Clay

(Name)

(1) Owner of Land: <u>City of West Point</u> (Name) <u>West Point, Mississippi</u> (Address)	Description & Color of Materials Sand, Clay, Red Clay, Shell, etc.	Thick- ness Feet	Depth Feet
(3) Topography: <u>Municipal</u> (Hilly) (Flat) (Level)	Top soil	2	2
(4) Purpose of Well: <u>Municipal</u> (Domestic Irrigation Municipal, Industrial, Other)	white clay	6	8
Information upon completion of well: (1) Diameter <u>16"</u> inches. (2) Total Depth <u>382'</u> feet. (3) Water Level <u>82'</u> feet below top of ground. (4) Cased to <u>299'</u> , Size <u>16"</u> (5) Screen: Size <u>8"</u> , Length <u>70'</u> (6) Were any formations sealed against pollution? <u>X</u> yes, <u>      </u> no. If YES depth of formation <u>299'</u> Why <u>Required</u> Drillers Remarks: <u>      </u>	red clay	6	14
	hard brittle clay	2	16
	hard blue soapstone	125	141
	lime rock & shells	4	145
	sandy clay	47	192
	sandy shale	37	229
	rock	1	230
	sandy clay & shells	7	237
	rock	1	238
	hard fine sand & clay stks	10	248
	rock	3	251
	hard fine sand	24	275
	brittle clay	5	280
	blue clay	9	289
	hard fine sand-clay stks	93	382
	clay	2	384

**CODED**

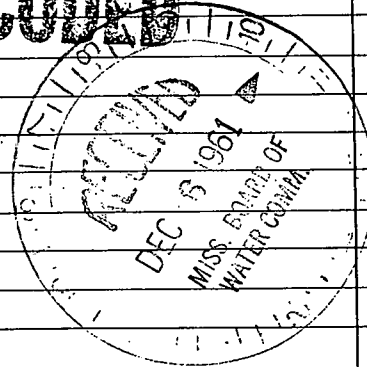

(Use Back Side)

Well No.

DEPARTMENT OF ENVIRONMENTAL QUALITY - OLWR  
PUBLIC SUPPLY WELLS PROJECT

GPS LOG

USER NAME(S): AH Imo DATE: 4-14-99

UNIT DEQ #: 82859 FILE #: B041413C

HEALTH DEPT. #: 130008-02 ELEV.: ~200

USGS #: H45 OLWR #: GW-01326

OWNER: City of West Point QUAD: West Point

LOCATION: SE SW S 15 T 13 R 65 COUNTY: CLAY

LOCATION DESCRIPTION: well located on <sup>West</sup> Church Hill Rd.

1/10 mile from Hwy 45 Att. Next to creek;  
Mossy Oak store across the street

CASING DIAM: \_\_\_\_\_ PUMP TYPE AND SIZE: Turbine 60 HP

GPS FIELD LOCATION: LAT: 33 35 32.8N LONG: 88 39 44.7W

GPS CORRECTED: LAT: 33.592668 LONG: 88.662011

REMARKS: \_\_\_\_\_

H45. West Point. 130008-02. Clay Co. 4/14/99

p161

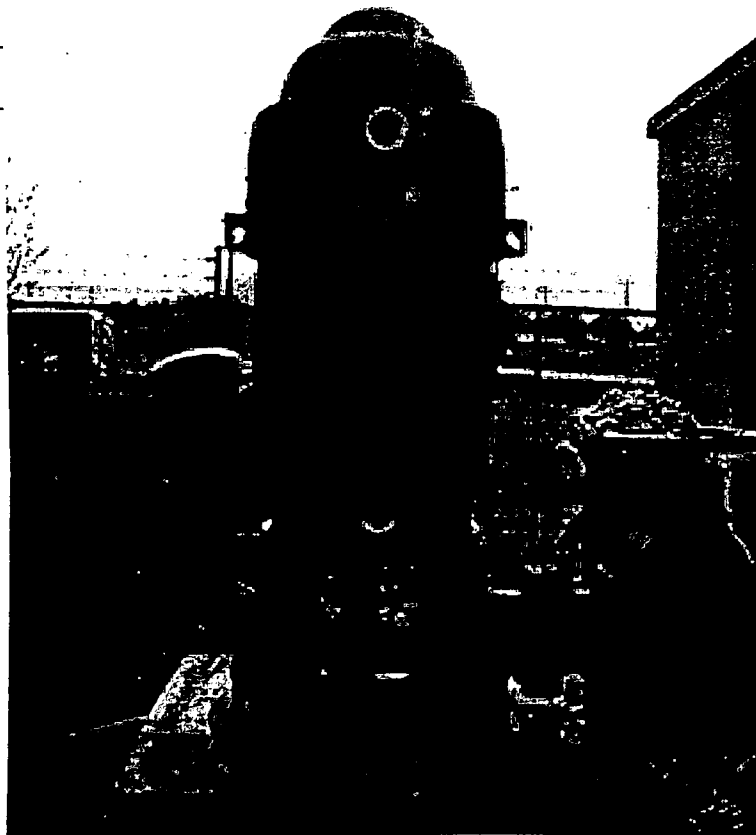



345

40'

H15

OKLA 27 MI.  
16 MI. TO MISS. B

347

560000 FEET

H25

349 88° 37' 30"

33° 37' 3"

12 MI. TO U.S. 45  
COLUMBUS 17 MI.

12 MI. TO U.S. 45  
COLUMBUS 17 MI.

3719

T 17 S  
1430000  
FEET

3718

35'

3716

179

E E