

12/4/90
Destroyed
West Point

Wkd Exp. (GW)
April 1966

Well No. 112

WELL SCHEDULE

PUNCHED

U. S. DEPT. OF THE INTERIOR

GEOLOGICAL SURVEY

WATER RESOURCES DIVISION

MASTER CARD
TRM... 6-6-1965

JAN 24 1973

Record by [Signature] Source of data [Signature] Date 1-12-74 Map C

State [Signature] County (or town) Clay

Latitude: 33° 33' 48.5" N Longitude: 83° 59' 30" W Sequential number: 1

Local well number: H 0 1 2 A C 2 7 1 7 5 0 6 1 0

Local use: [Blank] Owner or name: [Blank]

Owner or name: BORGIN SAUNDERS

Ownership: County, Fed Gov't, City, Corp or Co, Private, State Agency, Water Dist

Use of water: (S) Stock, (T) Instit, (U) Unused, (V) Recharge, (W) Recharge, (X) Desal-P S, (Y) Desal-other, (Z) Other

Use of well: (A) Anode, (D) Drain, (G) Seismic, (H) Heat Res, (I) Obs, (J) Oil-gas, (K) Recharge, (L) Test, (M) Unused, (N) Withdraw, (O) Waste, (P) Destroyed

DATA AVAILABLE: Well data [] Freq. W/L meas.: Discont [N] Field aquifer char. []

Hyd. lab. data: []

Qual. water data: type: []

Freq. sampling: [] Pumpage inventory: yes [] no, period: []

Aperture cards: []

Log data: []

Log data: []

Log data: []

Log data: []

Log data: []

Log data: []

Log data: []

Log data: []

Log data: []

Log data: []

Log data: []

Log data: []

Log data: []

Log data: []

Log data: []

Log data: []

Log data: []

Log data: []

Log data: []

WL-47. 10/5/78

Well No.

Well No. H12

PUNCHED

Latitude-longitude 33 34 05^N 088 39 32^W
d m s d m s

HYDROGEOLOGIC **LOG**

SAME AS ON MASTER CARD Physiographic Province: C13 Section: _____
Drainage Basin: 13E Subbasin: _____

Topo of well site: (D) depression, stream channel, dunes, flat, hilltop, sink, swamp, (V)
(Q) offshore, pediment, hillside, terrace, undulating, valley flat _____ 27

MAJOR AQUIFER: K3 7 30 31 aquifer, formation, group
Lithology: U.R Origin: 2 Thickness: _____ ft

Length of well open to: _____ ft 300 Depth to top of: _____ ft 600

MINOR AQUIFER: K3 6 40 47 aquifer, formation, group
Lithology: U.S Origin: 6 Thickness: _____ ft

Length of well open to: _____ ft _____ Depth to top of: _____ ft _____

Intervals Screened: _____

Depth to consolidated rock: _____ ft _____ Source of data: _____

Depth to basement: _____ ft _____ Source of data: _____

Surficial material: _____ Infiltration characteristics: _____

Coefficient Trans: _____ gpd/ft _____ Coefficient Storage: _____

Coefficient Perm: _____ gpd/ft²; Spec cap: _____ gpm/ft; Number of geologic cards: _____

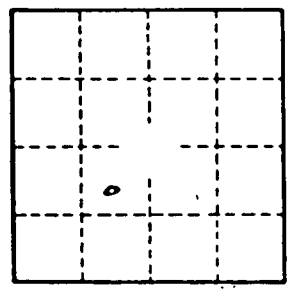
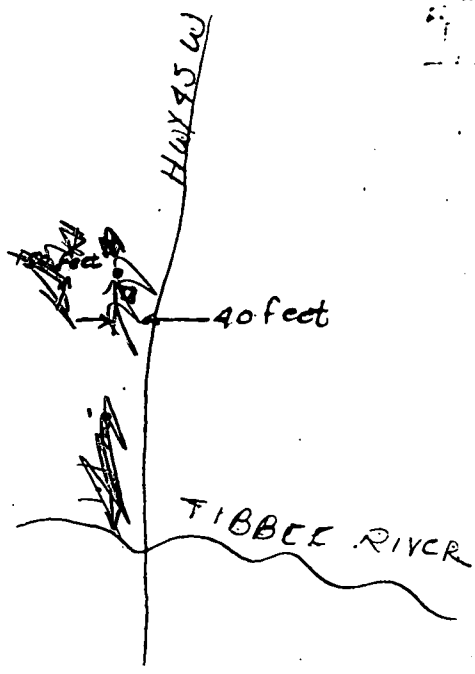

5.0 gal 65 min
10 gpm flow in 6-10 min
1-6-10

dropped
F-179

Observation Well

County CLAY

Well No. H 12

3334050588932.01

Owner's Name BURGIN BROTHERS

Location WEST POINT
(town)

2 mi. S on HWY 45
(miles and direction from center of town)

Other description Robert Irby - Shop owner

Depth 700 Diameter 4 Date drilled 1937

Formation Gardo

Elev. of lsd 194 Recorder _____ Type _____ No. _____

M.P. Top of well head plate at 0.5 ft ^{above} below lsd. Date 1/30/76
crack next to pipe

M.P. _____ at _____ ft above below lsd. Date _____

M.P. _____ at _____ ft above below lsd. Date _____

Special Add 13.72 to recorder tape R. Target W-L below lsd

Water Level - 43 1976

Sketch of location

Sketch of well head

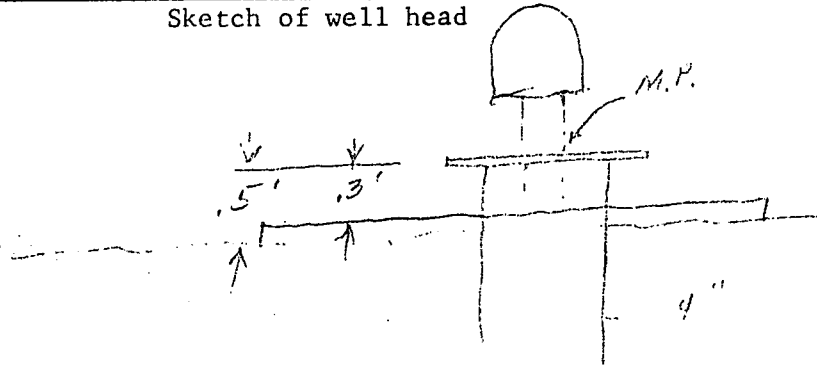
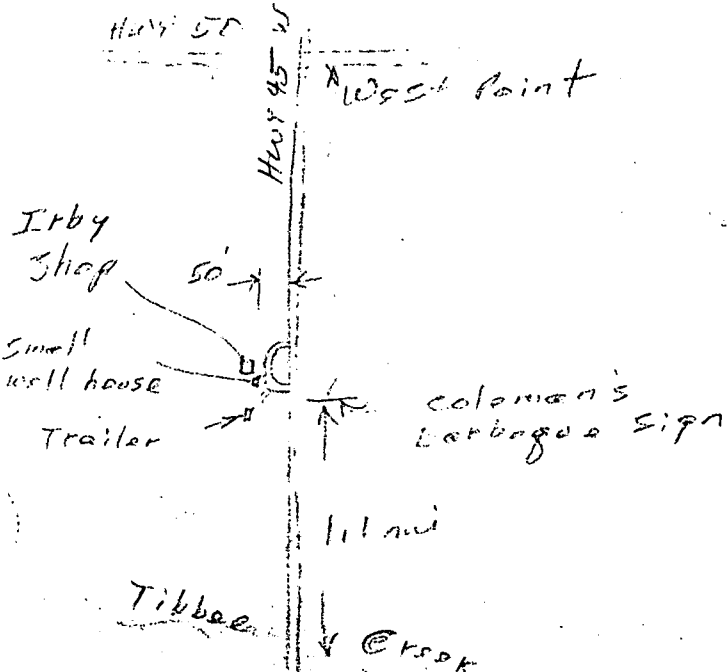

FILE COPY

County CLAY

Well No. H 12

Owner's Name BURGIN BROTHERS

Location WEST POINT

2 mi S on HWY 45
(town)
(miles and direction from center of town)

Other description Robert Irby - shop owner

Depth 700 Diameter 4 Date drilled 1937

Formation Gordo

Elev. of lsd 194 Recorder _____ Type _____ No. _____

M.P. Top of well head plate at 0.5 ft ^{above} below lsd. Date 1/30/76
Crack next to pipe.

M.P. _____ at _____ ft ^{above} below lsd. Date _____

M.P. _____ at _____ ft ^{above} below lsd. Date _____

Special Add 13.12 to recorder tape R. Irby at Well below lsd

WL. 47.18 10/5/78 1045 $\frac{194}{147} + 194$

Water Level -43.1976

Sketch of location

Sketch of well head

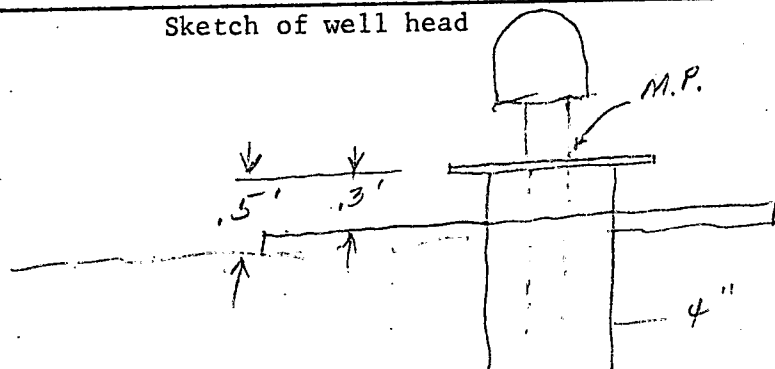
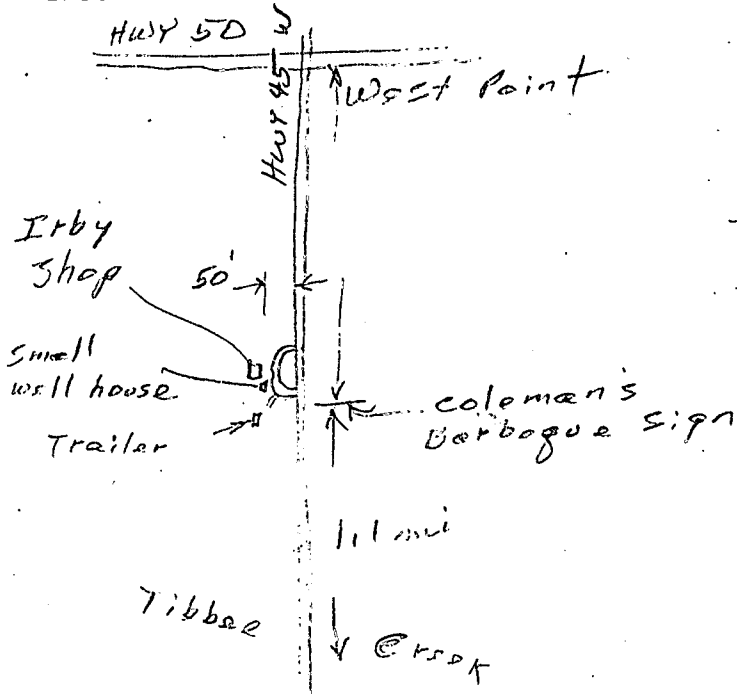

6000

1232

47.68

5

47.18

MAP

Observation Well

dropped
F-179

County CLAY

Well No. H 12

Owner's Name BURGIN BROTHERS

Location WEST POINT
(town)

2 mi. S on HWY 45
(miles and direction from center of town)

Other description Robert Irbys - shop corner

Depth 700 Diameter 4 Date drilled 1937

Formation Gorda

Elev. of lsd 194 Recorder _____ Type _____ No. _____

M.P. Top of well head plate at 0.5 ft ^{above} below lsd. Date 1/30/76
crack next to pipe

M.P. _____ at _____ ft ^{above} below lsd. Date _____

M.P. _____ at _____ ft ^{above} below lsd. Date _____

Special Add 13.72 to record book tape R. Irbys at W-L below lsd

Could not get reading 12/1/82
Water Level - 43 1000

Sketch of location

Sketch of well head

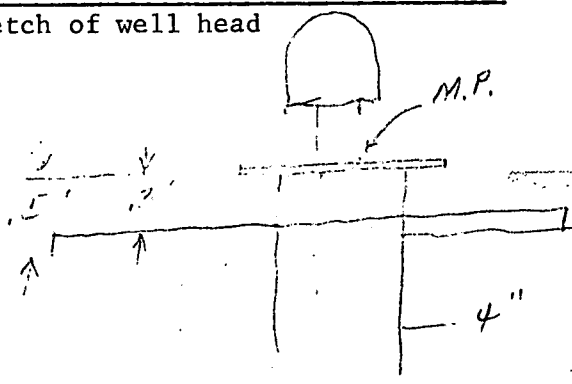
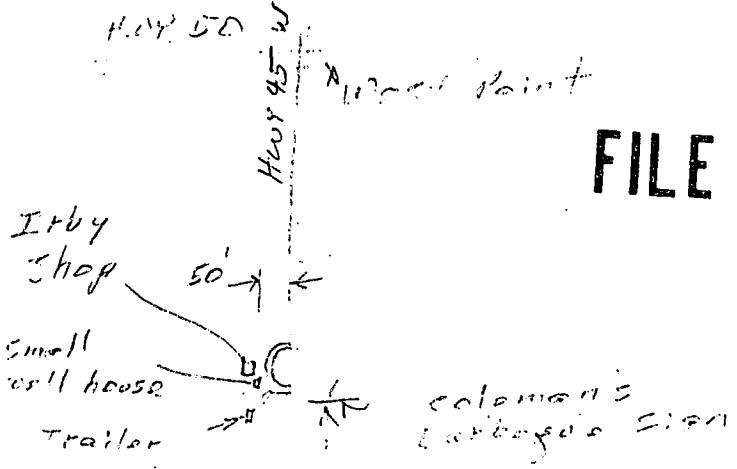

FILE COPY

Tibbs

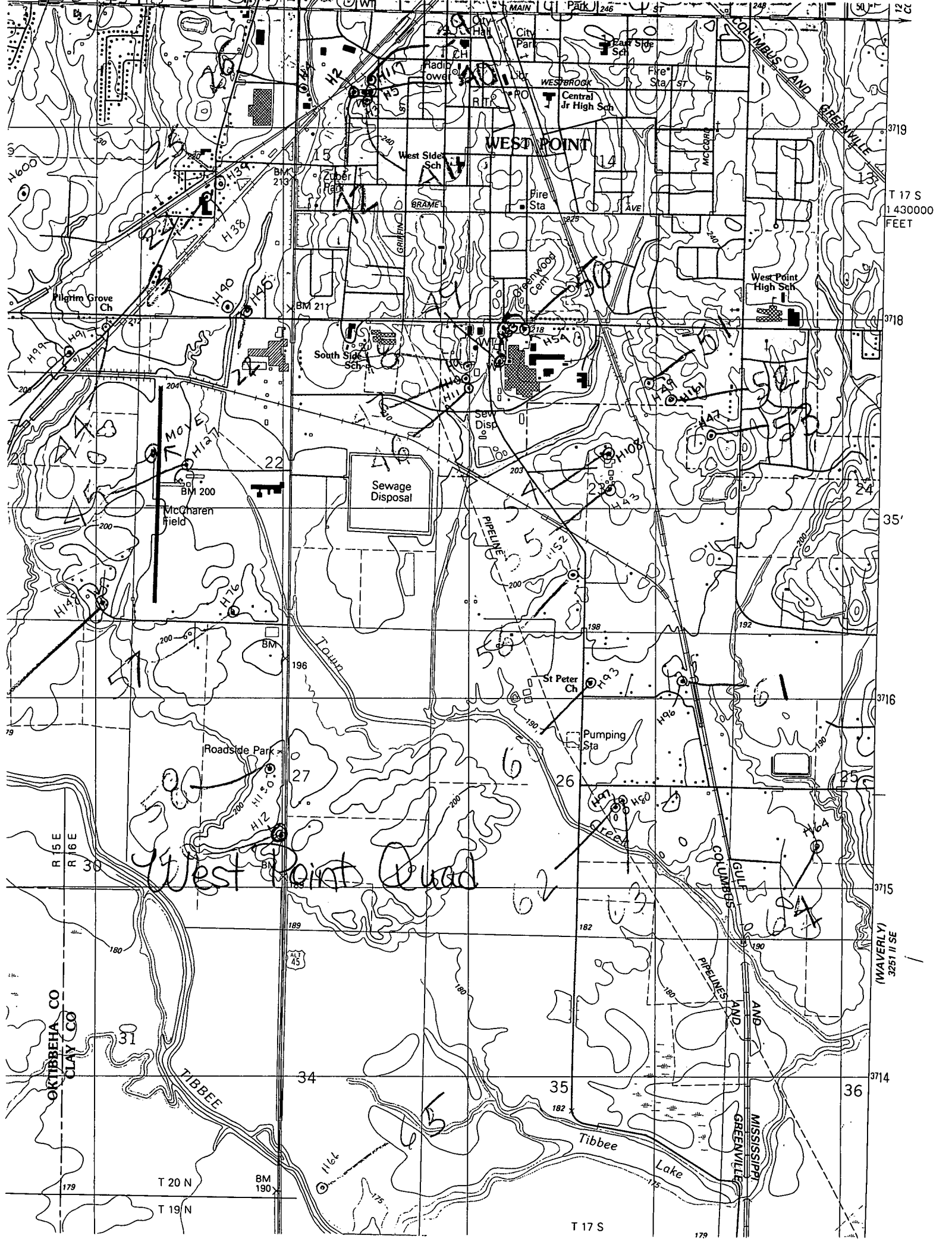

T 17 S
1430000
FEET

West Point Quad

(WAVERLY)
3251 II SE

OKTIBBEHA CO
CLAY CO

MISSISSIPPI
GREENVILLE
AND
COLUMBUS
AND
GULF

T 20 N
T 19 N
BM 190

T 17 S
179