

FILE COPY
WELL SCHEDULE
GEOLOGICAL SURVEY

Log # **PUNCHED**
WATER RESOURCES DIVISION

U. S. DEPT. OF THE INTERIOR

JAN 24 1973

MASTER CARD

Record by ENB Source of data Hoerner Date 5/19/55 Map

State MISS 28 County (or town) CLAY 13

Latitude: 33¹ 33² 6³ 27⁴ N⁵ Longitude: 08¹² 8¹³ 39¹⁴ 00¹⁵ Sequential number: 7

Lat-long accuracy: 2¹⁶ 17¹⁷ S¹⁸ 6¹⁹ E²⁰ Sec 11 SW t, NW t, SW t

Local well number: H0073C1117506E Other number: B & M

Local use: 038 Owner or name: HOSMER ICE CO

Ownership: County, Fed Gov't, City, Corp or Co, Private, State Agency, Water Dist N

Use of water: (A) Air cond, Bottling, Comm, Dewater, Power, Fire, Dom, Irr, Med, Ind, P S, Rec, (S) Stock, Instit, Unused, Recharge, Desal-P S, Desal-other, Other U

Use of well: (A) Anode, Drain, Seismic, Heat Res, Obs, Oil-gas, Recharge, Test, Unused, Withdraw, Waste, Destroyed, (P) φ

DATA AVAILABLE: Well data Freq. W/L meas: Field aquifer char.

Hyd. lab. data:

Qual. water data; type:

Freq. sampling: Pumpage inventory: yes no period:

Aperture cards: yes

Log data: Gamma Ray log 10' - 309'

10/29/87
COULD NOT
FIND
WELL GROUND
OVER, OR
DESTROYED
EVIDENCE
OF DOZER
WORK

WELL-DESCRIPTION CARD

SAME AS ON MASTER CARD Depth well: 309 ft Meas. rept accuracy 1

Depth cased: ft Casing type: ; Diam. 4 in

Finish: (C) porous concrete, (F) gravel w. (G) gravel w. (H) horiz. open (P) perf., (S) screen, (T) sd. pt., (W) shored, (X) open hole, (Z) other

Method Drilled: (A) air rot, (B) bored, (C) cable, (D) dug, (H) hyd jetted, (J) air percussion, (P) reverse, (R) rotary, (T) trenching, (V) driven, (W) drive wash, (Z) other H

Date Drilled: old Pump intake setting: ft

Driller:

Lift (type): (A) air, (B) bucket, (C) cent, (J) jet, (L) multiple, (M) multiple, (N) none, (P) piston, (R) rot, (S) submerg, (T) turb, (Z) other Deep Shallow

Power (type): (nat) diesel, elec, gas, gasoline, hand, gas, wind; (LP) H.P. Trans. or meter no.

Descrip. MP Top of hole 3' ft above below LSD, Alt. MP

Alt. LSD: 230 Accuracy: (source) 5

Water Level 157.53 ft above below MP; Ft above below LSD 163 Accuracy: 7

Date meas: 9.55 Yield: gpm Method determined

Drawdown: ft Accuracy: Pumping period hrs

QUALITY OF WATER DATA: Iron ppm Sulfate ppm Chloride ppm Hard. ppm

Sp. Conduct K x 10⁶ Temp. °F Date sampled

Taste, color, etc.

12/17/81
WL = 200.00

well stop up No M. 12/1/82

Well No. _____

Latitude-longitude N
S
d m s d m s

HYDROGEOLOGIC CARD

SAME AS ON MASTER CARD

Physiographic Province: _____

03 Section: _____

CTA 1 D Drainage Basin: _____

13 E Subbasin: _____

Topo of well site: (D) depression, stream channel, dunes, flat, hilltop, sink, swamp, (E) (F) (H) (K) (L) (M) (P) (S) (T) (U) (V) offshore, pediment, hillside, terrace, undulating, valley flat

MAJOR AQUIFER: system _____ series **K3** aquifer, formation, group **EUTAW** **EU**

Lithology: _____ Origin: **U.S.** Aquifer Thickness: **6** ft

Length of well open to: _____ ft Depth to top of: _____ ft

MINOR AQUIFER: system _____ series _____ aquifer, formation, group _____

Lithology: _____ Origin: _____ Aquifer Thickness: _____ ft

Length of well open to: _____ ft Depth to top of: _____ ft

Intervals Screened:

Depth to consolidated rock: _____ ft Source of data: _____

Depth to basement: _____ ft Source of data: _____

Surficial material: _____ Infiltration characteristics: _____

Coefficient Trans: _____ gpd/ft Coefficient Storage: _____

Coefficient Perm: _____ gpd/ft²; Spec cap: _____ gpm/ft; Number of geologic cards: _____

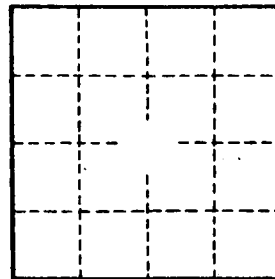

Well No. _____

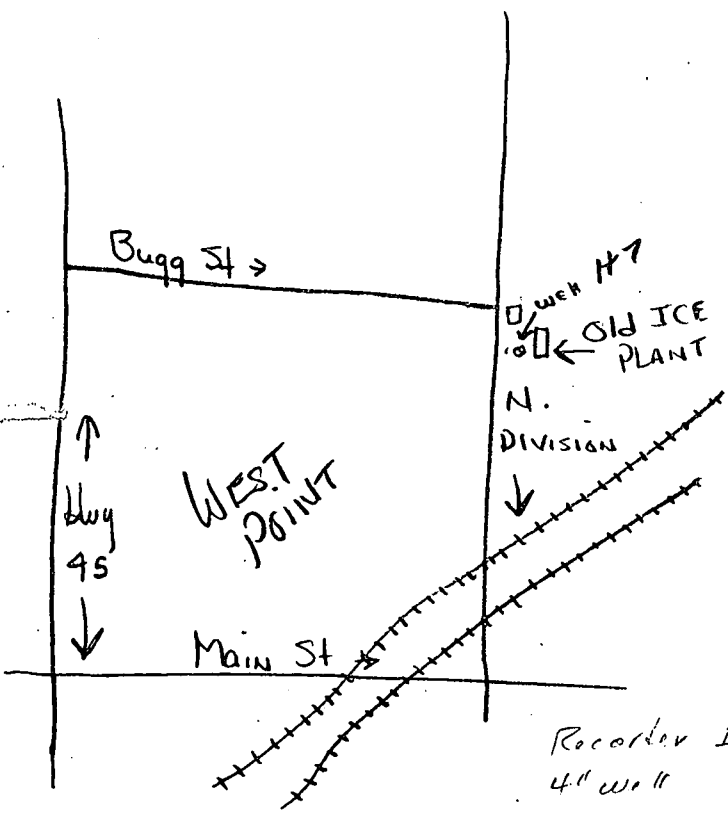

Recorder installed fairly sensitive for 4" well

County Clay

Well No. H 7

362705

Owner's Name West Point

Location West Point
(town)

.5 mi NW
(miles and direction from center of town)

Other description _____

Depth 309 Diameter 4" Date drilled old

23 Formation EU town

Elev. of lsd 230 Recorder Stephan "F" Stokes 9/12/75
Type No.

M.P. Top of casing flange at 3.0 ft above below lsd. Date 1972

M.P. Top of 4" coupling at 0.2 ft above below lsd. Date 4/2/74

M.P. _____ at _____ ft above below lsd. Date _____

Special _____

10/5/78
W.L. 200.0 below LSD. electric tape

Water Level 166 (1974)

Sketch of location

Sketch of well head

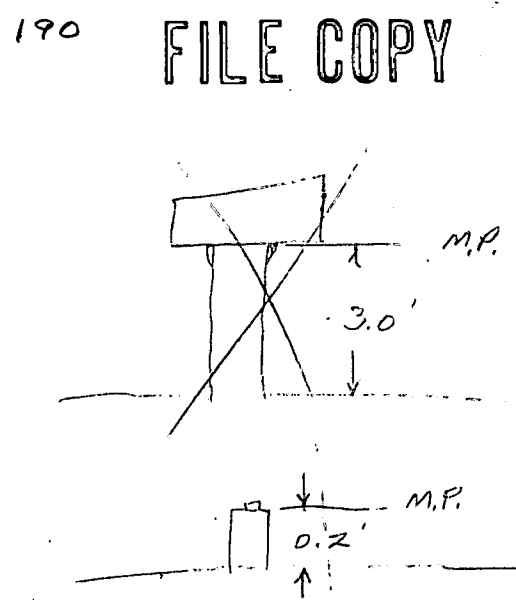
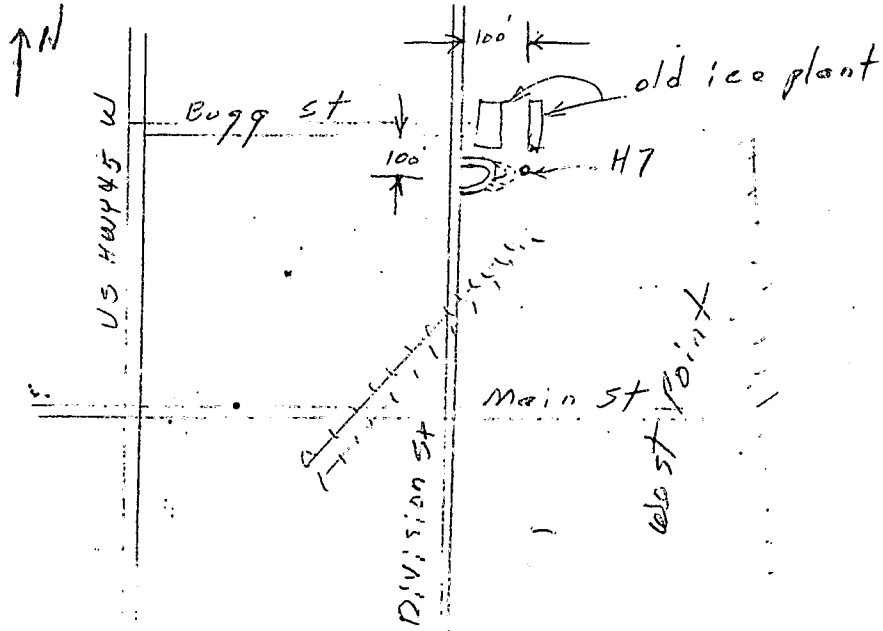

FILE COPY