

Abandoned

West Point

WRD Ex. (GW)
April 1966

Well No. H 2

WELL SCHEDULE

U. S. DEPT. OF THE INTERIOR

GEOLOGICAL SURVEY

WATER RESOURCES DIVISION

MASTER CARD WTO

Record by FHB Source of data Mr. Millsaps Date 6/54 Map _____

State Miss. 28 County Clay 13

Latitude: 33^{deg} 36^{min} 15^{sec} N Longitude: 02^{deg} 8^{min} 39^{sec} 0^W Sequential number: 1

Lat-long accuracy: 3⁰ T. 17^N R. 6⁰ Sec 15, NE^{1/4}, SW^{1/4}, NE^{1/4}

Local well number: H002 A1517506F Other number: CITY Well #1

Local use: 064 Owner or name: _____

Owner or name: WEST POINT Address: West Point

Ownership: County, Fed Gov't, City, Corp or Co, Private, State Agency, Water Dist M

Use of Air cond, Bottling, Comm, Dewater, Power, Fire, Dom, Irr, Med, Ind, P S, Rec, _____

Water: (S) (T) (U) (V) (W) (X) (Y) (Z) U
Stock, Inactit, Unused, Reppure, Recharge, Desal-P S, Desal-other, Other _____

Use of well: (A) (D) (G) (H) (I) (P) (R) (T) (U) (W) (X) (Z) U
Anode, Drain, Seismic, Heat Res, Obs, Oil-gas, Recharge, Test, Unused, Withdraw, Waste, Destroyed

DATA AVAILABLE: Well data Freq. W/L meas.: I Field aquifer char.

Hyd. lab. data: _____

Qual. water data; type: MSBCH

Freq. sampling: _____ Pumpage inventory: yes no period: _____

Aperture cards: _____

Log data: _____

WELL-DESCRIPTION CARD

SAME AS ON MASTER CARD Depth well: 383 ft Meas. rept. accuracy 3

Depth cased: 308 ft Casing type: _____; Diam. 4x12 in 14

Finish: (C) porous concrete, (F) gravel w. (perf.), (G) gravel w. (screen), (H) horiz. gallery, (I) open end, (P) perf., (S) screen, (T) sd. pt., (W) shored, (X) open hole, (Z) other G

Method Drilled: (A) air rot., (B) bored, (C) cable, (D) dug, (H) hyd jetted, (J) air rot., (P) percussion, (R) rotary, (T) reverse, (U) trenching, (V) driven, (W) drive wash, (Z) other H

Date Drilled: 9:25 Pump intake setting: 2:43 ft

Driller: Layne address _____

Lift (type): (A) air, (B) bucket, (C) cent., (J) jet, (L) multiple, (M) multiple, (N) none, (P) piston, (R) rot., (S) submerg, (T) turb., (U) other T Deep Shallow

Power (type): (nat) diesel, elec, gas, gasoline, hand, gas, wind; (LP) H.P. 50 V Trans. or meter no. _____

Descrip. MP OK (12/89) ft above below LSD. Alt. MP _____

Alt. LSD: 220 Accuracy: 1

Water Level: above below MP; Ft below LSD 196 Accuracy: _____

Date meas: 561 Yield: 0* gpm 369 Method determined 1

Drawdown: _____ ft Accuracy: _____ Pumping period _____ hrs

QUALITY OF WATER DATA: Iron _____ ppm Sulfate _____ ppm Chloride _____ ppm Hard. _____ ppm

Sp. Conduct _____ K x 10⁶ Temp. _____ °F Date sampled _____

Taste, color, etc. _____

RECORDED AND VERIFIED
FOLIO COMPUTATION BRANCH

Well No.

City Waterworks
west. Point

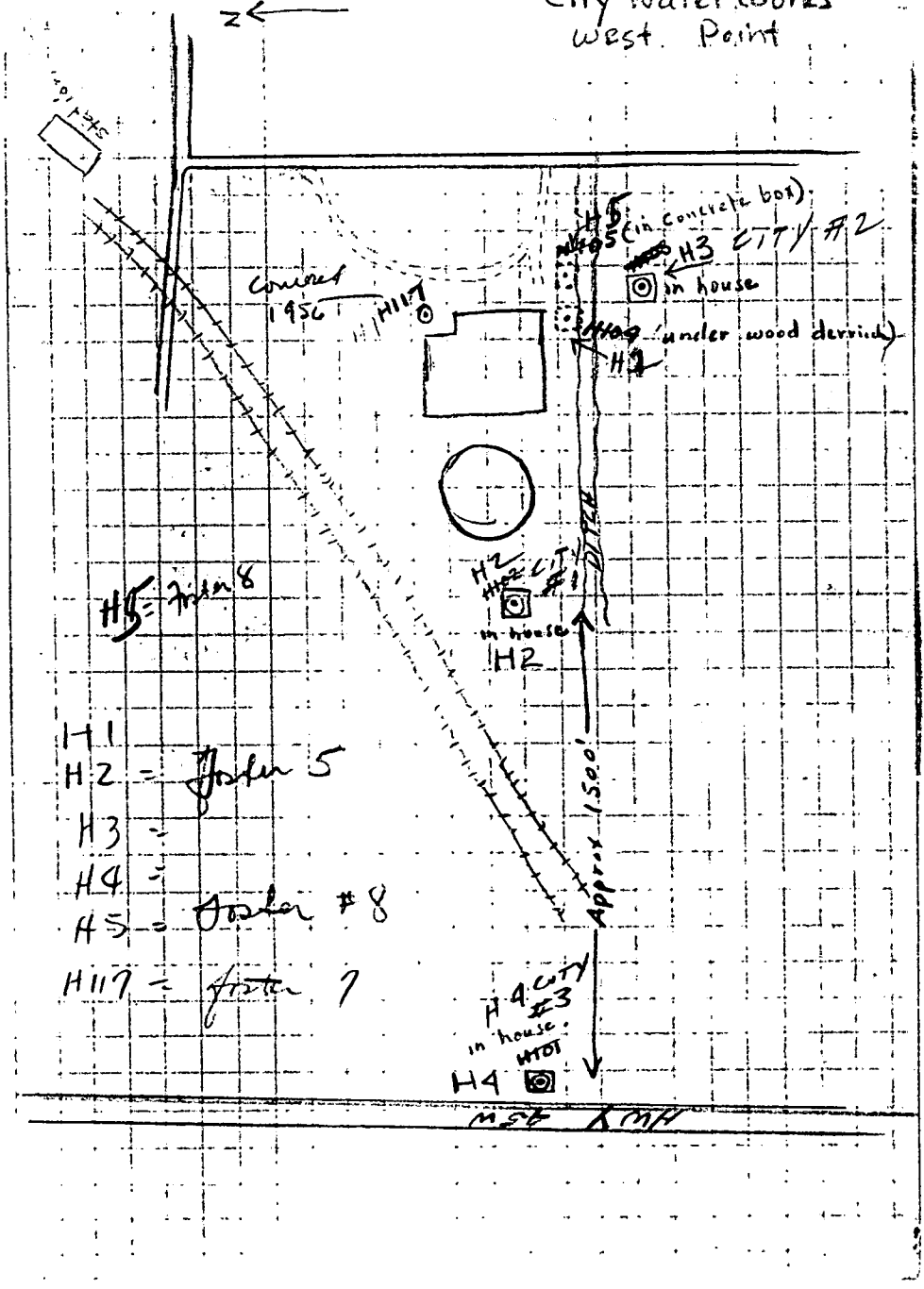
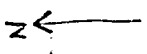

7.5 MINUTE SERIES (TOPOGRAPHIC)

SW/4 WEST POINT 15' QUADRANGLE

3251 11 (STRON)

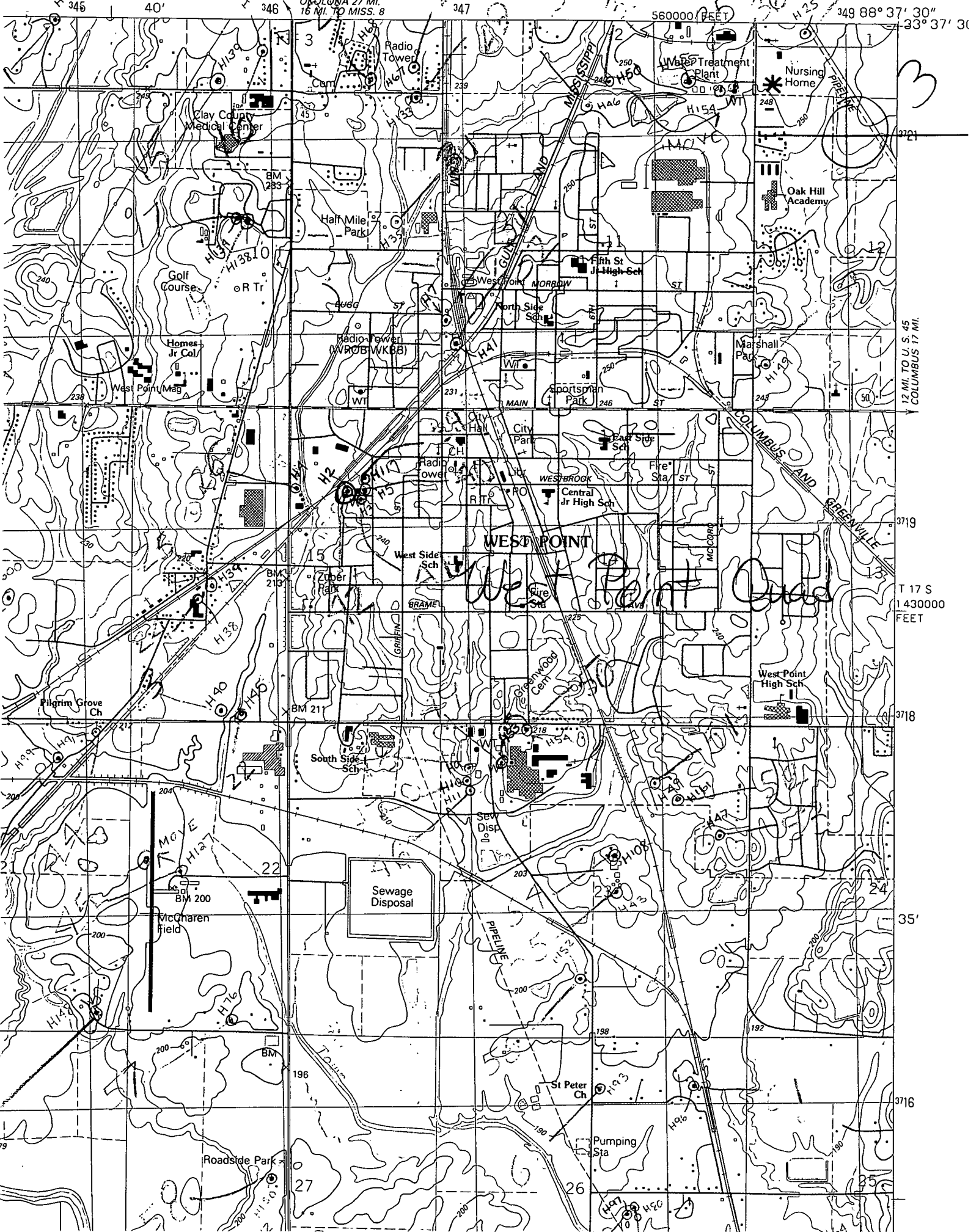

OKOLONA 27 MI.
16 MI. TO MISS. 8

560000 (FEET)

349 88° 37' 30"
3721 23° 37' 30"

12 MI. TO U.S. 45
COLUMBUS 17 MI.

T 17 S
1430000
FEET

3719

35'

3716

WEST POINT

West Point Data

Sewage Disposal

Roadside Park

Pumping Sta

St Peter Ch

West Point High Sch

Greenwood Cent

Fire Sta

Central Jr High Sch

City Park

Radio Tower

Radio Tower

Radio Tower

Clay County Medical Center

Nursing Home

Oak Hill Academy

Fifth St Jr High Sch

West Point MORROW

North Side Sch

Sportsman Park

Marshall Park

East Side Sch

Fire Sta

Central Jr High Sch

Fire Sta

West Side Sch

Greenwood Cent

South Side Sch

Sew Disp

St Peter Ch

Pumping Sta

Roadside Park

Sewage Disposal

McCharen field

BM 200

MOYE

HIA7

HIA8

HIA9

HIA0

HIA1

HIA2

HIA3

HIA4

HIA5

HIA6

HIA7

HIA8

HIA9

HIA0

HIA1

HIA2

HIA3

HIA4

HIA5

HIA6

HIA7

HIA8

HIA9

HIA0

HIA1

HIA2

HIA3

HIA4

HIA5

HIA6

HIA7

HIA8

HIA9

HIA0

HIA1

HIA2

HIA3

HIA4

HIA5

HIA6

HIA7

HIA8

HIA9

HIA0

HIA1

HIA2

HIA3

HIA4

HIA5

HIA6

HIA7

HIA8

HIA9

HIA0

HIA1

HIA2

HIA3

HIA4

HIA5

HIA6

HIA7

HIA8

HIA9

HIA0

HIA1

HIA2

HIA3

HIA4

HIA5

HIA6

HIA7

HIA8

HIA9

HIA0

HIA1

HIA2

HIA3

HIA4

HIA5

HIA6

HIA7

HIA8

HIA9

HIA0

HIA1

HIA2

HIA3

HIA4

HIA5

HIA6

HIA7

HIA8

HIA9

HIA0

HIA1

HIA2

HIA3

HIA4

HIA5

HIA6

HIA7

HIA8

HIA9

HIA0

HIA1

HIA2

HIA3

HIA4

HIA5

HIA6

HIA7

HIA8

HIA9

HIA0

HIA1

HIA2

HIA3

HIA4

HIA5

HIA6

HIA7

HIA8

HIA9

HIA0

HIA1

HIA2

HIA3

HIA4

HIA5

HIA6

HIA7

HIA8

HIA9

HIA0

HIA1

HIA2

HIA3

HIA4

HIA5

HIA6

HIA7

HIA8

HIA9

HIA0

HIA1

HIA2

HIA3

HIA4

HIA5

HIA6

HIA7

HIA8

HIA9

HIA0

HIA1

HIA2

HIA3

HIA4

HIA5

HIA6

HIA7

HIA8

HIA9

HIA0

HIA1

HIA2

HIA3

HIA4

HIA5

HIA6

HIA7

HIA8

HIA9

HIA0

HIA1

HIA2

HIA3

HIA4

HIA5

HIA6

HIA7

HIA8

HIA9

HIA0

HIA1

HIA2

HIA3

HIA4

HIA5

HIA6

HIA7

HIA8

HIA9

HIA0

HIA1

HIA2

HIA3

HIA4

HIA5

HIA6

HIA7

HIA8

HIA9

HIA0

HIA1

HIA2

HIA3

HIA4

HIA5

HIA6

HIA7

HIA8

HIA9

HIA0

HIA1

HIA2

HIA3

HIA4

HIA5

HIA6

HIA7

HIA8

HIA9

HIA0

HIA1

HIA2

HIA3

HIA4

HIA5

HIA6

HIA7

HIA8

HIA9

HIA0

HIA1

HIA2

HIA3

HIA4

HIA5

HIA6

HIA7

HIA8

HIA9

HIA0

HIA1

HIA2

HIA3

HIA4

HIA5

HIA6

HIA7

HIA8

HIA9

HIA0

HIA1

HIA2

HIA3

HIA4

HIA5

HIA6

HIA7

HIA8

HIA9

HIA0

HIA1

HIA2

HIA3

HIA4

HIA5

HIA6

HIA7

HIA8

HIA9

City Water works
west Point

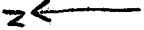

Station

Concessed
1956

H1117

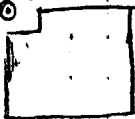

H2
H2 CITY #1
in house

H5 (in concrete box)
H3 CITY #2
in house
H4 (under wood derrick)
H1

H5 = Foster 6

H1

H2 = Foster 5

H3 =

H4 =

H5 = Foster #8

H117 = Foster 7

Approx 1500'

H4 CITY #3
in house
H101

MSE KM