

FORM 9-1642 (1-68)

Well No. G 54

WELL SCHEDULE

U. S. DEPT. OF THE INTERIOR

GEOLOGICAL SURVEY

WATER RESOURCES DIVISION

PUNCHED
JAN 24 1973

MASTER CARD

Record by J.S Source of data Bowc Date 12/69 Map _____
 State _____ County 28 (or town) Clay _____
 Latitude: 33° 36' 00" N Longitude: 088° 44' 45" W Sequential number: 1
 Lat-long accuracy: 1 T. 17 S. R. 5 W. Sec. 14 NE 1 SW 1 NE 1
 Local well number: G 054 CA 14 17 S 05 E Other number: _____ B & M
 Local use: 021 _____ Owner or name: _____
 Owner or name: D. FENNINGTON Address: 101 West Point

Ownership: County, Fed Gov't, City, Corp or Co, Private, State Agency, Water Dist _____ P
 Use of water: (A) Air cond, Bottling, Comm, Dewater, Power, Fire, Dom, Irr, Med, Ind, P S, Rec, _____
 (S) Stock, Instit, Unused, Recharge, Desal-P S, Desal-other, Other _____ H
 Use of well: (A) Anode, Drain, Seismic, Heat Res, Obs, Oil-gas, Recharge, Test, Unused, Withdraw, Waste, Destroyed. _____ W
 DATA AVAILABLE: Well data Freq. W/L meas.: Field aquifer char. _____
 Hyd. lab. data: _____
 Qual. water data; type: _____
 Freq. sampling: _____ Pumpage inventory: yes no; period: _____
 Aperture cards: _____ yes no
 Log data: _____

WELL-DESCRIPTION CARD

SAME AS ON MASTER CARD Depth well: _____ ft _____ Meas. rept. accuracy _____
 Depth cased; (first perf.) _____ ft _____ Casing type: _____; Diam. _____ in _____
 Finish: (C) porous concrete, (F) gravel w. (perf.), (G) gravel w. (screen), (H) horiz. gallery, (Ø) open end, (P) open perf., (S) screen, (T) ad. pt., (W) shored, (X) open hole, (B) other _____
 Method: (A) air bored, (B) cable, (C) dug, (D) hyd jetted, (H) rot., (J) percussion, (P) air, (R) reverse, (T) trenching, (V) driven, (W) drive wash, (Ø) other _____
 Date Drilled: 9/6/69 Pump intake setting: _____ ft _____
 Driller: _____ name _____ address _____
 Lift (type): (A) air, (B) bucket, (C) cent, (J) jet, (L) multiple, (M) multiple, (N) none, (P) piston, (R) rot, (S) submerg, (T) turb, other _____ Deep _____ Shallow _____
 Power (type): diesel, elec, gas, gasoline, hand, gas, wind; H.P. _____ LP _____ Trans. or meter no. _____
 Descrip. MP _____ above _____ ft below LSD, Alt. MP _____
 Alt. LSD: _____ Accuracy: (source) _____
 Water Level: 80 ft above _____ below _____ MP; Ft. above _____ below _____ LSD Accuracy: _____
 Date meas: _____ Yield: _____ gpm _____ Method determined _____
 Drawdown: _____ ft _____ Accuracy: _____ Pumping period _____ hrs _____
 QUALITY OF WATER DATA: Iron _____ ppm Sulfate _____ ppm Chloride _____ ppm Hard. _____ ppm
 Sp. Conduct _____ K x 10⁶ _____ Temp. _____ °F _____ Date sampled _____
 Taste, color, etc. _____

Well No.

G 54

Well No. 654

SEARCHED

Latitude-longitude N
S

HYDROGEOLOGIC CARD

SAME AS ON MASTER CARD Physiographic Province: 03 Section: _____

D Drainage Basin: 13E Subbasin: _____

Topo of well site: (D) depression, stream channel, dunes, flat, hilltop, sink, swamp, (E) offshore, pediment, hillside, terrace, undulating, valley flat

MAJOR AQUIFER: system _____ series K3 aquifer, formation, group E2

Lithology: _____ Origin: 6 Aquifer Thickness: 140 ft

Length of well open to: _____ ft Depth to top of: _____ ft

MINOR AQUIFER: system _____ series _____ aquifer, formation, group _____

Lithology: _____ Origin: _____ Aquifer Thickness: _____ ft

Length of well open to: _____ ft Depth to top of: _____ ft

Intervals Screened: _____

Depth to consolidated rock: _____ ft Source of data: _____

Depth to basement: _____ ft Source of data: _____

Surficial material: _____ Infiltration characteristics: _____

Coefficient Trans: _____ gpd/ft² Coefficient Storage: _____

Coefficient Perm: _____ gpd/ft²; Spec cap: _____ gpm/ft; Number of geologic cards: _____

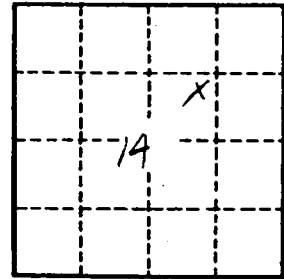

Well No.

654

CLAY
G54
10-28-69

MISSISSIPPI
BOARD OF WATER COMMISSIONERS
416 North State Street
Jackson, Mississippi 39201

CODED

WATER WELL DRILLERS LOG

10-28 1969 date well completed
Landon Herman Well firm name
Clay county well located

LANDOWNER: Danny Pennington
Route 1
West Point, Miss.
(mailing address)

Description of formations encountered	from	to
Surface Sand & Clay	0	18
Clay	18	360
Sand	360	500
Both	500	

WELL LOCATION:
sec. 14 T. 17 N. R. 5 E
7 miles S of Siloam
(distance) (direction) (nearest town)

WELL PURPOSE: Home
(home, irrigation, municipal, industrial)

- WELL COMPLETION DATA:
- (1) diameter (inches) 5"
 - (2) total depth (feet) 500
 - (3) static water level (feet) 80 below top of ground.
 - (4) casing (material) steel (depth) 23'2"
(size) 5" If telescope see back.
 - (5) screen (length) no (depth to top)
 - (6) pump (HP) (yield gpm)
(type power)
 - (7) electric log no (yes or no)
(organization running log)
 - (8) how well bottom plugged open

CODED

NOV 21 1969

DRILLERS REMARKS:

MISS. REG. OF
PROFESSIONAL ENGINEERS

GEOLOGICAL SURVEY

33° 37' 30" 88° 45' 338000E 339 340 R 5 E R 6 E 341 42' 30" 342

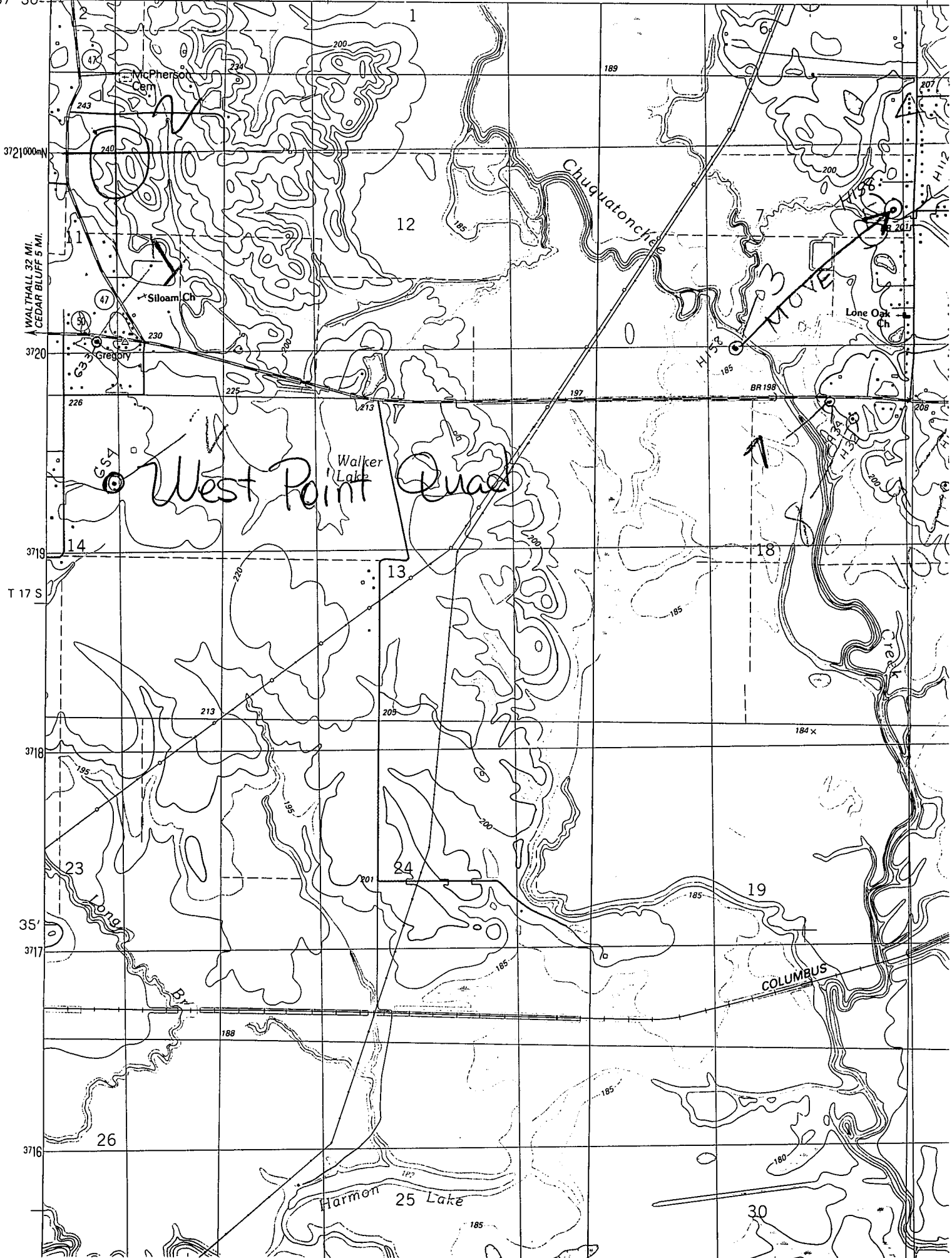

WALTHALL 32 MI.
CEDAR BLUFF 5 MI.

West Point Quad

COLUMBUS

Harmon 25 Lake

30