

Cedar Bluff

✓ go

FORM 9-1642
(1-68)

FILE COPY

Well No. G 16

WELL SCHEDULE

PUNCHED

U. S. DEPT. OF THE INTERIOR

GEOLOGICAL SURVEY

WATER RESOURCES DIVISION

JAN 24 1973

MASTER CARD

Record by B E Watson Source of data USGS Date 4-2-57 Map CEDAR BLUFF 134-0

State SI 28 County Clay (or town) 04 13

Latitude: 33^{deg} 36^{min} 38^{sec} N Longitude: 088^{degrees} 46^{min} 15^{sec} W

Lat-long accuracy: 3 T 17 N 5 R 10 NW NE SW SE

Local well number: G 016 A C 10 17 5 0 5 E Other number: _____ B & M

Local use: _____ Owner or name: Miss Stacie Childrese

Owner or name: B B CHILDRESE Address: Kenneth Bird

Ownership: County, Fed Gov't, City, Corp or Co, Private, State Agency, Water Dist P

Use of Air cond, Bottling, Comm, Dewater, Power, Fire, Dom, Irr, Med, Ind, P S, Rec, H

Water: (S) (T) (U) (V) (W) (X) (Y) (Z) W

Use of well: (A) (D) (G) (H) (I) (J) (K) (L) (M) (N) (O) (P) (Q) (R) (S) (T) (U) (V) (W) (X) (Y) (Z) W

DATA AVAILABLE: Well data 70 Freq. W/L meas.: _____ Field aquifer char. 71

Hyd. lab. data: _____ 73

Qual. water data: _____ 74

Freq. sampling: _____ Pumpage inventory: _____ 76

Appure cards: _____ 77

Log data: _____ 78 79

WELL-DESCRIPTION CARD

SAME AS ON MASTER CARD Depth well: 570 Meas. rept 6

Depth cased: _____ Casing type: _____ Diam. 4

Finish: porous concrete, gravel w. (perf.), (screen), gallery, open, other X

Method: (A) (B) (C) (D) (H) (J) (P) (R) (T) (V) (W) (Z) H

Drilled: air rot., bored, cable, dug, hyd rot., jetted, percussion, rotary, air reverse, driven, wash, other H

Date Drilled: 9-3-6 Pump intake setting: _____ ft 38

Driller: _____ name _____ address _____

Lift (type): (A) (B) (C) (J) (L) (M) (N) (P) (R) (S) (T) (Z) P Deep 40

Power (type): diesel, elec, gas, gasoline, hand, gas, wind, H.P. S Trans. or meter no. _____

Descrip. MP _____ above _____ below _____ LSD, Alt. MP _____

Alt. LSD: 245 Accuracy: 5

Water Level 8 Accuracy: 6

Date meas: 316 Yield: _____ Method determined _____

Drawdown: _____ Accuracy: _____ Pumping period _____ hrs _____

QUALITY OF WATER DATA: Iron _____ Sulfate _____ Chloride _____ Hard. _____

Sp. Conduct _____ K x 10⁶ Temp. _____ Date sampled _____

Taste, color, etc. _____

3/20/87
no one's seen
found well
bit completely
gone
down from as
deep as

12/5/90
pump has been
pulled -
open hole
covered with
metal plate
fe

unable to get tape in well MR. Bird well in home at 3:30 PM. wed.

Well No. G-16

Latitude-longitude N
S

HYDROGEOLOGIC CARD

SAME AS CARD Physiographic Province: 03 Section: _____

D Drainage Basin: 13E Subbasin: _____

Topo of well site: (D) depression, stream channel, dunes, flat, (H) hilltop, sink, swamp, (P) offshore, pediment, hillside, terrace, undulating, valley flat _____

MAJOR AQUIFER: system _____ series K3 aquifer, formation, group E2

Lithology: _____ Origin: 6 Aquifer Thickness: _____ ft
Length of well open to: _____ ft Depth to top of: _____ ft

MINOR AQUIFER: system _____ series _____ aquifer, formation, group _____

Lithology: _____ Origin: _____ Aquifer Thickness: _____ ft
Length of well open to: _____ ft Depth to top of: _____ ft

Intervals Screened: _____

Depth to consolidated rock: _____ ft Source of data: _____

Depth to basement: _____ ft Source of data: _____

Surficial material: _____ Infiltration characteristics: _____

Coefficient Trans: _____ gpd/ft Coefficient Storage: _____

Coefficient Perm: _____ gpd/ft²; Spec cap: _____ rpm/ft; Number of geologic cards: _____

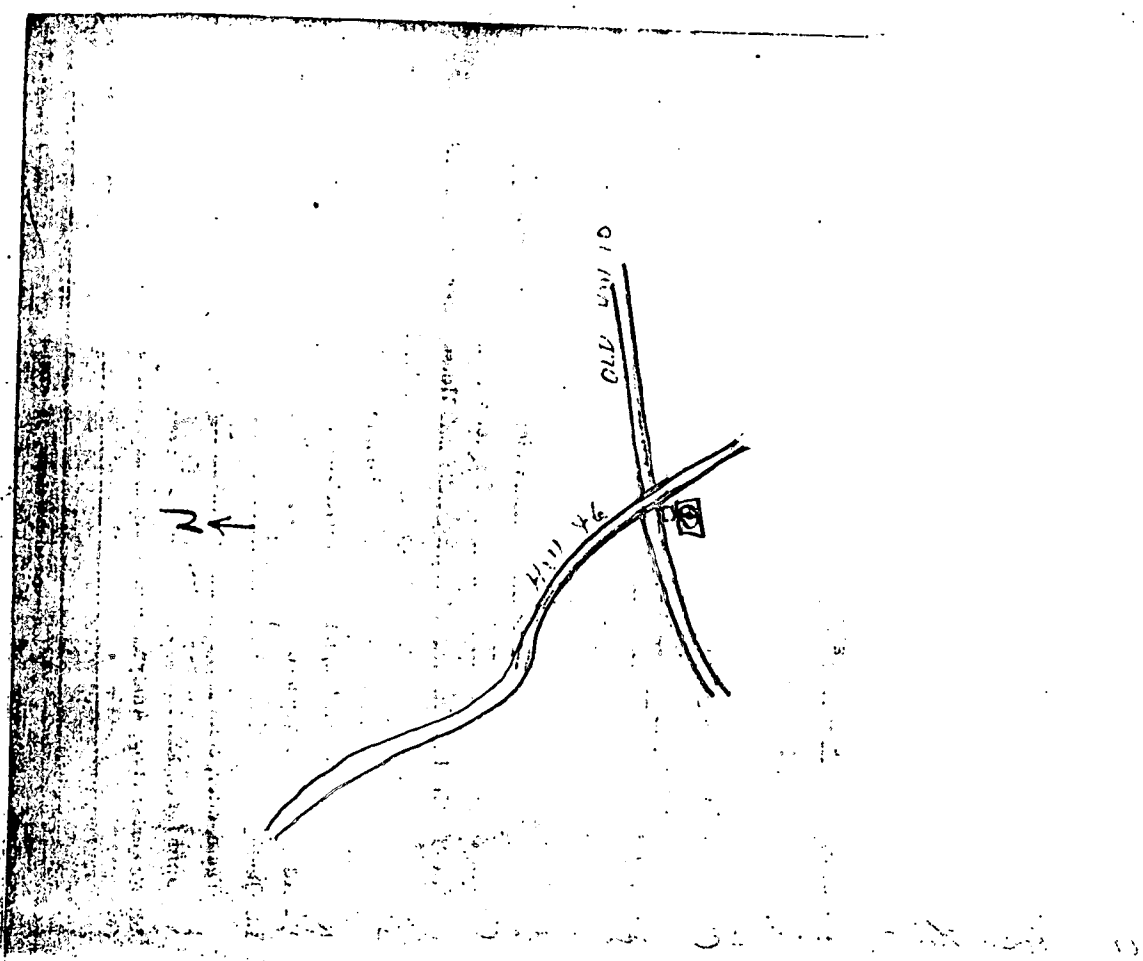

12/5/90

$$\begin{array}{r} 160.00 \\ - 23.42 \\ \hline 136.58 \end{array}$$

$$\begin{array}{r} - 1.15 \text{ mp} \\ \hline 135.43 \end{array}$$