

WELL SCHEDULE

U. S. DEPT. OF THE INTERIOR

GEOLOGICAL SURVEY

WATER RESOURCES DIVISION

MASTER CARD

Record by T.N. Shaw Source of data owner Date 5-12-67 Map Heidelberg Quad

State MISSISSIPPI County Clarke Sequential number: 1

Latitude: 31° 58' 46" N Longitude: 088° 53' 58" W

Lat-long accuracy: 3' T. 2 S, R. 14 E, Sec 30, SE 1/4, SE 1/4

Local well number: 1004 DD 3002 N 14 E Other number:

Local use: 008 Owner or name: Matt Eddins, Jr.

Owner or name: MATT EDDINS JR Address: Barnett Miss.

Ownership: County, Fed Gov't, City, Corp or Co, Private, State Agency, Water Dist P

Use of water: (A) Air cond, (B) Bottling, (C) Comm, (D) Dewater, (E) Power, (F) Fire, (H) Dom., (I) Irr, (M) Med, (N) Ind, (P) S, Rec, (S) Stock, (T) Instit, (U) Unused, (V) Repressure, (W) Recharge, (X) Desal-P S, (Y) Desal-other, (Z) Other H

Use of well: (A) Anode, (D) Drain, (G) Seismic, (H) Heat Res, (I) Obs, (P) Oil-gas, (R) Recharge, (T) Test, (U) Unused, (W) Withdraw, (X) Waste, (Z) Destroyed W

DATA AVAILABLE: Well data 1 Freq. W/L meas.: Field aquifer char.

Hyd. lab. data:

Qual. water data; type:

Freq. sampling: Pumpage inventory: yes no period:

Aperture cards: yes

Log data:

WELL-DESCRIPTION CARD

SAME AS ON MASTER CARD Depth well: 195 ft Meas. accuracy

Depth cased: 189 ft Casing type: G.I.; Diam. 2 in

Finish: porous concrete, gravel w. concrete, (F) gravel w. screen, (G) gravel w. gallery, (H) horiz. end, (I) open perf., (J) screen, (K) sd. pt., (L) shored, (M) open hole, (N) other

Method Drilled: (A) air bored, (B) cable, (C) dug, (D) hyd rot, (E) jetted, (F) air percussion, (G) reverse, (H) trenching, (I) driven, (J) drive wash, (K) other

Date Drilled: 1965 Pump intake setting: ft

Driller: McDonald & Hill, Meridian, Miss.

Lift (type): (A) air, (B) bucket, (C) cent, (D) jet, (E) multiple, (F) multiple, (G) none, (H) piston, (I) rot, (J) submerg, (K) turb, (L) other Deep Shallow

Power (type): elec nat, gas, gasoline, hand, gas, wind; H.P. 3/4 Trans. or meter no. 5

Descrip. MP ft above LSD. Alt. MP

Alt. LSD: 335 ± Accuracy:

Water Level: 80 ± ft above below MP; Ft below LSD 8.0 Accuracy: rept

Date meas: 10.6 Yield: gpm Method determined

Drawdown: ft Accuracy: hrs

QUALITY OF WATER DATA: Iron ppm Sulfate ppm Chloride ppm Hard. ppm

Sp. Conduct K x 10⁶ Temp. °F Date sampled

Taste, color, etc.

Well No. 24

Latitude-longitude 31.58.46 088.53.58
d m s d m s

HYDROGEOLOGIC CARD

SAME AS ON MASTER CARD
Physiographic Province: Coastal Plain 03 Section: East Gulf
Drainage Basin: Coastal Plain D 131P Subbasin: 26

Topo of well site: (D) depression, (C) stream channel, (E) dunes, (F) flat, (H) hilltop, (K) sink, (L) swamp, (P) offshore, (S) pediment, (T) hillside, (U) terrace, (V) undulating, valley flat
offshore, pediment, hillside, terrace, undulating, valley flat 27

MAJOR AQUIFER: Tertiary system, Eocene series, T.E Cockfield Fm. aquifer, formation, group C-0 30-31

Lithology: Sand US Origin: 2 Aquifer Thickness: ft

Length of well open to: ft 38 6 Depth to top of: ft 41 43 35 37

MINOR AQUIFER: system, series, aquifer, formation, group Aquifer Thickness: ft

Lithology: Origin: 50 Thickness: ft

Length of well open to: ft 54 56 Depth to top of: ft 57 59 31 33

Intervals Screened:

Depth to consolidated rock: ft 60 63 Source of data: 64

Depth to basement: ft 65 68 Source of data: 69

Surficial material: Infiltration characteristics: 70-71 72

Coefficient Trans: gpd/ft 73 75 Coefficient Storage: 76 78

Coefficient Perm: gpd/ft²; Spec cap: gpm/ft; Number of geologic cards: 79

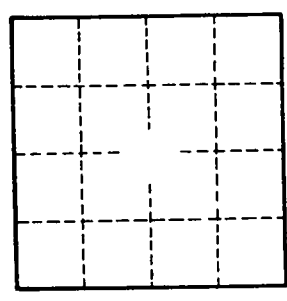
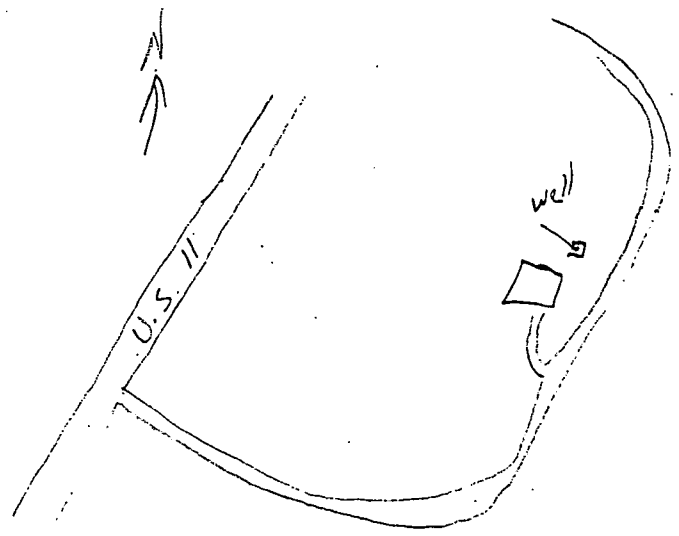

Well No. 24