

TRANSMITTED FOR ADP.

FORM 9-1642 (1-68)

Well No.

627

DoH # 110002-02, GW12548

WELL SCHEDULE

U. S. DEPT. OF THE INTERIOR

GEOLOGICAL SURVEY

WATER RESOURCES DIVISION

MASTER CARD

Record by MAH Source of data BOWC Date 8/19/74 Map Willows

State 139 28 County (or town) Clatsop

Latitude: 32⁰ 20¹ 14^N Longitude: 03⁹ 5⁷ 04^W Sequential number: 1

Lat-Long accuracy: 4⁷⁰ T 12⁹ S, R 3¹¹ Sec 7, NW & SE Irr/Ar irr/arr

Local well number: 6027B D0712 N03E Other number: Well #2

Local use: 060 Owner or name: CS4IWA Address: _____

Ownership: County, Fed Gov't, City, Corp or Co, Private, State Agency, Water Dist 17

Use of water: (A) Air cond, (B) Bottling, (C) Comm, (D) Dewater, (E) Power, (F) Fire, (G) Dom, (H) Irr, (I) Med, (J) Ind, (K) P S, (L) Rec, (M) Stock, (N) Tnstt, (O) Unused, (P) Reprssure, (Q) Recharge, (R) Desal-P S, (S) Desal-other, (T) Other SB

Use of well: (A) Anode, (B) Drain, (C) Seismic, (D) Heat Res, (E) Obs, (F) Oil-gas, (G) Recharge, (H) Test, (I) Unused, (J) Withdraw, (K) Waste, (L) Destroyed. W

DATA AVAILABLE: Well data Freq. W/L meas.: Field aquifer char.

Hyd. lab. data:

Qual. water data; type:

Freq. sampling: Pumpage inventory: yes no, period:

perfor cards: MOCN yes

Log data: Ref Elvg # 73 well # 1 GW

WELL-DESCRIPTION CARD

SAME AS ON MASTER CARD Depth well: 415 ft Meas. 3

Depth cased: 375 ft Casing type: B. steel; Diam. 6 in

Finish: (C) porous concrete, (F) gravel w. (perf.), (G) gravel w. (screen), (H) horiz. gallery, (I) open perf., (J) screen, sd. pt., (K) shored, (L) open hole, (M) other

Method Drilled: (A) air bored, (B) cable, (C) dug, (D) hyd jetted, (E) air rot., (F) percussion, (G) rotary, (H) reverse, (I) trenching, (J) driven, (K) drive wash, (L) other

Date Drilled: 974 Pump intake setting: _____ ft

Driller: Rambow Dring. + Const. Co. name address S

Lift (type): (A) air, (B) bucket, (C) cen., (D) jet, (E) multiple, (F) multiple, (G) none, (H) piston, (I) rot., (J) submerg, (K) turb., (L) other Deep Shallow

Power (type): (A) diesel, (B) elec, (C) gas, (D) gasoline, (E) hand, (F) gas, (G) wind, (H) H.P. 20 Trans. or meter no. _____

Descrip. MP 242 5 ft above below LSD, Alt. MP _____

Alt. LSD: 250 Accuracy: topo

Water Level: 168 ft below MP; Ft below LSD Accuracy: _____

Date meas: 874 Yield: 150 gpm Method determined _____

Drawdown: _____ ft Accuracy: _____ Pumping period _____ hrs

QUALITY OF WATER DATA: Iron _____ ppm Sulfate _____ ppm Chloride _____ ppm Hard. _____ ppm

Sp. Conduct 6 K x 10 6 Temp. _____ °F Date sampled _____

Taste, color, etc. _____

Well casing lowered 1983 20'-25'

7/31/80 WL = 257.

Well No. _____

Latitude-longitude _____

HYDROGEOLOGIC CARD

SAME AS ON MASTER CARD

Physiographic Province: _____

Section: 03

Drainage Basin: D

Subbasin: _____

15L

Topo of well site: (D) depression, stream channel, dunes, flat, hilltop, sink, swamp, (E) offshore, pediment, hillside, terrace, undulating, valley flat

MAJOR AQUIFER:

system _____

series TM

aquifer, formation, group MZ

Lithology: _____

3S

Origin: _____

3

Aquifer Thickness: _____

55 ft

Length of well open to: _____ ft

40

Depth to top of: _____ ft

360

MINOR AQUIFER:

system _____

series _____

aquifer, formation, group _____

Lithology: _____

Origin: _____

Aquifer Thickness: _____

Length of well open to: _____ ft

Depth to top of: _____ ft

Intervals Screened: _____

4" x 40' SS

Depth to consolidated rock: _____ ft

Source of data: _____

Depth to basement: _____ ft

Source of data: _____

Surficial material: _____

Infiltration characteristics: _____

Coefficient Trans: _____

gpd/ft _____

Coefficient Storage: _____

Coefficient Perm: _____

1.1

gpd/ft²; Spec cap: _____

gpm/ft; Number of geologic cards: _____

location sketch see G11

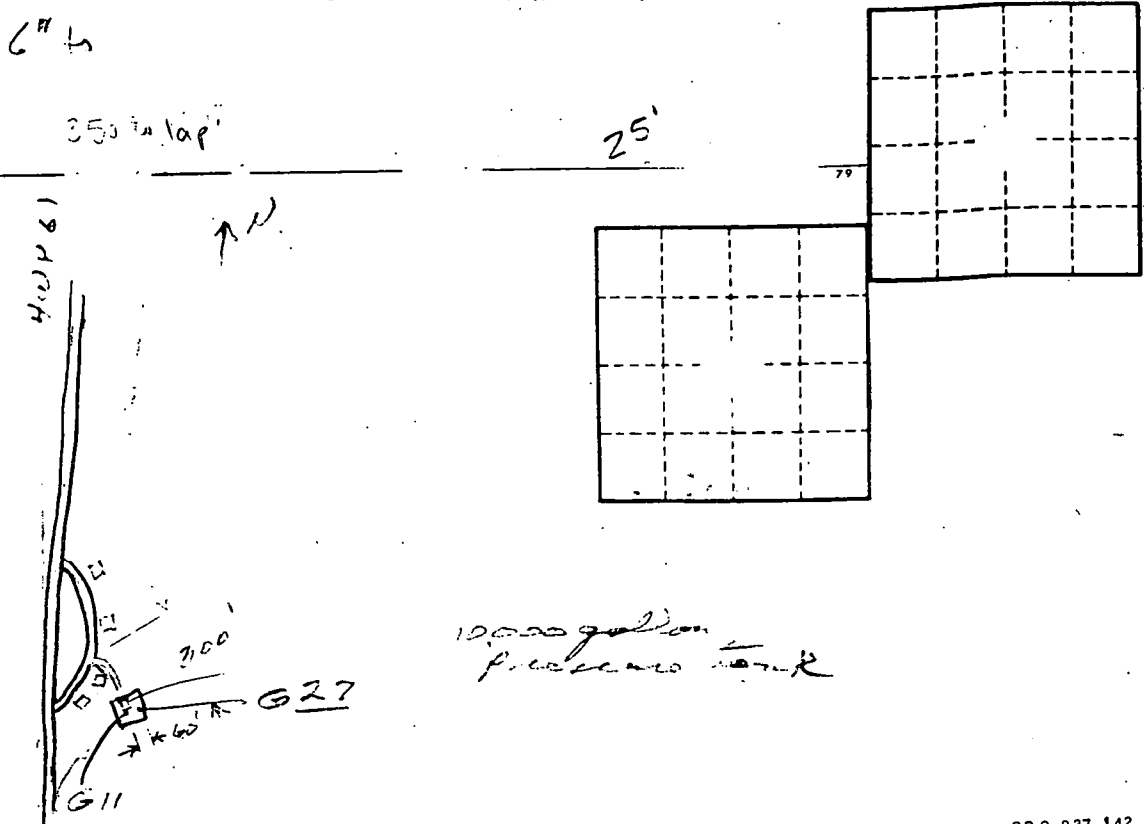

Need better loc.

CLAIBORNE

G 27

8-19-74

CW 12548

8-19

MISSISSIPPI BOARD OF WATER COMMISSIONERS CODED
416 North State Street
Jackson, Mississippi 39201

WATER WELL DRILLERS LOG

date well completed

firm name

county well located

Rayborn Drilling & Const. Claiborne

LANDOWNER:	description of formations encountered	from	to
C & S Water Assoc. (mailing address)			
WELL LOCATION: sec. 2 T. 120 S. R. 3 E. 5 miles N of West Union (distance) (direction) (nearest town)	Red clay	2	30
WELL PURPOSE: Municipal (home, irrigation, municipal, industrial)	Clay	30	80
WELL COMPLETION DATA: (1) diameter (inches) 6" (2) total depth (feet) 425' (3) static water level (feet) 168' below top of ground. (4) casing 6" gal. steel 385' (material) (depth) 6" if telescope see back. (5) screen 40' 375' (length) (depth to top) 4" SS (size) (material) (6) pump 20 HP 150 GPM (HP) (yield gpm) elec. (type power) (7) electric log no (yes or no) (organization running log) (8) how well bottom plugged closed	fine sand	80	100
	blue clay	100	360
	coarse sand	360	425

RECEIVED

NOV - 8 1974

DRILLERS REMARKS:

MISS. BD. OF WATER COMM.

Ⓜ
If well telescopes please sketch and show depths.

GROUND LEVEL

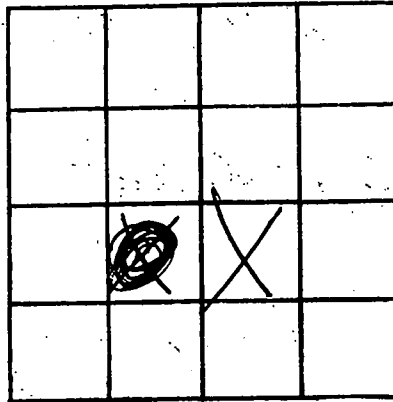

SECTION 2

Please indicate well location X.

ADDITIONAL INFORMATION

If more than one screen, show locations of each on sketch.

DEPARTMENT OF ENVIRONMENTAL QUALITY - OLWR
PUBLIC SUPPLY WELLS PROJECT

GPS LOG

USGS #: G0027 HEALTH DEPT. #: 0110002-02 OLWR #: GW-12548

OWNER: C.S. + I Water Company #2 COUNTY: CLAIBORNE

LOCATION: _____

QUAD: Willows ELEV: _____

GPS FIELD LOCATION: LAT: 32.02747 LONG: 90.94702

LOCATION DESCRIPTION: Intersection Hy 462 + State Hy 61. Go north 1.3
Miles. Well on east side of Hy 61. Between two Trailers.
Furthest well North.

CASING DIAMETER: 6" PUMP TYPE AND H.P.: Sub.

USER NAME(S) RLB DATE: Feb 1-2005 PICTURE #: _____

REMARKS: Tagged

DEPARTMENT OF ENVIRONMENTAL QUALITY - OLWR
PUBLIC SUPPLY WELLS PROJECT

GPS LOG

USER NAME(S): Richard Ingram DATE: 6-16-98
UNIT DEQ #: BPC/GWPB FILE #: _____
HEALTH DEPT. #: 0110002-02 ELEV. 245' *
USGS #: 627 OLWR #: 6W12548
OWNER: C, S, & I w/A QUAD: Willows
LOCATION: 1 RR 1 RR S 7 T12N R 3E COUNTY: Claiborne
LOCATION DESCRIPTION: NW well(?)

CASING DIA: _____ PUMP TYPE & SIZE: _____

GPS FIELD LOCATION: LAT. 32.027478 LONG. 90.947053

*GPS CORRECTED LOCATION: LAT. 32°01'38.92" LONG. 90°56'49.39"

REMARKS: E/ side of Hwy. 61, 1.1 mi. n/ of
Hwy. 462 intersection (north of Port Gibson),
behind center house of 3 houses, unlocked
fenced area w/ green water tank

Verified MSDH well tag #

* well spotted on quad in office from loc. description;
elev. best guess.

* real-time, corrected and averaged data collected

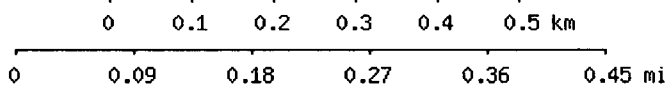

Map center is 32° 01' 39"N, 90° 56' 50"W (WGS84/NAD83)

Willows quadrangle

Projection is UTM Zone 15 NAD83 Datum

