

6778 WTO

DOH # 010000 7-02

6W01733

Recorded by WTO

U.S. GEOLOGICAL SURVEY  
WATER RESOURCES DIVISION  
MISSISSIPPI DISTRICT  
WELL RECORD

Well No. D32

E-Log No. 23

County: CHOCTAW

Ackerman Quad

Date 6/28/78

GPSd 10/29/96 CH

Site ID 332229089113601 R=0\* T=A\* 2=W\*

GEN. SITE DATA

Data reliab. 3=C\* Report. agency 4=USGS\* Dist. 6=28\* 7=28\* Co. 8=019\*

Lat. Long. / 9=332229\* 10=0891136\* Well No. 12=D032\*

Location 13=SESE S 36 T 18 N R 10 E\* Alt. 16=553.\*

Hyd. Unit (OWDC) 20= Date 21=06/28/1978\*

Well use 23=W\* Water Use 24=P\* Hole depth 27=462.\* Well depth 28=399.\*

WL 30=195.\* Date 31=11/01/1978\* Source 33=D\*

Status 273= Project No. 5=

OWNER

R=158\* T=A\* Date 159#11/01/1978\* Owner No. Well #2

Owner 161=REFORM W A

Reform Water Users Association, Inc.

FIELD QW

R=192\* T=A\* Date 193# Temp. 196#00010\* 197=

R=192\* T=A\* Date 193# Cond. 196#00095\* 197=

R=192\* T=A\* Date 193# pH 196#00400\* 197=

CONSTR.

R=58\* T=A\* 59#1\* Date 60=11/01/1978\* Remarks

Drlg. 63=330.\* Name Herndon Method 65=H\* Finish 66=B\*

CASING

R=76\* T=A\* 59#1\*

Top csgn. 77# 0.\* Bot. csgn. 78=360.\* Diam. 79# 10.\*

R=76\* T=A\* 59#1\*

Top csgn. 77# 295.\* Bot. csgn. 78=358.\* Diam. 79# 6.\*

OPENINGS

R=82\* T=A\* 59#1\* Top 83# 358.\* Bottom 84=399.\*

Type 85=S\* Diam. 87=6.\* Size 88=.925\*

R=82\* T=A\* 59#1\* Top 83# Bottom 84=

Type 85= Diam. 87= Size 88=

YIELD

R=146\* T=A\* 147#1\* Q 150=260.\* Q/S 272=

134 flows 146 pumped

R=42\* T= A \* Lift type 43# T\* Intake 44= \* Power type 45= E\*

LIFT Date 38= 11/01/1978\* H.P. 46= 25.\*

R=198\* T= A \* Log 199# D\* Top 200= 0.\* Bot 201= 442.\*

R=198\* T= A \* Log 199# E\* Top 200= 10.\* Bot 201= 462.\*

R=189\* T= A \* E.Log No. 190# 023\* 191= M I S S D I S T \*

ANAL. R=114\* T= A \* Year 115# \* Type 120= \*

R=90\* T= A \* 256# 1 \* Top 91= 350.\* Bot 92= 420.\*

AQUIFERS Unit ID 93= 124XLCXL\* Name of Unit

R=90\* T= A \* 256# 1 \* Top 91= \* Bot 92= \*

Unit ID 93= \* Name of Unit

R=98\* T= A \* 99# 1 \* Unit tested 100= \* 103= \*

R=105\* T= A \* 99# 1 \* Test No. 106# \*

HYDRAULICS 107= \* Transmissivity (gal/d)/ft

108= \* Hydraul. cond. (gal/d)/ft<sup>2</sup>

110= \* Storage coeff. Boundaries

R=121\* T= \* Yr Begin 122# \* Network 258= \*

Water Level Data Collection (1)

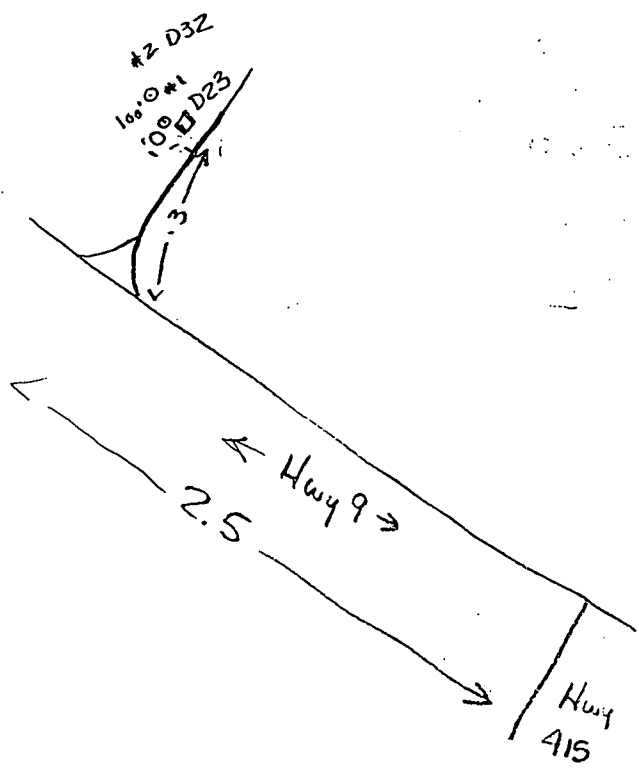

description of formations encountered	from	to
Brown Chalky Clay	0	12
Blue Clay Sand Streaks	12	57
Rock	57	58
Blue Clay	58	110
Sand	110	128
Blue Clay	128	192
Rock	192	193
Blue Clay	193	200
Sand	200	210
Blue Clay, Numerous Streaks of Sand	210	330
Sandy Blue Clay	330	380
Sand	380	415
Blue Clay, Sandy Streaks	415	442

To Ackerman →

CHOCTAW  
 D32  
 1178  
 Elog #23

GW 01733

MISSISSIPPI  
 BOARD OF WATER COMMISSIONERS  
 416 North State Street  
 Jackson, Mississippi 39201

CODED

WATER WELL DRILLERS LOG

November 19 78 Herndon Well & Supply, Inc. Choctaw  
 date well completed firm name county well located

LANDOWNER: Reform Water Users Ass'n., Inc. Reform, MS 39757 (mailing address)	description of formations encountered	from	to
	Brown Chalky Clay	0	12
	Blue Clay Sand Streaks	12	57
	Rock	57	58
	Blue Clay	58	110
	Sand	110	128
	Blue Clay	128	192
	Rock	192	193
	Blue Clay	193	200
	Sand	200	210
	Blue Clay, Numerous Streaks of Sand	210	330
	Sandy Blue Clay	330	380
	Sand	380	415
	Blue Clay, Sandy Streaks	415	442

WELL LOCATION:  
 sec. 36 T. 18 N. R. 10 E  
 X W  
 \_\_\_\_\_ miles \_\_\_\_\_ of \_\_\_\_\_  
 (distance) (direction) (nearest town)

WELL PURPOSE: Municipal  
 (home, irrigation, municipal, industrial)

- WELL COMPLETION DATA:
- (1) diameter (inches) 10 x 6
  - (2) total depth (feet) 442'
  - (3) static water level (feet) 195' below top of ground
  - (4) casing Steel, 360' (material), (depth)  
 10" (size) if telescope see back.
  - (5) screen 41' (length), 358' (depth to top)  
 6" Stainless Bar Weld (size), (material)
  - (6) pump 25 (HP), 260 (yield gpm)  
 Electric (type power)
  - (7) electric log yes (yes or no)  
 U.S.G.S. (organization running log)
  - (8) how well bottom plugged 6" BWV

DRILLERS REMARKS:

REGISTERED  
 NOV 17 1978

MISS. BD. OF WATER COMM

(X)

If well telescopes please sketch and show depths.

GROUND LEVEL

360' of 10" CASING

195' STATIC W/L

Top of LAP 295'

63' of 6" LAP

Top of screen 6" 358'

4' of Stainless bar-weld screen .025

24" Underream

10-30 GRAVEL

Back wash Valve 399'

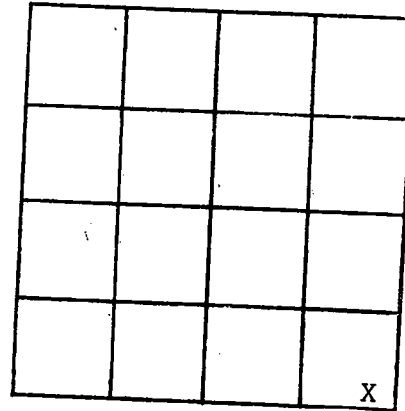

SECTION 36

Please indicate well location X.

ADDITIONAL INFORMATION

If more than one screen, show locations of each on sketch.

DEPARTMENT OF ENVIRONMENTAL QUALITY - OLWR  
PUBLIC SUPPLY WELLS PROJECT

GPS LOG

USER NAME(S): Hornbeak DATE: 10/29/96  
UNIT DEQ #: 82859 FILE #: B102922C  
HEALTH DEPT. #: 100007-02 ELEV. \_\_\_\_\_  
USGS #: D32? OLWR #: GW01733  
OWNER: Reform Water Assoc. QUAD: Acketman / Reform  
LOCATION: SE-SE S 36 T 18N R 10E COUNTY: Choctaw  
LOCATION DESCRIPTION: AT water plant on NW side of Y. Rd. .30 mi.  
NE of Intersection with Hwy 95 (Reform)  
CASING DIA: 10" PUMP TYPE & SIZE: Submersible.  
GPS FIELD LOCATION: LAT. 33° 22' 31.4" LONG. 89° 11' 33.0"  
GPS CORRECTED LOCATION: LAT. 33.37518091 LONG. 89.19312898  
REMARKS: GPS at well.  
\* (Well is the north well of 2 wells in yard.)  
\_\_\_\_\_  
\_\_\_\_\_

294

12'30" NATCHEZ TRACE 5 MI

D32

3150 1 NW (REFORM)

REFORM 4 MI WILLIAMS 1 MI

10'

