

FORM 9-1642
(1-68)

Well No. N18

WELL SCHEDULE

U. S. DEPT. OF THE INTERIOR

GEOLOGICAL SURVEY

WATER RESOURCES DIVISION

PUNCHED FOR RECORD

MASTER CARD

Record by BEE Source of data Clyde Hill Date 10/59 Map Woodland 113-0

State 40 28 County (or town) Chickasaw 09

Latitude: 33 46 38 N Longitude: 08 90 25 53 Sequential number: 1

Lat-long accuracy: 3 15 20 W, Sec 13, SE t. SW t. NW t.

Local well number: N018CB1315502E Other number: Family Woodland

Local use: 139 Owner or name: Colored School Night

Owner or name: KAUL GLOVE CO. Address: _____

Ownership: (C) County, (F) Fed Gov't, (M) City, Corp or Co, (N) Private, (P) State Agency, (S) Water Dist, (W) _____ C

Use of well: (A) Air cond, (B) Bottling, (C) Comm, (D) Dewater, (E) Power, (F) Fire, (G) Dom, (H) Irr, (I) Med, (J) Ind, (K) P S, (L) Rec, (M) _____, (N) _____, (O) _____, (P) _____, (Q) _____, (R) _____, (S) _____, (T) _____, (U) _____, (V) _____, (W) _____, (X) _____, (Y) _____, (Z) _____ 11

Use of well: (A) Anode, (B) Drain, (C) Seismic, (D) Heat Res, (E) Obs, (F) Oil-gas, (G) Recharge, (H) Test, (I) Unused, (J) Withdraw, (K) Waste, (L) Destroyed, (M) _____, (N) _____, (O) _____, (P) _____, (Q) _____, (R) _____, (S) _____, (T) _____, (U) _____, (V) _____, (W) _____, (X) _____, (Y) _____, (Z) _____ U

DATA AVAILABLE: Well data Freq. W/L meas.: Field aquifer char.

Hyd. lab. data: _____

Qual. water data; type: _____

Freq. sampling: _____ Pumpage inventory: yes, no, period: _____

Aperture cards: _____

Log data: _____

WELL-DESCRIPTION CARD

SAME AS ON MASTER CARD Depth well: _____ ft 1200 Meas. accuracy 6

Depth cased: _____ ft _____ Casing type: _____; Diam. _____ in 4

Finish: (C) porous concrete, (F) gravel w. (perf.), (G) gravel w. (screen), (H) horiz. gallery, (I) open end, (J) horiz. gallery, (K) open end, (L) screen, (M) other, (N) _____, (O) _____, (P) _____, (Q) _____, (R) _____, (S) _____, (T) _____, (U) _____, (V) _____, (W) _____, (X) _____, (Y) _____, (Z) _____ X

Method: (A) air rot, (B) bored, (C) cable, (D) dug, (E) hyd, (F) jetted, (G) air rot., (H) reverse percussion, (I) trenching, (J) driven, (K) drive wash, (L) other, (M) _____, (N) _____, (O) _____, (P) _____, (Q) _____, (R) _____, (S) _____, (T) _____, (U) _____, (V) _____, (W) _____, (X) _____, (Y) _____, (Z) _____ H

Date Drilled: 953 Pump intake setting: _____ ft _____

Driller: SMITH

Lift (type): (A) air, (B) bucket, (C) cent, (D) jet, (E) multiple, (F) multiple, (G) none, (H) piston, (I) rot, (J) submerg, (K) turb, (L) other, (M) _____, (N) _____, (O) _____, (P) _____, (Q) _____, (R) _____, (S) _____, (T) _____, (U) _____, (V) _____, (W) _____, (X) _____, (Y) _____, (Z) _____ N Deep Shallow

Power (type): (A) diesel, (B) elec, (C) nat gas, (D) gasoline, (E) hand, (F) gas, (G) wind, (H) H.P., (I) _____, (J) _____, (K) _____, (L) _____, (M) _____, (N) _____, (O) _____, (P) _____, (Q) _____, (R) _____, (S) _____, (T) _____, (U) _____, (V) _____, (W) _____, (X) _____, (Y) _____, (Z) _____ elec

Trans. or meter no. _____

Descrip. MP _____ ft above _____ ft below LSD, Alt. MP _____

Alt. LSD: _____ Accuracy: (source) _____ 315

Water Level: _____ ft above _____ ft below MP; _____ ft below LSD 115 Accuracy: _____

Date meas.: N70 Yield: _____ gpm _____ Method determined _____

Drawdown: _____ ft _____ Accuracy: _____ Pumping period _____ hrs _____

QUALITY OF WATER DATA: Iron _____ ppm Sulfate _____ ppm Chloride _____ ppm Hard. _____ ppm

Sp. Conduct _____ K x 10⁶ _____ Temp. _____ °F _____ Date sampled _____

Taste, color, etc.

5/11/92
DH
175.00
28.28
146.72

Well No. N18

concrete block
on top of hole 12/17/92
water tank
located 1 ft. SE of
camp open at 67

218

Well No.

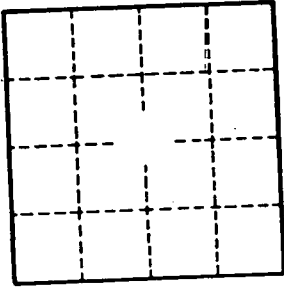

Well 15

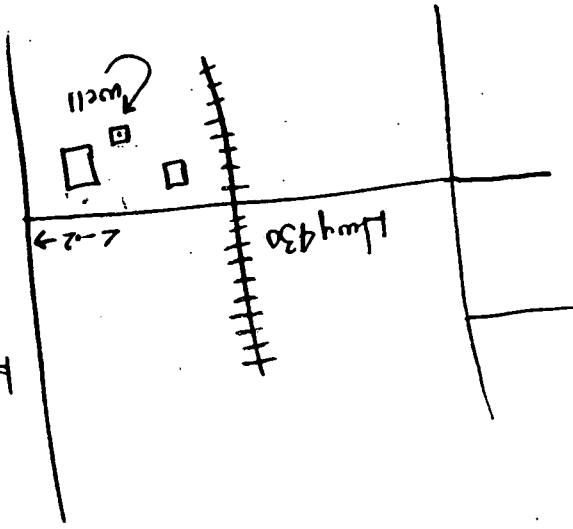

Position of the well - well not
used pump will be pushed.
New Owner Kone Above Co. (Recovery)

HYDROGEOLOGIC CARD

1 **SAME AS ON MASTER CARD**

2 **Physiographic Province:**

3 **Section:** **0.3**

4 **Drainage Basin:** **13E**

5 **Subbasin:**

6 **Topo of well site:** (A) depression, stream channel, dunes, flat, hillock, sink, swamp, (B) flat, hillock, (C) flat, hillock, terrace, undulating, valley flat, (D) ofshore, pediment, hillside, terrace, (E) flat

7 **MAJOR AQUIFER:** **K3**

8 **MINOR AQUIFER:**

9 **system:** **series:**

10 **Origin:** **5**

11 **Depth to top of:** **ft.**

12 **Length of well open to:** **ft.**

13 **MAJOR AQUIFER:** **series:**

14 **Origin:** **48**

15 **system:** **series:**

16 **Origin:**

17 **Thickness:** **ft.**

18 **MAJOR AQUIFER:** **series:**

19 **Origin:**

20 **Thickness:** **ft.**

21 **MAJOR AQUIFER:** **series:**

22 **Origin:**

23 **Thickness:** **ft.**

24 **MAJOR AQUIFER:** **series:**

25 **Origin:**

26 **Thickness:** **ft.**

27 **MAJOR AQUIFER:** **series:**

28 **Origin:**

29 **Thickness:** **ft.**

30 **MAJOR AQUIFER:** **series:**

31 **Origin:**

32 **Thickness:** **ft.**

33 **MAJOR AQUIFER:** **series:**

34 **Origin:**

35 **Thickness:** **ft.**

36 **MAJOR AQUIFER:** **series:**

37 **Origin:**

38 **Thickness:** **ft.**

39 **MAJOR AQUIFER:** **series:**

40 **Origin:**

41 **Thickness:** **ft.**

42 **MAJOR AQUIFER:** **series:**

43 **Origin:**

44 **Thickness:** **ft.**

45 **MAJOR AQUIFER:** **series:**

46 **Origin:**

47 **Thickness:** **ft.**

48 **MAJOR AQUIFER:** **series:**

49 **Origin:**

50 **Thickness:** **ft.**

51 **MAJOR AQUIFER:** **series:**

52 **Origin:**

53 **Thickness:** **ft.**

54 **MAJOR AQUIFER:** **series:**

55 **Origin:**

56 **Thickness:** **ft.**

57 **MAJOR AQUIFER:** **series:**

58 **Origin:**

59 **Thickness:** **ft.**

60 **MAJOR AQUIFER:** **series:**

61 **Origin:**

62 **Thickness:** **ft.**

63 **MAJOR AQUIFER:** **series:**

64 **Origin:**

65 **Thickness:** **ft.**

66 **MAJOR AQUIFER:** **series:**

67 **Origin:**

68 **Thickness:** **ft.**

69 **MAJOR AQUIFER:** **series:**

70 **Origin:**

71 **Thickness:** **ft.**

72 **MAJOR AQUIFER:** **series:**

73 **Origin:**

74 **Thickness:** **ft.**

75 **MAJOR AQUIFER:** **series:**

76 **Origin:**

77 **Thickness:** **ft.**

78 **MAJOR AQUIFER:** **series:**

79 **Origin:**

80 **Thickness:** **ft.**

81 **MAJOR AQUIFER:** **series:**

82 **Origin:**

83 **Thickness:** **ft.**

84 **MAJOR AQUIFER:** **series:**

85 **Origin:**

86 **Thickness:** **ft.**

87 **MAJOR AQUIFER:** **series:**

88 **Origin:**

89 **Thickness:** **ft.**

90 **MAJOR AQUIFER:** **series:**

91 **Origin:**

92 **Thickness:** **ft.**

93 **MAJOR AQUIFER:** **series:**

94 **Origin:**

95 **Thickness:** **ft.**

96 **MAJOR AQUIFER:** **series:**

97 **Origin:**

98 **Thickness:** **ft.**

99 **MAJOR AQUIFER:** **series:**

100 **Origin:**

101 **Thickness:** **ft.**

102 **MAJOR AQUIFER:** **series:**

103 **Origin:**

104 **Thickness:** **ft.**

105 **MAJOR AQUIFER:** **series:**

106 **Origin:**

107 **Thickness:** **ft.**

108 **MAJOR AQUIFER:** **series:**

109 **Origin:**

110 **Thickness:** **ft.**

111 **MAJOR AQUIFER:** **series:**

112 **Origin:**

113 **Thickness:** **ft.**

114 **MAJOR AQUIFER:** **series:**

115 **Origin:**

116 **Thickness:** **ft.**

117 **MAJOR AQUIFER:** **series:**

118 **Origin:**

119 **Thickness:** **ft.**

120 **MAJOR AQUIFER:** **series:**

121 **Origin:**

122 **Thickness:** **ft.**

123 **MAJOR AQUIFER:** **series:**

124 **Origin:**

125 **Thickness:** **ft.**

126 **MAJOR AQUIFER:** **series:**

127 **Origin:**

128 **Thickness:** **ft.**

129 **MAJOR AQUIFER:** **series:**

130 **Origin:**

131 **Thickness:** **ft.**

132 **MAJOR AQUIFER:** **series:**

133 **Origin:**

134 **Thickness:** **ft.**

135 **MAJOR AQUIFER:** **series:**

136 **Origin:**

137 **Thickness:** **ft.**

138 **MAJOR AQUIFER:** **series:**

139 **Origin:**

140 **Thickness:** **ft.**

141 **MAJOR AQUIFER:** **series:**

142 **Origin:**

143 **Thickness:** **ft.**

144 **MAJOR AQUIFER:** **series:**

145 **Origin:**

146 **Thickness:** **ft.**

147 **MAJOR AQUIFER:** **series:**

148 **Origin:**

149 **Thickness:** **ft.**

150 **MAJOR AQUIFER:** **series:**

151 **Origin:**

152 **Thickness:** **ft.**

153 **MAJOR AQUIFER:** **series:**

154 **Origin:**

155 **Thickness:** **ft.**

156 **MAJOR AQUIFER:** **series:**

157 **Origin:**

158 **Thickness:** **ft.**

159 **MAJOR AQUIFER:** **series:**

160 **Origin:**

161 **Thickness:** **ft.**

162 **MAJOR AQUIFER:** **series:**

163 **Origin:**

164 **Thickness:** **ft.**

165 **MAJOR AQUIFER:** **series:**

166 **Origin:**

167 **Thickness:** **ft.**

168 **MAJOR AQUIFER:** **series:**

169 **Origin:**

170 **Thickness:** **ft.**

171 **MAJOR AQUIFER:** **series:**

172 **Origin:**

173 **Thickness:** **ft.**

174 **MAJOR AQUIFER:** **series:**

175 **Origin:**

176 **Thickness:** **ft.**

177 **MAJOR AQUIFER:** **series:**

178 **Origin:**

179 **Thickness:** **ft.**

180 **MAJOR AQUIFER:** **series:**

181 **Origin:**

182 **Thickness:** **ft.**

183 **MAJOR AQUIFER:** **series:**

184 **Origin:**

185 **Thickness:** **ft.**

186 **MAJOR AQUIFER:** **series:**

187 **Origin:**

188 **Thickness:** **ft.**

189 **MAJOR AQUIFER:** **series:**

190 **Origin:**

191 **Thickness:** **ft.**

192 **MAJOR AQUIFER:** **series:**

193 **Origin:**

194 **Thickness:** **ft.**

195 **MAJOR AQUIFER:** **series:**

196 **Origin:**

197 **Thickness:** **ft.**

198 **MAJOR AQUIFER:** **series:**

199 **Origin:**

200 **Thickness:** **ft.**

201 **MAJOR AQUIFER:** **series:**

202 **Origin:**

203 **Thickness:** **ft.**

204 **MAJOR AQUIFER:** **series:**

205 **Origin:**

206 **Thickness:** **ft.**

207 **MAJOR AQUIFER:** **series:**

208 **Origin:**

209 **Thickness:** **ft.**

210 **MAJOR AQUIFER:** **series:**

211 **Origin:**

212 **Thickness:** **ft.**

213 **MAJOR AQUIFER:** **series:**

214 **Origin:**

215 **Thickness:** **ft.**

216 **MAJOR AQUIFER:** **series:**

217 **Origin:**

218 **Thickness:** **ft.**

219 **MAJOR AQUIFER:** **series:**

220 **Origin:**

221 **Thickness:** **ft.**

222 **MAJOR AQUIFER:** **series:**

223 **Origin:**

224 **Thickness:** **ft.**

225 **MAJOR AQUIFER:** **series:**

226 **Origin:**

227 **Thickness:** **ft.**

228 **MAJOR AQUIFER:** **series:**

229 **Origin:**

230 **Thickness:** **ft.**

231 **MAJOR AQUIFER:** **series:**

232 **Origin:**

233 **Thickness:** **ft.**

234 **MAJOR AQUIFER:** **series:**

235 **Origin:**

236 **Thickness:** **ft.**

237 **MAJOR AQUIFER:** **series:**

238 **Origin:**

239 **Thickness:** **ft.**

240 **MAJOR AQUIFER:** **series:**

241 **Origin:**

242 **Thickness:** **ft.**

243 **MAJOR AQUIFER:** **series:**

244 **Origin:**

245 **Thickness:** **ft.**

246 **MAJOR AQUIFER:** **series:**

247 **Origin:**

248 **Thickness:** **ft.**

249 **MAJOR AQUIFER:** **series:**

250 **Origin:**

251 **Thickness:** **ft.**

252 **MAJOR AQUIFER:** **series:**

253 **Origin:**

254 **Thickness:** **ft.**

255 **MAJOR AQUIFER:** **series:**

256 **Origin:**

257 **Thickness:** **ft.**

258 **MAJOR AQUIFER:** **series:**

259 **Origin:**

260 **Thickness:** **ft.**

261 **MAJOR AQUIFER:** **series:**

262 **Origin:**

263 **Thickness:** **ft.**

264 **MAJOR AQUIFER:** **series:**

265 **Origin:**

266 **Thickness:** **ft.**

267 **MAJOR AQUIFER:** **series:**

268 **Origin:**

269 **Thickness:** **ft.**

270 **MAJOR AQUIFER:** **series:**

271 **Origin:**

272 **Thickness:** **ft.**

273 **MAJOR AQUIFER:** **series:**

274 **Origin:**

275 **Thickness:** **ft.**

276 **MAJOR AQUIFER:** **series:**

277 **Origin:**

278 **Thickness:** **ft.**

279 **MAJOR AQUIFER:** **series:**

280 **Origin:**

281 **Thickness:** **ft.**

282 **MAJOR AQUIFER:** **series:**

283 **Origin:**

284 **Thickness:** **ft.**

285 **MAJOR AQUIFER:** **series:**

286 **Origin:**

287 **Thickness:** **ft.**

288 **MAJOR AQUIFER:** **series:**

289 **Origin:**

290 **Thickness:** **ft.**

291 **MAJOR AQUIFER:** **series:**

292 **Origin:**

293 **Thickness:** **ft.**

294 **MAJOR AQUIFER:** **series:**

295 **Origin:**

296 **Thickness:** **ft.**

297 **MAJOR AQUIFER:** **series:**

298 **Origin:**

299 **Thickness:** **ft.**

300 **MAJOR AQUIFER:** **series:**

301 **Origin:**

302 **Thickness:** **ft.**

303 **MAJOR AQUIFER:** **series:**

304 **Origin:**

305 **Thickness:** **ft.**

306 **MAJOR AQUIFER:** **series:**

307 **Origin:**

308 **Thickness:** **ft.**

309 **MAJOR AQUIFER:** **series:**

310 **Origin:**

311 **Thickness:** **ft.**

312 **MAJOR AQUIFER:** **series:**

313 **Origin:**

314 **Thickness:** **ft.**

315 **MAJOR AQUIFER:** **series:**

316 **Origin:**

317 **Thickness:** **ft.**

318 **MAJOR AQUIFER:** **series:**

319 **Origin:**

320 **Thickness:** **ft.**

321 **MAJOR AQUIFER:** **series:**

322 **Origin:**

323 **Thickness:** **ft.**

324 **MAJOR AQUIFER:** **series:**

325 **Origin:**

326 **Thickness:** **ft.**

327 **MAJOR AQUIFER:** **series:**

328 **Origin:**

329 **Thickness:** **ft.**

330 **MAJOR AQUIFER:** **series:**

331 **Origin:**

332 **Thickness:** **ft.**

333 **MAJOR AQUIFER:** **series:**

334 **Origin:**

335 **Thickness:** **ft.**

336 **MAJOR AQUIFER:** **series:**

337 **Origin:**

338 **Thickness:** **ft.**

339 **MAJOR AQUIFER:** **series:**

340 **Origin:**

341 **Thickness:** **ft.**

342 **MAJOR AQUIFER:** **series:**

343 **Origin:**

344 **Thickness:** **ft.**

345 **MAJOR AQUIFER:** **series:**

346 **Origin:**

347 **Thickness:** **ft.**

348 **MAJOR AQUIFER:** **series:**

349 **Origin:**

350 **Thickness:** **ft.**

351 **MAJOR AQUIFER:** **series:**

352 **Origin:**

353 **Thickness:** **ft.**

354 **MAJOR AQUIFER:** **series:**

355 **Origin:**

356 **Thickness:** **ft.**

357 **MAJOR AQUIFER:** **series:**

358 **Origin:**

359 **Thickness:** **ft.**

360 **MAJOR AQUIFER:** **series:**

361 **Origin:**

362 **Thickness:** **ft.**

363 **MAJOR AQUIFER:** **series:**

364 **Origin:**

365 **Thickness:** **ft.**

366 **MAJOR AQUIFER:** **series:**

367 **Origin:**

368 **Thickness:** **ft.**

369 **MAJOR AQUIFER:** **series:**

370 **Origin:**

371 **Thickness:** **ft.**

372 **MAJOR AQUIFER:** **series:**

373 **Origin:**

374 **Thickness:** **ft.**

375 **MAJOR AQUIFER:** **series:**

376 **Origin:**

377 **Thickness:** **ft.**

378 **MAJOR AQUIFER:** **series:**

379 **Origin:**

380 **Thickness:** **ft.**

381 **MAJOR AQUIFER:** **series:**

382 **Origin:**

383 **Thickness:** **ft.**

384 **MAJOR AQUIFER:** **series:**

385 **Origin:**

386 **Thickness:** **ft.**

387 **MAJOR AQUIFER:** **series:**

388 **Origin:**

389 **Thickness:** **ft.**

390 **MAJOR AQUIFER:** **series:**

391 **Origin:**

392 **Thickness:** **ft.**

393 **MAJOR AQUIFER:** **series:**

394 **Origin:**

395 **Thickness:** **ft.**

396 **MAJOR AQUIFER:** **series:**

397 **Origin:**

398 **Thickness:** **ft.**

399 **MAJOR AQUIFER:** **series:**

400 **Origin:**

401 **Thickness:** **ft.**

402 **MAJOR AQUIFER:** **series:**

403 **Origin:**

404 **Thickness:** **ft.**

405 **MAJOR AQUIFER:** **series:**

406 **Origin:**

407 **Thickness:** **ft.**

408 **MAJOR AQUIFER:** **series:**

409 **Origin:**

410 **Thickness:** **ft.**

411 **MAJOR AQUIFER:** **series:**

412 **Origin:**

413 **Thickness:** **ft.**

414