

12/17/91

Couldnt unscrew pipe to get tape down
Check later in future to see if abandoned

5-4-92
well will be
fixed so it can
be measured

FORM 9-1642
(1-68)

Well No. L 25

WELL SCHEDULE

U. S. DEPT. OF THE INTERIOR GEOLOGICAL SURVEY WATER RESOURCES DIVISION

MASTER CARD

Record by J. S. Source of data BONC Date 4/69 Map Buena Vista

State 28 County Chickasaw 09

Latitude: 33⁵2³4^N Longitude: 08⁸5⁰1⁰ Sequential number: 1

Lat-long accuracy: 3 T. 14 N. R. 4 W. Sec. 12 NW. NE. SW.

Local well number: 4025AC1214E04E Other number: B & M

Local use: 021 Owner or name: H. L. PARICHMAN Address: Buena Vista

Ownership: County, Fed Gov't, City, Corp or Co, Private, State Agency, Water Dist 1

Use of water: (A) Air cond, (B) Bottling, (C) Comm, (D) Dewater, (E) Power, (F) Fire, (G) Dom, (H) Irr, (I) Mad, (J) P S, (K) Rec, (L) Stock, (M) Instit, (N) Unused, (O) Repressure, (P) Recharge, (Q) Desal-P S, (R) Desal-other, (S) Other 1

Use of well: (A) Anode, (B) Drain, (C) Seismic, (D) Heat Res, (E) Obs, (F) Oil-gas, (G) Recharge, (H) Test, (I) Unused, (J) Withdraw, (K) Waste, (L) Destroyed W

DATA AVAILABLE: Well data Freq. W/L meas.: 7 Field aquifer char.

Hyd. lab. data:

Qual. water data; type:

Freq. sampling: Pumpage inventory: yes no; period:

Aperture cards: yes

Log data: 1

WELL-DESCRIPTION CARD

SAME AS ON MASTER CARD Depth well: 700 ft Meas. 1 Depth cased: 4 ft Casing type: 4x2 in; Diam. 4x2 in

Finish: (C) concrete, (F) porous gravel w. (G) gravel w. (H) horis. open (I) perf., (J) screen, (K) sd. pt., (L) shored, (M) open (N) hble, (O) other P

Method: (A) air bored, (B) cable, (C) dug, (D) hyd jetted, (E) air rot., (F) percussion, (G) rotary, (H) reverse, (I) trenching, (J) driven, (K) drive wash, (L) other 1

Date Drilled: 9-6-6 Pump intake setting: 33 ft

Driller: 34 name 34 address 34

Lift (type): (A) air, (B) bucket, (C) cent. jet, (D) multiple, (E) multiple, (F) none, (G) piston, (H) rot., (I) submerg, (J) turb., (K) other 39 Deep Shallow

Power (type): diesel, elec, nat gas, gasoline, hand. gas, wind; H.P. 3/4 Trans. or meter no. 41

Descr. MP B42 1/97 ft above LSD, Alt. MP 47

Alt. LSD: 325 Accuracy: 5

Water Level 140 ft above MP; Ft below LSD 140 Accuracy: 52

Date meas: 4-6-6 Yield: 6 gpm Method determined 61

Drawdown: 6 ft Accuracy: 65 Pumping period: 68 hrs

QUALITY OF WATER DATA: Iron ppm 69 Sulfate ppm 70 Chloride ppm 71 Hard. ppm 72

Sp. Conduct 73 K x 10⁶ Temp. 74 °F Date sampled 75

Taste, color, etc. 76

PUNCHED AND VERIFIED

Well No.

Well No. L 25

Latitude-longitude _____
 N
 S

HYDROGEOLOGIC CARD

Physiographic Province: 03 **Section:** _____

Drainage Basin: D **Subbasin:** 135

Topo of well site: (D) depression, stream channel, dunes, flat, hilltop, sink, swamp, (E) offshore, pediment, hillside, terrace, undulating, valley flat

MAJOR AQUIFER: system _____ series K3 aquifer, formation, group E4

Lithology: _____ **Origin:** 6 **Aquifer Thickness:** 120 ft

Length of well open to: _____ ft **Depth to top of:** 580 ft

MINOR AQUIFER: system _____ series _____ aquifer, formation, group _____

Lithology: _____ **Origin:** _____ **Aquifer Thickness:** _____ ft

Length of well open to: _____ ft **Depth to top of:** _____ ft

Intervals Screened: probably perforated

Depth to consolidated rock: _____ ft **Source of data:** _____

Depth to basement: _____ ft **Source of data:** _____

Surficial material: _____ **Infiltration characteristics:** _____

Coefficient Trans: _____ **Coefficient Storage:** _____

Perm: _____ **Spec cap:** _____ **Number of geologic cards:** _____

314 ft of 4-inch
 399 ft 2-inch (Must have about 13 ft logged)

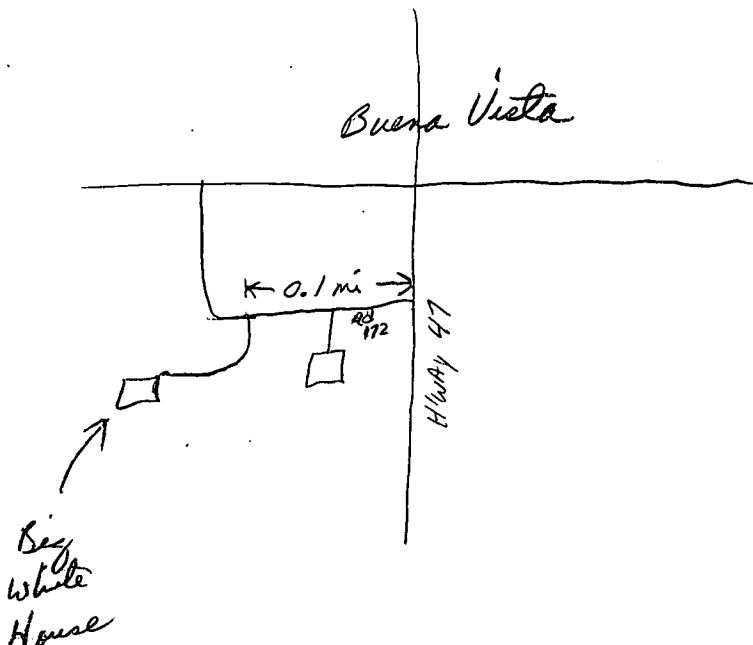
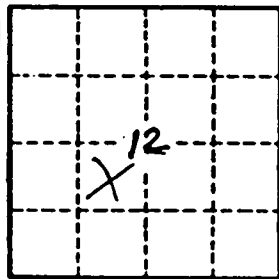

Well No. L 25