

can't get good measurement too muddy
Man said rod fell in well.

omit

County Map Location
direct

W&D Exp. (GW) April 1966 Well No. L-20
WELL SCHEDULE Exp # 35
U. S. DEPT. OF THE INTERIOR GEOLOGICAL SURVEY WATER RESOURCES DIVISION

114-B
BUENA VISTA

Record by V E Warren Source of data Driller Date 12-8-67 Map V. 114-1

State Illinois County (or town) Chickasaw Sequential number: 1

Latitude: 33° 53' 53" N Longitude: 088° 50' 20" W

Lat-long accuracy: 3 T. 140 R. 4 S. Sec 1 NW NW

Local well number: 20205B0114504E Other number: B & H

Local use: 021033 Owner or name: Bernice Thompson

Owner or name: B. THOMPSON Address: Bernice Thompson

Ownership: County, Fed Gov't, City, Corp or Co, Private, State Agency, Water Dist

Use of water: (A) Air cond, bottling, Comm, Dewater, Power, Fire, (H) Irr, Med, Ind, P S, Rec, (S) Stock, Irrit, Unused, Recharge, Desal-P S, Desal-other, Other

Use of well: (A) Anode, Drain, Seismic, Heat Res, Obs, Oil-gas, Recharge, Test, Unused, (W) Withdraw, Waste, Destroyed

Data Available: Well data Freq. W/L meas.: Field aquifer char.

Hvd. Lab. data:

Qual. water data:

Freq. sampling: Pumpage inventory: period:

Appeture cards:

Log data: 5' to 140-594 ft

WELL-DESCRIPTION CARD

SAME AS ON MASTER CARD Depth well: 594 ft Meas. repr. accuracy 3

Depth cased: 21 ft Casing Type: Steel Diam. 5 in

Material: (F) porous concrete, (G) gravel w. screen, (H) horiz. gallery, (I) open perf., (J) sd. pt., (K) shored, (L) open hole, other

Method: (A) air, (B) bored, (C) cable, (D) aug., (E) hyd., (F) jetted, (G) air percussion, (H) reverse trenching, (I) driven, (J) drive wash, other

Date Drilled: 12-8-67 9-6-67 Pump intake setting: 9 ft

Driller: Harold Thompson address Chickasaw

List: (A) air, bucket, cent, jet, (cent.) (turb.) multiple, multiple, none, piston, rot, submerg, turb, other Deep Shallow

Power: (fix.) diesel, elec, gas, gasoline, hand, gas, wind; H.P. Trans. or meter no.

Descript. MP OK (10/89) ft above LSD. Alt. MP

Alt. LSD: 350 Accuracy: (source)

Water Level: 148 ft above below MP; 148 LSD Accuracy: (D)

Date mess: 12-8-67 2-6-71 Yield: 2 gpm Method determined

Drawdown: 2 ft Accuracy: 30 Pumping period: 1 hr

QUALITY OF WATER DATA: Iron Sulfate Chloride Hard.

Sp. Conduct 6 K x 10⁶ temp. 74 °F Date sampled 77 79

Taste, color, etc.

ROLLA COUNTY CLERK'S OFFICE

Well No. L-20

Well No. L-20

Latitude-longitude N
S
d m s d m s

HYDROGEOLOGIC CARD

SAME AS ON MASTER CARD Physiographic Province: _____ Section: 03

Drainage Basin: D Subbasin: 113E

Topo of well site: (D) depression, stream channel, dunes, flat, (H) hilltop, sink, swamp, (L) offshore, pediment, hillside, terrace, undulating, valley flat
(C) (E) (F) (G) (I) (J) (K) (L) (M) (N) (O) (P) (Q) (R) (S) (T) (U) (V) (W) (X) (Y) (Z)

MAJOR AQUIFER: K3 Eutaw EU
system series aquifer, formation, group

Lithology: S Origin: 6 Aquifer Thickness: 74 ft

Length of well open to: _____ ft 74 Depth to top of: _____ ft 519

MINOR AQUIFER: _____ _____ _____ _____
system series aquifer, formation, group

Lithology: _____ Origin: _____ Aquifer Thickness: _____ ft

Length of well open to: _____ ft _____ Depth to top of: _____ ft _____

Intervals Screened: open

Depth to consolidated rock: _____ ft _____ Source of data: _____

Depth to basement: _____ ft _____ Source of data: _____

Surficial material: _____ Infiltration characteristics: _____

Coefficient Trans: _____ gpd/ft _____ Coefficient Storage: _____

Coefficient Perm: _____ gpd/ft²; Spec cap: _____ gpm/ft; Number of geologic cards: _____

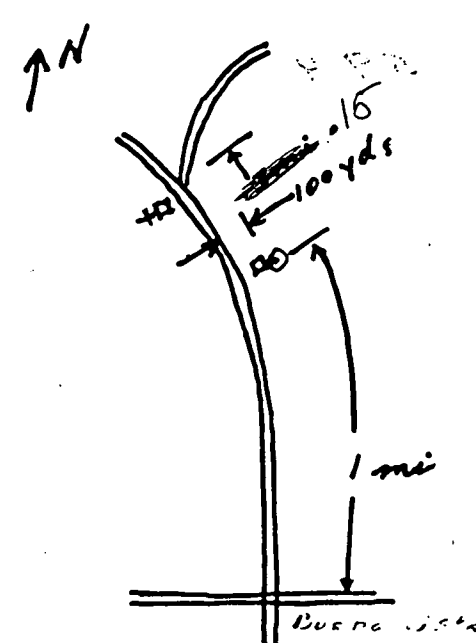

Arcola @ 396'
Eutaw @ 516'

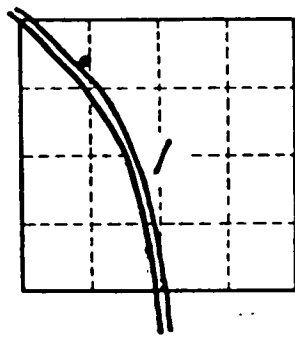

Well No. L-20