

DOT # 009007-02

GW01384

GW1384

GPSd 7/31/97 PP/DH

D19

FORM 9-1642 (1-68)

Well No.

WELL SCHEDULE

U. S. DEPT. OF THE INTERIOR

GEOLOGICAL SURVEY

WATER RESOURCES DIVISION

MASTER CARD

Record by BEE/WTO Source of data driller Date 10/58 Map EGYPT 215-A

State 28 County (or town) Cherkasov 09

Latitude: 33⁵59⁵58⁸ N Longitude: 08⁸45⁰11 S Sequential number: 1

Lat-long accuracy: 3 T. 12 R. 5 Sec 35 NE NW

Local well number: D019AB3512505E Other number: Well #1

Local use: 009 Owner or name: Silver Str.

Owner or name: OKOLANA Address: _____

Ownership: County, Fed Gov't, (M) City, Corp or Co, Private, (S) State Agency, Water Dist M

Use of water: (A) Air cond, (B) Bottling, (C) Comm, (D) Dewater, (E) Power, (F) Fire, (G) Dom, (H) Irr, (I) Med, (J) Ind, (K) P S, (L) Rec, (M) Stock, (N) Instit, (O) Unused, (P) Repressure, (Q) Recharge, (R) Desal-P S, (S) Desal-other, (T) Other P

Use of well: (A) Anode, (B) Drain, (C) Seismic, (D) Heat Res, (E) Obs, (F) Oil-gas, (G) Recharge, (H) Test, (I) Unused, (J) Withdraw, (K) Waste, (L) Destroyed W

DATA AVAILABLE: Well data Freq. W/L meas.: Field aquifer char.

Hyd. lab. data:

Qual. water data; type: USGS 4/75

Freq. sampling: Pumpage inventory: no, period:

Aperture cards:

Log data: samples

WELL-DESCRIPTION CARD

SAME AS ON MASTER CARD Depth well: TD 570 ft 562 Meas. rept. 3

Depth cased; (first perf.): 506 ft Casing type: _____; Diam. 12 in

Finish: porous concrete, gravel w. (perf.), gravel w. (screen), horiz. gallery, open perf., screen, sd. pt., shored, open hole, other G

Method Drilled: (A) air bored, (B) cable, (C) dug, (D) hyd jetted, (E) air rot., (F) reverse, (G) percussive, (H) rotary, (I) air, (J) air, (K) air, (L) air, (M) air, (N) air, (O) air, (P) air, (Q) air, (R) air, (S) air, (T) air, (U) air, (V) air, (W) air, (X) air, (Y) air, (Z) air A

Date Drilled: 9/58 Pump intake setting: _____ ft

Driller: CARLOSS WELL SUPPLY

Lift (type): (A) air, (B) bucket, (C) cent, (D) jet, (E) multiple, (F) multiple, (G) none, (H) piston, (I) rot, (J) submerg, (K) turb, (L) other T Deep Shallow

Power (type): (A) diesel, (B) elec, (C) gas, (D) gasoline, (E) hand, (F) gas, (G) wind, (H) H.P. 40 V Trans. or meter no. _____

Descrip. MP OK (10/89) ft above below LSD, Alt. MP _____

Alt. LSD: 317 Accuracy: (source) topo 4

Water Level: _____ ft above below MP; Ft below LSD 14 Accuracy: _____ D

Date meas: N 5/8 Yield: _____ gpm 600 Method determined _____

Drawdown: _____ ft 7.0 Accuracy: @ 419 gpm Pumping period: _____ hrs 7

QUALITY OF WATER DATA: Iron _____ ppm Sulfate _____ ppm Chloride _____ ppm Hard. _____ ppm

Sp. Conduct 350 K x 10⁶ 3 Temp. 21.0 °F Date sampled 4-23-75 475

Taste, color, etc. pH = 8.7

12/18/91
DH
191.00
4.40

186.60
- 1.60
185.00

8/14/87
WL = 195.60

1987
W.L. = 182.87

10/13/78
WL = 162.

11-30-82
WL = 173.55

MP = Pop-out
plug @ 1.5'

3-1970 sp. conduct = 395; temp. = 20.0°C

PUNCHED and VERIFIED
ROLL-OFF DIVISION BRANCH

Well No.

Well No. D19

Latitude-longitude _____

HYDROGEOLOGIC CARD

SAME AS ON MASTER CARD Physiographic Province: _____ Section: 03

Drainage Basin: D 13L Subbasin: _____

Topo of well site: (D) (C) (E) (F) (R) (K) (L) _____
 (O) (P) (S) (T) (U) (V) _____

MAJOR AQUIFER: system _____ series K3 aquifer, formation, group EZ
 Lithology: _____ Origin: 6 Aquifer Thickness: _____ ft

Length of well open to: _____ ft Depth to top of: _____ ft

MINOR AQUIFER: system _____ series _____ aquifer, formation, group _____
 Lithology: _____ Origin: _____ Aquifer Thickness: _____ ft

Length of well open to: _____ ft Depth to top of: _____ ft

Intervals Screened: 500-562 ft

Depth to consolidated rock: _____ ft Source of data: _____

Depth to basement: _____ ft Source of data: _____

Surficial material: _____ Infiltration characteristics: _____

Coefficient Trans: _____ gpd/ft Coefficient Storage: _____

Coefficient Perm: _____ gpd/ft²; Spec cap: _____ gpm/ft; Number of geologic cards: _____

This well use continuously (24 hour pumping)

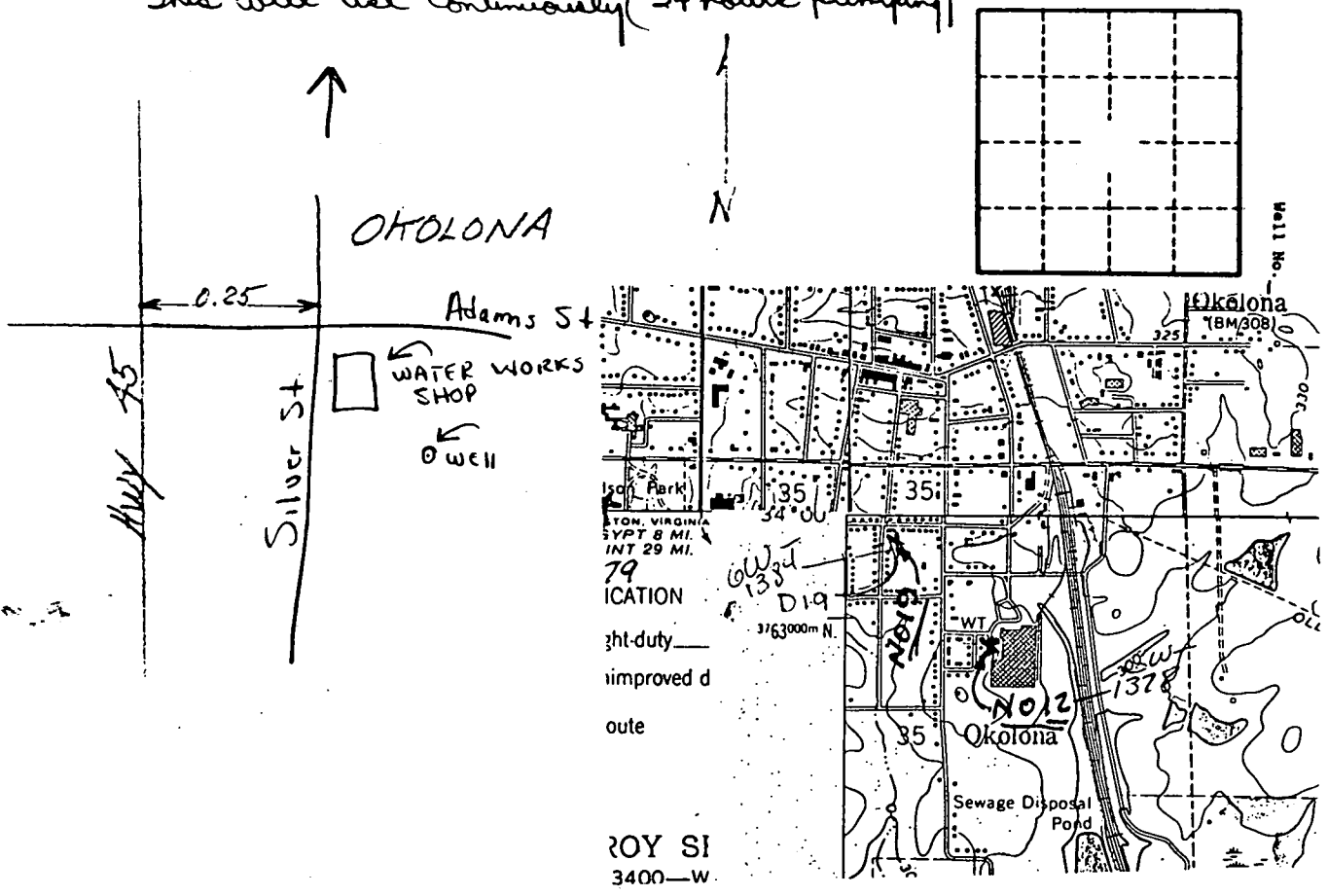

ROY SI 3400-W