

DCH # 0090007-02

GW01383

GPSd 7/30/97 DH/PP

D14

GW1383
GW1383
CORRECT

FORM 9-1642
(1-68)

Well No.

WELL SCHEDULE

U. S. DEPT. OF THE INTERIOR

GEOLOGICAL SURVEY

WATER RESOURCES DIVISION

PUNCHED and VERIFIED
ROLLA COMPUTATION BRANCH

MASTER CARD

Record by BCE Source of data Carter Plant Mgr. Date 6/58 Map Shannon

State 28 County (or town) Chickasaw 09

Latitude: 34⁰⁰09²2^N Longitude: 08⁸45¹¹11^W

Lat-long accuracy: 3⁰ T 12³ R 5⁰ Sec 26 NW 1 SE

Local well number: 0014 DB 26 12 50 5E Other number: _____ B & M

Local use: _____ Owner or name: Formerly Kraft Foods

Owner or name: OKALONA Address: OKOLONA wharf Plant

Ownership: County, Fed Gov't, City, Corp or Co, Private, State Agency, Water Dist N

Use of water: (A) Air cond, Bottling, Comm, Dewater, Power, Fire, Dom, Irr, Med, Ind, P S, Rec, (S) Stock, Instit, Unused, Repressure, Recharge, Desal-P S, Desal-other, Other U

Use of well: (A) Anode, Drain, Seismic, Heat Res, Obs, Oil-gas, Recharge, Test, Unused, Withdraw, Waste, Destroyed. U

DATA AVAILABLE: Well data Freq. W/L meas.: Field aquifer char.

Hyd. lab. data: _____

Qual. water data; type: USGS 10159

Freq. sampling: Pumpage inventory: no, period: _____

Aperture cards: _____

Log data: _____

WELL-DESCRIPTION CARD

SAME AS ON MASTER CARD Depth well: _____ ft 522 Meas. 3

Depth cased; (first perf.) _____ ft 342 Casing type: _____; Diam. _____ in 6

Finish: (C) porous concrete, (F) gravel w. (perf.), (G) gravel w. (perf.), (H) horiz. end, (O) open gallery, (P) perf., (S) screen, (T) sd. pt., (W) shored, (X) open hole, (B) other P

Method Drilled: (A) air rot, (B) bored, (C) cable, (D) dug, (H) rot., (J) hyd jetted, (P) air percuss, (R) reverse, (T) rotary, (V) driven, (W) drive wash, (B) other H

Date Drilled: 946 Pump intake setting: _____ ft _____

Driller: OC Webb address _____

Lift (type): (A) air, (B) bucket, (C) cent., (J) jet, (L) multiple, (M) multiple, (N) none, (P) piston, (R) rot., (S) submerg, (T) turb., (B) other P Deep Shallow

Power (type): (nat) diesel, (elec) gas, gasoline, hand, gas, wind; H.P. _____ Trans. or meter no. _____

Descrip. MP OK (10/89) above _____ ft below LSD, Alt. MP _____

Alt. LSD: 305 Accuracy: topo 3

Water Level _____ ft above _____ ft below MP; Ft below LSD _____ Accuracy: _____

Date meas: _____ Yield: _____ gpm 450 Method determined _____

Drawdown: _____ ft _____ Accuracy: _____ Pumping period _____ hrs _____

QUALITY OF WATER DATA: Iron 0.30 Sulfate 0.0 Chloride 69 Hard. 44

Sp. Conduct 430 K x 10⁶ Temp. 68 °F 68 Date sampled 059

Taste, color, etc. _____

DS-228

Well No. D14

Well No. _____

D14

Latitude-longitude _____ N
_____ S
d m s d m s

HYDROGEOLOGIC CARD

SAME AS ON MASTER CARD Physiographic Province: _____ Section: 03

Drainage Basin: D Subbasin: 13C

Topo of well site: (D) depression, stream channel, dunes, flat, hilltop, sink, swamp, (E) offshore, pediment, hillside, terrace, undulating, valley flat

MAJOR AQUIFER: system _____ series K3 aquifer, formation, group E2

Lithology: _____ Origin: 6 Aquifer Thickness: _____ ft
Length of well open to: _____ ft 80 Depth to top of: _____ ft

MINOR AQUIFER: system _____ series _____ aquifer, formation, group _____

Lithology: _____ Origin: _____ Aquifer Thickness: _____ ft
Length of well open to: _____ ft _____ Depth to top of: _____ ft

Intervals Screened: 342 - 522 ft

Depth to consolidated rock: _____ ft _____ Source of data: _____

Depth to basement: _____ ft _____ Source of data: _____

Surficial material: _____ Infiltration characteristics: _____

Coefficient Trans: _____ gpd/ft _____ Coefficient Storage: _____

Coefficient Perm: _____ gpd/ft²; Spec cap: _____ gpm/ft; Number of geologic cards: _____

(Well could be pumped not used)

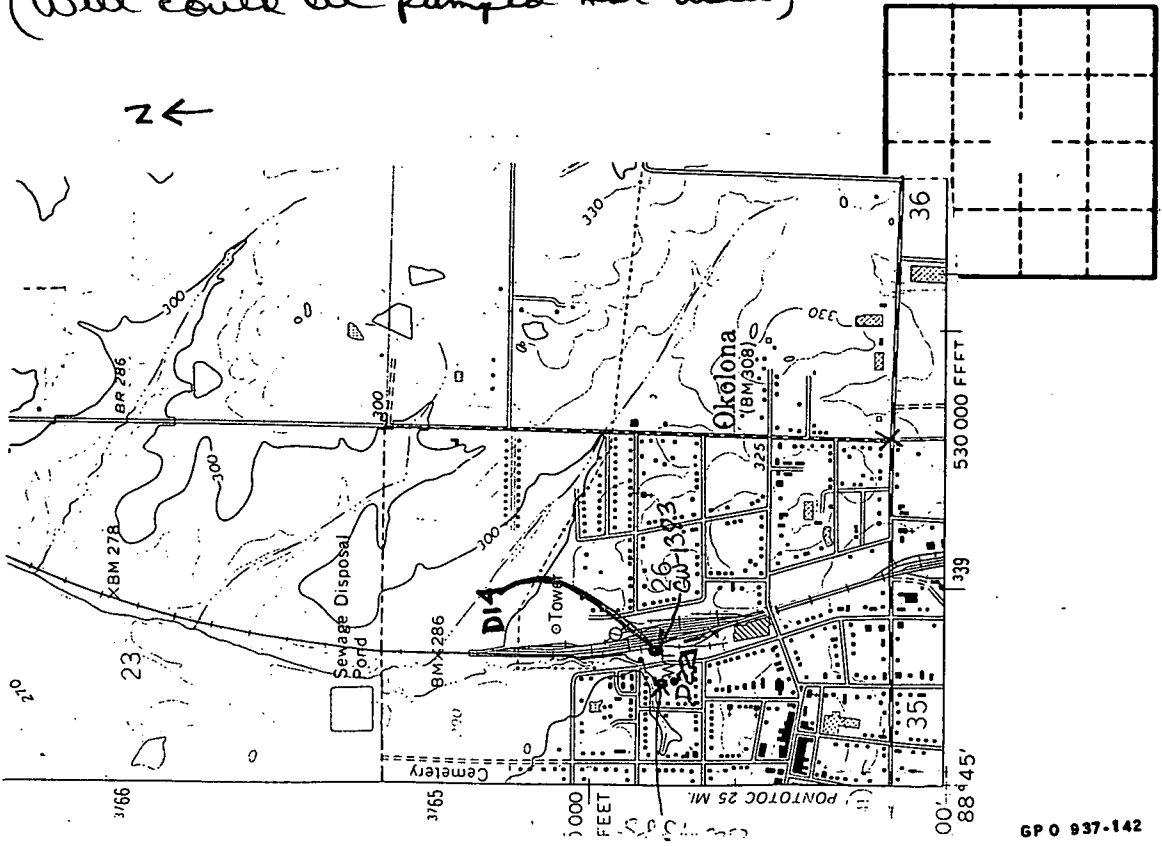

Well No. _____
D14

9-185
(October 1950)

UNITED STATES
DEPARTMENT OF THE INTERIOR
GEOLOGICAL SURVEY
WATER RESOURCES DIVISION

WELL SCHEDULE

Date Oct 21, 1958 Field No. _____
Record by R. E. Ellison, Jr. Office No. D-14
Source of data H. T. Carter, Plant mgr.

1. Location: State MISS County Chickasaw

Map SE SE 1/4 NW 1/4 sec. 26 T 12 N R 5

2. Owner: KRAFT FOODS Address Oakland, Miss

Tenant WHALEY OIL CO Address _____

Driller O. C. Webb Address Belden, MISS

3. Topography Plains

4. Elevation 305 ft. above _____ below _____

5. Type: Dug, drilled, driven, bored, jetted 1946

6. Depth: Rept. 522 ft. Meas. 280 ft.

7. Casing: Diam. 6" in., to 7" in. Type _____

Depth _____ ft., Finish 180 PERFORATED IN BOTTOM

8. Chief Aquifer KT Ke From _____ ft. to _____ ft.

Others _____

9. Water level _____ ft. rept. _____ ft. meas. _____ 19 _____ above _____ below _____

10. Pump: Type Diap Capacity _____ G. M. 450

Power: Kind Elec Horsepower _____

11. Yield: Flow _____ G. M., Pump _____ G. M., Meas., Rept. Est. _____

Drawdown _____ ft. after _____ hours pumping _____ G. M.

12. Use: Dom., Stock, PS., RR., Ind., Irr., Obs. _____

Adequacy, permanence _____

13. Quality Good Temp 68 °F.

Taste, odor, color _____ Sample Yes No 10-1-59

Unfit for _____

14. Remarks: (Log, Analyses, etc.) _____

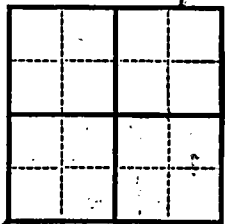

522
130
3

UNITED STATES
 DEPARTMENT OF THE INTERIOR
 GEOLOGICAL SURVEY
 WATER RESOURCES DIVISION

October 1950
 9-122

WELL SCHEDULE

Date _____
 Record by _____
 Well No. _____
 Field No. _____

Location _____
 County _____
 State _____
 Township _____
 Range _____
 Section _____
 Address _____

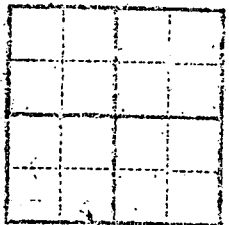

Well No. _____
 Diameter _____
 Depth _____
 Date of completion _____
 Name of owner _____

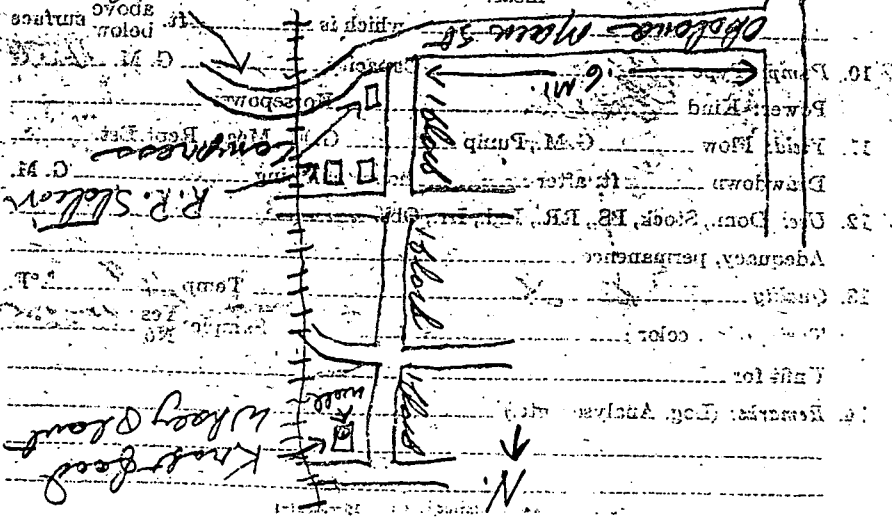

Remarks (Log Analysis) _____
 Time for _____
 Color _____
 Quantity _____
 Abnormality, permanent _____
 Use of _____
 Date _____

DEPARTMENT OF ENVIRONMENTAL QUALITY - OLWR

PUBLIC SUPPLY WELLS PROJECT

GPS LOG

USER NAME(S): Hardin/Phillips DATE: 7/30/97

UNIT DEQ #: _____ FILE #: B073021B

HEALTH DEPT. #: 090007-03 ELEV. 302

USGS #: D14 OLWR #: GW1383

OWNER: City of Okolona QUAD: Shannon

LOCATION: NW/SE S26 T12S R5E COUNTY: Chickasaw

LOCATION DESCRIPTION: At grain plant across from power
plant on Fleming St

CASING DIA: _____ PUMP TYPE & SIZE: Turbine; 15 HP

GPS FIELD LOCATION: LAT. 34° 00' 31.5" N LONG. 88° 44' 45.1" W

GPS CORRECTED LOCATION: LAT. 34.008577 LONG. 88.74575377

REMARKS: Measured 12' west of well

