

DOH # 080009-02
GW02160
1/81 WTO

Well # 2

151C

TRANSMITTED FOR ADP
5/85

Recorded by ND
Date 7-26-84

U.S. GEOLOGICAL SURVEY
WATER RESOURCES DIVISION
MISSISSIPPI DISTRICT
WELL RECORD

Well No. 041
E-Log No. 97
County CARROLL
Vaiden Quad

GPSd 9/26/96 Hornbeak

Site ID 331956089443001 R=0* T=A* 2=W*

Data reliab. 3=C* Report. agency 4=USGS* Dist. 6=28* 7=28* Co. 8=015*

Lat. Long. 9=331956* 10=0894430* Well No. 12=0041*

Location 13=NWSE S 14 T 17 N R 05 E* Alt. 16=337.*

Hyd. Unit (OWDC) 20= Date 21=0612711984*

Well use 23=W* Water Use 24=P* Hole depth 27=540.* Well depth 28=460.*

WL 30=7A.* Date 31=0911811984* Source 33=D*

Status 273= Project No. 5=

R=158* T=A* Date 159#0911811984* Owner No. _____

Owner 161# V. A. T. DEN. Well # 2

R=192* T=A* Date 193# Temp. 196#00010* 197=

R=192* T=A* Date 193# Cond. 196#00095* 197=

R=192* T=A* Date 193#0810911984* pH 196#00400* 197=7.9*

R=58* T=A* 59#1* Date 60=0911811984* Remarks _____

Drlg. 63=021* Name HERNDON Method 65=H* Finish 66=5*

R=76* T=A* 59#1*

Top csgn. 77# 0.* Bot. csgn. 78=420.* Diam. 79# 10.*

R=76* T=A* 59#1*

Top csgn. 77# 380.* Bot. csgn. 78=420.* Diam. 79# 6.*

R=82* T=A* 59#1* Top 83# 420.* Bottom 84= 460.*

Type 85=S* Diam. 87=6.* Size 88=

R=82* T=A* 59#1* Top 83# Bottom 84=

Type 85= Diam. 87= Size 88=

R=146* T=A* 147# 1* Q 150=536.* Q/S 272=

134 flows 146 pumped

GEN. SITE DATA

OWNER

FIELD QW

CONSTR.

CASING

OPENINGS

YIELD

LIFT

R=42* T= A * Lift type 43# T* Intake 44= * Power type 45= E*
 Date 38= 09/18/1984* H.P. 46= 60.*

LOGS

R=198* T= A * Log 199# E* Top 200= 210.* Bot 201= 530.*
 R=198* T= A * Log 199# D* Top 200= 0.* Bot 201= 540.*
 R=189* T= A * E Log No. 190# 097* 191= M I S S D I S T *

ANAL.

R=114* T= A * Year 115# * 117= * 120= *

AQUIFERS

R=90* T= A * 256# 1 * Top 91= 440.* Bot 92= 510.*
 Unit ID 93= 124WLCXM* Name of Unit _____
 R=90* T= A * 256# 1 * Top 91= * Bot 92= *
 Unit ID 93= * Name of Unit _____

HYDRAULICS

R=98* T= A * 99# 1 * Unit tested 100= * 103= *
 R=105* T= A * 99# 1 * Test No. 106# *
 107= * Transmissivity (gal/d)/ft _____
 108= * Hydraul. cond. (gal/d)/ft² _____
 110= * Storage coeff. Boundaries _____

R=121* T= * Yr Begin 122# * Network 258# *

Water Level Data Collection (1)

Red Clay	0	25
Blue Clay	25	120
Dark Clay	120	210
Blue Clay	210	220
Dark W/Clay Str	220	310
Grey Clay	310	440
Spand	440	510
Clay	510	540

1/12/84 PEG/JHH
 GPS A011216 A 82.00
 5.34
 Lat 33° 19.967' 76.66
 2.15
 Long 89° 44.527' 74.51
 BOT No. 8 0009 02 337.00
 74.51
262.49

Public Water Supply Annual Report

Name of Water Supply Town of Uaiden
 Public Water Supply (PWS) ID Number 080009 County CARROLL

Official Public Water Supply Address (This is the address where all official correspondence is received)
 Attention Maxie Henley Daytime Phone (601) 464-5266
 Address P.O. Box 76 Uaiden MS 39176

Monthly Bacteriological Sample Results Should be Mailed to: (Complete if different from official water supply address in above section)
 Attention Maxie Henley Daytime Phone () - -
 Address _____

Owner/Responsible Official of System (President, mayor, or owner of the water system)
 Name Louis M. Mc Dougal
 Address P.O. Box 144 Uaiden MS 39176
 Home Phone (601) 464-5449 Work Phone (601) 464-8884

Water Superintendent/Operator (To be completed by the person who directly supervises and is personally responsible for the daily operation and maintenance of this water system. Must be certified by Mississippi State Department of Health for a community water supply.)
 Name Maxie Henley James Gervish
 Address Rt. # 2 Box 39C Kilmichael MS 39747
 Home Phone (601) 262-7142 Work Phone (601) 464-5266

Mississippi State Department of Health Certification Number 001672 Expiration Date 05/15/93

I certify that I am the person who directly supervises and is personally responsible for the daily operation and maintenance of this public water system and I do hold a valid Certificate of Competency as required by Sections 21-27-201 through 21-27-211, Mississippi Code of 1972, Annotated. Signed this 3rd day of FEBRUARY 1992.
 Signature of Operator Maxie Henley

Secretary/Treasurer/Bookkeeper
 Name Bonita Smith
 Address P.O. Box 76 Uaiden MS 39176
 Home Phone (601) 464-5642 Work Phone (601) 464-5266

System Information

- How many usable sources of water (wells for groundwater systems, purchase points if buying water, etc.) does this system have?
 Wells = 2 Purchase Points = _____ Surface Water = _____ Other = _____ (explain) _____
- How many active connections on this system? 798
- How many people does this system serve? 2544
- How many gallons of water did this system sell during the last calendar year (January-December)? 65,325,985
- What was the peak month for water sales during the last calendar year and how many gallons of water were sold during that month?
 Month = July Gallons Sold = 6,082,770
- The charge to the customer for the 1st 3000 gallons of water is \$ 5.33.

This Annual Report is to be completed and returned to the Division of Water Supply no later than February 29, 1992. Information from this report will be used to update our files and for determining compliance with the laws and regulations governing public water supplies in Mississippi. Return the completed report to: Division of Water Supply; P. O. Box 1700; Jackson, Mississippi 39215-1700.

Who completed this report? Name Maxie Henley Title Water & Sewer Super.

Signature Maxie Henley Date 02/03/92

White Copy = Training & Certification
 Canary Copy = Compliance Branch
 Pink Copy = Water System
 Goldenrod Copy = Regional Engineer

DAI E100 # 97
 CARROLL CO.
 9-18-84

GW 02160

MISSISSIPPI DEPARTMENT OF NATURAL RESOURCES
 Bureau of Land and Water Resources
 Southport Mall
 P.O. Box 10631
 Jackson, Mississippi 39209
WATER WELL DRILLERS LOG

CODED

9-18-84 date well completed
 Henderson Well & Supply, Inc. firm name
 Carroll county well located

LANDOWNER: Jawn G. Vidon
Vidon, G.S.
 (mailing address)

description of formations encountered	from	to
Red Clay	0	25
Blue Clay	25	120
Darby Clay	120	210
Blue Clay	210	220
hard W/Clay str	220	310
Grey Clay	310	440
Sand	440	570
Clay	570	570

WELL LOCATION:
 sec. 14 T. 17 N. R. 5 E. S. W
 (distance) miles (direction) of (nearest town)

WELL PURPOSE:
 (home, irrigation, municipal, industrial)

- WELL COMPLETION DATA:
- (1) diameter (inches) 10
 - (2) total depth (feet) 460
 - (3) static water level (feet) 74 ^{below} above top of ground.
 - (4) casing Steel 420
 (material) (depth)
 (size) if telescope see back.
 - (5) screen 40' 420'
 (length) (depth to top)
6" SS
 (size) (material)
 - (6) pump 60 536
 (HP) (yield gpm)
Electric
 (type power)
 - (7) electric log yes
 (yes or no)
The Bureau of Geology
 (organization running log)
 - (8) how well bottom plugged
Backwash Valve

CODED

RECEIVED

APR 8 - 1985

Department of Natural Resources
 Bureau of Land & Water Resources

DRILLERS REMARKS:

WILCOX DATA SHEET-VERIFICATION CHECKLIST WLCXM

COUNTY Carroll

Vaiden Quad
U.S.G.S. E-105 # 97

WELL OWNER Town of Vaiden-Well#2 Hwy 51 N near Pig Wig Store #2 CHECKED
 U.S.G.S. NO. Q 41 9/20/94
 B.O.H. NO 80009-02 9/20/94
 OLWR NO. _____

LOCATION:

MAP SW, SW, NW, SE S14, T17N, R5E 9/20/94
 GPS A011216A 9/20/94

ELEV. (MSL) 337 9/20/94
 W.L. (L.S.) (1) 82.00 - 5.34 = 76.66 - 2.15 = -74.51 9/20/94
 (2) 81.00 - 4.23 = 76.77 - 2.15 = -74.62 9/20/94

HEAD (MSL) 337 - 74.51 = +262.49 9/20/94

SCREENED INTERVAL 420' - 460' (LS) / -83' - -123' (msc) 9/20/94

AQUIFER VERIFIED middle Wilcox 3/31/95

PREVIOUS W.L. -74' (1984) 9/20/94

DATA ENTERED _____

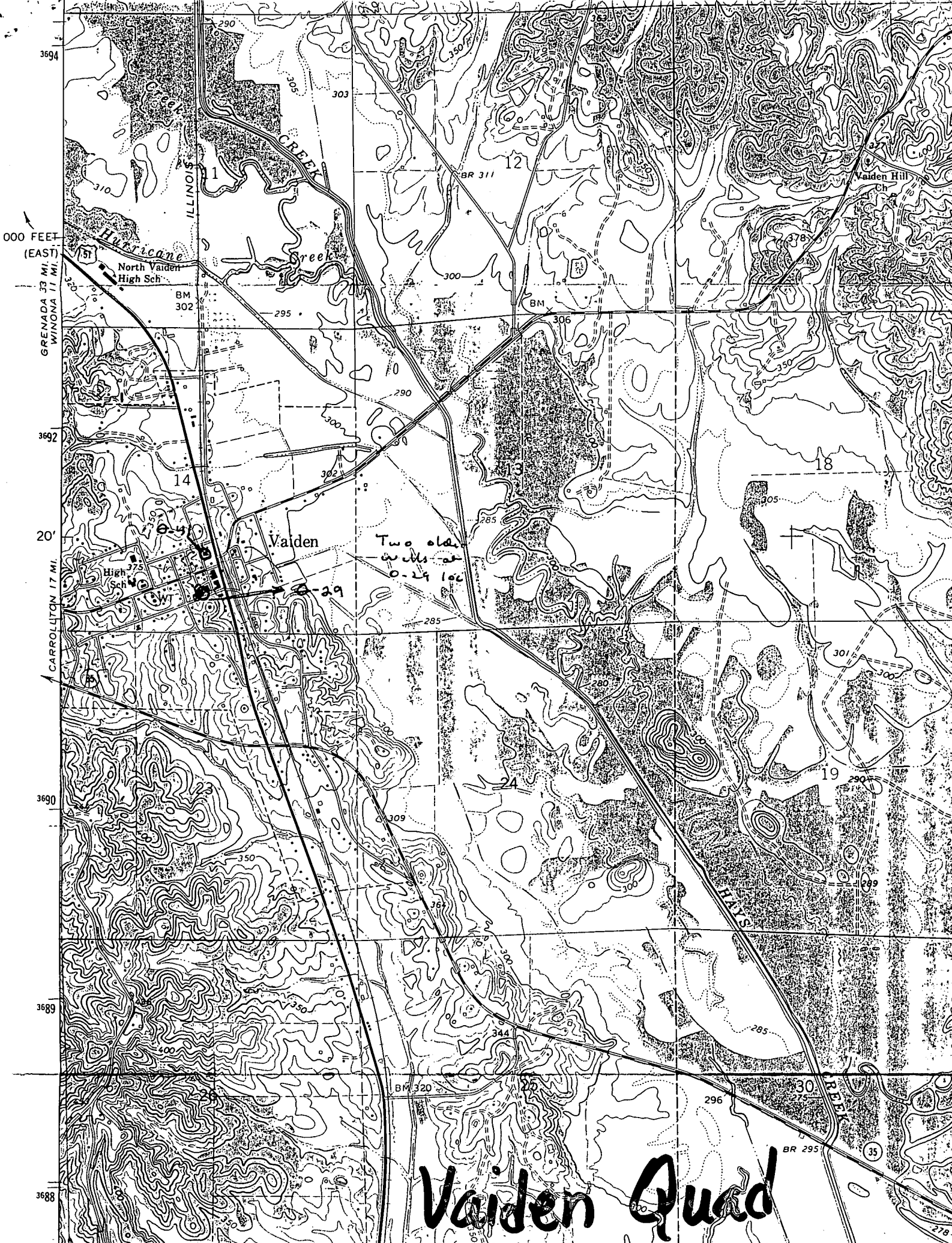

000 FEET (EAST)
GRENADA 37 MI.
WINONA 17 MI.

20'
CARROLLTON 17 MI.

Vaiden Quad

DEPARTMENT OF ENVIRONMENTAL QUALITY - OLWR

PUBLIC SUPPLY WELLS PROJECT

GPS LOG

USER NAME(S): Horubek DATE: 9/26/96
UNIT DEQ #: 82859 FILE #: B092623A
HEALTH DEPT. #: 080009-02 ELEV. _____
USGS #: 041 OLWR #: 6W02160
OWNER: Town of Vaiden QUAD: Vaiden
LOCATION: NW-SE s 14 T 17 N R 5 E COUNTY: Cattoll
LOCATION DESCRIPTION: In Fence on West Side of Hwy 51N, between
(Mulberry ST Hwy 430) & Herring ST. (Vaiden)
CASING DIA: 10" PUMP TYPE & SIZE: 60 HP Elec.
GPS FIELD LOCATION: LAT. 33° 19' 57.6" LONG. 89° 44' 29.8
GPS CORRECTED LOCATION: LAT. 33.33255138 LONG. 89.74173926
REMARKS: GPS at Well.

