

LIFT

R=42* T= A * Lift type 43# S* Intake 44= * Power type 45= E*

Date 38= 11/01/1978* H.P. 46= 20.*

LOGS

R=198* T= A * Log 199# D* Top 200= 0.* Bot 201= 820.*

R=198* T= A * Log 199# E* Top 200= 30.* Bot 201= 820.*

R=189* T= A * E Log No. 190# 073* 191= M I S S D I S T *

ANAL.

R=114* T= A * Year 115# * Type 120= *

AQUIFERS

R=90* T= A * 256# 1 * Top 91= 680.* Bot 92= 800.*

Unit ID 93= 124MUWX * Name of Unit

R=90* T= A * 256# 1 * Top 91= * Bot 92= *

Unit ID 93= * Name of Unit

HYDRAULICS

R=98* T= A * 99# 1 * Unit tested 100= * 103= *

R=105* T= A * 99# 1 * Test No. 106# *

107= * Transmissivity (gal/d)/ft

108= * Hydraul. cond. (gal/d)/ft²

110= * Storage coeff. Boundaries

R=121* T= * Yr Begin 122# *

Water Level Data Collection (1)

MSDH - 080004-01

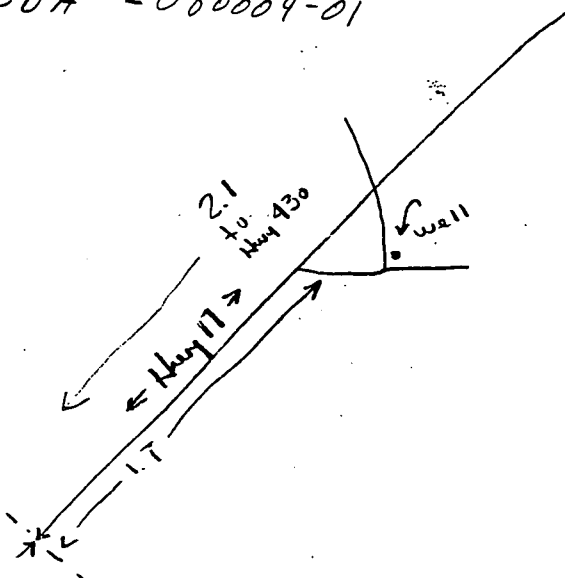

Description of formations encountered	from	to
From Class		
PEG/JG		
MP: 2.45 from stream		
9/8/93	210.00	200.00
	20.00	9.92
	190.00	190.08
	- 2.45	- 2.45
	197.55	187.63

good w/B but hard to read for mud on type

CARROLL
H33
11/78
Flwg # 73

GW 02852

MISSISSIPPI
BOARD OF WATER COMMISSIONERS
416 North State Street
Jackson, Mississippi 39201

CODED

WATER WELL DRILLERS LOG

November 1978 date well completed Herndon Well & Supply, Inc. firm name Carroll county well located

LANDOWNER:	Description of formations encountered	from	to
Well #2	Brown Clay	0	15
Coila, MS 38923 (mailing address)	Coarse Red Sand	15	185
WELL LOCATION:	Blue Clay	185	220
sec. 33 T 18 N R 03 E 5 miles North of Blackhawk (distance) (direction) (nearest town)	Sand	220	270
WELL PURPOSE: Municipal (home, irrigation, municipal, industrial)	Blue Clay	270	320
WELL COMPLETION DATA:	Blue Sand	320	330
(1) diameter (inches) 8 x 4	Rock	330	331
(2) total depth (feet) 795'	Blue Sand, Coarse	331	341
(3) static water level (feet) 189' below top of ground.	Rock	341	342
(4) casing Steel 740' (material) (depth)	Blue Sand, Coarse	342	392
8" if telescope see back. (size)	Rock	392	393
(5) screen 61' 734' (length) (depth to top)	Blue Sand, Coarse	393	421
4" SS Ribbed (size) (material)	Rock	421	422
(6) pump 20 157.5 (HP) (yield gpm)	Blue Sand, Coarse	422	435
Electric (type power)	Rock	435	436
(7) electric log yes (yes or no)	Blue Sand, Coarse	436	439
U.S.G.S. (organization running log)	Rock	439	440
(8) how well bottom plugged 4" BWV	Blue Sand, Coarse	440	455
DRILLER'S REMARKS:	Rock	455	456
NOV 20 1978	Blue Sand, Coarse	456	461
MISS. BD. OF WATER COM	Rock	461	462
	Blue Sand, Coarse	462	465
	Rock	465	466
	Blue Sand, Coarse	466	474
	Rock	474	475
	Blue Sand, Coarse	475	481
	Rock	481	482
	Fine, Blue Sand	482	495
	Rock	495	496
	Fine, Blue Sand	496	535
	Blue Clay, Numerous Sand Streaks	535	710
	Sand	710	725
	Blue Clay	725	730
	Sand	730	735
	Blue Clay	735	740
	Good, Medium Fine Sand	740	805
	Blue Clay	805	820

WILCOX DATA SHEET-VERIFICATION CHECKLIST MWX

COUNTY Carroll

Coila Quad
U.S.G.S. E-10J#73

WELL OWNER Pelucia Water Assoc Well #2

CHECKED

U.S.G.S. NO. H 33

9/19/94

B.O.H. NO 080004-01

9/19/94

OLWR NO. _____

LOCATION:

MAP SE, NE, NW, SE S 33, T 18 N, R 3 E

9/19/94

GPS No

ELEV. (MSL) 405

9/19/94

W.L. (L.S.) (1) 210 - 20.00 = 190 - 2.45 = 187.55

9/19/94

(2) 200 - 9.92 = 190.08 - 2.45 = 187.63

9/19/94

HEAD (MSL) 405 - 187.55 = + 217.45

9/19/94

SCREENED INTERVAL 734' - 795' (LS) / - 329' - -390' (MSL)

9/19/94

AQUIFER VERIFIED Meddian - Upper Wilcox

9/19/94

PREVIOUS W.L. - 189' (1978)

9/19/94

DATA ENTERED _____

DEPARTMENT OF ENVIRONMENTAL QUALITY - OLWR
PUBLIC SUPPLY WELLS PROJECT

GPS LOG

USER NAME(S): Hornbeck DATE: 9/25/96
UNIT DEQ #: 82859 FILE #: B092521A
HEALTH DEPT. #: 080004-01 ELEV. _____
USGS #: H33 OLWR #: GW02852
OWNER: Pelucia Rural w/A #3 Coila QUAD: Coila
LOCATION: NW-SE s 33T 18NR 3E COUNTY: Carroll
LOCATION DESCRIPTION: In Block Bldg. AT Ground Tank on NE Side
of Gravel Rd. 10 mi. SE of Intersection with
CASING DIA: 8" Hwy 17, 1.25 mi. SW of (Coila)
PUMP TYPE & SIZE: 25 HP Elec.
GPS FIELD LOCATION: LAT. 33° 22' 42.0" LONG. 89° 59' 08.7"
GPS CORRECTED LOCATION: LAT. 33.37786025 LONG. 89.98552363
REMARKS: GPS at Well,

