

WELL SCHEDULE

U. S. DEPT. OF THE INTERIOR

GEOLOGICAL SURVEY

WATER RESOURCES DIVISION

MASTER CARD

Record by J. A. CALLAHAN Source of data obs. Date 1-9-68 Map Outman Quad.

State MISSISSIPPI County CLARKE

Latitude: 32° 03' 35" N Longitude: 088° 39' 36" W Sequential number: 1

Local well number: H 004 CA 3303 N 16 C Other number: Test hole

Local use: 008 369 11 Owner or name: EAST QUITMAN Address: 611 1/2 N. Main

Ownership: (C) County, (F) Fed Gov't, (M) City, (N) Corp or Co, (P) Private, (S) State Agency, (W) Water Dist W

Use of water: (A) Air cond, (B) Bottling, (C) Comm, (D) Dewater, (E) Power, (F) Fire, (H) Dom, (I) Irr, (M) Med, (N) Ind, (P) Rec, (S) Stock, (T) Instit, (U) Unused, (V) Reppure, (W) Recharge, (X) Desal-P S, (Y) Desal-other, (Z) Other P

Use of well: (A) Anode, (D) Drain, (G) Seismic, (H) Heat Res, (I) Obs, (P) Oil-gas, (R) Recharge, (T) Test, (U) Unused, (W) Withdraw, (X) Waste, (Z) Destroyed W

DATA AVAILABLE: Well data Freq. W/L meas.: Field aquifer char. Z

Hyd. lab. data: _____

Qual. water data; type: MSBOK 2/69

Freq. sampling: _____ Pumpage inventory: yes, no, period: _____

Aperture cards: _____

Log data: E D (MSBOK)

16.0
34.0
125.68
124.68
34.0
125.68
11.5

11-35 AM 10/27/80
Keld-160' WT.-125.68'
Wct-34.32' below M.P.
measuring 2' - 1.0'

WELL-DESCRIPTION CARD

SAME AS ON MASTER CARD Depth well: 716 ft Meas. accuracy 3

Depth cased: (first perf.) 280 ft Casing type: _____; Diam. 10x8 in

Finish: (C) concrete, (F) porous, (G) gravel w. screen, (H) gravel w. gallery, (I) horz. open end, (P) perf., (S) screen, (T) sd. pt., (W) shored, (X) open hole, (Z) other S

Method: (A) air, (B) bored, (C) cable, (D) dug, (H) hyd jetted, (J) air, (P) reverse, (R) trenching, (T) driven, (V) drive wash, (W) percuss, (X) rotary, (Z) other H

Date Drilled: 9-6-8 Pump intake setting: _____ ft

Driller: McDONALD & HILL, MERIDIAN MISS

Lift (type): (A) air, (B) bucket, (C) cent, (J) jet, (L) multiple, (M) multiple, (N) none, (P) piston, (R) rot, (S) submerg, (T) turb, (Z) other S Deep Shallow

Power (type): (nat) diesel, elec, gas, gasoline, hand, gas, wind; (LP) H.P. U Trans. or meter no. _____

Descrip. MP 350 ft above LSD. Alt. MP _____

Alt. LSD: 340 ft Accuracy: CI 20ft

Water Level: 125 ft above MP; 230 ft above LSD Accuracy: 20' ± 2#

Date meas: 768 Yield: 20# gpm Method 230 determined

Drawdown: _____ ft Accuracy: _____ Pumping period: 12 min. hrs _____

QUALITY OF WATER DATA: Iron 3 ppm Sulfate 0 ppm Chloride 2 ppm Hard. 42 ppm

Sp. Conduct 21 K x 10⁶ Temp. 26.9 °F Date sampled _____

Taste, color, etc. _____

10/25/89
131.38

WELL NO. 44

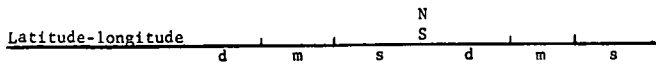

HYDROGEOLOGIC CARD

SAME AS ON MASTER CARD Physiographic Province: 0.3 Section: _____
 Drainage Basin: D Subbasin: 1.3.P _____
 Topo of well site: (D) depression, stream channel, dunes, flat, hilltop, sink, swamp, (E) (F) (H) (K) (L) _____
 (Ø) (P) (S) (T) (U) (V) offshore, pediment, hillside, terrace, undulating, valley flat _____
 MAJOR AQUIFER: system _____ series TE aquifer, formation, group SPARTA SAND SS
 Lithology: _____ Origin: US Aquifer Thickness: 2 ft
 Length of well open to: 4.5 ft Depth to top of: 4.0 ft
 MINOR AQUIFER: system _____ series _____ aquifer, formation, group _____
 Lithology: _____ Origin: _____ Aquifer Thickness: _____ ft
 Length of well open to: _____ ft Depth to top of: _____ ft
 Intervals Screened: 40'
 Depth to consolidated rock: _____ ft Source of data: _____
 Depth to basement: _____ ft Source of data: _____
 Surficial material: _____ Infiltration characteristics: _____
 Coefficient Trans: 30,000 gpd/ft² Coefficient Storage: 30.3
 Perm: 670 gpd/ft²; Spec cap: 11 gpm/ft; Number of geologic cards: _____
4 miles E. of Carlisle

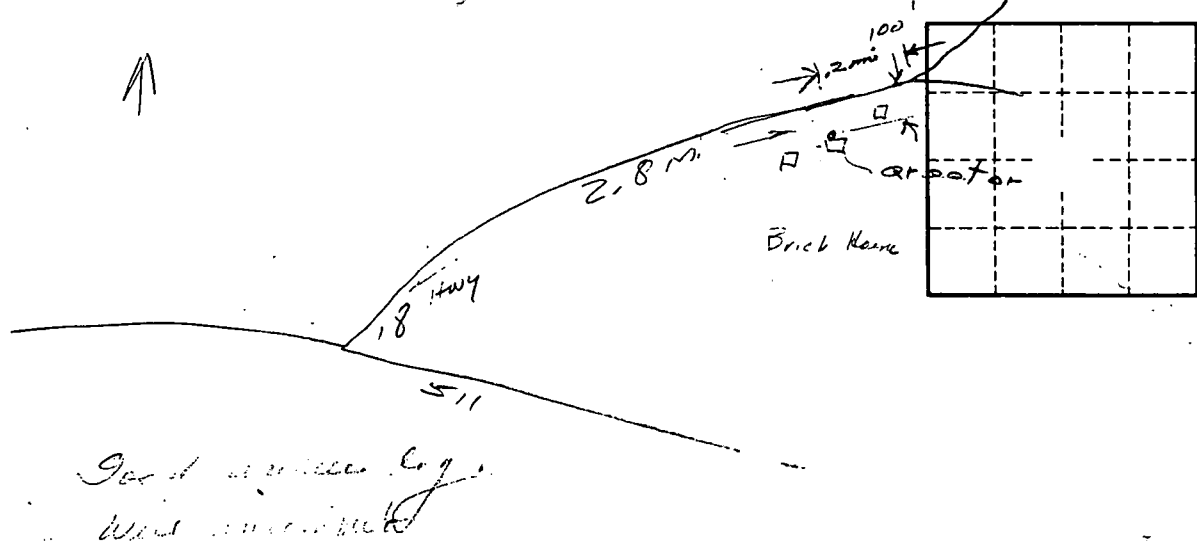

Good water log.
 well in contact
 PH.: 5.9 Ca₂ = 125 TDS: 131
 Alk: 45 Fe: .15
 Cl: 15 Mg: 3.9
 SO₄ = 42.1 Ca: 1.6
 F < .1 Na: 28
 K: 2.6

