

WELL SCHEDULE
GEOLOGICAL SURVEY

WATER RESOURCES DIVISION

U. S. DEPT. OF THE INTERIOR

18
07
Elog #25

PUNCHED and VERIFIED
ROLLA COMMUNICATION BRANCH

MASTER CARD

Record by CY Source of data MSGs Date 4/65 Map ATLANTA 113-C
State 53 28 County (or town) Calhoun 46 07

Latitude: 33° 47' 48" N Longitude: 08° 41' 38" W
Lat-long accuracy: 3 min 22 sec 10 sec 3 degrees 20 min 10 sec SE 100 ft 100 ft

Local well number: 0007 0322 N 10E Other number: NE NE SE SE

Local use: 053025 Owner or name: HOWARD EASLEY Address: _____

Ownership: County, Fed Gov't, City, Corp or Co, Private, State Agency, Water Dist. P

Use of water: (A) Air cond, (B) Bottling, (C) Comm, (D) Devater, (E) Power, (F) Fire, (G) Dom, (H) Irr, (I) Mad, (J) Ind, (K) P S, (L) Rec, (M) Stock, (N) Instat, (O) Unused, (P) Recharge, (Q) Desal-P S, (R) Desal-other, (S) Other N

Use of well: (A) Anode, (B) Drain, (C) Seismic, (D) Heat Res, (E) Obs, (F) Oil-gas, (G) Recharge, (H) Test, (I) Unused, (J) Withdrew, (K) Waste, (L) Destroyed W

DATA AVAILABLE: Well data Freq. W/L meas: Field aquifer char.

Hyd. lab. data: _____

Qual. water data; type: _____

Freq. sampling: _____ Pumpage inventory: yes no period: _____

Aperture cards: _____

Log data: Gamma Ray log / Elog 548-1622' J.E

WELL-DESCRIPTION CARD
SAME AS ON MASTER CARD Depth well: 1622 ft Meas. rept. accuracy 3

Depth cased: 1545 ft Casing type: _____; Diam. 4 in 4

Finish: (C) porous concrete, (D) gravel w. (E) gravel w. (F) horiz. (G) open (H) screen, (I) gallery, (J) end, (K) perf., (L) screen, (M) sd. pt., (N) shored, (O) open (P) cble, (Q) other X

Method: (A) air rot, (B) bored, (C) cable, (D) dug, (E) hyd, (F) jetted, (G) air rot., (H) percussion, (I) rotary, (J) reverse, (K) tranching, (L) driven, (M) drive wash, (N) other N

Date Drilled: 3/65 9:6:5 Pump intake setting: _____ ft _____

Driller: T.M. Parks name address _____

Lift (type): (A) air, (B) bucket, (C) cent., (D) jet, (E) multiple, (F) multiple, (G) none, (H) piston, (I) rot., (J) submerg, (K) turb, (L) other Deep Shallow

Power (type): (A) diesel, (B) elec, (C) gas, (D) gasoline, (E) hand, (F) gas, (G) wind; HP Trans. or meter no. _____

Descrip. MP 345 388 (10/89) ft above LSD, Alt. MP _____

Alt. LSD: 3010 Accuracy: (source) 4

Water Level: _____ ft above MP; _____ ft below LSD Accuracy: _____

Date meas: _____ Yield: _____ gpm _____ Method determined _____

Drawdown: _____ ft Accuracy: _____ Pumping period: _____ hrs _____

QUALITY OF WATER DATA: Iron _____ ppm Sulfate _____ ppm Chloride _____ ppm Hard. _____ ppm
Sp. Conduct _____ K x 10⁶ Temp. _____ °F Date sampled _____

1988
W.L. = 166.25
5/29/91
DH IJE
185.00
13.73
171.28
-0.55 m.p.
170.72

Well No.

Well No. 07

Latitude-longitude _____

HYDROGEOLOGIC CARD

SAME AS ON MASTER CARD Physiographic Province: 03 Section: _____

Drainage Basin: D Subbasin: 1156

Top of well site: (D) depression, stream channel, dunes, flat, hilltop, sink, swamp, (C) offshore, pediment, hillside, terrace, undulating, valley flat

MAJOR AQUIFER: system _____ series K3 aquifer, formation, group Eutaw and Mesha

Lithology: _____ Origin: S Aquifer Thickness: _____ ft

Length of well open to: _____ ft Depth to top of: _____ ft

MINOR AQUIFER: system _____ series _____ aquifer, formation, group _____

Lithology: _____ Origin: _____ Aquifer Thickness: _____ ft

Length of well open to: _____ ft Depth to top of: _____ ft

Intervals Screened: _____

Depth to consolidated rock: _____ ft Source of data: _____

Depth to basement: _____ ft Source of data: _____

Surficial material: _____ Infiltration characteristics: _____

Coefficient Trans: _____ spd/ft Coefficient Storage: _____

Coefficient Perm: _____ spd/ft²; Spec cap: _____ gpm/ft; Number of geologic cards: _____

4 inch casing to 545'

- Arcola @ 1208'
- Eutaw @ 1308'
- Mesha @ 1503' (?)
- Gorda @ 1613'

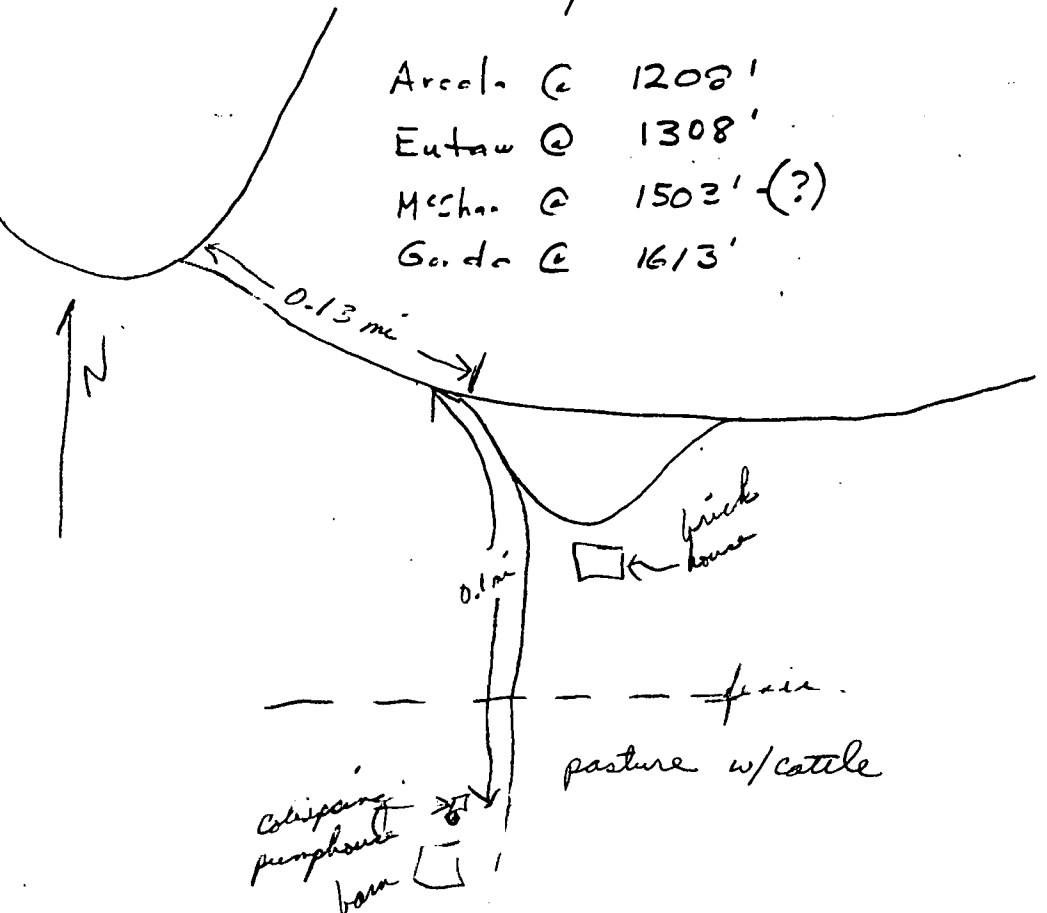
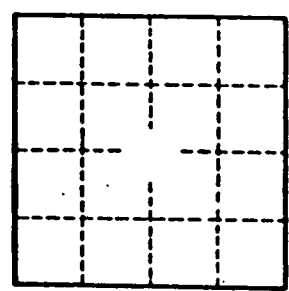

Well No. _____