

9-185  
(October 1950)

UNITED STATES  
DEPARTMENT OF THE INTERIOR  
GEOLOGICAL SURVEY  
WATER RESOURCES DIVISION

WELL SCHEDULE

Date 5-23, 1960 Field No. 16

Record by C. Jessup Office No. 06

Source of data Electric Log (M.S.S.)

1: Location: State Miss. County Calhoun

Map S6 1/4 S8 1/4 Sec. 4 T 15 N R 1 E W

2: Owner: Eli Reedy Address Wardman

Tenant \_\_\_\_\_ Address \_\_\_\_\_

Driller T.M. Parks Address Haulka

3: Topography \_\_\_\_\_

4: Elevation 368 ft. above ALT below \_\_\_\_\_

5: Type: Dug, drilled, driven, bored, jetted 7/15/59

6: Depth: Rept. 1613 ft. Meas. \_\_\_\_\_ ft.

7: Casing: Diam. 4-7/8 in., to 153 in., Type \_\_\_\_\_

Depth \_\_\_\_\_ ft., Finish 100 Perforated

8: Chief Aquifer KM PIPE From \_\_\_\_\_ ft. to \_\_\_\_\_ ft.

Others \_\_\_\_\_

9: Water level \_\_\_\_\_ ft. rept. \_\_\_\_\_ ft. 19 \_\_\_\_\_ above below \_\_\_\_\_

which is \_\_\_\_\_ ft. above surface below \_\_\_\_\_

10: Pump: Type Red Capacity \_\_\_\_\_ G. M.

Power: Kind Elco Horsepower \_\_\_\_\_

11: Yield: Flow \_\_\_\_\_ G. M., Pump \_\_\_\_\_ G. M., Meas., Rept. Est. \_\_\_\_\_

Drawdown \_\_\_\_\_ ft. after \_\_\_\_\_ hours pumping \_\_\_\_\_ G. M.

12: Use: Dom., Stock, PS., RR., Ind., Irr., Obs.

Adequacy, permanence Plenty

13: Quality good Temp \_\_\_\_\_ °F.

Taste, odor, color \_\_\_\_\_ Sample Yes No 6-11-60

Unfit for \_\_\_\_\_ Partial

14: Remarks: (Log, Analyses, etc.) Well supplies three families.

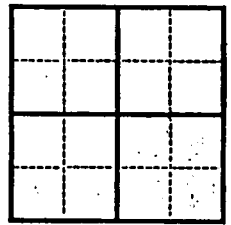

UNITED STATES  
DEPARTMENT OF THE INTERIOR  
GEOLOGICAL SURVEY  
WATER RESOURCES DIVISION

(October 1920)  
9-182

WELL SCHEDULE

Date \_\_\_\_\_  
Record by \_\_\_\_\_  
Source of data \_\_\_\_\_

1. Name of well \_\_\_\_\_  
2. Owner \_\_\_\_\_  
3. Driller \_\_\_\_\_

4. Location \_\_\_\_\_  
5. Direction of dip \_\_\_\_\_  
6. Direction of flow \_\_\_\_\_

7. Character of water \_\_\_\_\_  
8. Kind of casing \_\_\_\_\_  
9. Depth of casing \_\_\_\_\_

10. Water level \_\_\_\_\_  
11. Pump type \_\_\_\_\_  
12. Power kind \_\_\_\_\_

13. Well flow \_\_\_\_\_  
14. Test point, stool, etc. \_\_\_\_\_  
15. Quantity \_\_\_\_\_

16. Taste, odor, color \_\_\_\_\_  
17. Unit for \_\_\_\_\_  
18. Remarks (Log, Analyser, etc.) \_\_\_\_\_

19. Sample No. \_\_\_\_\_  
20. \_\_\_\_\_

21. \_\_\_\_\_  
22. \_\_\_\_\_

23. \_\_\_\_\_  
24. \_\_\_\_\_

25. \_\_\_\_\_  
26. \_\_\_\_\_

27. \_\_\_\_\_  
28. \_\_\_\_\_

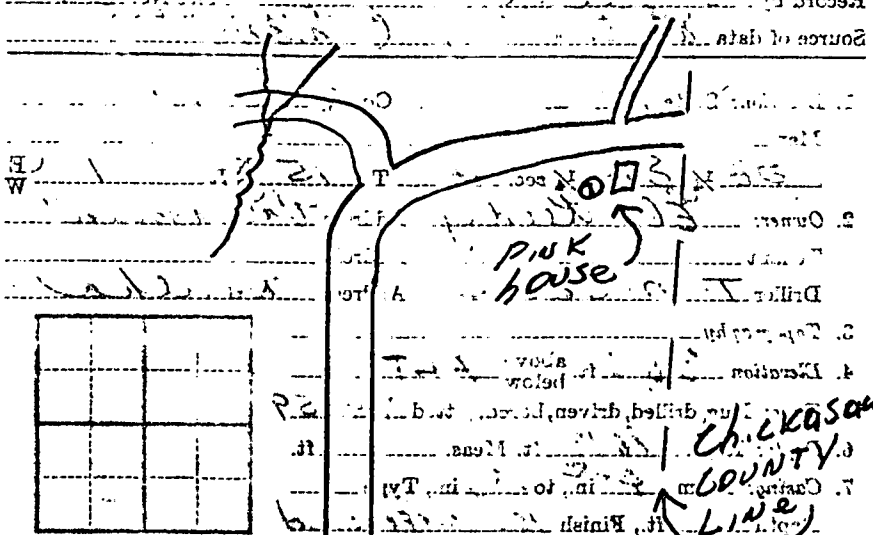

Top saw  
Creek

Pink house

Chickasaw  
County  
Line