

9-185
(October 1950)

UNITED STATES
DEPARTMENT OF THE INTERIOR
GEOLOGICAL SURVEY
WATER RESOURCES DIVISION

WELL SCHEDULE SYLW
Date March 20 1956 Field No. VT10
Record by E. N. Baswell Office No. K4
Source of data driller + insp. while drilling

1. Location: State Miss County Calhoun
Map County

NW $\frac{1}{4}$ NE $\frac{1}{4}$ sec. 22 T. 14 S. R. 32-13-E

2. Owner: Town of Derma Address Miss

Tenant _____ Address _____

Driller Robert E. Ratliff Address Grenada, Miss

3. Topography low hill top

4. Elevation 285 ft. above msl (topo map)

5. Type: Dug, drilled driven, bored, jetted 4 1956

6. Depth: Rept. 788 ft. Meas. _____ ft.

7. Casing: Diam. 8 in., to 4 in., Type _____

Depth _____ ft. Finish _____

8. Chief Aquifer Tuscaloosa From 1220 ft. to 2 ft.

Others _____

9. Water level not ft. complete 3/20/56 above 19 ft. below _____
which is _____ ft. below surface

10. Pump: Type Turbine Capacity _____ G. M.
Power: Kind Elec. Horsepower _____

11. Yield: Flow _____ G. M., Pump _____ G. M., Meas., Rept. Est. _____
Drawdown _____ ft. after _____ hours pumping _____ G. M.

12. Use: Dom., Stock, PS RR., Ind., Irr., Obs. _____
Adequacy, permanence _____

13. Quality OK Temp _____ °F.
Taste, odor, color OK Sample Yes _____ No _____

Unfit for _____

14. Remarks: (Log, Analyses, etc.) See reverse.

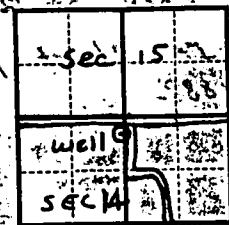

UNITED STATES
DEPARTMENT OF THE INTERIOR
GEOLOGICAL SURVEY
WATER RESOURCES DIVISION

(October 1950)

CALHOUN
CITY

Wardman To BYW 8

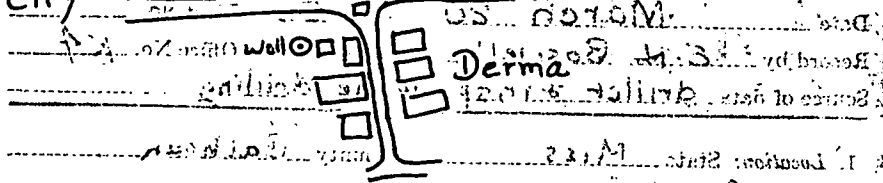

3-20-56
NW 1/4 NE 1/4 Sec 22 T. 14 N. R. 22 E.

Rock broke bit off @ 1888 ft. Reaming before going deeper. Will set 8" casing

at 1250, 3' soft layer, then another 8" rock

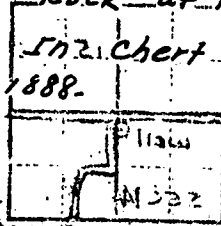

chert pea gravel, no sand showing (?)

1. Type of casing
2. Depth
3. Casing diameter
4. Depth
5. Kind of pump
6. Others
7. Water level
8. Pump type
9. Power kind
10. Flow
11. Drawdown
12. Meter
13. Quality
14. Remarks