

SITE - 334557090430201

20/25

M55

FORM 9-1642 (1-68)

Well No.

Log # 35 107C

WELL SCHEDULE

U. S. DEPT. OF THE INTERIOR

GEOLOGICAL SURVEY

WATER RESOURCES DIVISION

6W06035

060035-03

MASTER CARD

Record by P.E. Grant Source of data D.L. + E.L. Date 2-27-70 Map Merigold

State Miss County Bolivar

Latitude: 33 45 57 N Longitude: 09 04 30 W

Lat-long accuracy: 22 0 5 9 NN SE W

Local well number: M0558D0922N05W

Local use: 064035 Owner or name: Baxter Lab

Owner or name: BAXTER LABORATORY

Ownership: County, Fed Gov't, City, Corp or Co, Private, State Agency, Water Dist

Use of Air cond, Bottling, Comm, Dewater, Power, Fire, Dom, Irr, Mad, Ind, P S, Rec

water: (S) (T) (U) (V) (W) (X) (Y) (Z)

Use of well: (A) (D) (G) (H) (I) (J) (K) (L) (M) (N) (O) (P) (Q) (R) (S) (T) (U) (V) (W) (X) (Y) (Z)

DATA AVAILABLE: Well data Freq. W/L meas.: Field aquifer char.

Hyd. lab. data:

Qual. water data; type: SPRT

Freq. sampling: Pumpage inventory: no, period:

Aperture cards:

Log data:

WELL-DESCRIPTION CARD

SAME AS ON MASTER CARD Depth well: 812 ft Meas. rept accuracy

Depth cased: 732 ft Casing type: steel Diam. 12 x 8 in

Finish: porous gravel w. concrete, (perf.), (screen), gallery, end, horiz. open perf., screen, sd. pt., shored, open hole, other

Method Drilled: (A) (B) (C) (D) (H) (J) (P) (R) (T) (V) (W) (X) (Y) (Z)

Date Drilled: 970 Pump intake setting: ft

Driller: Laune Central Co Cleveland, Miss

Lift (type): (A) (B) (C) (J) multiple, multiple, none, piston, rot, submerg, turb, other

Power (type): diesel, elec, gas, gasoline, hand, gas, wind; H.P. 75 Trans. or meter no.

Descrip. MP 138 ft above LSD, Alt. MP

Alt. LSD: 140 Accuracy: topo

Water Level: 49 Accuracy:

Date meas: 370 Yield: 750 Method determined

Drawdown: Accuracy: Pumping period hrs

QUALITY OF WATER DATA: Iron Sulfate Chloride Hard.

Sp. Conduct K x 10 Temp. Date sampled

Taste, color, etc.

PUNCHED and VERIFIED BOLLA COMB. DIVISION BRANCH

Well No. 3

Latitude-longitude _____
N
S
d m s d m s

HYDROGEOLOGIC CARD

SAME AS ON MASTER CARD Physiographic Province: 03 Section: _____

E Drainage Basin: 115H Subbasin: _____

Top of well site: (D) depression, stream channel, dunes, flat, hilltop, sink, swamp, (K) (L) (P) (S) (T) (U) (V) offshore, pediment, hillside, terrace, undulating, valley flat _____

MAJOR AQUIFER: system _____ series TE aquifer, formation, group SIS

Lithology: _____ Origin: 2 Aquifer Thickness: _____ ft

Length of well open to: _____ ft 8.0 Depth to top of: _____ ft

MINOR AQUIFER: system _____ series _____ aquifer, formation, group _____

Lithology: _____ Origin: _____ Aquifer Thickness: _____ ft

Length of well open to: _____ ft _____ Depth to top of: _____ ft

Intervals Screened:

Depth to consolidated rock: _____ ft _____ Source of data: _____

Depth to basement: _____ ft _____ Source of data: _____

Surficial material: _____ Infiltration characteristics: _____

Coefficient Trans: _____ gpd/ft _____ Coefficient Storage: _____

Coefficient Perm: _____ gpd/ft²; Spec cap: _____ gpm/ft; Number of geologic cards: _____

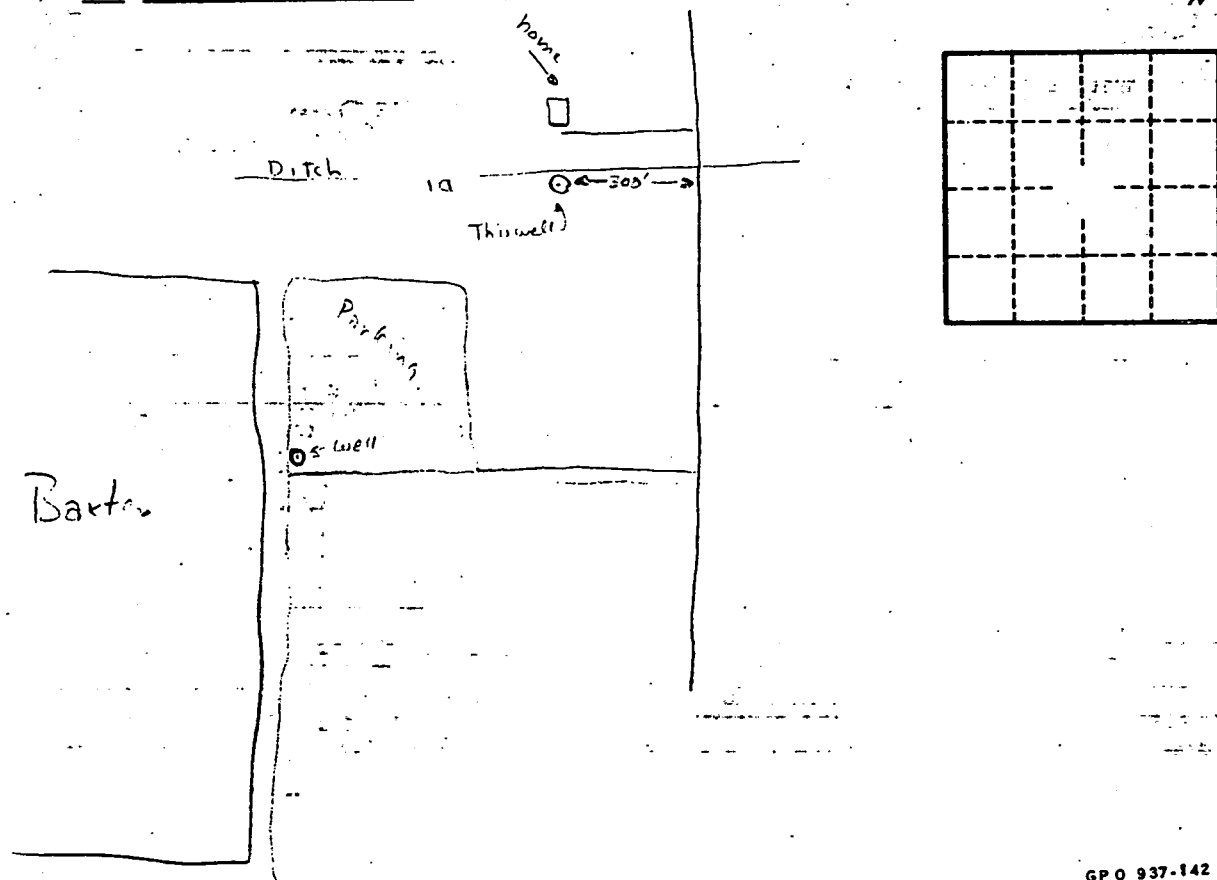

Well No. _____