

WELL SCHEDULE

U. S. DEPT. OF THE INTERIOR

GEOLOGICAL SURVEY

WATER RESOURCES DIVISION

GW05980

MASTER CARD

Record by M Smith Source of data old records Date 7/70 Map Cleveland

State 28 County (or town) Bolivar 06

Latitude: 33^{deg} 44^{min} 45^{sec} N Longitude: 09^{deg} 04^{min} 25^{sec} W Sequential number: 1

Lat-long accuracy: 3 T. 22 S. R. 5 E. Sec. 21, NE 1/4, NW 1/4, NW 1/4 SW NE NW

Local well number: M 04 1 A B 2 1 2 2 N O S W Other number: B & M

Local use: 009 Owner of name: CLEVELAND

Owner or name: CLEVELAND Address:

Ownership: County, Fed Gov't, City, Corp or Co, Private, State Agency, Water Dist AB M

Use of water: (A) Air cond, Bottling, Comm, Dewater, Power, Fire, Dom, Irr, Med, Ind, P S, Rec, P & A

(S) Stock, Instit, Unused, Repressure, Recharge, Desal-P S, Desal-other, Other DY P

Use of well: (A) Anode, Drain, Seismic, Heat Res, Obs, Oil-gas, Recharge, Test, Unused, Withdraw, Waste, Destroyed. W

DATA AVAILABLE: Well data Freq. W/L meas.: Field aquifer char.

Hyd. lab. data: SPRT

Qual. water data; type:

Freq. sampling: Pumpage inventory: yes no, period:

Aperture cards: yes

Log data:

WELL-DESCRIPTION CARD

SAME AS ON MASTER CARD Depth well: 847 ft Meas. rept accuracy 4

Depth cased: (first perf.) 762 ft Casing type: ; Diam. 12 in

Finish: porous concrete, gravel w. (perf.), gravel w. (screen), horiz. gallery, open end, other 31

Method Drilled: (A) air bored, (B) cable, (C) dug, (D) hyd jettied, (E) air rot., (F) percussion, (G) rotary, (H) reverse, (I) trenching, (J) driven, (K) drive wash, (L) other 42

Date Drilled: 945 Pump intake setting: ft

Driller: Carless

Lift (type): (A) air, (B) bucket, (C) cent, (D) jet, (E) multiple, (F) multiple, (G) none, (H) piston, (I) rot, (J) submerg, (K) turb, (L) other 39 Deep Shallow

Power (type): diesel, elec, gas, gasoline, hand, gas, wind; H.P. 40 Trans. or meter no. V

Descrip. MP above ft below LSD, Alt. MP

Alt. LSD: 140 Accuracy: (source) 3

Water Level: above ft below MP; Ft below LSD 29 Accuracy: G

Date meas: 155 Yield: 1115 gpm Method determined 41

Drawdown: ft Accuracy: Pumping period: hrs

QUALITY OF WATER DATA: Iron ppm Sulfate ppm Chloride ppm Hard. ppm

Sp. Conduct K x 10 Temp. °F Date sampled

Taste, color, etc.

WATER RESOURCES DIVISION

Well No. M 41

Well No. M 41

Latitude-longitude _____
d m s N S

HYDROGEOLOGIC CARD

SAME AS ON MASTER CARD Physiographic Province: _____ Section: _____

E Drainage Basin: _____ USA Subbasin: _____

Topo of well site: (D) depression, stream channel, dunes, flat, hilltop, sink, swamp, (E) offshore, pediment, hillside, terrace, undulating, valley flat (F) (H) (K) (L) (P) (S) (T) (U) (V) _____

MAJOR AQUIFER: _____ system _____ series TE _____ aquifer, formation, group SS

Lithology: _____ US Origin: _____ Z Aquifer Thickness: _____ ft
Length of well open to: _____ ft 8.5 Depth to top of: _____ ft

MINOR AQUIFER: _____ system _____ series _____ aquifer, formation, group _____

Lithology: _____ Origin: _____ Aquifer Thickness: _____ ft
Length of well open to: _____ ft _____ Depth to top of: _____ ft

Intervals Screened: _____

Depth to consolidated rock: _____ ft _____ Source of data: _____

Depth to basement: _____ ft _____ Source of data: _____

Surficial material: _____ Infiltration characteristics: _____

Coefficient Trans: _____ gpd/ft² _____ Coefficient Storage: _____

Perm: _____ gpd/ft²; Spco cap: _____ gpm/ft; Number of geologic cards: _____

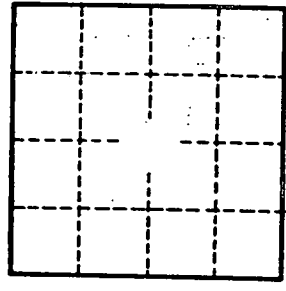
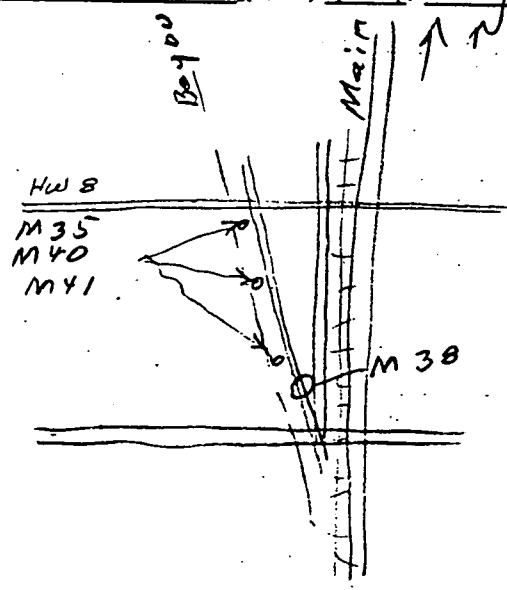

Well No.

M 41

MISSISSIPPI DEPARTMENT OF NATURAL RESOURCES

Bureau of Land and Water Resources

P. O. Box 10631
Jackson, Mississippi 39209
WATER WELL PLUGGING
DECOMMISSIONING

33445090425501

COUNTY WELL LOCATED BOLIVAR	
WELL NUMBER 1 A <i>m41</i>	CODED
DATE WELL PLUGGED 07/23/91	

PERMIT NUMBER
NAME OF DRILLING FIRM LAYNE-CENTRAL CO.
CLEVELAND, MS 38732

NAME & MAILING ADDRESS OF LANDOWNER			
CITY OF CLEVELAND			
P.O. BOX 1439			
CLEVELAND, MS 38732			
WELL LOCATION	SEC	TOWNSHIP	RANGE
	21	22N	5W
DISTANCE	DIRECTION	NEAREST TOWN	
APPROX. 200' SOUTH OF INTERSECTION OF BAYOU AVE. AND HWY. 8.			
OTHER LANDMARK @ NORTH END OF CITY SHOP			
WELL PURPOSE: Home, Irrigation, Municipal, Industrial, Fish Pond, etc. MUNICIPAL			

NAME OF WELL CONTRACTOR WHO DRILLED THE WELL		
NAME OF LANDOWNER WHEN WELL WAS CRILLED CITY OF CLEVELAND		
WELL DATA		
Well Depth 822'	Casing Diameter (In.) 12	Casing Length (Ft.) 668
Type of Casing STEEL	Hole Depth 822	Depth to Static Water Level NOT MEASURED
DATE WELL COMPLETED APPROXIMATELY 1946		

DESCRIBE HOW THE WELL OR HOLE WAS PLUGGED:
(AMOUNT OF CASING AND/OR SCREEN THAT WAS REMOVED, OR LEFT IN HOLE,
MATERIAL USED IN PLUGGING, ETC.)

PUMP WAS REMOVED - CEMENT LINE WAS RUN TO BOTTOM OF WELL AND
FILLED WITH CEMENT SLURRY BY HALLIBURTON SERVICES, INC.

RECEIVED

AUG 01 1991

Dept. of Environmental Quality
Bureau of Land & Water Resources

I CERTIFY THAT THE WELL WAS PLUGGED OR ABANDONED IN ACCORDANCE WITH THE STATE OF MISSISSIPPI REGULATIONS.

[Signature]

SIGNATURE

7/31/91

DATE

[Handwritten mark]