

Reprinted 7/82

FORM 9-1642 (1-68)

Well No. H39

WELL SCHEDULE

U. S. DEPT. OF THE INTERIOR

GEOLOGICAL SURVEY

WATER RESOURCES DIVISION

PUNCHED

MASTER CARD

Record by JCM Source of data BOWC Date 4-72 Map _____

State 28 County (or town) Benton 05

Latitude: 34 47 40 N Longitude: 089 13 10 Sequential number: 1

Lat-long accuracy: 5 30 R 10 E Sec 31 SW SE SE

Local well number: H0390D103501E Other number: _____

Local use: 216 Owner or name: _____

Owner or name: CECIL HARRIS Address: Ashland

Ownership: County, Fed Gov't, City, Corp or Co, Private, State Agency, Water Dist P

Use of water: (A) Air cond, (B) Bottling, (C) Comm, (D) Dewater, (E) Power, (F) Fire, (G) Dom, (H) Irr, (I) Med, (J) P S, (K) Rec, (L) Stock, (M) Instat, (N) Unused, (O) Reppure, (P) Recharge, (Q) Desal-P S, (R) Desal-Other H

Use of well: (A) Anode, (B) Drain, (C) Seismic, (D) Heat Res, (E) Obs, (F) Oil-gas, (G) Recharge, (H) Test, (I) Unused, (J) Withdraw, (K) Waste, (L) Destroyed W

DATA AVAILABLE: Well data 0 Freq. W/L meas.: 0 Field aquifer char. 0

Hyd. lab. data: _____

Qual. water data; type: UWGS 1/74

Freq. sampling: 0 Pumpage inventory: yes 0 no, period: _____

Aperture cards: _____ yes 0

Log data: D

WELL-DESCRIPTION CARD

SAME AS ON MASTER CARD Depth well: _____ ft 330 Meas. 3

Depth cased; (first perf.) _____ ft 320 Casing type: plc; Diam. _____ in 4

Finish: porous concrete, gravel w. (perf.), gravel w. (screen), horiz. open perf., screen, sd. pt., shored, open hole, other S

Method Drilled: (A) air bored, (B) cable, (C) dug, (D) hyd jetted, (E) air reverse, (F) trenching, (G) driven, (H) drive wash, (I) rot., (J) percussion, (K) rotary, (L) other H

Date Drilled: 9-7-72 Pump intake setting: _____ ft 0

Driller: A. J. Modlin name _____ address _____

Lift (type): (A) air, (B) bucket, (C) cent, (D) jet, (E) multiple, (F) multiple, (G) none, (H) piston, (I) rot, (J) submerg, (K) turb, (L) other S Deep 0 Shallow 40

Power (type): diesel, elec, gas, gasoline, hand, gas, wind; H.P. 1/2 5 Trans. or meter no. _____

Descrip. MP _____ ft above _____ below LSD, Alt. MP _____

Alt. LSD: _____ Accuracy: _____ (source) _____

Water Level _____ ft above _____ below MP; _____ ft above _____ below LSD Accuracy: _____

Date meas: 3-7-72 Yield: _____ gpm 6 Method determined _____

Drawdown: _____ ft _____ Accuracy: _____ Pumping period _____ hrs _____

QUALITY OF WATER DATA: Iron _____ ppm Sulfate _____ ppm Chloride _____ ppm Hard. _____ ppm

Sp. Conduct 100 K x 10 1 Temp. 17.0 °F Date sampled 1-15-74 17.2

Taste, color, etc. pH = 6.3

Well No.

H39

HYDROGEOLOGIC CARD

SAME AS ON MASTER CARD Physiographic Province: _____ Section: 03

D Drainage Basin: 13E Subbasin: _____

Topo of well site: (D) depression, stream channel, dunes, flat, hilltop, sink, swamp, (P) offshore, pediment, hillside, terrace, undulating, valley flat
(Φ) (P) (S) (T) (U) (V)

MAJOR AQUIFER: system _____ series T.E aquifer, formation, group L.W

Lithology: _____ Origin: 6 Aquifer Thickness: 70 ft

Length of well open to: _____ ft 10 Depth to top of: _____ ft 260

MINOR AQUIFER: system _____ series _____ aquifer, formation, group _____

Lithology: _____ Origin: _____ Aquifer Thickness: _____ ft

Length of well open to: _____ ft _____ Depth to top of: _____ ft _____

Intervals Screened: 4" Rlc

Depth to consolidated rock: _____ ft _____ Source of data: _____

Depth to basement: _____ ft _____ Source of data: _____

Surficial material: _____ Infiltration characteristics: _____

Coefficient Trans: _____ gpd/ft _____ Coefficient Storage: _____

Coefficient Perm: _____ gpd/ft²; Spec cap: _____ gpm/ft; Number of geologic cards: _____

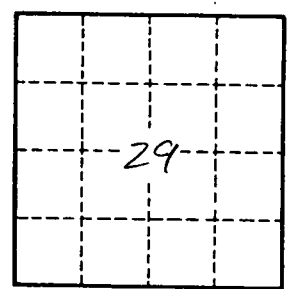
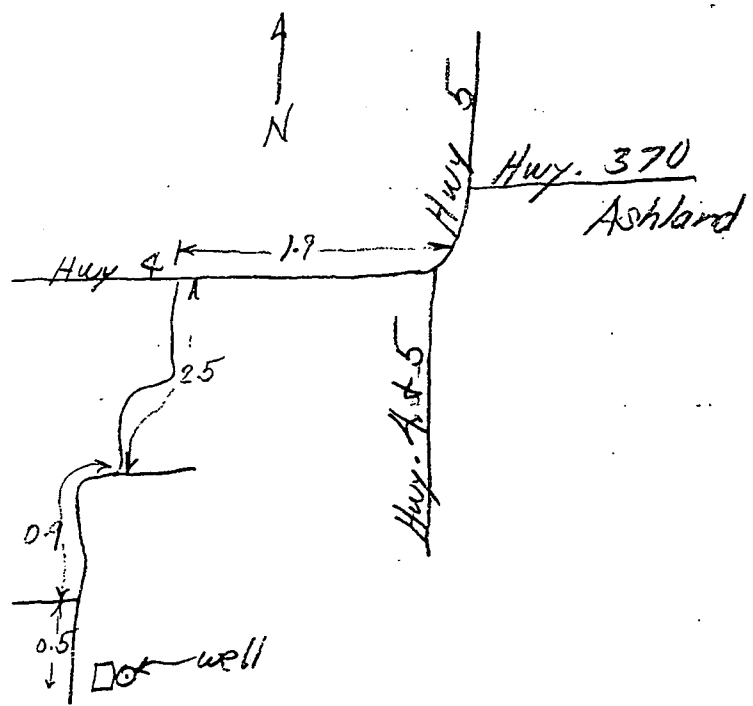

Well No.

H39