

Well No. 112

Latitude-longitude N
S
d m s d m s

HYDROGEOLOGIC CARD

SAME AS ON MASTER CARD

Physiographic Province: _____

03 Section: _____

D Drainage Basin: _____

13T Subbasin: _____

Topo of well site: (D) depression, stream channel, dunes, flat, hilltop, sink, swamp, (E) (F) (H) (K) (L) (P) (S) (T) (U) (V) offshore, pediment, hillside, terrace, undulating, valley flat

MAJOR AQUIFER:

system _____ series TE aquifer, formation, group TA

Lithology: _____ Origin: S Aquifer Thickness: 3 ft

Length of well open to: _____ ft Depth to top of: _____ ft

MINOR AQUIFER:

system _____ series _____ aquifer, formation, group _____

Lithology: _____ Origin: _____ Aquifer Thickness: _____ ft

Length of well open to: _____ ft Depth to top of: _____ ft

Intervals Screened:

Depth to consolidated rock: _____ ft Source of data: _____

Depth to basement: _____ ft Source of data: _____

Surficial material: _____ Infiltration characteristics: _____

Coefficient Trans: _____ gpd/ft Coefficient Storage: _____

Coefficient Perm: _____ gpd/ft²; Spec cap: _____ gpm/ft; Number of geologic cards: _____

Rt 2 Box 50C

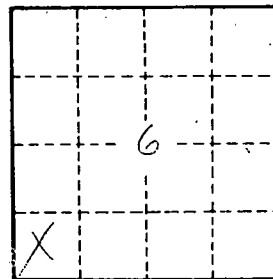
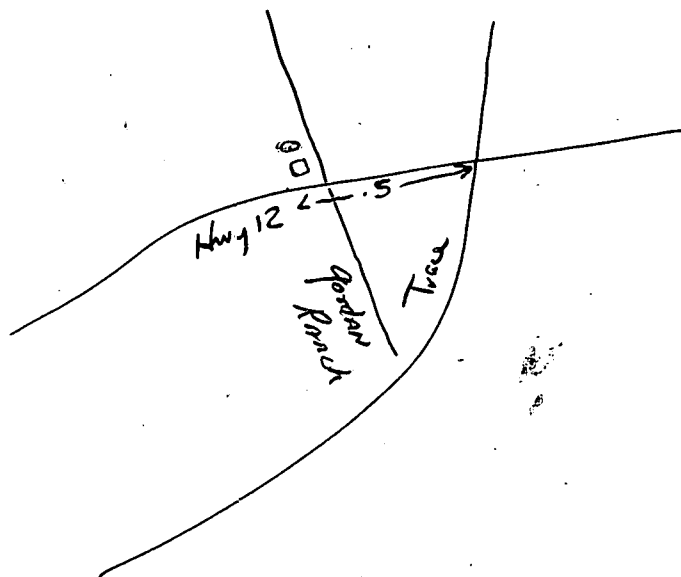

Well No.

M. C. E. Morgan is a lawyer in Kosciusko.

WELL SCHEDULE

U. S. DEPT. OF THE INTERIOR

GEOLOGICAL SURVEY

WATER RESOURCES DIVISION

MASTER CARD #

Record by Bew Source of data tenant Date 2-8-57 Map _____

State 28 County (or town) Attala 04

Latitude: 33 05 38 N Longitude: 08 43 12 9 Sequential number: 1

Lat-long accuracy: 4 T 14 S, R 8 W, Sec 6, SW 1/4, SW 1/4

Local well number: N002CC0614N08E Other number: _____

Local use: _____ Owner or name: #2

Owner or name: C. E. MORGAN Address: Rt. 2 Box 50C

Ownership: County, Fed Gov't, City, Corp or Co, Private, State Agency, Water Dist P

Use of water: (A) Air cond, Bottling, Comm, Dewater, Power, Fire, Dom, Irr, Med, Ind, P S, Rec, (S) Stock, Instit, Unused, Repressure, Recharge, Desal-P S, Desal-other, Other H

Use of well: (A) Anode, Drain, Seismic, Heat Res, Obs, Oil-gas, Recharge, Test, Unused, Withdraw, Waste, Destroyed. W

DATA AVAILABLE: Well data Freq. W/L meas.: Field aquifer char.

Hyd. lab. data: _____

Qual. water data; type: _____

Freq. sampling: Pumpage inventory: no, period: _____

Aperture cards: _____

Log data: _____

WELL-DESCRIPTION CARD

SAME AS ON MASTER CARD Depth well: 140 Meas. rept accuracy 6

Depth cased: _____ Casing type: _____; Diam. in 2

Finish: (C) porous concrete, (F) gravel w. (perf.), (G) screen, (H) horiz. gallery, (I) open end, (J) rot., (K) air bored, (L) cable dug, (M) hyd jetted, (N) percuss, (O) rotary, (P) perf., (Q) screen, (R) sd. pt., (S) shored, (T) open hole, (U) other H

Method Drilled: (A) air bored, (B) cable dug, (C) hyd jetted, (D) percuss, (E) rotary, (F) reverse, (G) trenching, (H) driven, (I) drive wash, (J) other H

Date Drilled: Dec 9 5 6 Pump intake setting: _____ ft _____

Driller: E. Presley name address _____

Lift (type): (A) air, (B) bucket, (C) cent, (D) jet, (E) multiple, (F) multiple, (G) none, (H) piston, (I) rot, (J) submerg, (K) turb, (L) other 1 Deep 1 Shallow 40

Power (type): (A) diesel, (B) elec, (C) gas, (D) gasoline, (E) hand, (F) gas, (G) wind, (H) H.P. 3/4 5 Trans. or meter no. _____

Descrip. MP _____ ft above _____ below LSD, Alt. MP _____

Alt. LSD: 410 TOPO Accuracy: _____

Water Level: _____ ft above _____ below MP; _____ ft below LSD Accuracy: _____

Date meas: _____ Yield: _____ gpm Method determined _____

Drawdown: _____ ft Accuracy: _____ Pumping period _____ hrs _____

QUALITY OF WATER DATA: Iron _____ ppm Sulfate _____ ppm Chloride _____ ppm Hard. _____ ppm

Sp. Conduct _____ K x 10 _____ Temp. _____ °F Date sampled _____

Taste, color, etc. hard - iron

WELL NO.