

WELL SCHEDULE

U. S. DEPT. OF THE INTERIOR

GEOLOGICAL SURVEY

WATER RESOURCES DIVISION

PUNCHED and VERIFIED
ROLLA COMPUTATION BRANCH

MASTER CARD

Record by B.E. Ellison Source of data W.M. Conroy Const. Super Date 5-12-60 Map _____

State Mississippi 28 County (or town) Amite 03

Latitude: 31° 08' 35" N Longitude: 090° 48' 27" W Sequential number: 1

Lat-long accuracy: 2' T. 2 S. R. 4 W. Sec 16 NW NE

Local well number: N 0 0 2 B A 1 6 0 2 N O 4 E Other number: Old Name

Local use: 038 Owner or name: Liberty Rosenwald School

Owner or name: CENTRAL SCHOOL Address: Liberty Miss

Ownership: County, Fed Gov't, City, Corp or Co, Private, State Agency, Water Dist C

Use of water: (A) Air cond, (B) Bottling, (C) Comm, (D) Dewater, (E) Power, (F) Fire, (H) Dom, (I) Irr, (M) Med, (N) Ind, (P) S, (R) Rec, (S) Stock, (T) Instit, (U) Unused, (V) Recharge, (W) Recharge, (X) Desal-P S, (Y) Desal-other, (Z) Other T

Use of well: (A) Anode, (D) Drain, (G) Seismic, (H) Heat Res, (P) Obs, (R) Oil-gas, (T) Recharge, (U) Test, (V) Unused, (W) Withdraw, (X) Waste, (Z) Destroyed W

DATA AVAILABLE: Well data Freq. W/L meas.: Field aquifer char.

Hyd. lab. data: _____

Qual. water data; type: USGS Complete 1968

Freq. sampling: original Pumpage inventory: yes, no, period: _____

Aperture cards: _____ yes

Log data: _____

WELL-DESCRIPTION CARD

SAME AS ON MASTER CARD Depth well: 220' ft 220 Meas. rept accuracy 6

Depth cased: (first perf.) 190 ft 190 Casing type: Steel; Diam. 8 in 8

Finish: (C) porous concrete, (F) gravel w. (perf.), (G) gravel w. (screen), (H) horiz. gallery, (I) open end, (P) perf., (S) screen, (T) sd. pt., (W) shored, (X) open hole, (Z) other S

Method Drilled: (A) air rot, (B) bored, (C) cable, (D) dug, (H) hyd jetted, (J) air rot., (P) percussion, (R) reverse, (T) trenching, (V) driven, (W) drive wash, (Z) other H

Date Drilled: 1960 9:60 Pump intake setting: _____ ft 36 38

Driller: Dean Griner, Columbia Miss

Lift (type): (A) air, (B) bucket, (C) cent, (J) jet, (L) multiple, (M) multiple, (N) none, (P) piston, (R) rot, (S) submerg, (T) turb, (Z) other S Deep D Shallow 40

Power (type): (nat) diesel, (elec) gas, (LP) gasoline, hand, gas, wind; H.P. 5 Trans. or meter no. _____

Descrip. MP 1.5 ft above LSD. Alt. MP _____

Alt. LSD: 340 Accuracy: (source) T 5

Water Level 62.14 ft above MP; Ft 6.7 below LSD Accuracy: _____ 52 A

Date meas: 3:70 Yield: 80 gpm 8:0 Method determined 61

Drawdown: _____ ft Accuracy: _____ Pumping period _____ hrs 66 68

QUALITY OF WATER DATA: Iron _____ ppm Sulfate _____ ppm Chloride _____ Hard. _____ 72

Sp. Conduct <50 K x 10 0 Temp. 65 °F 118 Date sampled 3-11-68 363 77 79

Taste, color, etc. Field PH=5.7

Well No.

Well No. N2

Latitude-longitude 31.08.41 [°] 90.48.24
d m s d m s

HYDROGEOLOGIC CARD

SAME AS ON MASTER CARD Physiographic Province: 03 Section: _____

D Drainage Basin: 146 Subbasin: _____

(D) (C) (E) (F) (H) (K) (L) Topo of depression; stream channel, dunes, flat, hilltop, sink, swamp,
well site: (O) (P) (S) (T) (U) (V) offshore, pediment, hillside, terrace, undulating, valley flat _____

MAJOR AQUIFER: _____ system _____ series T.M _____ aquifer, formation, group M.Z

Lithology: _____ Origin: 3 Aquifer Thickness: _____ ft

Length of well open to: _____ ft 310 Depth to top of: _____ ft

MINOR AQUIFER: _____ system _____ series _____ aquifer, formation, group _____

Lithology: _____ Origin: _____ Aquifer Thickness: _____ ft

Length of well open to: _____ ft _____ Depth to top of: _____ ft

Intervals Screened: 190-220

Depth to consolidated rock: _____ ft _____ Source of data: _____

Depth to basement: _____ ft _____ Source of data: _____

Surficial material: _____ Infiltration characteristics: _____

Coefficient Trans: _____ gpd/ft _____ Coefficient Storage: _____

Coefficient Perm: _____ gpd/ft²; Spec cap: _____ gpm/ft; Number of geologic cards: _____

3-11-70
 75.00
 12.86
 62.14
 - 1.50 MP
 WL 60.64 GL
 WTD

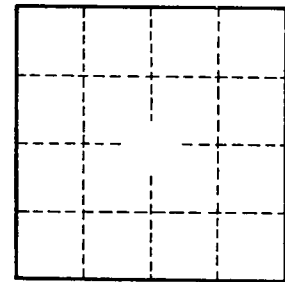
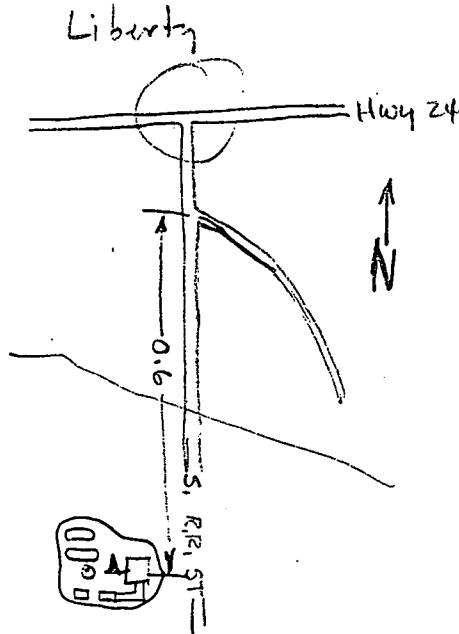

Well No. _____

N2