

2266 Liberty - 20'

WRD Exp. (GW)
April 1966

Well No. H2

WELL SCHEDULE

U. S. DEPT. OF THE INTERIOR

GEOLOGICAL SURVEY

WATER RESOURCES DIVISION

MASTER CARD

Record by MOWC + WTO Source of data driller-owner Date 4-3-68 Map _____

State Miss. 28 County AMITE 13
(or town)

Latitude: 31 13 24 N 11 S Longitude: 09 05 03 7 Sequential number: 1
deg min sec 12 degrees 15 min sec 18

Lat-long accuracy: 3 T. 3 S. R. 4 Sec 18 NE SW B & M

Local well number: 11022A 1803 04 W Other number: _____

Local use: 065 Owner or name: W.D. KIMBROUGH

Owner or name: W D KIMBROUGH Address: Rt# Liberty

Ownership: County, Fed Gov't, City, Corp or Co, Private, State Agency, Water Dist P

Use of water: (A) Air cond, Bottling, Comm, Dewater, Power, Fire, Dom, Irr, Med, Ind, P S, Rec, (S) Stock, Instit, Unused, Repressure, Recharge, Desal-P S, Desal-other, Other H

Use of well: (A) Anode, Drain, Seismic, Heat Res, Obs, Oil-gas, Recharge, Test, Unused, Withdraw, Waste, Destroyed W

DATA AVAILABLE: Well data Freq. W/L meas.: Field aquifer char.

Hyd. lab. data: _____

Qual. water data; type: USGS Complete 1968

Freq. sampling: Pumpage inventory: yes no; period: _____

Aperture cards: _____ yes

Log data: _____

WELL-DESCRIPTION CARD

SAME AS ON MASTER CARD Depth well: 279 ft Meas. 279 accuracy 3

Depth cased: _____ ft 269 Casing type: galv.; Diam. _____ in 4

Finish: (C) porous concrete, (F) gravel w. concrete, (G) gravel w. (screen), (H) horiz. gallery, (O) open end, (P) perf., (S) screen, (T) sd. pt., (W) shored, (X) open hole, (Z) other S

Method Drilled: (A) air rot, (B) bored, (C) cable, (D) dug, (H) hyd. rot., (J) jetted, (P) air percussion, (R) reverse, (T) trenching, (V) driven, (W) drive wash, (Z) other H

Date Drilled: 1965 9 6 5 Pump intake setting: 165' ft 165

Driller: Reeves Well + Pump

Lift (type): (A) air, (B) bucket, (C) cent., (J) jet, (L) multiple, (M) multiple, (N) none, (P) piston, (R) rot., (S) submerg., (T) turb., other S Deep D Shallow 40

Power (type): (nat) diesel, (elec) gas, gasoline, hand, gas, wind; H.P. 1/2 Trans. or meter no. T

Descrip. MP _____ ft above below LSD. Alt. MP _____

Alt. LSD: 400 Accuracy: (source) _____

Water Level: 108 ft above below MP; Ft. below LSD 108 Accuracy: _____

Date meas: _____ Yield: _____ gpm Method determined _____

Drawdown: _____ ft Accuracy: _____ Pumping period _____ hrs _____

QUALITY OF WATER DATA: Iron _____ ppm Sulfate _____ ppm Chloride _____ ppm Hard. _____ ppm

Sp. Conduct 75 K x 10⁶ Temp. 67 °F Date sampled 4-3-68 468

Taste, color, etc. Field pH = 6.3

Latitude-longitude 31 13 23 ^N 90 50 36
d m s d m s

HYDROGEOLOGIC CARD

SAME AS ON MASTER CARD Physiographic Province: 03 Section: _____

D Drainage Basin: 14G Subbasin: _____

(D) (C) (E) (F) (H) (K) (L)
 Topo of well site: depression, stream channel, dunes, flat, hilltop, sink, swamp,
 (Φ) (P) (S) (T) (U) (V)
 offshore, pediment, hillside, terrace, undulating, valley flat _____ F

MAJOR AQUIFER: system _____ series TM aquifer, formation, group MZ

Lithology: _____ Origin: 3 Aquifer Thickness: 17 ft

Length of well open to: _____ ft 10 Depth to top of: _____ ft 2

MINOR AQUIFER: system _____ series _____ aquifer, formation, group _____

Lithology: _____ Origin: _____ Aquifer Thickness: _____ ft

Length of well open to: _____ ft _____ Depth to top of: _____ ft _____

Intervals Screened: 269' - 279' 10' x 3"

Depth to consolidated rock: _____ ft _____ Source of data: _____

Depth to basement: _____ ft _____ Source of data: _____

Surficial material: _____ Infiltration characteristics: _____

Coefficient Trans: _____ gpd/ft _____ Coefficient Storage: _____

Coefficient Perm: _____ gpd/ft²; Spec cap: _____ gpm/ft; Number of geologic cards: _____

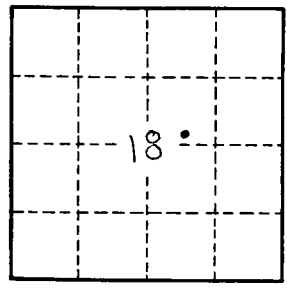
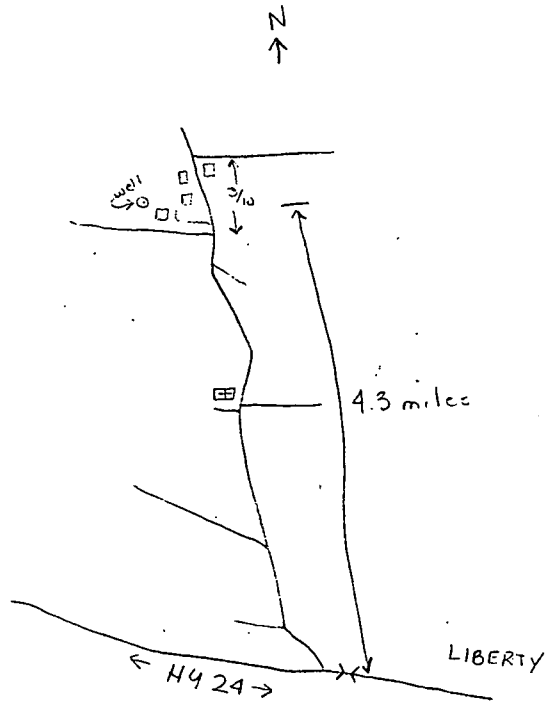

Well No. H2