

WELL SCHEDULE  
GEOLOGICAL SURVEY

**PUNCHED**  
WATER RESOURCES DIVISION

U. S. DEPT. OF THE INTERIOR

DEC-28-1972

MASTER CARD

Record by G. J. Dakin (Hitt) Source of data owner Date 10-1-56 Map Corinth

State 28 County (or town) Alcorn 02

Latitude: 345555 N Longitude: 0883525 Sequential number: 1

Lat-long accuracy: 3 T 2 R 7 Sec 5 NW SE SW

Local well number: G006DC0502S07E Other number: \_\_\_\_\_ B & M

Local use: \_\_\_\_\_ Owner or name: PAUL JONES Address: \_\_\_\_\_

Ownership: County, Fed Gov't, City, Corp or Co, Private, State Agency, Water Dist P

Use of water: (A) Air cond, (B) Bottling, (C) Comm, (D) Dewater, (E) Power, (F) Fire, (G) Irr, (H) Med, (I) Ind, (J) P S, (K) Rec, (L) Stock, (M) Insit, (N) Unused, (O) Reppure, (P) Recharge, (Q) Desal-P S, (R) Desal-other, (S) Other H

Use of well: (A) Anode, (B) Drain, (C) Seismic, (D) Heat Res, (E) Obs, (F) Oil-gas, (G) Recharge, (H) Test, (I) Unused, (J) Withdraw, (K) Waste, (L) Destroyed W

DATA AVAILABLE: Well data  Freq. W/L meas.:  Field aquifer char.

Hyd. lab. data: \_\_\_\_\_

Qual. water data; type: \_\_\_\_\_

Freq. sampling: \_\_\_\_\_ Pumpage inventory:  yes  no period: \_\_\_\_\_

Aperture cards: \_\_\_\_\_ yes

Log data: \_\_\_\_\_

WELL-DESCRIPTION CARD

SAME AS ON MASTER CARD Depth well: 200± ft 200 Meas. 6 accuracy 30

Depth cased; (first perf.) \_\_\_\_\_ ft 30 Casing type: 5 Diam. in 3

Finish: (C) porous concrete, (F) gravel w. (G) gravel w. (H) horz. open (I) perf., (J) screen, (K) sd. pt., (L) shored, (M) open (N) other X

Method Drilled: (A) air rot, (B) bored, (C) cable, (D) dug, (E) hyd rot., (F) jettad, (G) air percussion, (H) reverse, (I) rotary, (J) trenching, (K) driven, (L) wash, (M) other H

Date Drilled: \_\_\_\_\_ Pump intake setting: \_\_\_\_\_ ft \_\_\_\_\_

Driller: \_\_\_\_\_ name \_\_\_\_\_ address \_\_\_\_\_

Lift (type): (A) air, (B) bucket, (C) cent, (D) jar, (E) multiple (cent.), (F) multiple (turb.), (G) none, (H) piston, (I) rot, (J) submerg, (K) turb, (L) other W Deep  Shallow

Power (type): diesel, elec, gas, gasoline, hand, gas, wind; H.P. \_\_\_\_\_ Trans. of meter no. \_\_\_\_\_

Descrip. MP 405' (11/89) ft above below LSD, Alt. MP \_\_\_\_\_

Alt. LSD: 40.0 Accuracy: 5 (source)

Water Level \_\_\_\_\_ ft above below MP; Ft below LSD 4 Accuracy: \_\_\_\_\_

Date meas: 10-1956 0.56 Yield: 10-1-56 spm 3 Method determined

Drawdown: \_\_\_\_\_ ft Accuracy: \_\_\_\_\_ Pumping period \_\_\_\_\_ hrs \_\_\_\_\_

QUALITY OF WATER DATA: Iron \_\_\_\_\_ Sulfate \_\_\_\_\_ Chloride \_\_\_\_\_ Hard. \_\_\_\_\_

Sp. Conduct \_\_\_\_\_ K x 10<sup>6</sup> Temp. \_\_\_\_\_ °F \_\_\_\_\_ Date sampled \_\_\_\_\_

Taste, color, etc. Fe, clear

Well No.

66

Well No. 66

**PUNCHED**

Latitude-longitude

HYDROLOGIC DISTRICT: 930

SAME AS ON MASTER CARD

Physiographic Province: \_\_\_\_\_

Section: 03

Drainage Basin: D

Subbasin: 16L

Topo of well site: (D) depression, stream channel, dunes, flat, hilltop, sink, swamp.  
(S) offshore, pediment, hillside, terrace, undulating, valley flat

MAJOR AQUIFER: A3

CS

Lithology: U Origin: 6 Aquifer Thickness: \_\_\_\_\_ ft

Length of well open to: \_\_\_\_\_ ft Depth to top of: \_\_\_\_\_ ft

MINOR AQUIFER: \_\_\_\_\_

Lithology: \_\_\_\_\_ Origin: \_\_\_\_\_ Aquifer Thickness: \_\_\_\_\_ ft

Length of well open to: \_\_\_\_\_ ft Depth to top of: \_\_\_\_\_ ft

Interval Screened: \_\_\_\_\_

Depth to consolidated rock: \_\_\_\_\_ ft Source of data: \_\_\_\_\_

Depth to basement: \_\_\_\_\_ ft Source of data: \_\_\_\_\_

Surficial material: \_\_\_\_\_ Infiltration characteristics: \_\_\_\_\_

Coefficient Trans: \_\_\_\_\_ gpd/ft Coefficient Storage: \_\_\_\_\_

Coefficient Perm: \_\_\_\_\_ gpd/ft<sup>2</sup>; Spec cap: \_\_\_\_\_ gpm/ft; Number of geologic cards: \_\_\_\_\_

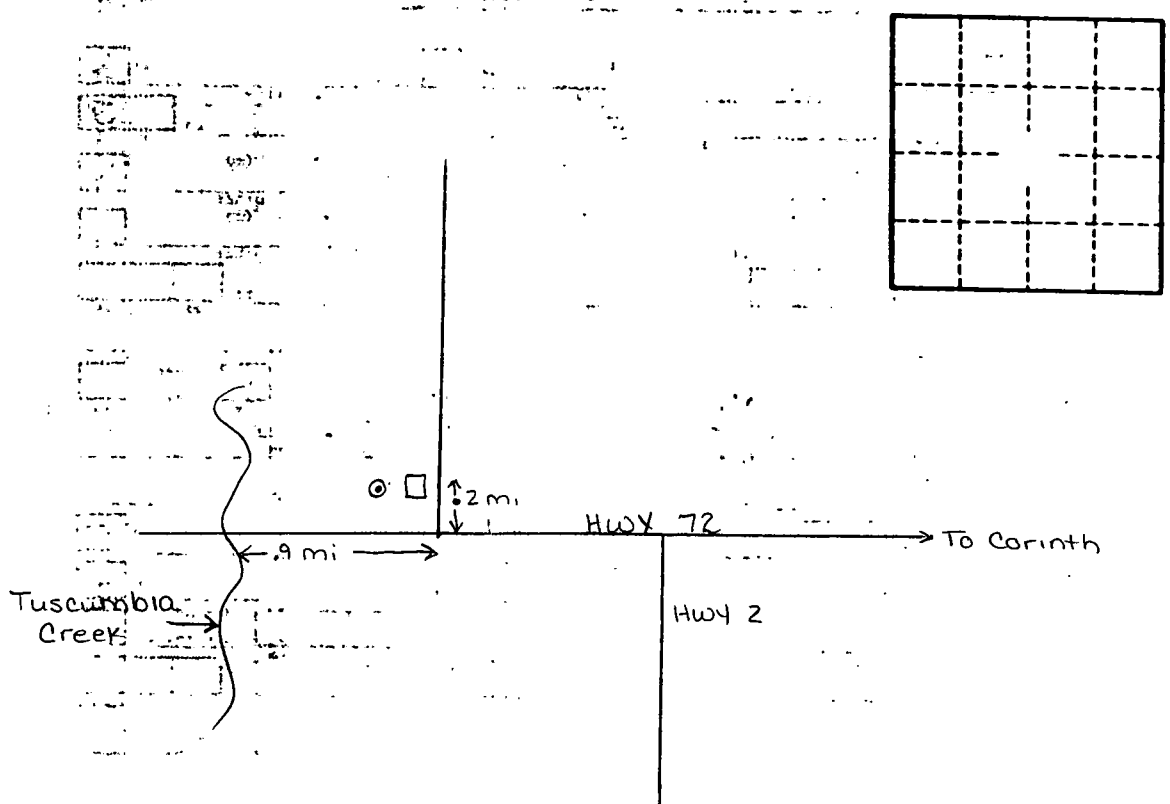

Well No.

66