

WELL SCHEDULE

PUNCHED

U. S. DEPT. OF THE INTERIOR

GEOLOGICAL SURVEY

WATER RESOURCES DIVISION

DEC 28 1972

MASTER CARD

Record by (B.E. Ellison) Source of data owner Date 10-19-61 Map Kossuth N

State 28 County (or town) Alcorn 02

Latitude: 345601N Longitude: 088375W Sequential number: 1

Lat-long accuracy: 30 T 2 S R 6 W Sec 2 SE t, SE t, SE t

Local well number: F025DD0202506E Other number: \_\_\_\_\_

Local use: \_\_\_\_\_ Owner or name: \_\_\_\_\_

Owner or name: A. E. SULTOR Address: Cosinth

Ownership: County, Fed Gov't, City, Corp or Co, Private, State Agency, Water Dist P

Use of Air cond, Bottling, Comm, Dewater, Power, Fire, Dom, Irr, Med, Ind, P S, Rec, water: \_\_\_\_\_

Stock, Instit, Unused, Repressure, Recharge, Desal-P S, Desal-other, Other H

Use of well: (A) Anode, (D) Drain, (G) Seismic, (H) Heat Res, (O) Obs, (P) Oil-gas, (R) Recharge, (T) Test, (U) Unused, (W) Withdraw, (X) Waste, (B) Destroyed. W

DATA AVAILABLE: Well data  Freq. W/L meas.:  Field aquifer char.

Hyd. lab. data: \_\_\_\_\_

Qual. water data; type: \_\_\_\_\_

Freq. sampling: \_\_\_\_\_ Pumpage inventory:  no; period: \_\_\_\_\_

Aperture cards: \_\_\_\_\_ yes

Log data: \_\_\_\_\_

WELL-DESCRIPTION CARD

SAME AS ON MASTER CARD Depth well: 350 ft Meas. 6

Depth cased: \_\_\_\_\_ Casing type: 25 ft; Diam. 4 in

Finish: (C) porous concrete, (F) gravel w. (G) gravel w. (H) horiz. open (P) perf., (S) screen, (T) sd. pt., (W) shored, (X) open hole, (B) other X

Method Drilled: (A) air rot, (B) bored, (C) cable, (D) dug, (H) hyd jetted, (J) air rot., (P) reverse percussion, (R) rotary, (T) trenching, (V) driven, (W) drive wash, (B) other H

Date Drilled: 930 Pump intake setting: \_\_\_\_\_ ft

Driller: Edd Blankenship Tenn.

Lift (type): (A) air, (B) bucket, (C) cent, (J) jet, (L) multiple, (M) multiple, (N) none, (P) piston, (R) rot, (S) submerg, (T) turb, (B) other P Deep  Shallow

Power (type): nat, LP, diesel, elec, gas, gasoline, hand, gas, wind; H.P. 1 Trans. or meter no. \_\_\_\_\_

Descrip. MP top of 6' casing OK (10/79) Alt. MP \_\_\_\_\_

Alt. LSD: 435 Accuracy: \_\_\_\_\_

Water Level above MP; Ft below LSD 45 Accuracy: \_\_\_\_\_

Date mea: \_\_\_\_\_ Yield: \_\_\_\_\_ gpm Method determined \_\_\_\_\_

Drawdown: \_\_\_\_\_ ft Accuracy: \_\_\_\_\_ Pumping period \_\_\_\_\_ hrs

QUALITY OF WATER DATA: Iron \_\_\_\_\_ ppm Sulfate \_\_\_\_\_ ppm Chloride \_\_\_\_\_ ppm Hard. \_\_\_\_\_ ppm

Sp. Conduct 250 K x 10<sup>6</sup> Temp. \_\_\_\_\_ °F Date sampled 11-19-73

Taste, color, etc. PH 7.2 F. = 0.9

See Level  
11/30/82  
WL-52.90

50  
WL 4.36  
45.64  
11-19-73  
WL-49.  
10/19/78  
Substitute well

Well No. F25

Well No. F 25

Latitude-longitude \_\_\_\_\_ N \_\_\_\_\_ S

HYDROGEOLOGIC CARD

SAME AS ON MASTER CARD

Physiographic Province: \_\_\_\_\_

Section: 03

Drainage Basin: D Subbasin: 162

Top of well site: (D) depression, stream channel, dunes, flat, hilltop, sink, swamp, (E) offshore, pediment, hillside, terrace, undulating, valley flat

MAJOR AQUIFER: system \_\_\_\_\_ series K3 aquifer, formation, group C3

Lithology: U5 Origin: 6 Aquifer Thickness: \_\_\_\_\_ ft  
Length of well open to: \_\_\_\_\_ ft Depth to top of: \_\_\_\_\_ ft

MINOR AQUIFER: system \_\_\_\_\_ series \_\_\_\_\_ aquifer, formation, group \_\_\_\_\_

Lithology: \_\_\_\_\_ Origin: \_\_\_\_\_ Aquifer Thickness: \_\_\_\_\_ ft  
Length of well open to: \_\_\_\_\_ ft Depth to top of: \_\_\_\_\_ ft

Intervals Screened: \_\_\_\_\_

Depth to consolidated rock: \_\_\_\_\_ ft Source of data: \_\_\_\_\_

Depth to basement: \_\_\_\_\_ ft Source of data: \_\_\_\_\_

Surficial material: \_\_\_\_\_ Infiltration characteristics: \_\_\_\_\_

Coefficient Trans: \_\_\_\_\_ gpd/ft<sup>2</sup> Coefficient Storage: \_\_\_\_\_

Coefficient Perm: \_\_\_\_\_ gpd/ft<sup>2</sup>; Spec cap: \_\_\_\_\_ gpm/ft; Number of geologic cards: \_\_\_\_\_

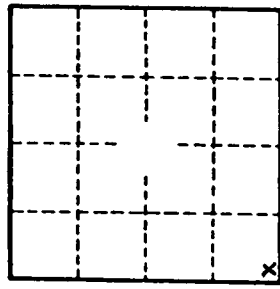
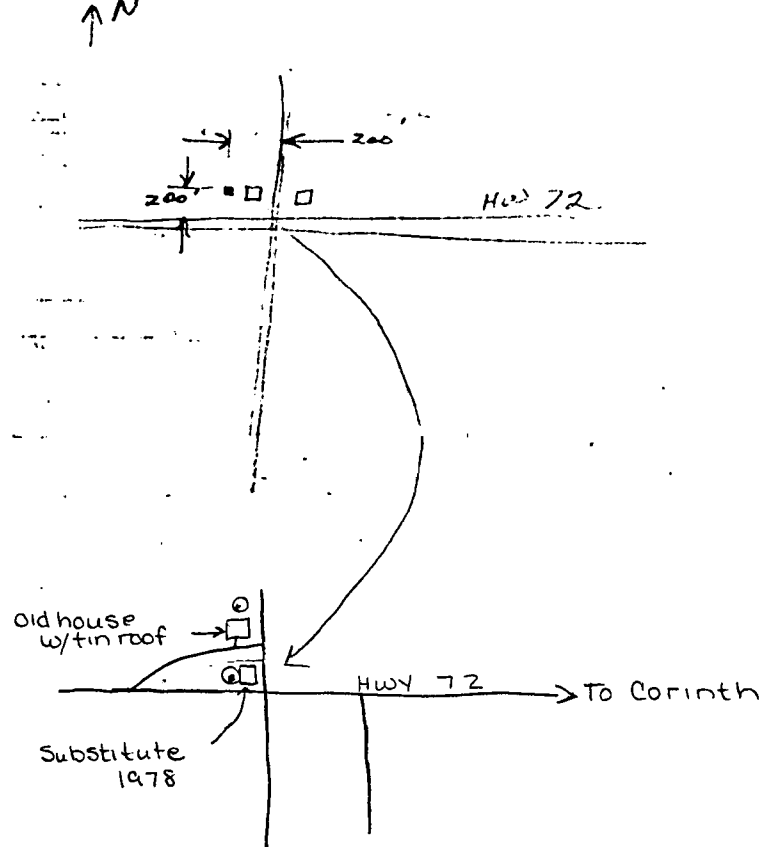

Well No. F 25