

WELL SCHEDULE

U. S. DEPT. OF THE INTERIOR

GEOLOGICAL SURVEY

WATER RESOURCES DIVISION

PUNCHED

DEC 28 1972

MASTER CARD

Record by G.J. Dugan (A.H.H.) Source of data Dugan Date 10-1-56 Map _____

State 28 County Alcorn 02

Latitude: 34 57 26 N Longitude: 088 32 46 Sequential number: 7

Lat-long accuracy: 3 T 1 R 2 W, Sec 34, NE 1/4, SW 1/4, NE 1/4

Local well number: 0016CA3401S07E Other number: _____

Local use: 118 Owner or name: M. McGehee Address: County R. 3

Ownership: County, Fed Gov't, City, Corp or Co, Private, State Agency, Water Dist P

Use of water: (A) Air cond, (B) Bottling, (C) Comm, (D) Dewater, (E) Power, (F) Fire, (H) Irr, (I) Med, (M) Ind, (N) P S, (P) Rec, (S) Stock, (T) Instit, (U) Unused, (V) Repressure, (W) Recharge, (X) Desal-P S, (Y) Desal-other, (Z) Other H

Use of well: (A) Anode, (D) Drain, (G) Seismic, (H) Heat Res, (I) Obs, (P) Oil-gas, (R) Recharge, (T) Test, (U) Unused, (W) Withdraw, (X) Waste, (Z) Destroyed W

DATA AVAILABLE: Well data Freq. W/L meas.: Field aquifer char.

Hyd. lab. data:

Qual. water data; type:

Freq. sampling: Pumpage inventory: yes no, period: _____

Aperture cards: yes

Log data:

WELL-DESCRIPTION CARD

SAME AS ON MASTER CARD Depth well: 230 ft Meas. rept accuracy 6

Depth cased: _____ ft Casing type: _____; Diam. _____ in 4

Finish: (C) porous concrete, (F) gravel w. (screen), (G) gravel w. (gallery), (H) horiz. end, (I) open end, (P) perf., (S) screen, (T) sd. pt., (W) shored, (X) open hole, (Z) other H

Method: (A) Drilled, (B) air bored, (C) cable, (D) dug, (H) rot., (J) hyd jetted, (P) air percussion, (R) reverse, (T) trenching, (V) driven, (W) drive wash, (Z) other

Date Drilled: _____ Pump intake setting: _____ ft _____

Driller: Con F. Fairer, County

Lift (type): (A) air, (B) bucket, (C) cent, (J) jet, (L) multiple, (M) multiple, (N) none, (P) piston, (R) rot, (S) submerg, (T) turb., (V) other J Deep Shallow

Power (type): diesel, elec, gas, gasoline, hand, gas, wind; H.P. 1/2 S Trans. or meter no. _____

Descrip. MP _____ ft above below LSD, Alt. MP _____

Alt. LSD: 520 Accuracy: 5

Water Level _____ ft above below MP; Ft below LSD _____ Accuracy: _____

Date meas: _____ Yield: _____ gpm _____ Method determined _____

Drawdown: _____ ft _____ Accuracy: _____ Pumping period _____ hrs _____

QUALITY OF WATER DATA: Iron _____ ppm Sulfate _____ ppm Chloride _____ ppm Hard. _____ ppm

Sp. Conduct _____ K x 10⁶ Temp. _____ °F Date sampled _____

Taste, color, etc. _____

Well No. C16

Well No. C16

Latitude-longitude d m s d m s

HYDROGEOLOGIC CARD

UNITAS WATER CARD

Physiographic Province: _____

Section: 03

DEC 8 1953

Drainage Basin: 162 Subbasin: _____

Topo of well site: (D) depression, stream channel, dunes, flat, hilltop, sink, swamp, (E) offshore, pediment, hillside, terrace, undulating, valley flat

MAJOR AQUIFER: _____ system _____ series K3 _____ aquifer, formation, group C5

Lithology: US Origin: 6 Aquifer Thickness: _____ ft
Length of well open to: _____ ft Depth to top of: _____ ft

MINOR AQUIFER: _____ system _____ series _____ aquifer, formation, group _____

Lithology: _____ Origin: _____ Aquifer Thickness: _____ ft
Length of well open to: _____ ft Depth to top of: _____ ft

Intervals Screened: _____
Depth to consolidated rock: _____ ft Source of data: _____

Depth to basement: _____ ft Source of data: _____
Surficial material: _____ Infiltration characteristics: _____

Coefficient Trans: _____ gpd/ft _____ Coefficient Storage: _____

Coefficient Perm: _____ gpd/ft²; Spec cap: _____ gpm/ft; Number of geologic cards: _____

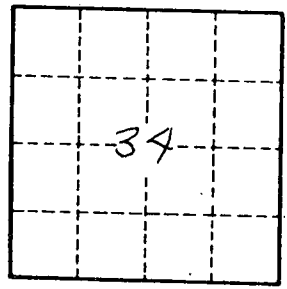
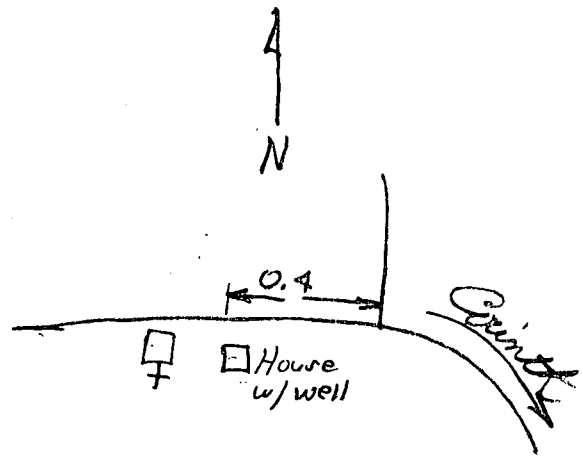

Well No.

C16