

WELL SCHEDULE

U. S. DEPT. OF THE INTERIOR

GEOLOGICAL SURVEY

WATER RESOURCES DIVISION

PUNCHED DEC 28 1972

MASTER CARD

Record by Dalvin B. E. Ellison Source of data J.F. Crum, owner Date 11-14-61 Map

State 2 P County (or town) alcorn 0 2

Latitude: 34 58 31 W Longitude: 0 8 53 6 51 Sequential number: 1

Lat-long accuracy: 3 T 1 S 6 R 25 W, Sec 25, NE, NE

Local well number: B 0 0 7 A A 2 5 0 1 S 0 6 E Other number: B & M

Local use: \_\_\_\_\_ Owner or name: J F CRUM Address: Courtly Miss

Ownership: County, Fed Gov't, City, Corp or Co, Private, State Agency, Water Dist P

Use of water: (A) Air cond, Bottling, Comm, Dewater, Power, Fire, (F) Dom, Irr, Med, Ind, P S, Rec, (I) (M) (N) (P) (R)

(S) Stock, (T) Instatit, (U) Unused, (V) Recharge, (W) Desal-P S, (X) Desal-other, (Z) Other H

Use of well: (A) Anode, (D) Drain, (G) Seismic, (H) Heat Res, (P) Obs, (R) Oil-gas, (T) Recharge, (U) Test, (W) Unused, (X) Withdraw, (Z) Waste, Destroyed. W

DATA AVAILABLE: Well data  Freq. W/L meas.: \_\_\_\_\_ Field aquifer char.

Hyd. lab. data: \_\_\_\_\_

Qual. water data; type: \_\_\_\_\_

Freq. sampling: \_\_\_\_\_ Pumpage inventory:  yes, no, period: \_\_\_\_\_

Aperture cards: \_\_\_\_\_ yes

Log data: \_\_\_\_\_

WELL-DESCRIPTION CARD

SAME AS ON MASTER CARD Depth well: \_\_\_\_\_ ft 300 Meas. rept accuracy 6

Depth cased: \_\_\_\_\_ ft Casing type: \_\_\_\_\_; Diam. in 4

Finish: (C) porous concrete, (F) gravel w. (perf.), (G) gravel w. (screen), (H) horiz. gallery, (P) open end, (S) perf., (T) screen, (W) sd. pt., (X) shored, (Z) open hole, other X

Method Drilled: (A) air rot., (B) bored, (C) cable, (D) dug, (H) hyd jetted, (J) air rot., (P) air percussion, (R) reverse, (T) trenching, (V) driven, (W) drive wash, (Z) other H

Date Drilled: 9 5 1 Pump intake setting: \_\_\_\_\_ ft

Driller: O. P. Norvell, Rt. 1, Winnesoga, Miss.

Lift (type): (A) air, (B) bucket, (C) cent, (J) jet, (L) multiple, (M) multiple, (N) none, (P) piston, (R) rot, (S) submerg, (T) turb, (Z) other P Deep  Shallow

Power (type): (nat) diesel, elec, gas, gasoline, hand, gas, wind; (LP) H.P. 1 Trans. or meter no. \_\_\_\_\_

Descrip. MP \_\_\_\_\_ ft above below LSD, Alt. MP \_\_\_\_\_

Alt. LSD: \_\_\_\_\_ Accuracy: \_\_\_\_\_ 7 6 0 5

Water Level \_\_\_\_\_ ft above below MP; Ft below LSD \_\_\_\_\_ Accuracy: \_\_\_\_\_

Date meas: \_\_\_\_\_ Yield: \_\_\_\_\_ gpm Method determined \_\_\_\_\_

Drawdown: \_\_\_\_\_ ft Accuracy: \_\_\_\_\_ Pumping period \_\_\_\_\_ hrs \_\_\_\_\_

QUALITY OF WATER DATA: Iron \_\_\_\_\_ Sulfate \_\_\_\_\_ Chloride \_\_\_\_\_ Hard. \_\_\_\_\_

Sp. Conduct \_\_\_\_\_ K x 10 \_\_\_\_\_ Temp. \_\_\_\_\_ °F Date sampled \_\_\_\_\_

Taste, color, etc. good

Well No. B7

Well No. B7

Latitude-longitude \_\_\_\_\_  
d m s d m s

HYDROGEOLOGIC CARD

03 162

Physiographic Province: \_\_\_\_\_

03 Section: \_\_\_\_\_

STE 8 S 3 E 0

Drainage Basin: \_\_\_\_\_

162 Subbasin: \_\_\_\_\_

Topo of well site: (D) depression, stream channel, dunes, flat, hilltop, sink, swamp, (P) offshore, pediment, hillside, terrace, undulating, valley flat

MAJOR AQUIFER: \_\_\_\_\_

system \_\_\_\_\_

series \_\_\_\_\_

H3

aquifer, formation, group \_\_\_\_\_

CJ

Lithology: \_\_\_\_\_

U.S.

Origin: \_\_\_\_\_

6

Aquifer Thickness: \_\_\_\_\_

ft \_\_\_\_\_

Length of well open to: \_\_\_\_\_ ft \_\_\_\_\_

Depth to top of: \_\_\_\_\_ ft \_\_\_\_\_

MINOR AQUIFER: \_\_\_\_\_

system \_\_\_\_\_

series \_\_\_\_\_

aquifer, formation, group \_\_\_\_\_

Lithology: \_\_\_\_\_

\_\_\_\_\_

Origin: \_\_\_\_\_

\_\_\_\_\_

Aquifer Thickness: \_\_\_\_\_

ft \_\_\_\_\_

Length of well open to: \_\_\_\_\_ ft \_\_\_\_\_

Depth to top of: \_\_\_\_\_ ft \_\_\_\_\_

Intervals Screened: \_\_\_\_\_

Depth to consolidated rock: \_\_\_\_\_ ft \_\_\_\_\_

ft \_\_\_\_\_

Source of data: \_\_\_\_\_

Depth to basement: \_\_\_\_\_ ft \_\_\_\_\_

ft \_\_\_\_\_

Source of data: \_\_\_\_\_

Surficial material: \_\_\_\_\_

Infiltration characteristics: \_\_\_\_\_

Coefficient Trans: \_\_\_\_\_

gpd/ft \_\_\_\_\_

Coefficient Storage: \_\_\_\_\_

Coefficient Perm: \_\_\_\_\_

gpd/ft<sup>2</sup>; Spec cap: \_\_\_\_\_

gpm/ft; Number of geologic cards: \_\_\_\_\_

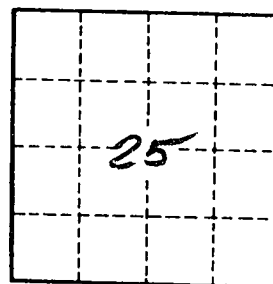
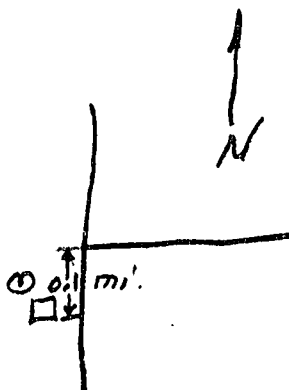

Well No. \_\_\_\_\_

B7