

WELL SCHEDULE

U. S. DEPT. OF THE INTERIOR

GEOLOGICAL SURVEY

WATER RESOURCES DIVISION

PUNCHED and VERIFIED  
ROLLA COMPUTATION BRANCH

MASTER CARD

Record by Hutt Source of data Tenant Date 10/56 Map KOSSUTH N

State 28 County (or town) Alcorn 02

Latitude: 34574.3N Longitude: 088380.9 Sequential number: 1

Lat-long accuracy: 20 T 1 N 60 W, Sec 26, SW t, SE t

Local well number: B0030D2601506E Other number: B & M

Local use: \_\_\_\_\_ Owner or name: B C TAYLOR Address: \_\_\_\_\_

Ownership: County, Fed Gov't, City, Corp or Co, Private, State Agency, Water Dist P

Use of water: (A) Air cond, (B) Bottling, (C) Comm, (D) Dewater, (E) Power, (F) Fire, (G) Dom, (H) Irr, (I) Med, (J) P S, (K) Rec, (L) Stock, (M) Instit, (N) Unused, (O) Reppure, (P) Recharge, (Q) Desal-P S, (R) Desal-other, (S) Other H

Use of well: (A) Anode, (B) Drain, (C) Seismic, (D) Heat Res, (E) Obs, (F) Oil-gas, (G) Recharge, (H) Test, (I) Unused, (J) Withdraw, (K) Waste, (L) Destroyed W

DATA AVAILABLE: Well data 1 Freq. W/L meas: 1 Field aquifer char. 1

Hyd. lab. data: \_\_\_\_\_

Qual. water data; type: USGS 10/56

Freq. sampling: \_\_\_\_\_ Pumpage inventory: \_\_\_\_\_

Aperture cards: \_\_\_\_\_

Log data: \_\_\_\_\_

WELL-DESCRIPTION CARD

SAME AS ON MASTER CARD Depth well: 300 ft Meas. rept accuracy 6

Depth cased; (first perf.) \_\_\_\_\_ ft Casing type: \_\_\_\_\_; Diam. \_\_\_\_\_ in

Finish: porous concrete, gravel w. (perf.), (screen), (horiz. gallery), (open end), (shored), (open hole), (other) X

Method Drilled: (A) air bored, (B) cable, (C) dug, (D) hyd jetted, (E) air rot., (F) percussion, (G) rotary, (H) reverse, (I) trenching, (J) driven, (K) wash, (L) drive wash, (M) other H

Date Drilled: 9-2-6 Pump intake setting: \_\_\_\_\_ ft

Driller: H B PRIDDY name address \_\_\_\_\_

Lift (type): (A) air, (B) bucket, (C) cent, (D) jet, (E) multiple, (F) multiple, (G) none, (H) piston, (I) rot, (J) submerg, (K) turb, (L) other N Deep 1 Shallow 0

Power (type): (A) diesel, (B) elec, (C) gas, (D) gasoline, (E) hand, (F) gas, (G) wind, (H) H.P., (I) Trans. or meter no. 1

Descrip. MP 392' (10/89) ft above below LSD, Alt. MP \_\_\_\_\_

Alt. LSD: 400 Accuracy: T

Water Level \_\_\_\_\_ ft above below MP; \_\_\_\_\_ ft above below LSD +4 Accuracy: \_\_\_\_\_

Date meas: 056 Yield: flows gpm 4 Method determined \_\_\_\_\_

Drawdown: \_\_\_\_\_ ft Accuracy: \_\_\_\_\_ Pumping period \_\_\_\_\_ hrs \_\_\_\_\_

QUALITY OF WATER DATA: Iron \_\_\_\_\_ ppm Sulfate \_\_\_\_\_ ppm Chloride \_\_\_\_\_ ppm Hard. \_\_\_\_\_ ppm

Sp. Conduct \_\_\_\_\_ K x 10<sup>6</sup> Temp. 63 Date sampled 056

Taste, color, etc. \_\_\_\_\_

Well No. \_\_\_\_\_

Latitude-longitude \_\_\_\_\_  
d m s N S d m s

**HYDROGEOLOGIC CARD**

**SAME AS ON MASTER CARD** Physiographic Province: 03 Section: \_\_\_\_\_

D Drainage Basin: 167 Subbasin: \_\_\_\_\_

Topo of well site: (D) depression, stream channel, dunes, flat, hilltop, sink, swamp, (E) (F) (H) (K) (L) (P) (S) (T) (U) (V) offshore, pediment, hillside, terrace, undulating, valley flat \_\_\_\_\_

MAJOR AQUIFER: system \_\_\_\_\_ series K3 aquifer, formation, group CS

Lithology: \_\_\_\_\_ Origin: 6 Aquifer Thickness: \_\_\_\_\_ ft  
Length of well open to: \_\_\_\_\_ ft Depth to top of: \_\_\_\_\_ ft

MINOR AQUIFER: system \_\_\_\_\_ series \_\_\_\_\_ aquifer, formation, group \_\_\_\_\_

Lithology: \_\_\_\_\_ Origin: \_\_\_\_\_ Aquifer Thickness: \_\_\_\_\_ ft  
Length of well open to: \_\_\_\_\_ ft Depth to top of: \_\_\_\_\_ ft

Intervals Screened: \_\_\_\_\_

Depth to consolidated rock: \_\_\_\_\_ ft Source of data: \_\_\_\_\_

Depth to basement: \_\_\_\_\_ ft Source of data: \_\_\_\_\_

Surficial material: \_\_\_\_\_ Infiltration characteristics: \_\_\_\_\_

Coefficient Trans: \_\_\_\_\_ gpd/ft Coefficient Storage: \_\_\_\_\_

Coefficient Perm: \_\_\_\_\_ gpd/ft<sup>2</sup>; Spec cap: \_\_\_\_\_ gpm/ft; Number of geologic cards: \_\_\_\_\_

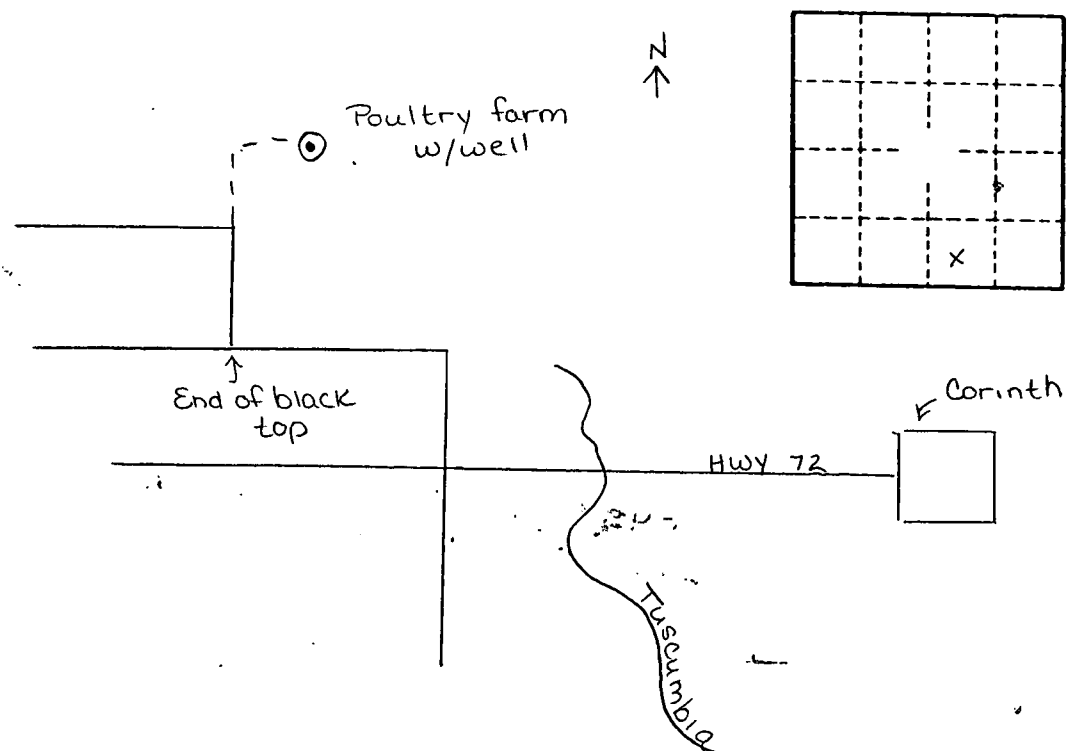

No distances noted on original sketch