

WELL SCHEDULE

U. S. DEPT. OF THE INTERIOR

GEOLOGICAL SURVEY

WATER RESOURCES DIVISION

PUNCHED

DEC 28 1972

MASTER CARD

Record by Daly/H.H. Source of data owner Date 10-2-52 Map KOSSUTH N

State 28 County Alcorn 02

Latitude: 33 53 22 11 N Longitude: 09 38 52 Sequential number: 1

Lat-long accuracy: 3 T 1 S R 6 W Sec 27 SE 1 NE 1 NE

Local well number: B002A42701S06E Other number: B & M

Local use: \_\_\_\_\_ Owner or name: C. B. LUKER Address: Corinth Bt. 1

Ownership: (C) County, (F) Fed Gov't, (M) City, Corp or Co, (N) Private, (P) State Agency, (W) Water Dist P

Use of water: (A) Air cond, (B) Bottling, (C) Comm, (D) Dewater, (E) Power, (F) Fire, (H) Dom, (I) Irr, (M) Med, (N) Ind, (P) P S, (R) Rec, (S) Stock, (T) Inatit, (U) Unused, (V) Repressure, (W) Recharge, (X) Desal-P S, (Y) Desal-other, (Z) Other H

Use of well: (A) Anode, (D) Drain, (G) Seismic, (H) Heat Res, (O) Obs, (P) Oil-gas, (R) Recharge, (T) Test, (U) Unused, (W) Withdraw, (X) Waste, (Z) Destroyed W

DATA AVAILABLE: Well data  Freq. W/L meas.:  Field aquifer char.

Hyd. lab. data: \_\_\_\_\_

Qual. water data; type: \_\_\_\_\_

Freq. sampling: \_\_\_\_\_ Pumpage inventory:  yes  no; period: \_\_\_\_\_

Aperture cards: \_\_\_\_\_ yes

Log data: \_\_\_\_\_

WELL-DESCRIPTION CARD

SAME AS ON MASTER CARD Depth well: 338 ft Meas. 0 reft accuracy \_\_\_\_\_

Depth cased: (first perf.) 40 ft Casing type: \_\_\_\_\_; Diam. 4 in

Finish: (C) porous concrete, (F) gravel w. (perf.), (G) gravel w. (screen), (H) horiz. gallery, (O) open end, (P) perf., (S) screen, (T) sd. pt., (W) shored, (X) open hole, (Z) other O

Method: (A) air bored, (B) cable, (C) dug, (D) hyd rot., (H) jetted, (J) air rot., (P) percussion, (R) rotary, (T) reverse, (V) trenching, (W) driven, (Z) other H

Date Drilled: 9-5-50 Pump intake setting: \_\_\_\_\_ ft

Driller: Norvell Drilling Co. address Corinth

Lift (type): (A) air, (B) bucket, (C) cent., (J) jet, (L) multiple, (M) multiple, (N) none, (P) piston, (R) rot., (S) submerg, (T) turb., (Z) other J Deep  Shallow

Power (type): elec nat gas, gasoline, hand, gas, wind; H.P. 1/2 Trans. or meter no. 5

Descrip. MP 392 (10/89) ft above below LSD, Alt. MP \_\_\_\_\_

Alt. LSD: 390 Accuracy: (source) 6

Water Level: \_\_\_\_\_ ft above below MP; Ft below LSD \_\_\_\_\_ Accuracy: \_\_\_\_\_

Date meas: \_\_\_\_\_ Yield: \_\_\_\_\_ gpm Method determined \_\_\_\_\_

Drawdown: \_\_\_\_\_ ft Accuracy: \_\_\_\_\_ Pumping period \_\_\_\_\_ hrs

QUALITY OF WATER DATA: Iron \_\_\_\_\_ ppm Sulfate \_\_\_\_\_ ppm Chloride \_\_\_\_\_ Hard. \_\_\_\_\_

Sp. Conduct \_\_\_\_\_ K x 10 6 Temp. \_\_\_\_\_ °F Date sampled \_\_\_\_\_

Taste, color, etc. \_\_\_\_\_

Well No.

B2

Well No. B2

Latitude-longitude \_\_\_\_\_  
d m s N S d m s

HYDROLOGIC CARD  
BASED ON MASTER CARD

Physiographic Province: \_\_\_\_\_ Section: 03

Drainage Basin: 161 Subbasin: \_\_\_\_\_

Topo of well site: (D) depression, stream channel, dunes, flat, hilltop, sink, swamp, offshore, pediment, hillside, terrace, undulating, valley flat \_\_\_\_\_

MAJOR AQUIFER: \_\_\_\_\_ system \_\_\_\_\_ series K3 \_\_\_\_\_ aquifer, formation, group C3

Lithology: \_\_\_\_\_ Origin: 6 Aquifer Thickness: \_\_\_\_\_ ft  
Length of well open to: \_\_\_\_\_ ft Depth to top of: \_\_\_\_\_ ft

MINOR AQUIFER: \_\_\_\_\_ system \_\_\_\_\_ series \_\_\_\_\_ aquifer, formation, group \_\_\_\_\_

Lithology: \_\_\_\_\_ Origin: \_\_\_\_\_ Aquifer Thickness: \_\_\_\_\_ ft  
Length of well open to: \_\_\_\_\_ ft Depth to top of: \_\_\_\_\_ ft

Intervals Screened: \_\_\_\_\_

Depth to consolidated rock: \_\_\_\_\_ ft Source of data: \_\_\_\_\_

Depth to basement: \_\_\_\_\_ ft Source of data: \_\_\_\_\_

Surficial material: \_\_\_\_\_ Infiltration characteristics: \_\_\_\_\_

Coefficient Trans: \_\_\_\_\_ gpd/ft \_\_\_\_\_ Coefficient Storage: \_\_\_\_\_

Coefficient Perm: \_\_\_\_\_ gpd/ft<sup>2</sup>; Spec cap: \_\_\_\_\_ gpm/ft; Number of geologic cards: \_\_\_\_\_

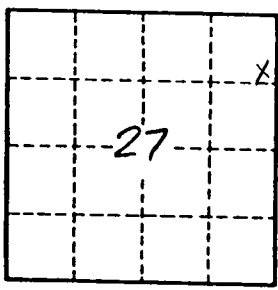
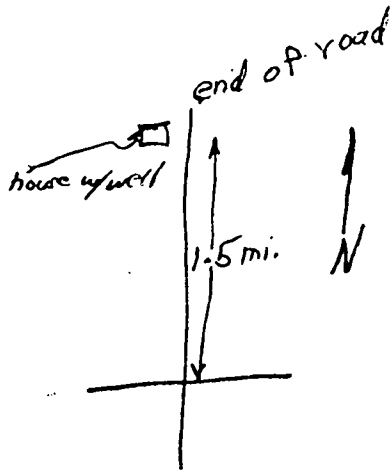

Well No.

B2