

Coded By Q 2195  
 Checked By 92404-24-95  
 Entered By 297  
 Date 7/95

U.S. GEOLOGICAL SURVEY  
 WATER RESOURCES DIVISION  
 MISSISSIPPI DISTRICT

Well No. 2105  
 E-Log No. \_\_\_\_\_  
 County ADAMS  
 Agency \_\_\_\_\_

WELL RECORD

Agency Code U1S1GIS Site Id 131131131019112633011 Project No. 5  
 Station Name 12 K 1405 INT PAPER CO Latitude 9 31 131 131 Longitude 10 09 126 131  
 Land Net Irregular  
 Land Long Ac. 11 5 57 4 Disc 6 23 State 7 28 County 9 001 Land Net 13 15 51 55 11 17 11 R 13 11 2  
 Location Map 14 NATCHEZ Altitude 16 74 Mec/Meas 17 A U Accuracy 18 15 Hydraulic Unit 20 018106111001

Agency Use 803 A 10 Date Invented 7 11 Station Type 4 Data Type 804  
 Instru. 905 Remarks \_\_\_\_\_ Relia. 3 C L M U 2 X

Date of Construction 21 08 / 31 / 1994 Well Use 23 W Water Use 24 N Primary Aquifer 714 1 2 M R V A Hole Depth 27 1455  
 Well Depth 29 150 Water Level 30 Water Level Date 31 Method 34 Status 37 Source 33

CONSTRUCTION DATA  
 Construction Date 60 08 / 31 / 1994 Contractor 63 01 61 4 Name LAYNE Method 65 H Finish 66 0

CONSTRUCTION CASING DATA  
 Top/Casing 77 10 Bot/Casing 78 10 Diameter 79 20  
 Top/Casing 77 Bot/Casing 78 Diameter 79

CONSTRUCTION OPENINGS DATA  
 Top/Depth 83 10 Bot/Depth 84 150 Diameter 87 20 Type 85 S Length 89 Width 88 10 46  
 Top/Depth 83 Bot/Depth 84 Diameter 87 Type 85 Length 89 Width 88

CONSTRUCTION LIFT DATA  
 R=42 T=A 254#1 Life Type 43 T Date 38 08 / 31 / 1994 Intake 44 1110  
 Power 45 6 H.P. 46 2000 Serial No. 49

MISCELLANEOUS OWNER DATA  
 Date of Ownership 159 08 / 31 / 1994 Owner Name 161 INT PAPER CO

MISCELLANEOUS OTHER ID DATA  
 E-Log No. 190 Assigner 191 M I S S I S S I P P I

MISCELLANEOUS QW DATA

R=192	T=A	738#1	Date of Measurement 1934 / /	Aquifer Sampled 1954 / /	Temp 196#00010	Value 1974 / / /
R=192	T=A	738#2	Date of Measurement 1934 / /	Aquifer Sampled 1954 / /	So Cond 196#00095	Value 1974 / / /
R=192	T=A	738#3	Date of Measurement 1934 / /	Aquifer Sampled 1954 / /	pH 196#00100	Value 1974 / / /

MISCELLANEOUS LOGS DATA

R=199	T=A	739#1	Log Type 199#1	Sec. Depth 200# / 10#	End Depth 201# / 156#
R=199	T=A	739#1	Log Type 199#1	Sec. Depth 200# / / /	End Depth 201# / / /

MISCELLANEOUS NETWORK DATA 706 = Qw WL WD \*

R=114	T=A	730#1	Sec. Year 115# / / /	End Year 116# / / /	Agency Source 120=A	Freq. 117# / / /	118# /
R=121	T=A	730#2	Sec. Year 115# / / /	End Year 116# / / /	Agency Source 117# / / /	Freq. 118# /	

MISCELLANEOUS REMARKS DATA

R=183	T=A	311#1	Date of Remarks 184# / / / / /	Remarks 185#
-------	-----	-------	-----------------------------------	-----------------

DISCHARGE DATA

R=146	T=A	Pump/ Flow	147#1	Date 148# 08 / 31 / 1994	Type 703# P A	Discharge 150# / 1332#	So. Capacity 272# / / / /
-------	-----	---------------	-------	-----------------------------	------------------	---------------------------	------------------------------

GEOHYDROLOGIC DATA

R=90	T=A	721#1	Depth Top 91# / / / /	Depth Bot. 92# / / / /	Unit Id 93# / 1212121212	304#
------	-----	-------	--------------------------	---------------------------	-----------------------------	------

HYDRAULIC DATA

R=98	T=A	790#1	Unit Tested 100# / / / / /	103# /
------	-----	-------	-------------------------------	--------

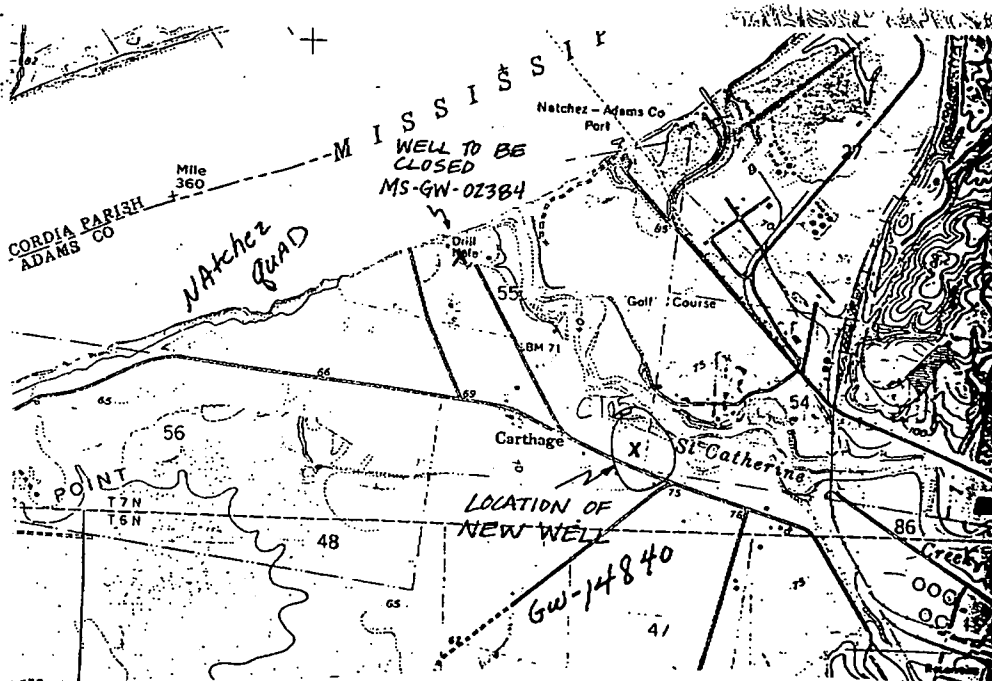

DESCRIPTION OF FORMATIONS ENCOUNTERED	FROM	TO
Brown Clay	0	20
Blue Clay	20	60
Sand & Clay	60	105
Sand & Gravel	105	150
Clay	150	155

26' d d 2 hr.  
(51 gpm / Ft)