

No driller's log

Not permitted

FORM 9-1642 (1-68)

Well No. C19

WELL SCHEDULE

E log # 827

U. S. DEPT. OF THE INTERIOR

GEOLOGICAL SURVEY

WATER RESOURCES DIVISION

Skerrill Allen - mg 1. 4420201 10/9/81

MASTER CARD

Record by JAC Source of data Obs Date 6/61 Map Natchez  
 State 52 28 County (or town) Adams 605 01  
 Latitude: 313144N Longitude: 0912547 Sequential number: 1  
 Lat-long accuracy: 2 70 30 2 54 19 degrees 15 min sec 19  
 Local well number: C019 C27 03N 03W Other number: 86H

Local use: 060 Owner or name: Bastech, Inc.  
 Owner or name: NATCHEZ PART Address: Linwood  
 Ownership: County, Fed Gov't, City, Corp or Co, Private, State Agency, Water Dist. N  
 Use of Air'cond, Bottling, Comm, Devstator, Power, Fire, Dom, Irr, Mad, Ind, P S, Rec, Stock, Instit, Unused, Repressure, Recharge, Desal-P S, Desal-other, Other

Use of well: (A) (D) (G) (H) (I) (J) (K) (L) (M) (N) (P) (R) (S) (T) (U) (V) (W) (X) (Y) (Z)  
 Anode, Drain, Seismic, Heat Res, Obs, Oil-gas, Recharge, Test, Unused, Withdraw, Waste, Destroyed.  
 DATA AVAILABLE: Well data  Freq. W/L meas.:  Field aquifer char:   
 Hyd. Lab. data:   
 Qual. water data: type: USGS   
 Freq. sampling:  Pumpage inventory:  yes  no  period:

Aperture cards:  yes  no   
 Log data: E log 20-435'  E

WELL-DESCRIPTION CARD

SAME AS ON MASTER CARD Depth well: 507 ft Meas. 3  
 Depth cased: 487 ft Casing type: 10 in; Diam. 10 in  
 Finish: porous gravel v. gravel v. horiz. open (P) (S) (T) (W) (X) (Z) (screen), gallery, and, other 3  
 Method: (A) (B) (C) (D) (H) (J) (K) (L) (M) (N) (P) (R) (S) (T) (U) (V) (W) (X) (Y) (Z) drilled: air bored, cable, dug, hyd jetted, air reverse trenching, driven, drive rot, rot., percussion, rotary, other 4  
 Date Drilled: 6/61 961 Pump intake setting: 10 ft

Driller: 10/9/81  
 Lift (type): (A) (B) (C) (J) multiple, multiple, (N) (P) (R) (S) (T) (Z) air, bucket, cent, jet, (cent.) (turb.) none, piston, rot, submerg, turb, other  Deep  Shallow 40  
 Power (type): diesel, elec, gas, gasoline, hand, gas, wind; H.P.  Trans. or meter no.

Descrip. MP top of 6" at 210' 78 ft above LSD, Alt. MP 78  
 Alt. LSD: 1000 Accuracy: 75 10/9/81 5  
 Water Level: 62 ft below MP; Ft below LSD Accuracy: 4  
 Date meas: 861 Yield: 861 gpm Method determined: 41

Drawdown: 62 ft Accuracy: 63 Pumping period: 46 hrs 48  
 QUALITY OF WATER DATA: Iron 661 ppm Sulfate 71 ppm Chloride 71 ppm Hard. 72  
 Sp. Conduct 71 K x 10<sup>6</sup> Temp. 71 °F Date sampled 661  
 Taste, color, etc. 2

I think this is Miss. River Corp., Inc. other wells permitted

PUNCHED and VERIFIED ROLLA COM-P-UTATION BRANCH

David Smith AL Engr. 445-24

10/9/81 102 928 92.72 210 90.72

HYDROGEOLOGIC CARD

SAME AS ON MASTER CARD

Physiographic Province:

03

Section:

D

Drainage Basin:

154

Subbasin:

Topo of well site: (D) depression, stream channel, dunes, flat, hilltop, sink, swamp, (C) (E) (F) (H) (K) (L) (P) (S) (T) (U) (V) offshore, pediment, hillside, terrace, undulating, valley flat

MAJOR AQUIFER:

T.M

M.Z

Lithology:

US

Origin:

3

Aquifer Thickness:

Length of well open to:

Depth to top of:

MINOR AQUIFER:

Lithology:

Origin:

Aquifer Thickness:

Length of well open to:

Depth to top of:

Intervals Screened:

Depth to consolidated rock:

Source of data:

Depth to basement:

Source of data:

Surficial material:

Infiltration characteristics:

Coefficient Trans:

gpd/ft.

Coefficient Storage:

Coefficient Perm:

gpd/ft. ; Spec cap:

gpm/ft. ; Number of geologic cards:

See C 45 for sketch

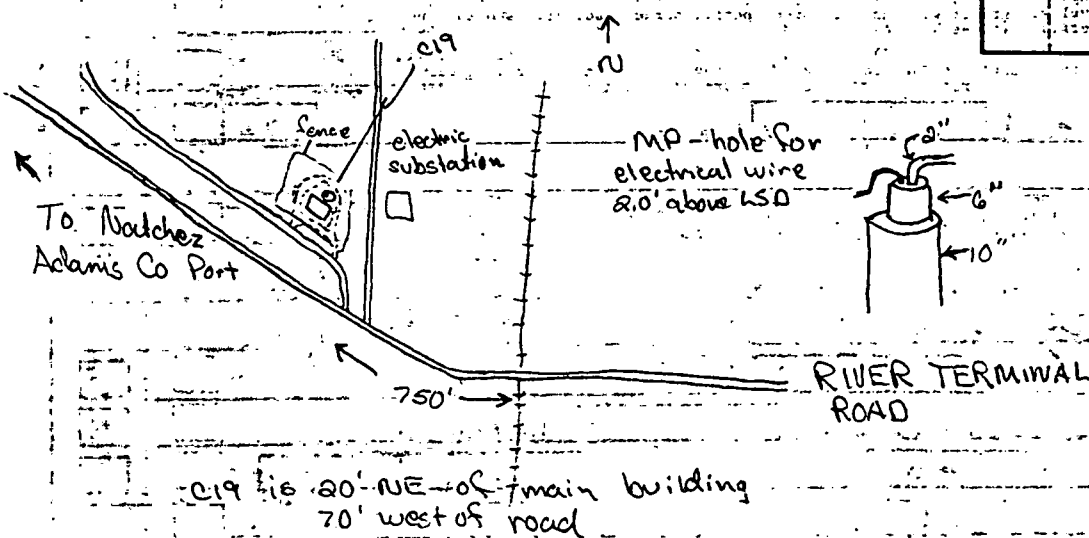
Base alluvium 132' Clay sand breaks to 300'