

Part 2 never received 4/13

TFU 31-2#6 elev 365

### State Well Report Part 1

County: Yazoo  
 Permit #: \_\_\_\_\_  
 Driller: John W Thompson  
 Date drilling completed: 11-3-11

Mississippi Department of Environmental Quality  
 Office of Land and Water Resources  
 P.O. Box 10631  
 Jackson, MS 39289-0631  
 (601)961-5210  
 (601)354-6938 (fax)

For Office Use Only:  
 Aquifer: R 78  
 Well #: \_\_\_\_\_  
 L. S. Elevation: \_\_\_\_\_  
 E-log #: \_\_\_\_\_

State Law requires that this report be prepared by the driller in detail and filed with the Department within 30 days of completion of drilling of the well.

Well Owner Information	Well Location
Owner Name: <u>Denbury Onshore</u>	Latitude: <u>32.40.30.3"</u> Longitude: <u>90.26.25"</u>
Mailing Address: <u>500 Central Ave</u> <u>Laurel MS 39440</u>	Method of Lat/Long (circle one): Conventional Survey, USGS quad, Hand-held GPS, Survey-grade GPS
City: _____ State: _____ Zip Code: _____	NW <input checked="" type="checkbox"/> NE <input checked="" type="checkbox"/> Sec. <u>31</u> ✓ Twn <u>9N</u> ✓ Rng <u>2W</u> ✓
Telephone No. ( ) _____	Distance: <u>4</u> Miles Direction: <u>NW</u> of Nearest Town: <u>Bantonla</u>

**Well Data**

Purpose of Well (circle one) Home Industrial Public Supply Irrigation Fish Culture Other: rig supply

Date well drilling started: 10-28-11 Date well drilling completed: 11-3-11

If flowing, method of flow regulation: Valve \_\_\_\_\_ Other (describe) \_\_\_\_\_

Static Water Level: 231 feet above or (below) (circle one) land surface Date measured: 11-3-11

Method of Measurement (circle one) steel tape electric tape air line other: \_\_\_\_\_

Hole depth: 603 Well depth: 580 Well grouted to a depth of 0 feet

Type of grout (circle one): Cement Bentonite Mix

Casing length: 520 feet Casing diameter: 4 inches Type of casing: PVC

Screen length: 60 feet Screen diameter: 4 inches Type of screen: PVC Slotted

Screen slot size: .008 inches Setting depth: From 520 feet to 580 feet

Type of completion (circle all applicable): Gravel packed Underreamed Telescoped Open hole Natural Development

Other (describe): \_\_\_\_\_

Top of lap pipe or reduction in casing: \_\_\_\_\_ feet. If telescoped or more than one screen, describe on back of page

Logs run (circle all applicable): No log run Electric Gamma Ray Density Sonic Neutron Other: \_\_\_\_\_

Name of organization running log(s): \_\_\_\_\_

I certify that the well was drilled, constructed, and completed in accordance with all applicable requirements of the Mississippi Department of Environmental Quality and/or the Mississippi Department of Health regulations and state laws.

John W Thompson 0-679  
 Print Name of Water Well Contractor and License No.

John W Thompson  
 Signature of Water Well Contractor

RECEIVED  
 NOV 03 2011  
 BY: OLWR

R78

If well telescopes please sketch below and show depths

Ground Level

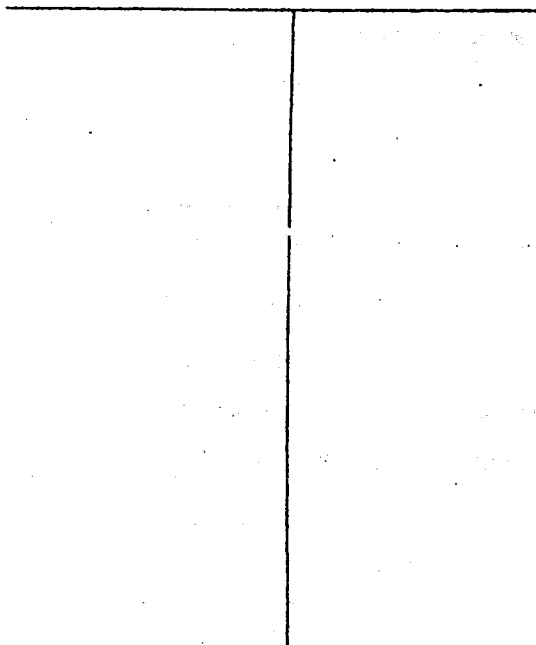

Description of Formations Encountered	From	To
Clay	0	50
Sand + gravel	50	95
Blue Clay	95	300
Soft clay + sand strips	300	480
Sand	480	580
sand + clay	580	603

If more than one screen, show location of each on sketch

Sketch the property layout and include the following: 1) the well location; 2) any permanent structures on the property that may aid in locating the well; 3) any roads, power lines, or other items that may aid in locating the property and the well; 4) indicate direction.

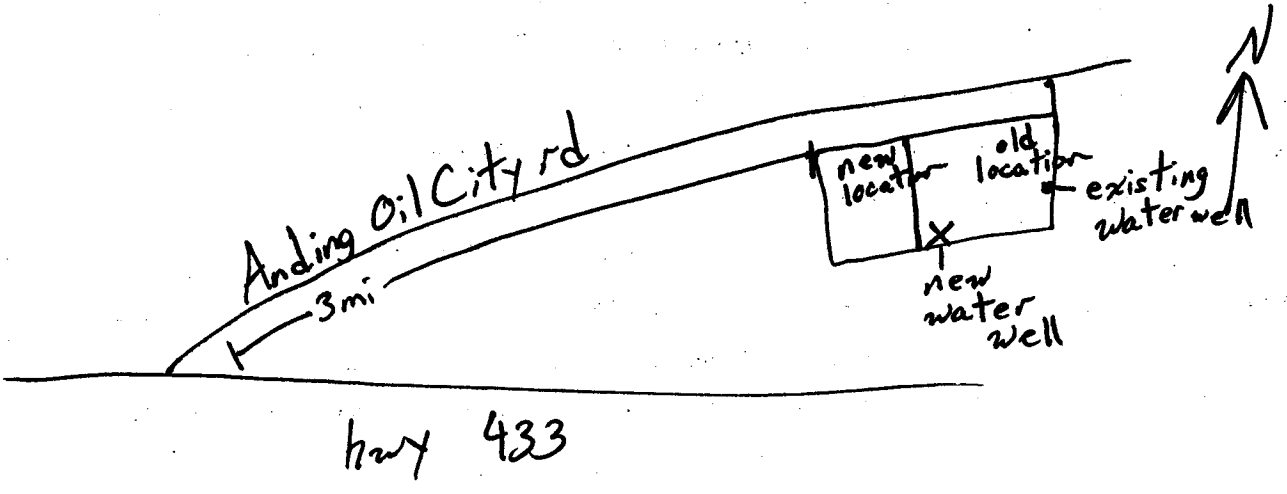

Landowner Name: Denbury Onshore

John W. Thompson  
Signature of Water Well Contractor