

TH-1 31-10 + 31-7

### State Well Report Part 1

County: Yazoo  
 Permit #: \_\_\_\_\_  
 Driller: John W Thompson  
 Date drilling completed: 12-30-10

Mississippi Department of Environmental Quality  
 Office of Land and Water Resources  
 P.O. Box 10631  
 Jackson, MS 39289-0631  
 (601)961-5210  
 (601)354-6938 (fax)

For Office Use Only:  
 Aquifer: P-65  
 Well #: \_\_\_\_\_  
 L. S. Elevation: \_\_\_\_\_  
 E-log #: \_\_\_\_\_

State Law requires that this report be prepared by the driller in detail and filed with the Department within 30 days of completion of drilling of the well.

Well Owner Information	Well Location
Owner Name: <u>Denbury Onshore</u>	Latitude: <u>32.40.13</u> Longitude: <u>90.26.2.6</u>
Mailing Address: <u>P.O. Box 6506</u> <u>Laurel MS</u>	Method of Lat/Long (circle one): <u>Conventional Survey</u> , USGS quad, <u>hand-held GPS</u> , Survey-grade GPS
City: _____ State: _____ Zip Code: _____	<u>NW 1/4 52 1/4 Sec 31 Twn 10N Rng 3W</u>
Telephone No. ( ) _____	Distance: <u>1</u> Miles Direction: <u>S</u> of Nearest Town: <u>0.1 City</u>

**Well Data**

Purpose of Well (circle one) Home Industrial Public Supply Irrigation Fish Culture Other: rig supply

Date well drilling started: 12-27-10 Date well drilling completed: 12-30-10

If flowing, method of flow regulation: Valve \_\_\_\_\_ Other (describe) \_\_\_\_\_

Static Water Level: 237 feet above or below (circle one) land surface Date measured: 12-30-10

Method of Measurement (circle one) steel tape electric tape air line other: \_\_\_\_\_

Hole depth: 620 Well depth: 600 Well grouted to a depth of 10 feet

Type of grout (circle one): Cement Bentonite Mix

Casing length: 520 feet Casing diameter: 4 inches Type of casing: PVC

Screen length: 80 feet Screen diameter: 4 inches Type of screen: PVC Slotted

Screen slot size: 008 inches Setting depth: From 520 feet to 600 feet

Type of completion (circle all applicable): Gravel packed Underreamed Telescoped Open hole Natural Development

Other (describe): \_\_\_\_\_

Top of lap pipe or reduction in casing: \_\_\_\_\_ feet. If telescoped or more than one screen, describe on back of page

Logs run (circle all applicable): No log run Electric Gamma Ray Density Sonic Neutron Other: \_\_\_\_\_

Name of organization running log(s): \_\_\_\_\_

I certify that the well was drilled, constructed, and completed in accordance with all applicable requirements of the Mississippi Department of Environmental Quality and/or the Mississippi Department of Health regulations and state laws.

John W Thompson 0-679  
 Print Name of Water Well Contractor and License No.

John W Thompson  
 Signature of Water Well Contractor

RECEIVED  
 JAN 11 2011  
 BY: OLWR

If well telescopes please sketch below and show depths.

Ground Level \_\_\_\_\_

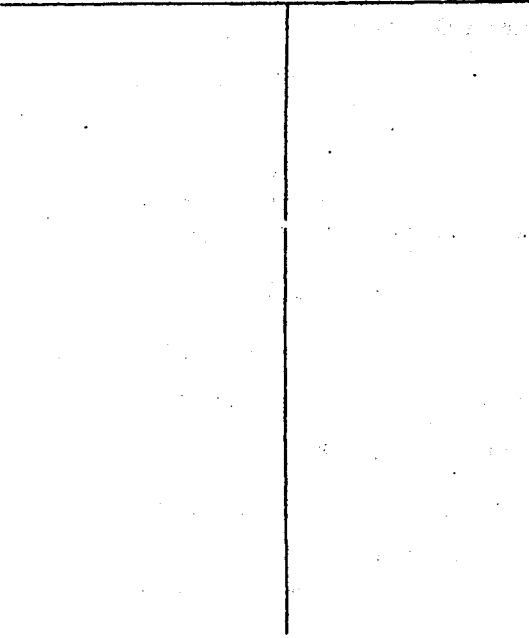

Description of Formations Encountered	From	To
Clay	0	50
sand & gravel	50	90
Blue clay	90	360
soft Clay	360	480
sand	480	600
Clay	600	620

More than one screen, show location of each on sketch

Sketch the property layout and include the following: 1) the well location; 2) any permanent structures on the property that may aid in locating the well; 3) any roads, power lines, or other items that may aid in locating the property and the well; 4) indicate direction.

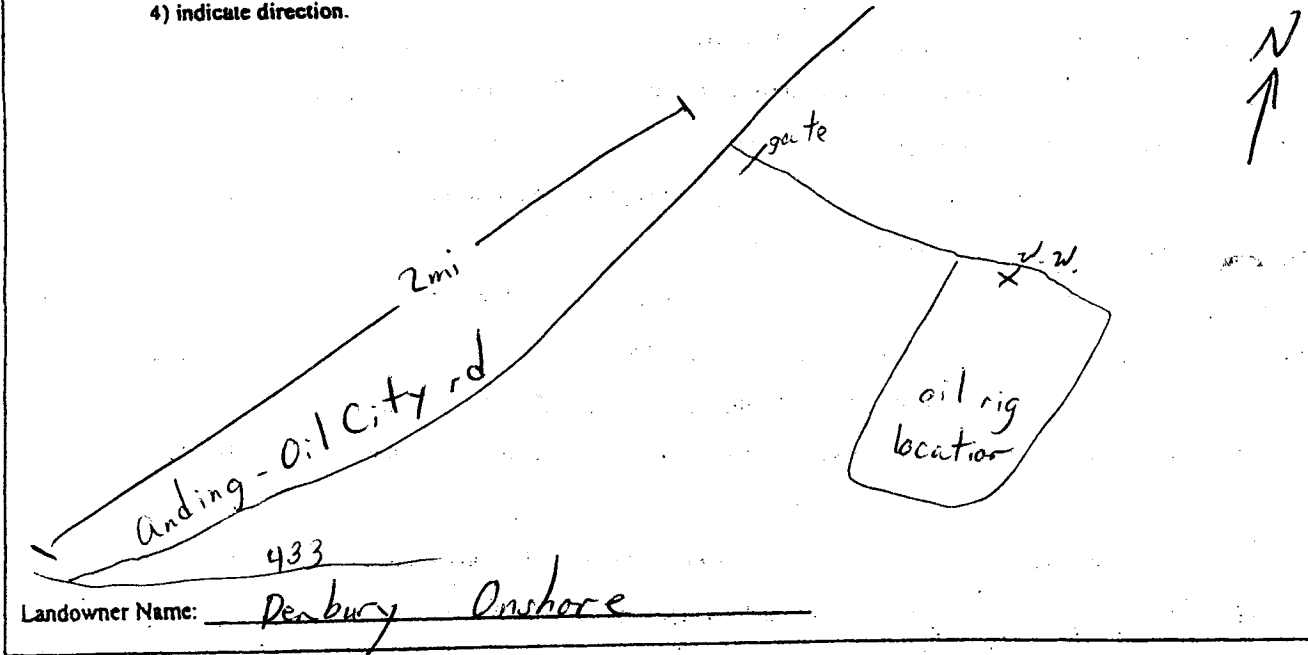

John W. Thompson  
Signature of Water Well Contractor

# STATE WELL REPORT

## Part 2

**Pump Installer's Completion Report**  
 Mississippi Department of Environmental Quality  
 Office of Land and Water Resources  
 P.O. Box 10631  
 Jackson, MS 39289-0631  
 (601)961-5210  
 (601)354-6938 (fax)

County: Yazoo  
 Permit #: \_\_\_\_\_  
 Driller: John W Thompson  
 Date completed: 12-30-10  
*Copy information from block on Part 1*

**For Office Use Only:**

Aquifer: \_\_\_\_\_  
 Well #: \_\_\_\_\_  
 Elevation: \_\_\_\_\_

*This part of the report must be completed by a licensed water well contractor or a licensed pump installer. A copy of Part 1 of the report must be attached and both parts filed with the Department at the above address within 30 days of well completion.*

Well Owner Information	Well Location
Owner Name: <u>Derbury Onshore</u>	Latitude: <u>32° 40' 13"</u> Longitude: <u>90° 26' 21.6"</u>
Mailing Address: <u>P.O. Box 6506</u> <u>Laurel MS</u>	Method of Lat/Long (check one): Conventional Survey _____ USGS quad <u>Hand-held GPS</u> , Survey-grade GPS _____
City _____ State _____ Zip Code _____	<u>1/4</u> _____ <u>1/4</u> Sec <u>31</u> T <u>10N</u> R <u>32W</u>
Telephone No. ( ) _____	Distance _____ Direction _____ Nearest Town <u>O.H. City</u>

Pump Type Circle one	Power Type Circle one
Air Lift _____ Jet _____ <u>Submersible</u>	Diesel Engine _____ Gasoline Engine _____ Natural Gas _____
Bucket _____ Piston _____ Turbine _____	<u>Electric Motor</u> _____ Hand _____ Tractor PTO _____
Centrifugal _____ Rotary _____ Flowing Well _____	Windmill _____ Other (specify): _____
Other (specify): _____	Horse Power Rating of Motor: <u>7.5</u>
Date Pump Installed: <u>12-30-10</u>	Setting Depth: <u>280</u> feet
Rated Pump Capacity: <u>55</u> Gallons Per Minute	Number of Stages: _____

Pump Test Data	Method of Measuring Water Level Circle one
Date Well Tested: <u>12-30-10</u>	<u>Air Line</u> _____ Electric Measuring Line _____ Steel Tape _____
Static Water Level (A): <u>237</u> Feet Below Land Surface	Other (specify): _____
Pumping Water Level (B): <u>245</u> Feet Below Land Surface	For flowing well, measured shut in head: _____ feet
Drawdown [(B) - (A)]: <u>8</u> Feet Below Land Surface	Well yielded <u>5.5</u> GPM with a drawdown of _____
Test Pumping Rate: <u>55</u> Gallons Per Minute	<u>8</u> feet after <u>4</u> hours of pumping
Duration of Pump Test (minimum 4 hours): <u>4</u> hours	

I HEREBY CERTIFY that the above statements are true to the best of my knowledge.

John W Thompson 0-679 \_\_\_\_\_  
 Print Name of Pump Installer and License No. (if applicable) Signature of Pump Installer

Form: OLWR-SWR-1B

RECEIVED

JAN 11 2011

BY: OLWR